

PAL TERMINAL NO.1

OF FEET
0 50 100 150

OF PUBLIC DOCKS
- OREGON
50

1003

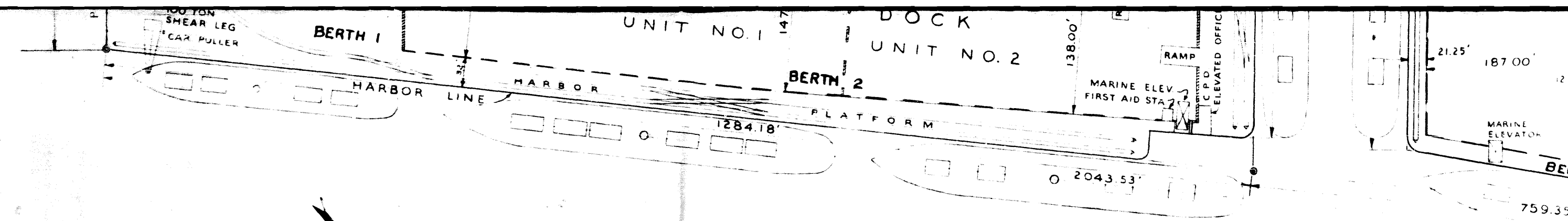

PORTLAND MUNICIPAL

SCALE OF FEET
0 25 50 75 100

THE COMMISSION OF PORTLAND
PORTLAND - OREGON

1950

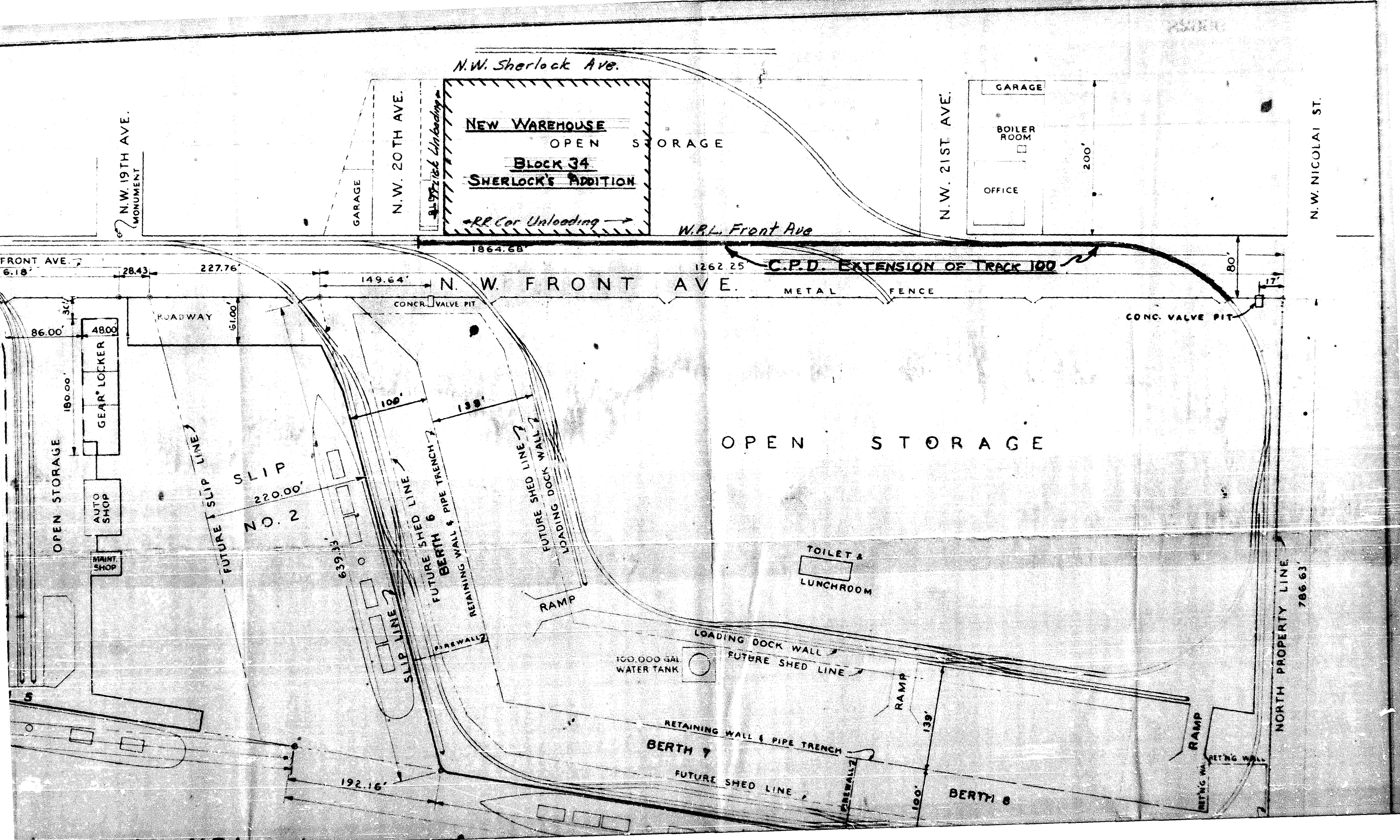

N.W. Sherlock Ave.

N.W. 19TH AVE.
MONUMENT

N.W. 20TH AVE.

N.W. 21ST AVE.

N.W. NICOLAI ST.

NEW WAREHOUSE
OPEN STORAGE
BLOCK 34
SHERLOCK'S ADDITION

RR Car Unloading

GARAGE
BOILER ROOM
OFFICE

FRONT AVE.
6.18'

W.R.L. Front Ave

1864.68'

1262.25'

C.P.D. EXTENSION OF TRACK 100

N.W. FRONT AVE.

METAL FENCE

CONC. VALVE PIT

OPEN STORAGE

SLIP NO. 2
220.00'

FUTURE SHED LINE
BERTH 6
RETAINING WALL & PIPE TRENCH

FUTURE SHED LINE
LOADING DOCK WALL

TOILET & LUNCHROOM

100,000 GAL. WATER TANK

LOADING DOCK WALL
FUTURE SHED LINE

BERTH 7
RETAINING WALL & PIPE TRENCH

FUTURE SHED LINE

BERTH 8
RETAINING WALL

NORTH PROPERTY LINE
786.63'

N.W. 14TH AVE.

N.W. UPSHUR ST.

N.W. 17TH AVE.

N.W. FRONT AVE.

FRONT AVE.

FRONT AVE.

METAL FENCE

OPEN

100,000 GAL. WATER TANK

WAREHOUSE NO. 1

QUAY DOCK EXTENSION UNIT NO. 3

PIER "A"

SHED

PIER "B"

SOUTH OPEN DOCK

BERTH 1

QUAY UNIT NO. 1

DOCK UNIT NO. 2

BERTH 2

BERTH 3

BERTH 4

BERTH 5

100 TON SHEAR LEG CAR PULLER

HARBOR LINE

HARBOR

PLATFORM

MARINE ELEV. FIRST AID STA.

MARINE ELEVATOR

OFFICE 50,000 GAL. TANK ABOVE TOILETS (ABANDONED)

325.00'

127.25'

230.00'

57.90'

200.00'

105.62'

176.00'

171.00'

86.00'

381.00'

PROPERTY LINE - METAL FENCE

RAMP

RAMP

OFFICE

177.00'

RAMP

FIREWALL

PLATFORM

RAMP

FIREWALL

RAMP

C.P.D. ELEVATED OFFICE

SLIP LINE

SLIP LINE

OPEN STORAGE

1284.18'

2043.53'

759.35'

ORDINANCE No. 96628

An ordinance granting a revocable permit to the Commission of Public Docks and the Northern Pacific Terminal Company to load and unload railroad cars on spur track 100 located on N. W. Front Avenue, opposite Block 34, Sherlock's Addition, specifying maximum period that said cars may remain on track and declaring an emergency.

The City of Portland does ordain as follows:

Section 1. The Council finds that the Commission of Public Docks is in the process of constructing a transit warehouse at Municipal Terminal No. 1, on Block 34, Sherlock's Addition to the City of Portland; that there is presently located on Front Avenue opposite said Block 34 a spur track known as Track 100, which was constructed and paid for by the Commission of Public Docks with the approval of the City of Portland; that the Northern Pacific Terminal Company possesses a franchise from the City of Portland to operate equipment over said track; that it would facilitate the use of properties of the City of Portland and convenience the work of the Commission of Public Docks in controlling such properties if the loading and unloading of railroad cars on said Track 100 be permitted; that the loading and unloading of railroad cars from tracks located on streets of the City of Portland requires special permission by the Council of the City of Portland; that such permission from the Council will prevent delay in the completion of a contract now outstanding for the construction of said transit warehouse and would result in the saving of additional expense to the Commission of Public Docks and the City of Portland, and that the granting of such permission so to load and unload railroad cars would be in the public interest; now, therefore, a revocable permit hereby is granted to the Commission of Public Docks and to the Northern Pacific Terminal Company to load and unload railroad cars of whatever nature and description on Track 100, located on Front Avenue opposite Block 34, Sherlock's Addition to the City of Portland, and for said cars to remain thereon not to exceed a period of ten (10) consecutive hours in any one day, and not to impede unreasonably and/or delay traffic on Front Avenue.

Section 2. Inasmuch as this ordinance is necessary for the immediate preservation of the public health, peace, and safety of the City of Portland in this: That it is in the

ORDINANCE No. 96628

public interest that the beneficial use of properties of the City of Portland under the control of the Commission of Public Docks should be expedited without unnecessary delay; therefore, an emergency hereby is declared to exist and this ordinance shall be in force and effect from and after its passage by the Council.

Passed by the Council, JUN 26 1952

Dorothy McCullough Lee
Mayor of the City of Portland
Will Gibson.

Attest:

Auditor of the City of Portland

By

John B. Emmer
CHIEF DEPUTY

Calendar No. 3461

ORDINANCE No. 196628

Title

An Ordinance granting a revocable permit to the Commission of Public Docks and the Northern Pacific Terminal Company to load and unload railroad cars on spur tract 100, located on N.W. Front Avenue, apposite Block 34, Sherlock's Addition, specifying maximum period that said cars may remain on track and declaring an emergency.

Filed JUN 24 1952

Will Gibson.
Auditor of the CITY OF PORTLAND

By R. S. IVEY
Deputy

THE COMMISSIONERS VOTED AS FOLLOWS:

	Yeas	Nays
Bean	/	
Bundy Hawkins	/	
Bowes	/	
Peterson	/	
Lee	/	

FOUR-FIFTHS CALENDAR

Bean	
Bundy Hawkins	NAB
Bowes	WAR
Peterson	FLP
Lee	DMcL SK

INTRODUCED BY

Com'r Peterson

DRAWN BY

MCR:pep

Date June 23, 1952

NOTED BY THE COMMISSIONER

Affairs

Finance

Safety

Utilities FLP

Works

City Attorney

NOTED FOR CITY AUDITOR

RSI

JHL

APPROVED

Date 6-24-52

By F.L. Fowler

Traffic ~~Commissioner~~ Engineer

Date 6-24-52

By L. G. Apperson
City Engineer