



**PORTLAND PARKS & RECREATION**

Healthy Parks, Healthy Portland

# ADA Transition Plan - Parks



Commissioner Amanda Fritz  
Director Mike Abbaté

[www.PortlandParks.org](http://www.PortlandParks.org)

# Americans with Disabilities Act (ADA)

- Title I: Employment
- Title II: State and Local Government Activities
- Title III: Public Accommodations

- 260 publically-accessible sites surveyed
- 20,355 barriers identified
- 17,008 barriers scheduled



# HELP MAKE PORTLAND PARKS & RECREATION ACCESSIBLE FOR ALL

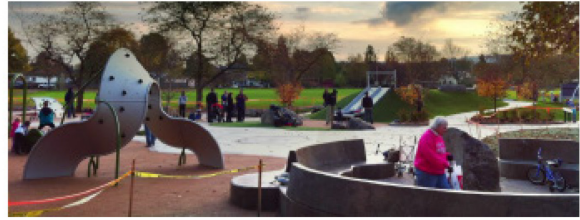

## Informed By:

- Parks Accessibility Advisory Committee
- Portland Commission on Disability
  - Accessibility in the Built Environment Subcommittee
- ADA Transition Plan Stakeholder Review Committee
- Three Public Forums (July 18, 21, 23)
- Online Comment Form

# Facility Reports

- Reference Diagram
- Barrier Number
- Barrier Description
- Code References
- Estimates (Low Confidence)
- Barrier Category

## P&R-316: Bloomington Park

<b>Park</b>	
<b>3 - 1</b>	<b>Curb Ramp</b>
<b>Install, replace or modify curb ramp</b>	
Notes: Slope of the curb ramp is 10%	
State: ---	
Federal: 405.2, 406.1	
<b>4 - 1</b>	<b>Walk</b>
<b>Regrade surface</b>	
Notes: Cross slope of asphalt path is 10%	
State: -	
Federal: 403.3	
<b>4 - 2</b>	<b>Walk</b>
<b>Grind or patch vertical change of grade</b>	
Notes: Surface level change is 1" due to broken asphalt (1/4" max, up to 1/2" with a bevel).	
State: ---	
Federal: 303.2, 303.3	
<b>4 - 3</b>	<b>Walk</b> <span style="float: right;">Category: 2</span>
<b>Regrade surface</b> <span style="float: right;">\$30</span>	
Notes: Running slope of asphalt path up to 7.0% for 2 linear feet (5.0% max).	
State: -	
Federal: 403.3	
<b>4 - 4</b>	<b>Walk</b> <span style="float: right;">Category: 2</span>
<b>Provide a firm, stable and slip resistant surface</b> <span style="float: right;">\$53</span>	
Notes: Surface of asphalt path is not firm, stable and slip-resistant due to plants growing in path for 3-1/2 linear feet.	
State: ---	
Federal: 302.1	
<b>4 - 5</b>	<b>Walk</b> <span style="float: right;">Category: 2</span>
<b>Regrade surface</b> <span style="float: right;">\$330</span>	
Notes: Cross slope of asphalt path is 2.4% to 2.9% for 22 linear feet (2.0% max).	
State: -	
Federal: 403.3	

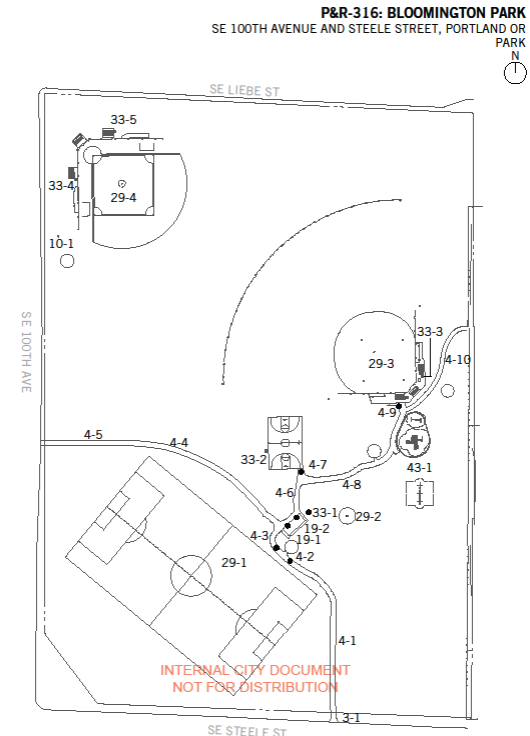

**Table 2.3.1. Distribution of Barrier Type**

<b>Barrier Type</b>	<b>Number of Barriers</b>	<b>Percent of Barriers</b>
Maintenance	8,736	51.4%
Capital	8,272	48.6%
<b>Grand Total</b>	<b>17,008</b>	<b>100.0%</b>

Maintenance: Central Services Work Orders

Capital:

- 1) Scope checks for funded projects, e.g, Marshall
- 2) Future package development, e.g, Bond

# Marshall Park in SW Portland



**Tier Score + Category Score + Experience Priority Score =  
Overall Priority Score**





# Tier Score + Category Score + Experience Priority Score = Overall Priority Score

**Table 2.2.1. Distribution of Priority Score**

<b>Priority Score</b>	<b>Number of Barriers</b>	<b>Percent of Barriers</b>
3	977	4.8%
4	4,547	22.3%
5	3,647	17.9%
6	2,382	11.7%
7	1,892	9.3%
8	2,487	12.2%
9	1,635	8.0%
10	1,523	7.5%
11	845	4.2%
12	350	1.7%
13	70	0.3%
<b>Grand Total</b>	<b>20,355</b>	<b>100.0%</b>

Plan describes process, summary schedule

By site and scheduled year

Years 1-2 (starting in 2016)

Years 3-5

Years 6-10

Years 11-20



# Arbor Lodge Park - Harper's Playground in NE Portland



# Dawson Park in NE Portland



# Next Steps

## PP&R Facilities Supplement:

- Tracking, Reporting, Funding

## Citywide Plan:

- Conduct an evaluation of City Policies and Programs
- Assess Rights of Way

# Thank You Parks Accessibility Advisory Committee

## Members:

- Steven Brown
- Georgena Moran
- David Nail (former)
- Laurie Sitton
- Fern Wilgus