



Building Permit Application

City of Portland, Oregon - Bureau of Development Services

1900 SW 4th Avenue, Portland, Oregon 97201 • 503-823-7310 • TTY 503-823-6868 • www.portlandoregon.gov/bds

13-180917-RS

Type of work

- ☐ New construction ☒ Addition/alteration/replacement
☐ Demolition ☐ Other:

Category of construction

- ☒ 1 & 2 family dwelling ☐ Commercial/industrial ☐ Accessory building
☐ Multifamily ☐ Master builder ☐ Other:

Job site information and location

Job no.: Job address: 2625 NE 35th Place

City/State/ZIP: Portland OR

Suite/bldg./apt. no.: Project name:

Cross street/directions to job site:

Subdivision: Lot no. Tax map/parcel no.

Description of work

Demolition and rebuild of fireplace
chimney to existing specifications
with new materials

Provide RS Permit no.

Property owner

Name: Joanne Fantuzzi E-mail:

Address:

City/State/ZIP:

Phone: FAX:

Owner installation: This installation is being made on property that I own, which is not intended for sale, lease, rent, or exchange.

Owner signature: Date:

Contractor

Business name: Professional Masonry E-mail: flyingbrick2@msn.com

Address: 1507 SE Boise St

City/State/ZIP: Portland OR 97202

Phone: 503 230 7711 FAX:

CCB lic. no. 56217

Authorized signature: [Signature]

Print name: Jackie Stanley Date: July 16, 2013

Applicant

Business name:

Contact name:

Address: CCB

City/State/ZIP:

Phone: FAX:

E-mail:

Authorized signature:

Print name: Date:

This permit application expires if a permit is not obtained within 180 days after it has been accepted as complete.

Office Use Only

Permit no:

Date received:

By:

Required Data: One and Two Family Dwelling

Permit fees* are based on the value of the work performed. Indicate the value (rounded to the nearest dollar) of all equipment, materials, labor, overhead, and the profit for the work indicated on this application.

| | |
|-------------------------|-------------|
| Valuation: | 9500 |
| Number of bedrooms: | |
| Number of bathrooms: | |
| Total number of floors: | |
| New dwelling area: | square feet |
| Garage/carport area: | square feet |
| Covered porch area: | square feet |
| Deck area: | square feet |
| Other structure area: | square feet |

Required Data: Commercial Use

Permit fees* are based on the value of the work performed. Indicate the value (rounded to the nearest dollar) of all equipment, materials, labor, overhead, and the profit for the work indicated on this application.

| | |
|-------------------------|-------------|
| Valuation: | |
| Existing building area: | square feet |
| New building area: | square feet |
| Number of stories: | |
| Type of construction: | |
| Occupancy groups | |
| Existing: | |
| New: | |

Notice

All contractors and subcontractors are required to be licensed with the Oregon Construction Contractors Board under ORS 701 and may be required to be licensed in the jurisdiction in which work is being performed.

Statement of Fact: I certify that the facts and information set forth in this application are true and complete to the best of my knowledge. I understand that any falsification, misrepresentation or omission of fact (whether intentional or not) in this application or any other required document, as well as any misleading statement or omission, may be cause for revocation of permit and/or certificate of occupancy, regardless of how or when discovered.

I acknowledge that work related to this Building Permit Application may be subject to regulations governing the handling, removal and/or disposal of asbestos and/or lead-based paint. _____ (initials)

Building Permit Fees*

Please refer to fee schedule

| | |
|---------------------------|--|
| Fees due upon application | |
| Amount received | |
| Date received | |

Residential Combo permit subcontractor submittals only can be faxed to 503-823-7693 or e-mailed to BDSCombInspSec@portlandoregon.gov.

2625 NE 35TH PLACE
PORTLAND, OR

Demolish and rebuild
of fireplace to existing
Specifications

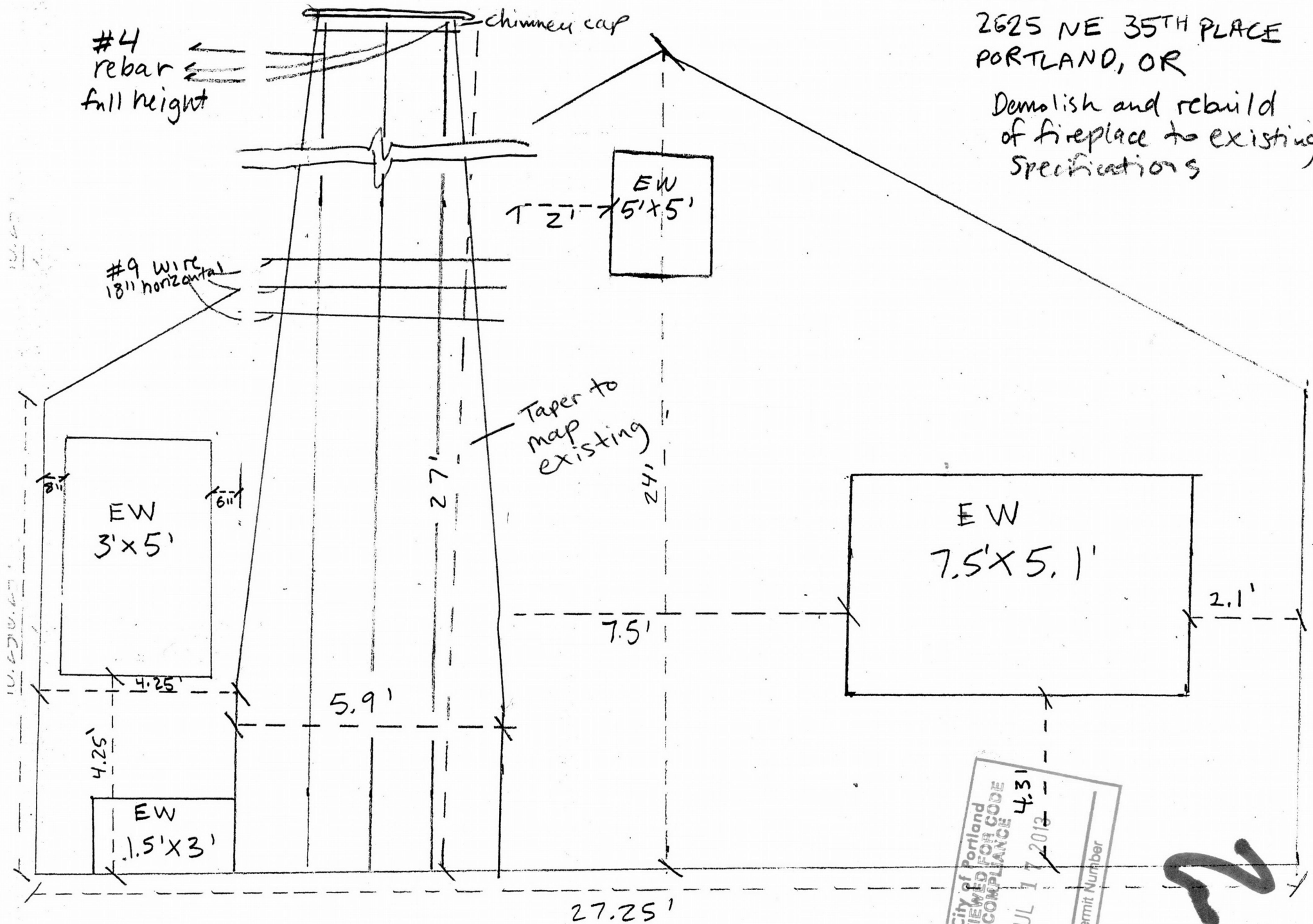

13-1806917-125

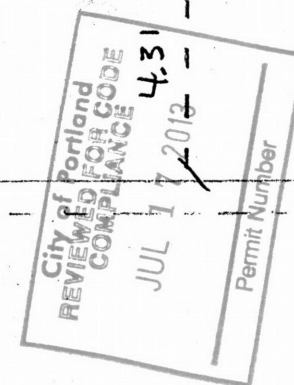

2
B

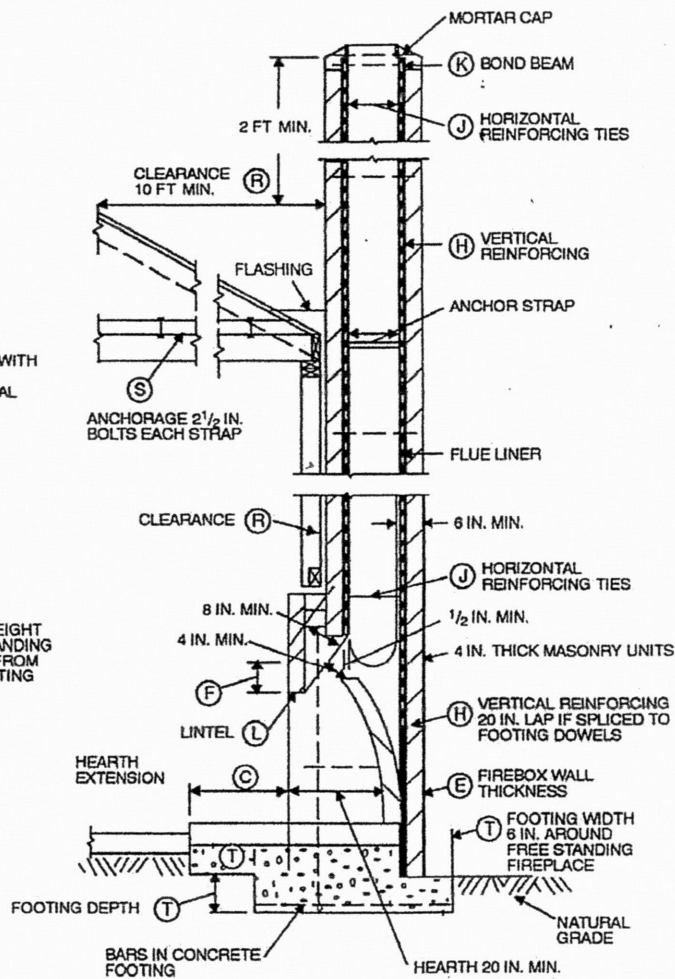
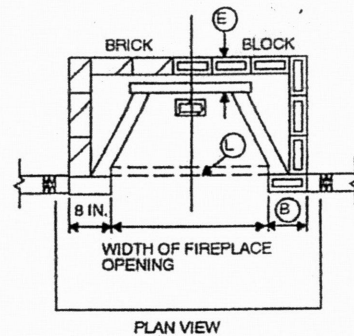
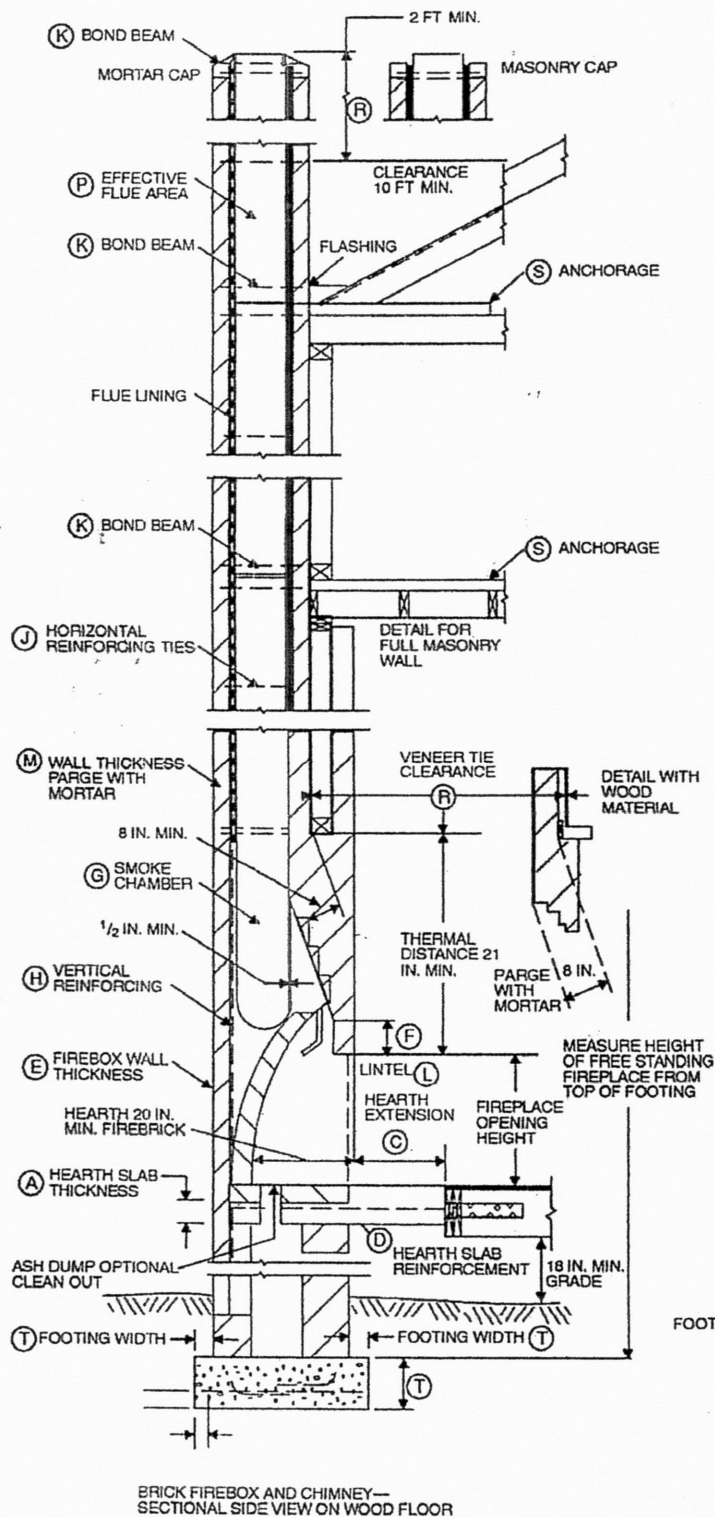

For SI: 1 inch = 25.4 mm, 1 foot = 304.8 mm.

FIGURE R1001.1
FIREPLACE AND CHIMNEY DETAILS

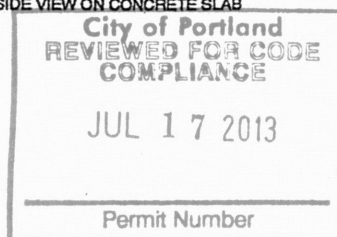



House
Chimney
driveway

City of Portland
REVIEWED FOR CODE
COMPLIANCE

JUL 17 2013

Permit Number

PortlandMaps

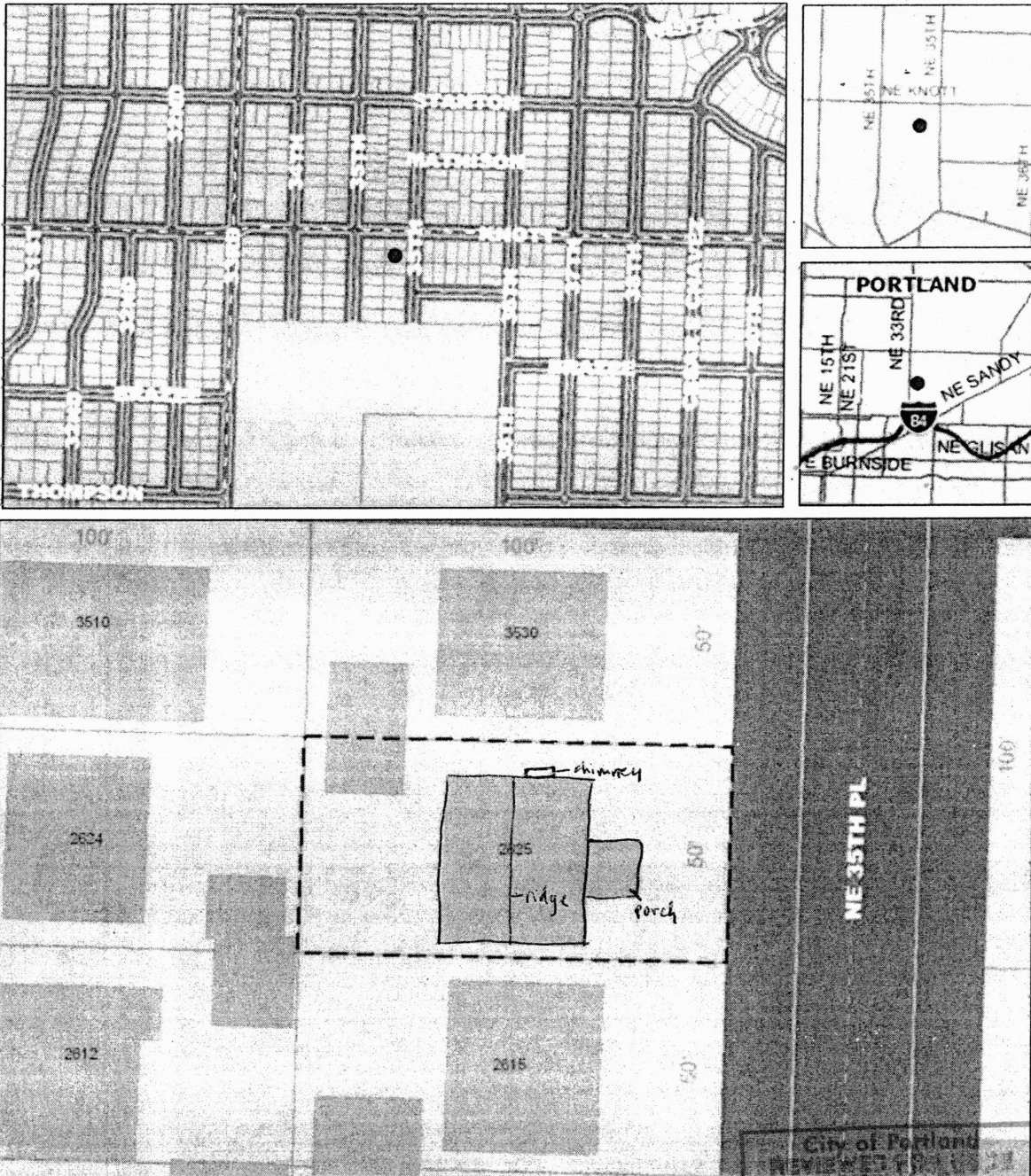
[New Search](#) | [Mapping](#) | [Advanced](#) | [Google Earth](#) | [Help](#) | [PortlandOnline](#)**2625 NE 35TH PL - GRANT PARK -
PORTLAND**[Explorer](#) | [Property](#) | [Maps](#) | [Projects](#) | [Crime](#) | [Census](#) |
[Environmental](#) | [Transportation](#)[Summary](#) | [Assessor](#) | [Permits/Cases](#) | [Block](#) | [Schools](#) | [Parks](#) | [Development](#) | [Garbage/Recycling](#) | [Noise](#) | [Historic](#) |
[Permits](#) | [Water](#) | [Documents](#)**Property & Location****City of Portland, Corporate GIS**

THE GIS APPLICATIONS ACCESSED THROUGH THIS WEB SITE PROVIDE A VISUAL DISPLAY OF DATA FOR YOUR CONVENIENCE. EVERY REASONABLE EFFORT HAS BEEN MADE TO ASSURE THE ACCURACY OF THE MAPS AND ASSOCIATED DATA. THE CITY OF PORTLAND MAKES NO WARRANTY, REPRESENTATION OR GUARANTEE AS TO THE CONTENT, SEQUENCE, ACCURACY, TIMELINESS OR COMPLETENESS OF ANY OF THE DATA PROVIDED HEREIN. THE USER OF THESE APPLICATIONS SHOULD NOT RELY ON THE DATA PROVIDED HEREIN FOR ANY REASON. THE CITY OF PORTLAND EXPLICITLY DISCLAIMS ANY REPRESENTATIONS AND WARRANTIES, INCLUDING, WITHOUT LIMITATION, THE IMPLIED WARRANTIES OF MERCHANTABILITY AND FITNESS FOR A PARTICULAR PURPOSE. THE CITY OF PORTLAND SHALL ASSUME NO LIABILITY FOR ANY ERRORS, OMISSIONS, OR INACCURACIES IN THE INFORMATION PROVIDED REGARDLESS OF HOW CAUSED. THE CITY OF PORTLAND SHALL ASSUME NO LIABILITY FOR ANY DECISIONS MADE OR ACTIONS TAKEN OR NOT TAKEN BY THE USER OF THE APPLICATIONS IN RELIANCE UPON ANY INFORMATION OR DATA FURNISHED HEREUNDER. FOR UPDATED INFORMATION ABOUT THE MAP DATA ON PORTLANDMAPS PLEASE REFER TO CITY'S METADATA FOR QUESTIONS ABOUT ASSESSMENT INFORMATION PLEASE CONTACT THE COUNTY ASSESSORS OFFICE IN YOUR COUNTY.

JUL 17 2013

7/17/2013

[Address](#) | [Mapping](#) | [Advanced](#) | [Google Earth](#) | [Help](#) | [About](#)PortlandMaps © 2013 [City of Portland, Oregon](#)