

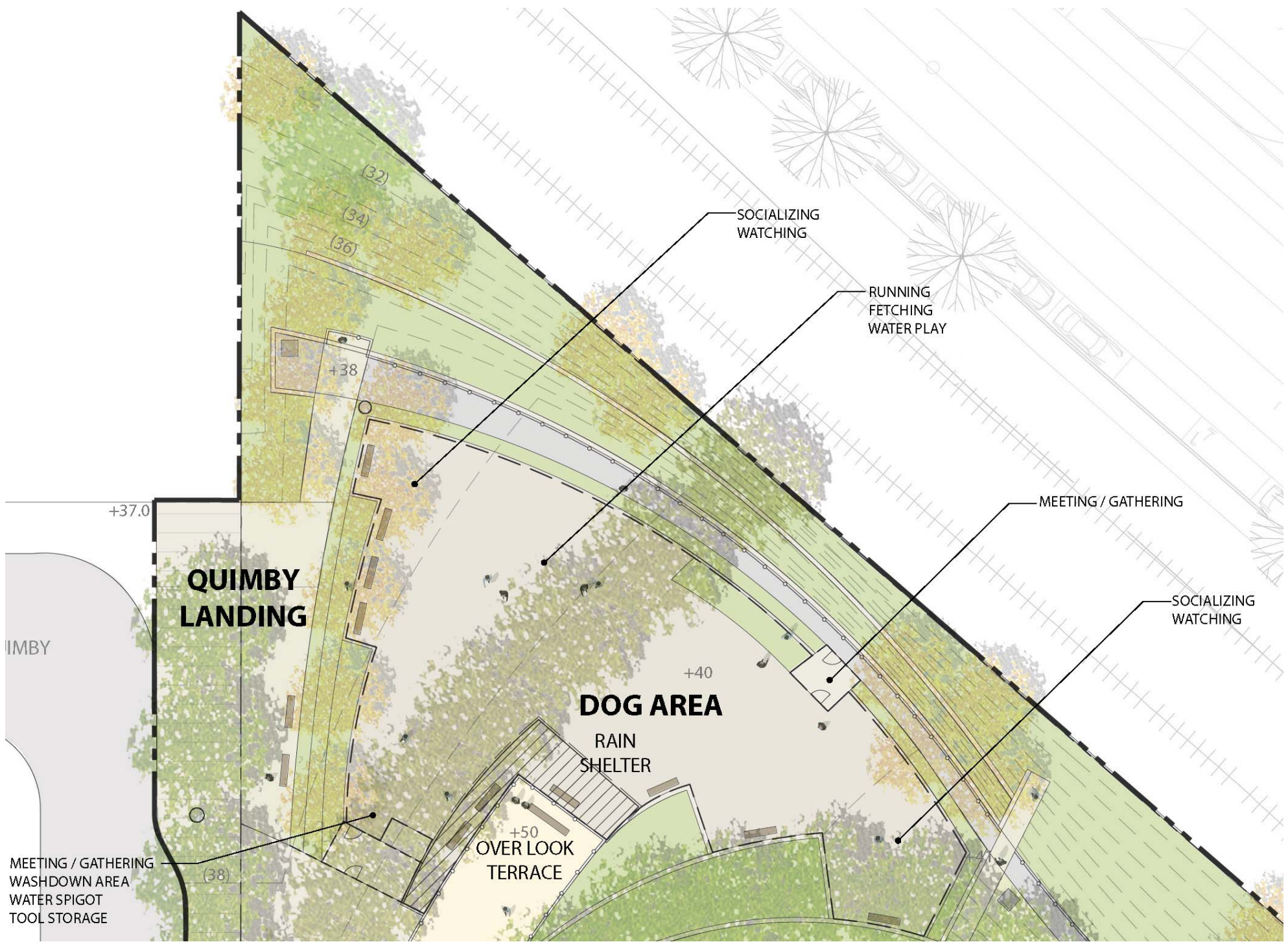

THE FIELDS NEIGHBORHOOD PARK

SCHEMATIC PLAN





THE FIELDS NEIGHBORHOOD PARK

DOG AREA







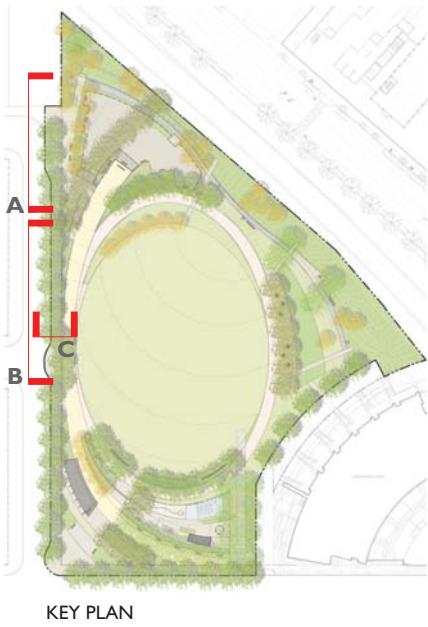

KEY PLAN



SECTION A: QUIMBY LANDING AND DOG RUN (FROM 11TH STREET)



SECTION B: PETTYGROVE LANDING AND OVERLOOK WALK (FROM 11TH STREET)



SECTION C: PETTYGROVE LANDING (LOOKING NORTH)

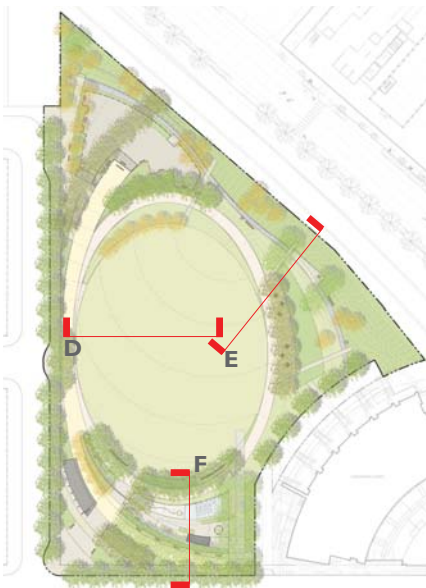

KEY PLAN



OVERLOOK ACCESS WALK

CENTRAL GRASSED OPEN SPACE

OVERLOOK

ELLIPSE WALK

SECTION D: THE YARD (LOOKING NORTH)



ELLIPSE WALK

“URBANOLOGY” TRAIL

PORTLAND RAILROAD COMPANY

SECTION E: EAST EDGE OF PARK (LOOKING NORTH)

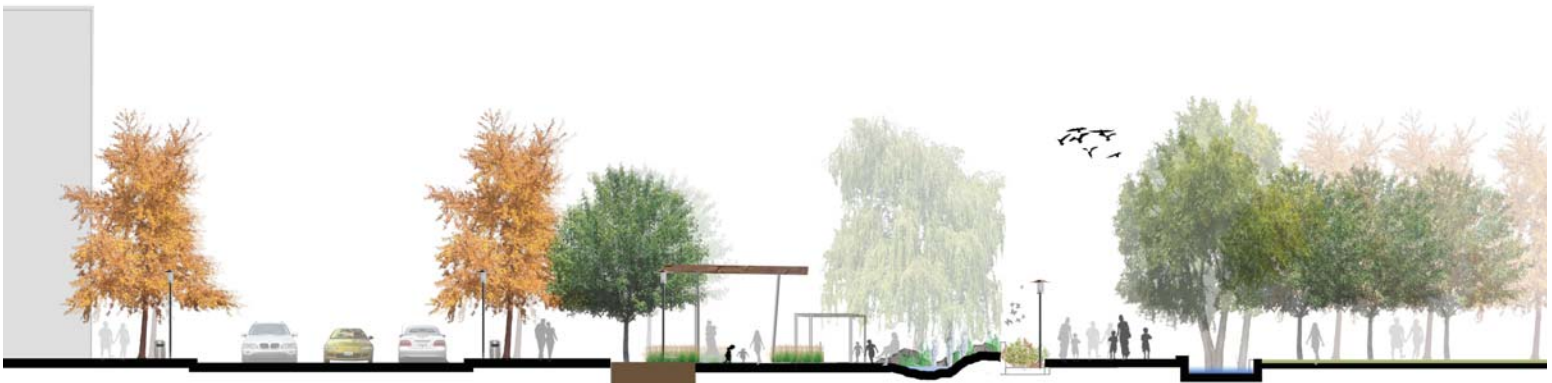

NW OVERTON STREET

RAIN SHELTER

RIVER HABITAT

ELLIPSE WALK

THE YARD

SECTION F: CHILDREN'S AREA (LOOKING WEST)