

EXHIBIT 2

South Corridor Project
I-205 Segment

City of Portland
S.E. 94th Avenue
Portland, OR 97266
1S2E16DC
PNS, DEA INC. 07-07-10

EXHIBIT "A"

Reserved Sewer Easement

A strip of land falling within vacated S.E. 94th Avenue situated in the Southeast one-quarter of Section 16, Township 1 South, Range 2 East, W.M., City of Portland, Multnomah County, Oregon, and being a portion of S.E. 94th Avenue, said strip being 15.00 feet wide, lying 10.00 feet on the westerly side and 5.00 feet on the easterly side of the following described center line:

Commencing at the southeast corner of Lot 6, Block 4, Webb's Addition; thence along the west right-of-way line of S.E. 94th Avenue North 01° 34' 11" East 81.00 feet; thence South 88° 05' 25" East 10.30 feet to the true point of beginning of said center line; thence North 07° 38' 32" West 9.74 feet; thence North 43° 38' 32" West 12.32 feet to the westerly right-of-way line of S.E. 94th Avenue. The sidelines of said strip lengthen or shorten to begin on a line bearing South 88° 05' 25" East to or from the true point of beginning and end on the westerly right-of-way line of S.E. 94th Avenue.

This parcel contains 262 square feet, more or less.

The bearings of this description are based on the Oregon Coordinate System of 1983, north zone, 1991 adjustment.

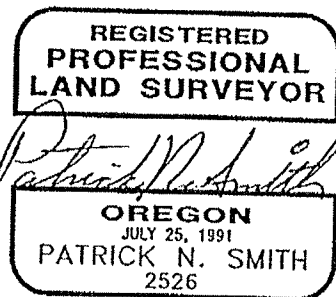

RENEWAL 6/30/12

184538

EXHIBIT 3



INTERSTATE 205

TOWN OF LENT

S.E. 93RD AVENUE

S.E. 94TH AVENUE

S.E. HENRY STREET

WEBB'S ADD.

BLOCK 5

BLOCK 4

EXISTING PIPE

RESERVED
SEWER EASEMENT
262 SQ. FT.



DAVID EVANS
AND ASSOCIATES INC.
2100 Southwest River Parkway
Portland Oregon 97201
Phone: 503.223.6663

PROJECT

SOUTH CORRIDOR PROJECT

SHEET

TITLE

S.E. 94TH AVENUE & S.E. HENRY STREET

EXHIBIT MAP FOR SEWER EASEMENT

DWG. REF.

SvEm8

PROJECT

TMTX0000-0123

SCALE

1" = 60'

AMENDMENT NO.

2

DRAWN BY

TAS

DESIGN BY

PNS

APPROVED BY

KRW

DATE

7/07/10

1