

Transportation Access Projects in the Central Eastside



Portland to Milwaukie light rail

Connecting a corridor



Portland to Milwaukie light rail: Opens in 2015

- Construction creates opportunity
- Dramatically changes the district and the corridor
- PBOT seeks to formalize and fund access projects that benefit from light rail construction



SE Water Avenue Relocation Project:



OMSI Master Plan

- OMSI master plan envisioned Water Ave relocation
- New Roadway moves through traffic to edge of future campus
- Leaves “old” Water Ave to be converted into a plaza space



Sherman Alternative
Site Plan

OMSI Master Plan
June 12, 2007 district property owners update

Relocating Water Avenue

- New alignment facilitates streetcar connections to future light rail bridge
- Allows expansion of OMSI and Portland Opera
- Minimizes conflict with industrial users
- Builds a complete street with pedestrian and bicycle facilities



SE Water Ave Cross Section

Previous Section

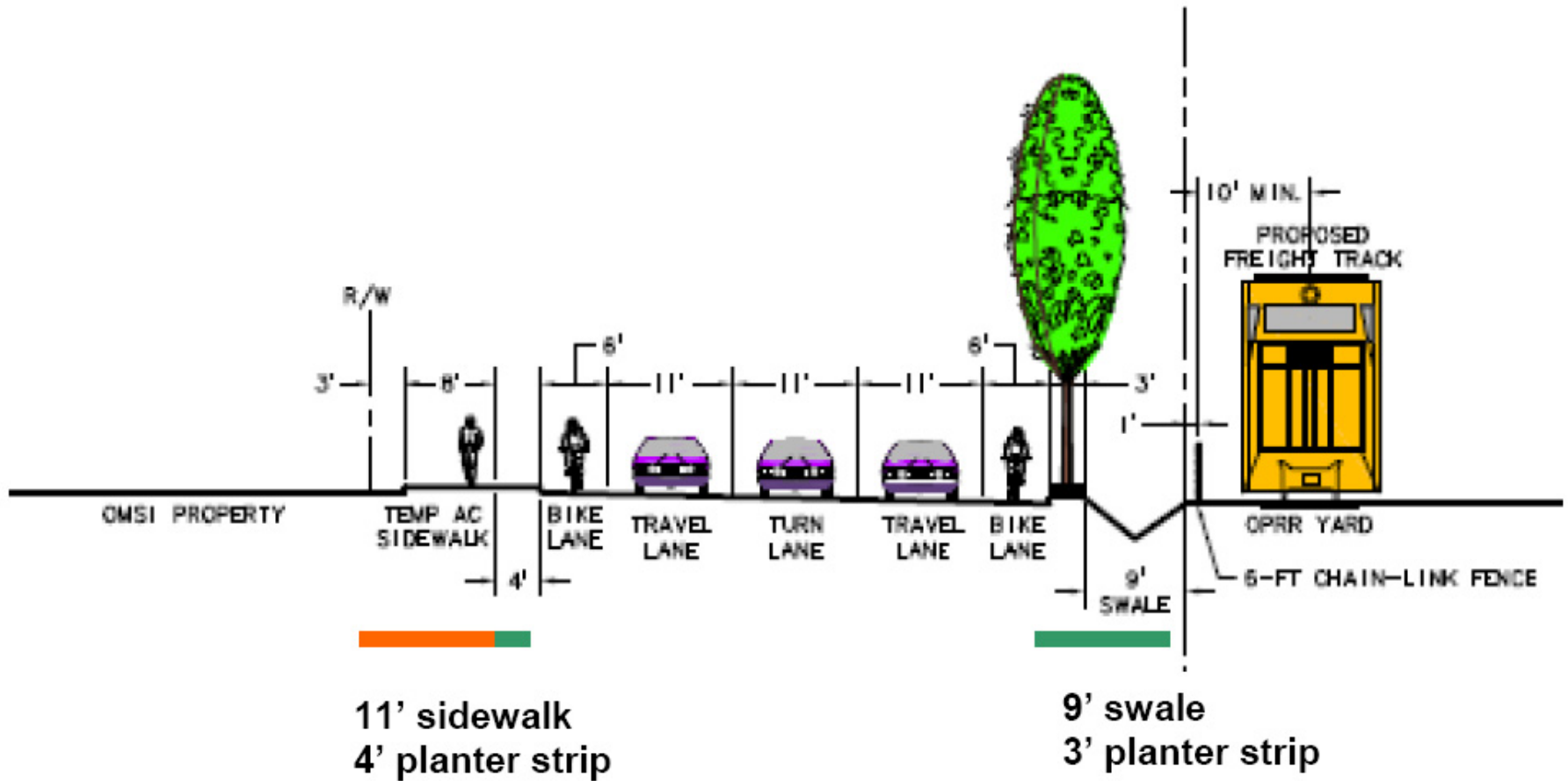

SE Water Ave Cross Section

Proposed Revised Section

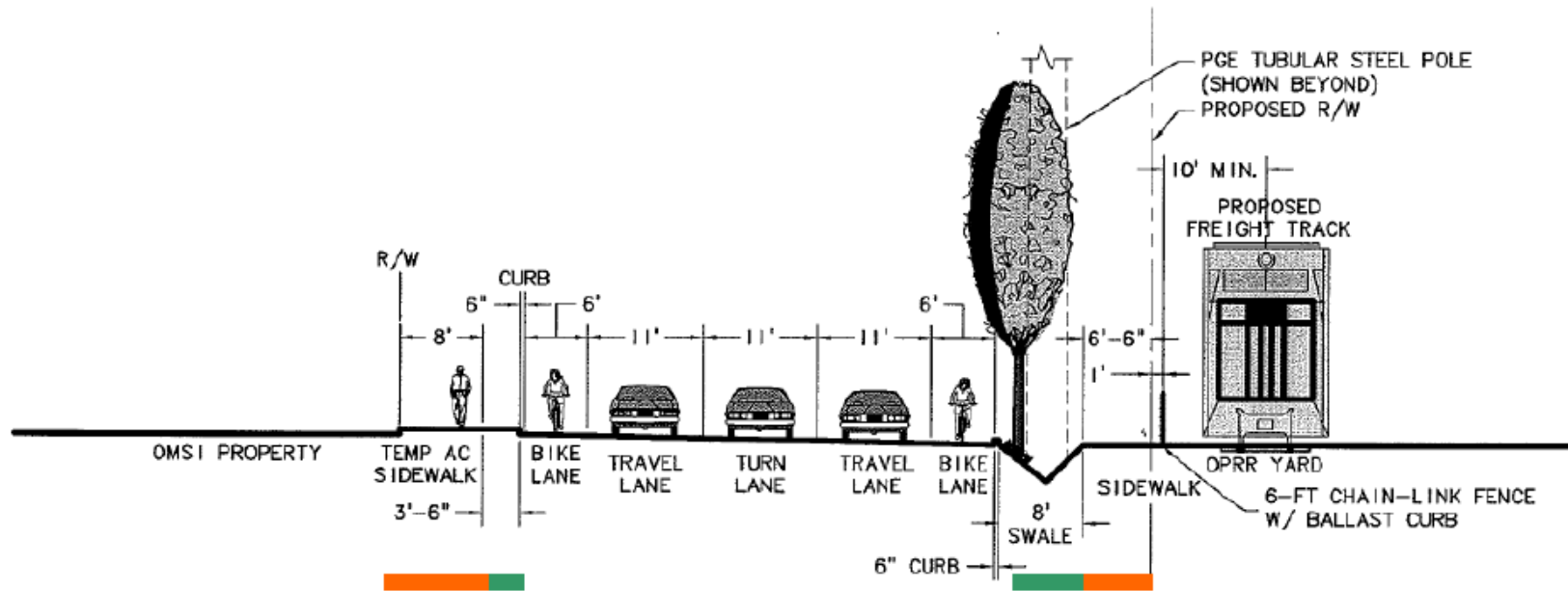

8' sidewalk
4' planter strip

6'6" sidewalk
8 foot swale

Note: Revised section is conceptual only. Design requirements for swale sizing and PGE pole placement still being developed.

SE Water Ave TSP Classification Change







- Move designation for primary circulation to new roadway
- Retain local street designations for existing street to Caruthers
- Remove future street designation between Caruthers and Division
- Greenway trail designation along river unchanged



Clinton to the River Multiuse Path





-  Clinton to the River Path
 -  Trail/Bike Boulevard
 -  Bicycle Route
 -  Bicycle Lane
 -  Future Light Rail
 -  Future Streetcar
- N**

Path connects numerous bike boulevards



Path connects numerous Pedestrian Streets/Paths



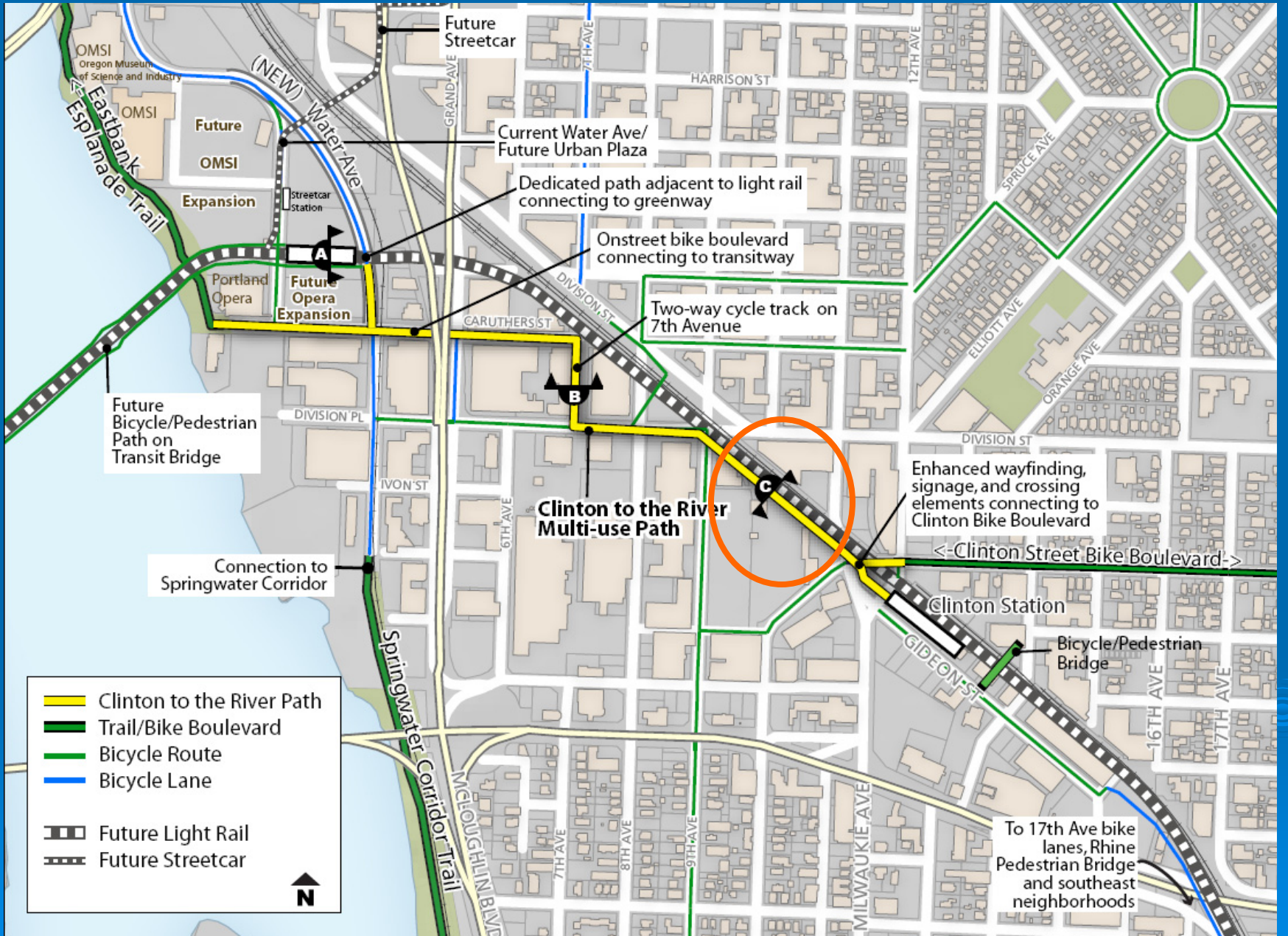

Trail Segment adjacent to NW Natural Property

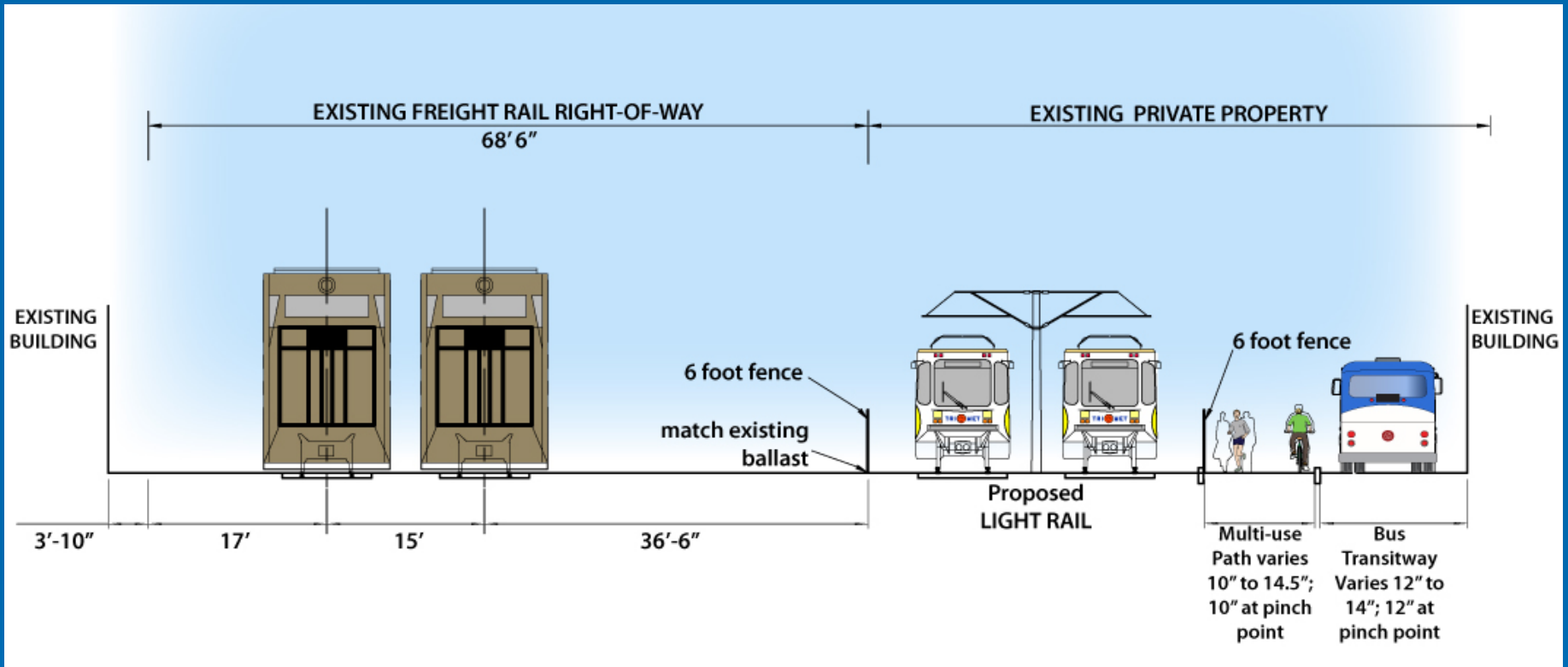

10 foot "pinch point"

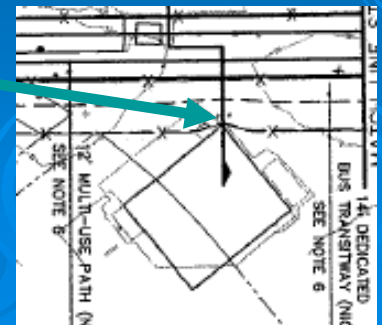



- Clinton to the River Path
 - Trail/Bike Boulevard
 - Bicycle Route
 - Bicycle Lane

 - Future Light Rail
 - Future Streetcar
- ↑ N

7th Avenue Busway, Sidewalk and Cycletrack

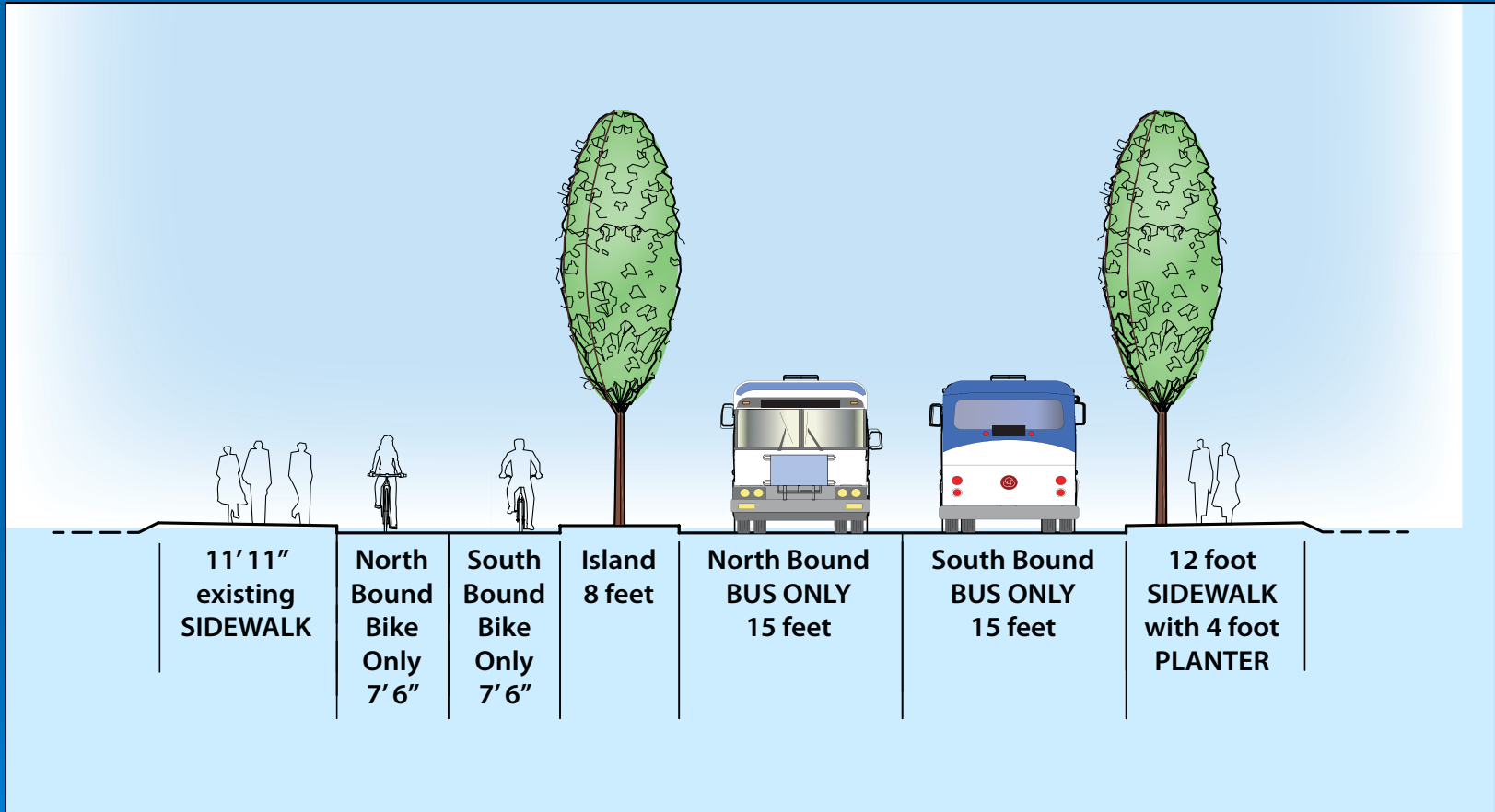

7th Avenue Busway, Sidewalk and Cycletrack

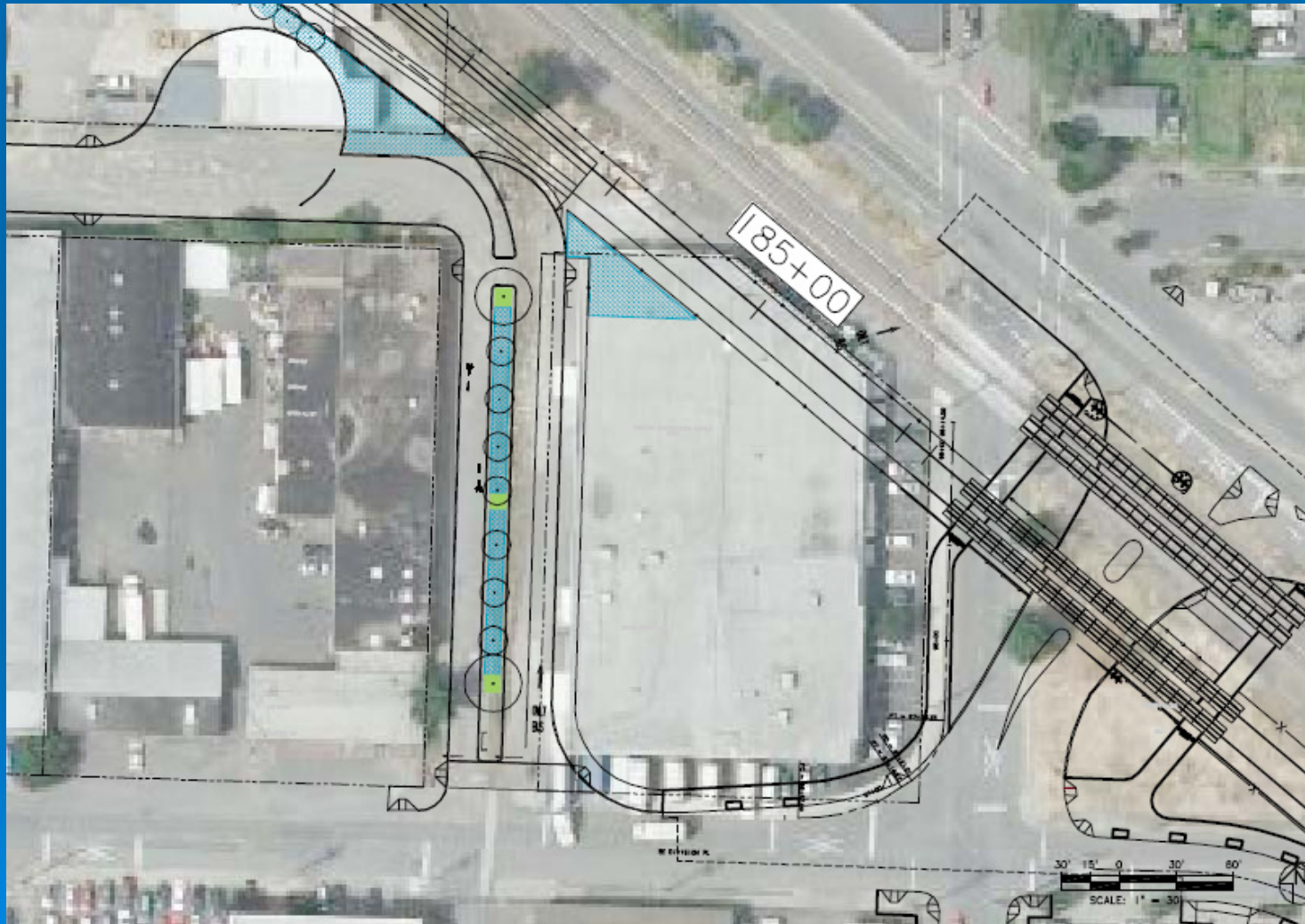



OMSI LRT Station includes Sidewalk and Cycletrack

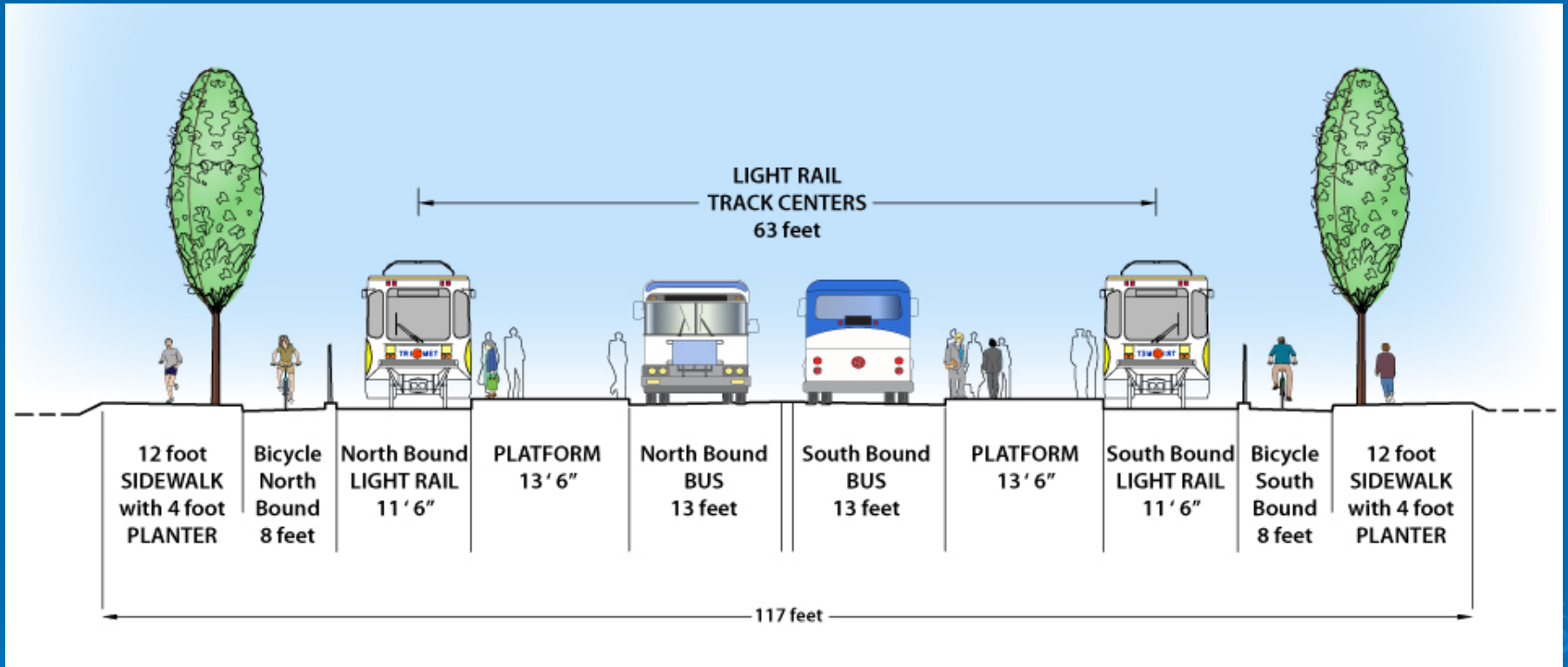

Next Steps:

Formalize Projects through City Council

- Stakeholder briefings and outreach
- Planning Commission: October 12
- Open House: November
- City Council: November

Update TSP to include projects

- TSP Technical Update: October –March

Continue to pursue funding

- More information on both projects: www.SECorridorProject.com