

DIRECTOR PARK MAP*



SW Yamhill Street and Park Avenue
503.823.8087

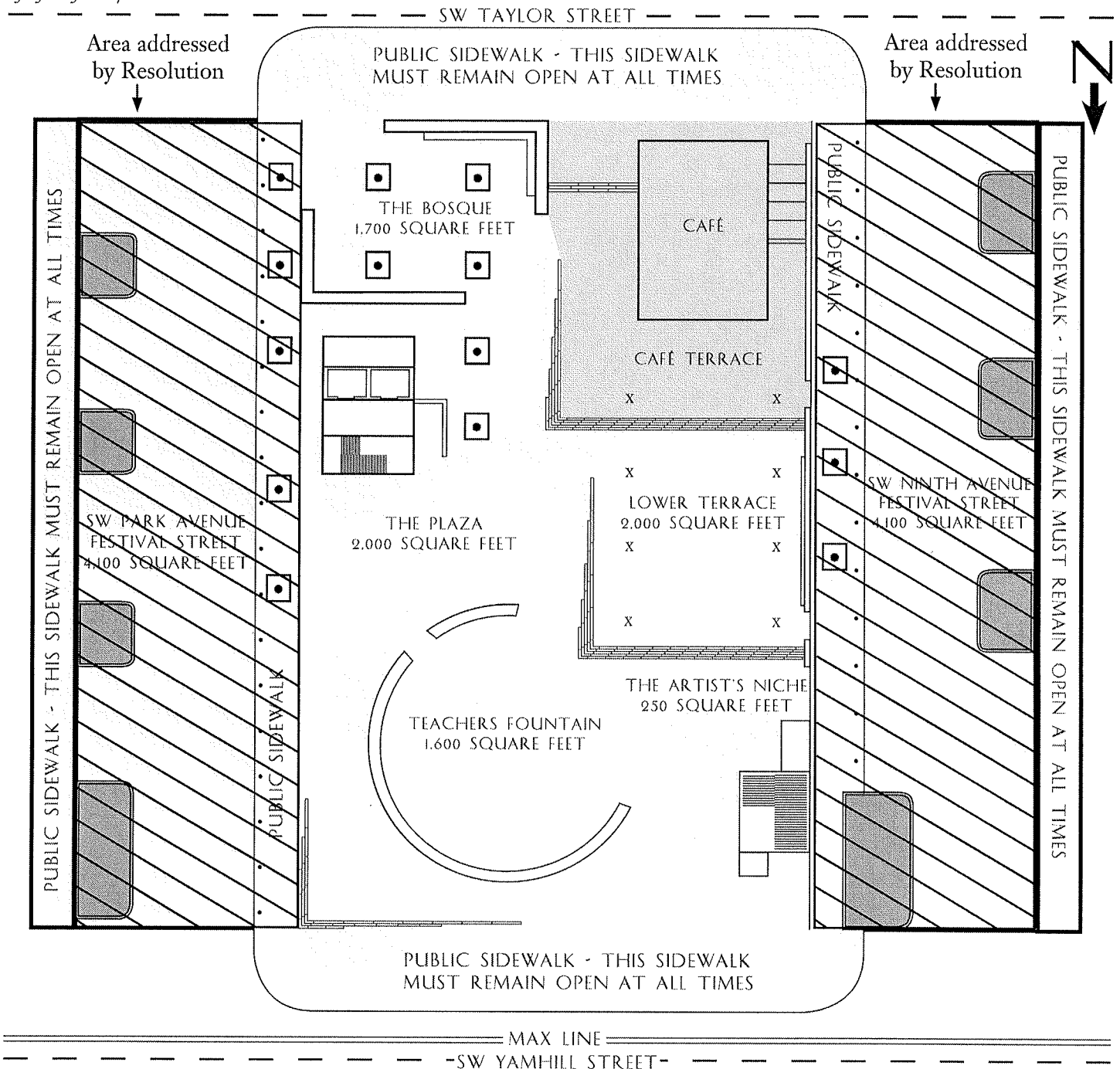

**PORTLAND
PARKS & RECREATION**

Healthy Parks, Healthy Portland



 : Planter boxes
  : Tree
 x : Canopy support columns
  : Stairs to parking structures
 • : Bollards
 *Map is not drawn to scale

MAP LEGEND

www.PortlandParks.org • Nick Fish, Commissioner • Zari Santner, Director

Sustaining a healthy park and recreation system to make Portland a great place to live, work and play.