

2801 north gantenbein avenue • portland, oregon 97227



EMANUEL HOSPITAL'S PRESENTATION
TO
SHRINERS HOSPITAL FOR CRIPPLED CHILDREN
OCTOBER 16, 1977

ROGER G. LARSON, PRESIDENT
(503)-280-4001

TABLE OF CONTENTS

1. Introduction
 2. Status of the Emanuel Urban Renewal Plan
 3. Veteran's Administration Hospital
 4. Other Construction Development Activities
 5. Land Considerations for Shriners Hospital
 6. Additional Planning Considerations
 - a. Opportunities for Shared Services
 - b. Certificate of Need
 - c. Urban Renewal Design
 - d. Zoning
 7. Emanuel Educational Programs
 8. Conclusion
- Appendix 1 - Site Development Plan

(1) INTRODUCTION

Beginning in October 1971, and again in April 1974, December 1974, and January 1977, Emanuel Hospital has had the pleasure of making presentations to various representatives of the Shriners Hospital for Crippled Children to relocate on the Emanuel urban renewal campus. It is the intent of this presentation to highlight the current progress and certain ramifications of Emanuel Hospital, and further to suggest the opportunities which are present for possible relocation of the Shriners Hospital.

In 1915, Emanuel moved from Southwest Portland to the present location. Through the decades the hospital has grown, and it is now a 554-bed institution. It is one of the largest community medical center teaching hospitals in the Pacific Northwest.

In 1966, in cooperation with the City of Portland and the Portland Development Commission, the hospital's Board of Directors chose to remain in this location, and to embark upon an urban renewal program. In addition to the urban renewal program, the Board also embarked upon a long-range modernization and construction program for the hospital. Phases one and two of this plan were a physician's office building located on North Vancouver Avenue, and an 80-bed extended care and rehabilitation center located to the north of the main hospital structure. These are now in operation with a total investment of approximately \$3.2 million. Construction of phase three, "Operation

Update" as we have named it, is proceeding well. It consists of a newly constructed lobby which connects the north wing of the existing hospital with the Emanuel East Administration Building. This phase also includes extensive remodeling of various departments in the main hospital building and the construction of a 200-replacement bed, five-floor patient hospital wing attached to the north side of the existing hospital. Construction on the new hospital wing was completed in March 1977, and is now occupied. The final portion of this program is a capital fund raising campaign which is being conducted by the Emanuel Medical Center Foundation to raise \$1.5 million to help offset a fraction of the \$12 million requirement for the Operation Update program.

The design for the Emanuel campus has been oriented towards providing an opportunity for multiple facilities to be located in close proximity allowing for separate identity and autonomy for each institution. The Emanuel Hospital campus site was selected because of its excellent accessibility, both to the freeway system and to our public transportation network.

(2) STATUS OF THE EMANUEL URBAN RENEWAL PLAN

The Emanuel urban renewal land clearance project is now virtually complete with all of the property now being owned by either Portland Development Commission or Emanuel Hospital.

(3) VETERAN'S ADMINISTRATION HOSPITAL PROPOSAL

During 1975, Emanuel Hospital prepared a general discussion presentation for the Veteran's Administration Hospital to consider relocation on the Emanuel campus. This came about as a result of the Veteran's Administration Offices in Washington, D.C. finding it necessary to replace their Veteran's Hospital in Vancouver, Washington and the Veteran's Hospital located here in Portland. Our presentation suggested the south portions of the Emanuel campus for the site of potential relocation for the Veteran's Hospital.

A consultant's report, prepared for the City of Portland in August 1977, did a comparative analysis of hospital sites on Marquam Hill and on the Emanuel campus. The report dealt with such areas as transportation, environment, city services and neighborhood impact. After receiving the report, along with several days of public testimony, the City of Portland Planning Commission voted to recommend the Emanuel campus as a superior site for construction of a hospital facility. A copy of this report can be made available to the Shriners in their site assessment.

We have been advised that Congress and the Veteran's Administration will be making a site selection for the new Veteran's Administration Hospital during the Fall of 1977.

(4) OTHER CONSTRUCTION DEVELOPMENT ACTIVITIES

In September 1977, the Housing and Urban Development Administration and the City of Portland broke ground on a new housing for the elderly project to be located in the Eliot community, immediately adjacent to the Emanuel campus. It is anticipated that this housing project will be completed July 1, 1978.

Additionally within the last year, the City of Portland has done considerable remodeling and new construction in Dawson Park, immediately adjacent to the Emanuel campus.

Finally, a new physician's office facility is being constructed just east of the two sites being proposed for construction of the new Shriners Hospital for Crippled Children.

(5) LAND CONSIDERATIONS FOR THE SHRINERS HOSPITAL

As has been mentioned earlier in this presentation, the Veteran's Administration Hospital main site interest apparently lies on the southern portion of the Emanuel campus. We should like to suggest that the Shriners Hospital consider north portions of the campus for

possible relocation. We suggest this site with the understanding that other campus site possibilities could become available as we receive further information from the Veteran's Administration. In addition, we continue to review site locations with other development sponsors. (The attached campus site development plan will show the various possibilities of relocation.)

(6) **ADDITIONAL CONSIDERATIONS FOR THE SHRINERS HOSPITAL**

a. Opportunities for Shared Services -

Comprehensive Health Planning Agency in Portland is presently working on an areawide plan for pediatric services. Portland pediatricians, for some time now, have designated Emanuel Hospital as the pediatric hospital facility for the metropolitan area. Additionally, Emanuel has continued to function as the major orthopedic hospital in the area. We feel that our strengths in the pediatric and orthopedic areas will compliment well the expertise and renowned reputation of excellence that the Shriners Hospital has in orthopedic child care. The overlap of physician membership on both the Shriners' and Emanuel's medical staffs should enhance the opportunities for shared medical programs which will function to the benefit of both hospitals.

We would be most anxious to pursue any programs for sharing expensive equipment and facilities on the campus. Emanuel is in

the process of constructing a computerized axial tomographic full body scanner which would be available to the Shriners for use in x-ray procedures. Emanuel has a large full service laboratory which already provides some laboratory services for the Shriners Hospital. These services would continue to be available. Construction of a new linear accelerator for treatment of cancer was completed approximately a year ago and this facility would also be available for use by the Shriners. A variety of other services exist which may be of benefit to the Shriners and we would be happy to discuss any opportunities for sharing that would appear to be of benefit to both institutions.

b. Certificate of Need -

The State of Oregon has a Certificate of Need Law. Essentially this law requires any health care facility wishing to modernize or construct new facilities to gain approval from certain local and state health agencies before construction can begin. We have considerable experience in this arena, and can offer assistance to the Shriners Hospital in processing the appropriate application.

c. Urban Renewal Design -

It would be necessary for any facility or development activity wishing to locate on the campus to conform to the urban renewal plan. The plan addresses itself to certain architectural design

and landscape concepts.

d. Zoning -

If any change in zoning would be required or if streets need to be vacated, we would assist the Shriners Hospital in every way possible. Again, we have had experience with local planning agencies and we, together with the Portland Development Commission, would help in these particular tasks.

(7) EMANUEL EDUCATION AND RESEARCH PROGRAMS

Emanuel is one of the largest community medical center teaching hospitals in the Northwest. One of the many important physician training programs is orthopedic surgery. This program has been in existence for 40 years. Emanuel is proud to participate directly in sponsorship of this orthopedic surgery program by cooperating with the Shriners Hospital, University of Oregon Medical School, and in recent years, the Veteran's Administration Hospital. In other cooperative programs with the Medical School, Emanuel provides residencies in neurology, pediatrics, obstetrics-gynecology. Also, the hospital provides residencies in internal medicine, general surgery, pathology, radiology, and family practice. All of the residency programs are approved by their respective American Specialty Boards and the Council on Medical Education of the Medical Association. Emanuel has more than 50 physicians in resident training at any one time throughout the year. We also have a school of x-ray technology, medical technology, and an

internship in pharmacy.

Emanuel has ongoing clinical research programs in a variety of areas.

Emanuel's medical staff has a strong interest in both education and clinical research and we would look forward to working with the Shriners on programs of mutual interest.

(8) CONCLUSION FOR THE SHRINERS HOSPITAL PRESENTATION

In summary, and reflecting over the past several years of discussions, we wish to reiterate our desire to have the Shriners Hospital facility relocate on the Emanuel Hospital campus.

When one observes:

- ... the potential for close coordination of shared services and personnel,

- ... the continuing aspects of medical education and clinical research, and

- ... convenient accessibility to the public,

it would seem that the relocation of the Shriners Hospital to the Emanuel campus does hold considerable attraction. This consideration possesses many positive factors for the continuance in excellence of pediatric-orthopedic care that the Shriners Hospital has provided to the Portland Community for many decades. As the Shriner Hospital organization considers relocation, may it recall the factors sited in this presentation and consider seriously, a site here at Emanuel. We stand committed to offer the utmost of assistance as you consider relocating in the near future.

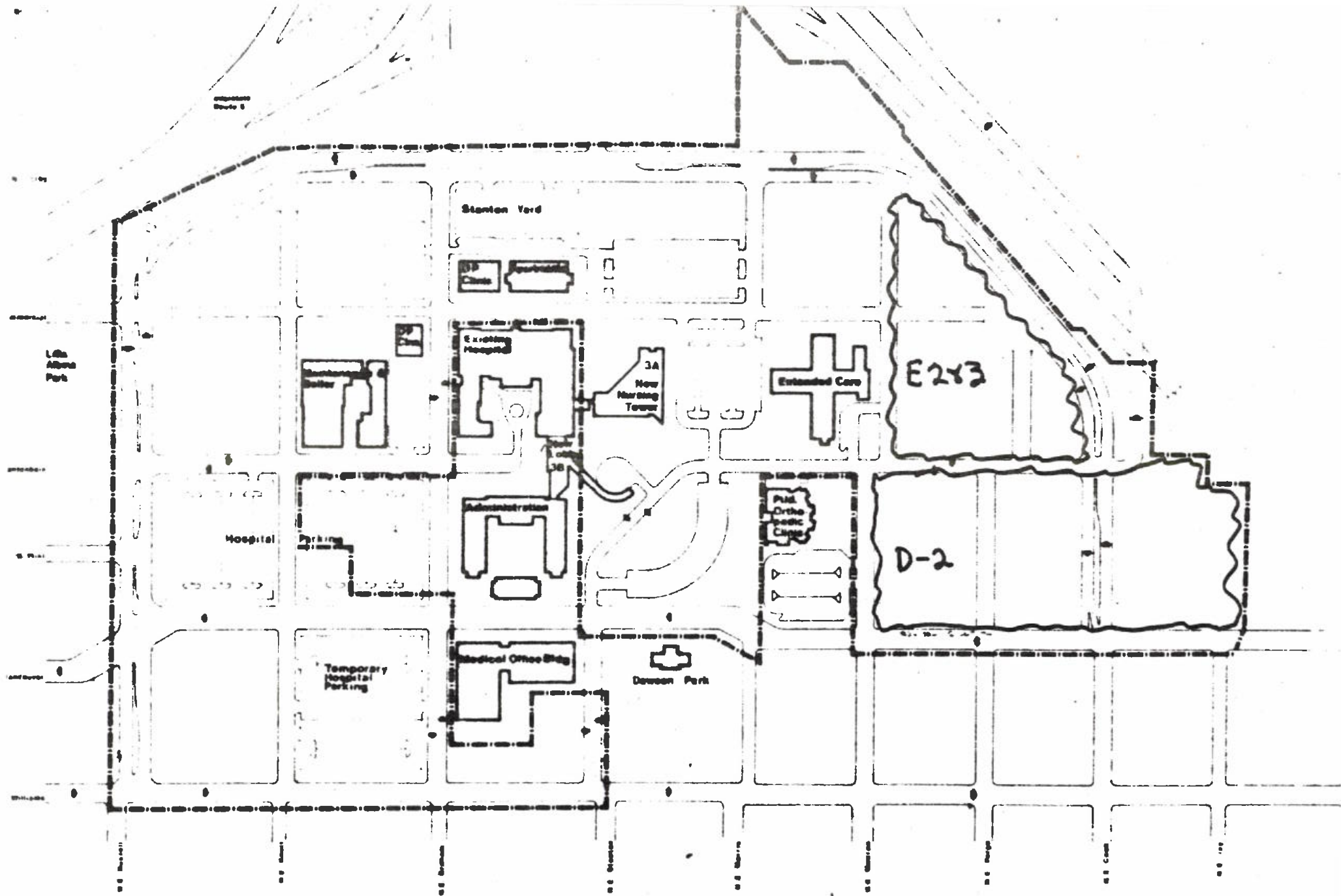

ELIOT NEIGHBORHOOD



LEGEND
Existing Bldg
New Bldg
Urban Renewal Project