

ORDINANCE NO. 126515

Recorded 4-5-68
Book 612 Page 1229

An Ordinance establishing zones in recently-annexed area in Southwest Portland west and south of Riverview Cemetery, from the Willamette River on the east to SW 11th Drive on the west, and including Lewis and Clark College, and declaring an emergency.

The City of Portland ordains:

Section 1. The Council finds that an area in Southwest Portland west and south of Riverview Cemetery, from the Willamette River on the east to SW 11th Drive on the west, and including Lewis and Clark College, has been recently annexed to the city; that in accordance with the Planning and Zoning Code, said area retains the zoning regulations of the former jurisdiction, Multnomah County, until City zoning is established; that the City Planning Commission by report dated February 1, 1968, (PC#5009) recommended adoption of certain zoning in said annexed area; that the City Auditor under date of March 8, 1968, notified all real property owners within said annexed area that the time for hearing before the City Council was fixed for 2 p.m. March 27, 1968, in the Council Chamber in the City Hall, at which time and place a hearing was held and all remonstrances made or filed against such recommended zoning were heard and considered and were overruled and are by this ordinance specifically overruled; that the classifications as hereinafter set forth will not adversely affect the peace, health, safety or convenience of the neighborhood, but will be beneficial to both the neighborhood and the general public, and should be established; now, therefore, the recently-annexed area in Southwest Portland west and south of the Riverview Cemetery, from the Willamette River on the east to SW 11th Drive on the west, and including Lewis and Clark College, shall be zoned as set forth on the following map, by this reference hereby made a part of this ordinance:

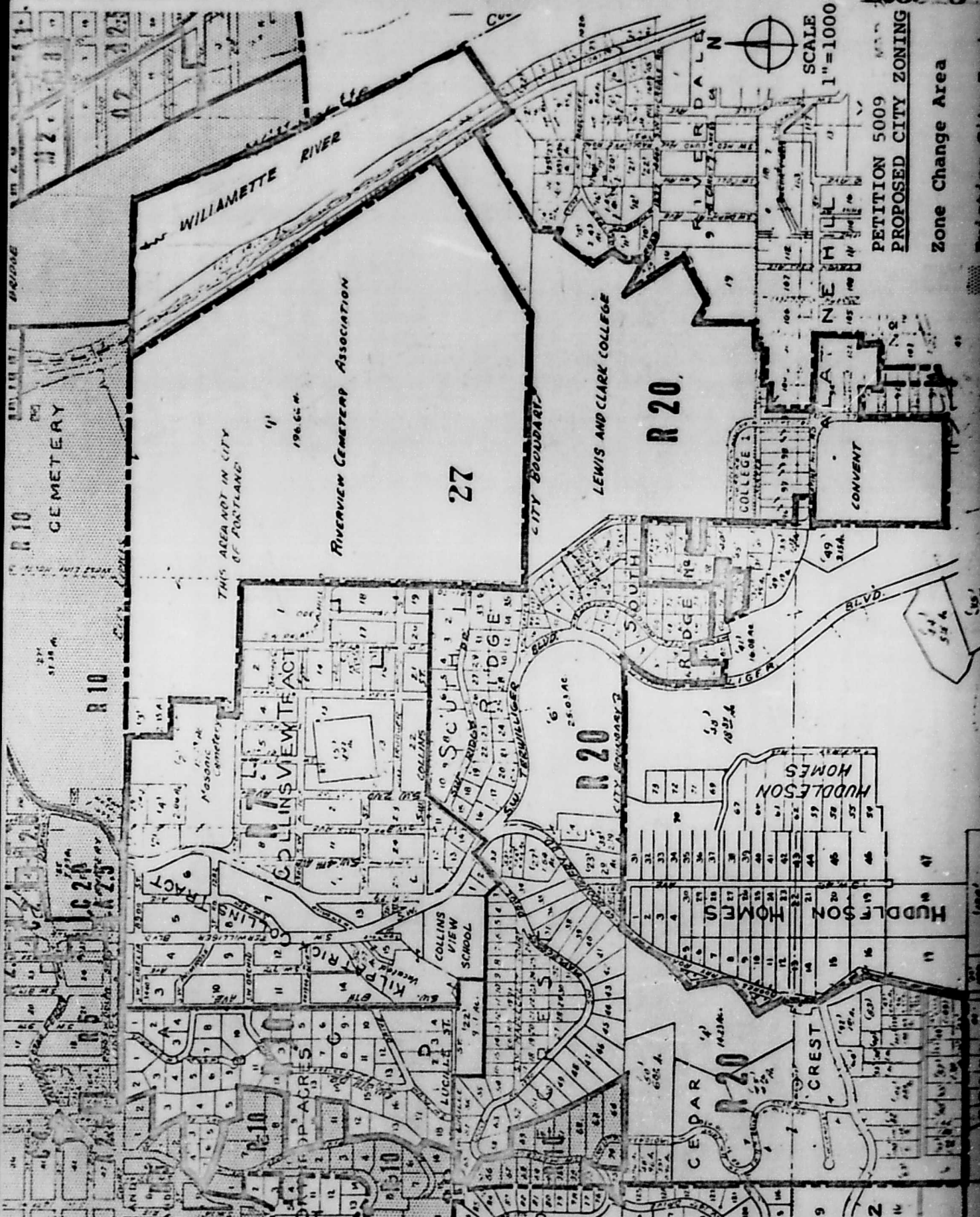

SCALE
1"=1000'

PETITION 5009
PROPOSED CITY ZONING

Zone Change Area

Existing City Zoning

ORDINANCE No.

Section 2. All requirements of the Planning and Zoning Code applicable to each zone classification, the provisions of the Building Code, and generally all other applicable code and ordinance provisions and regulations of the city of Portland, whether presently existing or hereafter enacted, shall be complied with. The City Auditor shall file a certified copy of this ordinance in the appropriate record file of Multnomah County, and thereupon the City Auditor hereby is directed to change the maps provided for in Section 6-602 of said Planning and Zoning Code by designating on said maps said property as being zoned as set forth herein.

Section 3. Inasmuch as this ordinance is necessary for the immediate preservation of the public health, peace and safety of the city of Portland in this: In order that there may be no delay in establishing zones for recently annexed areas; therefore, an emergency hereby is declared to exist and this ordinance shall be in force and effect from and after its passage by the Council.

Passed by the Council, APR 3 - 1968

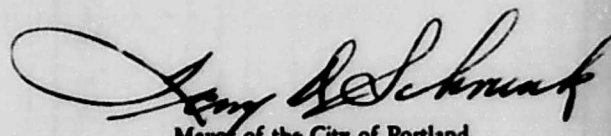
Mayor of the City of Portland

Attest:

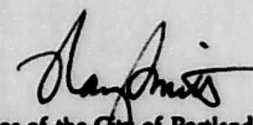
Auditor of the City of Portland

Calendar No. 1372

ORDINANCE No. 126515

Title

An Ordinance establishing zones in recently-annexed area in Southwest Portland west and south of Riverview Cemetery, from the Willamette River on the east to SW 11th Drive on the west, and including Lewis and Clark College, and declaring an emergency.

INTRODUCED BY
Order of Council

DRAWN BY
AGB:jw

Date March 29, 1968

NOTED BY THE COMMISSIONER

Affairs
Finance and
Administration

Safety

Utilities

Works

City Attorney

NOTED FOR CITY AUDITOR

R. C. H

M.C.

APPROVED

Date

By

City Engineer

Date

By

THE COMMISSIONERS VOTED AS FOLLOWS:

	Yes	Nays
Bowes	/	
Earl	/	
Grayson	/	
Ivancic	/	
Schrunk	/	

FOUR-FIFTHS CALENDAR

Bowes	
Earl	
Grayson	
Ivancic	
Schrunk	

Filed MAR 29 1968

RAY SMITH

Auditor of the CITY OF PORTLAND

By

Deputy