

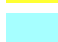



Legend

 Proposed Zone Changes

Zoning

-  Single Dwelling Resident at 5,000 (R5)
-  Resident at Mult -Dwelling 1 (RM1)
-  Resident at Mult -Dwelling 2 (RM2)
-  Resident at Mult -Dwelling 3 (RM3)
-  Commercial Mixed Use 1 (CM1)

-  Commercial Mixed Use 2 (CM2)
-  Commercial Mixed Use 3 (CM3)
-  General Employment 1 (EG1)
-  General Employment 2 (EG2)
-  Central Employment (EX)
-  General Industrial 1 (IG1)
-  Heavy Industrial (IH)

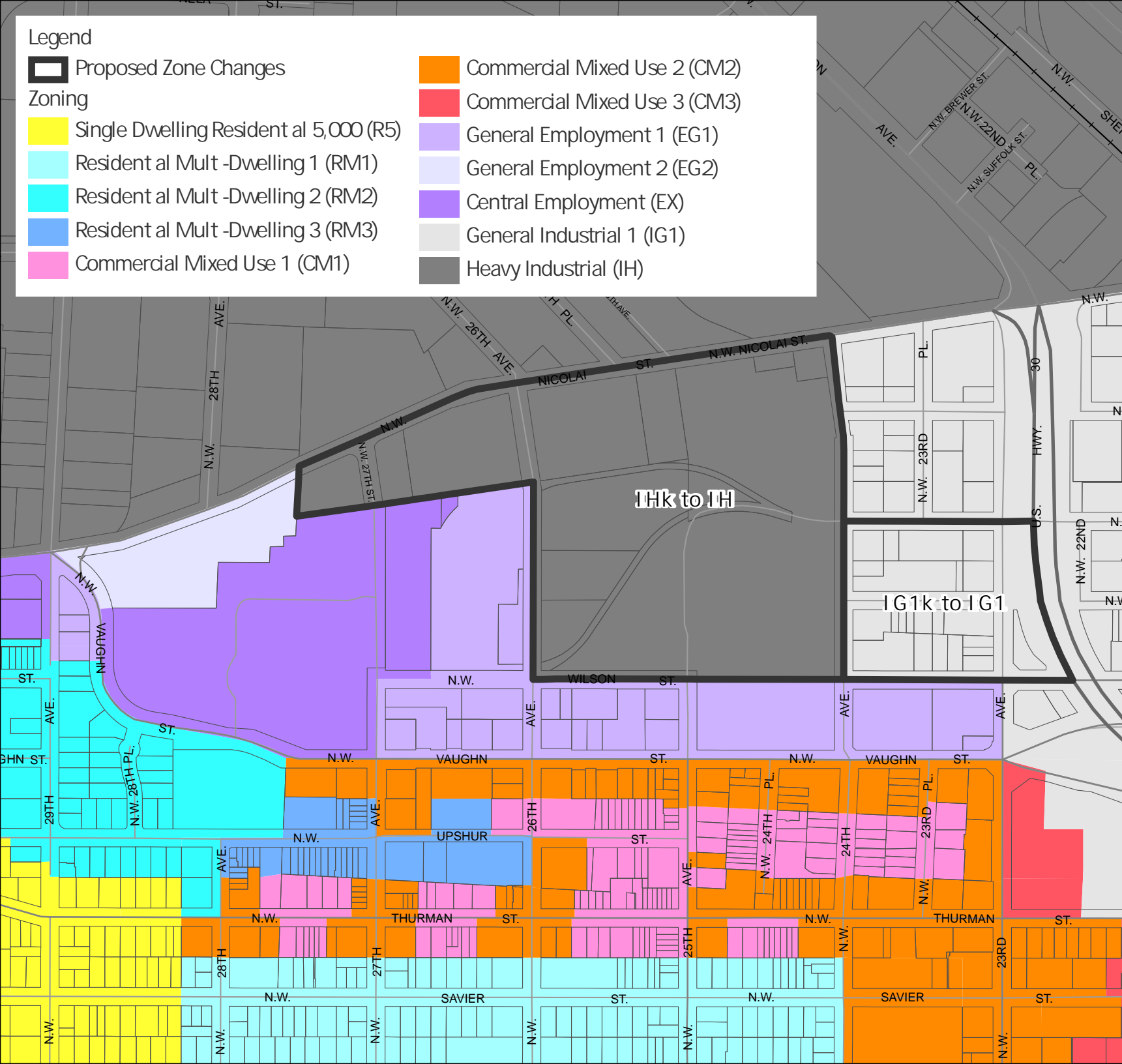

IHk to IH

IG1k to IG1

Montgomery Park to Hollywood

Northwest Plan Discussion Draft - Proposed Zoning

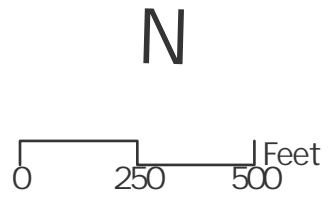

The information on this map was derived from City of Portland GIS databases. Care was taken in the creation of this map but it is provided "as is". The City of Portland cannot accept any responsibility for error, omissions or positional accuracy.

The City of Portland ensures meaningful access to city programs, services, and activities to comply with Civil Rights Title VI and ADA Title II laws and reasonably provides translation, interpretation, modifications, accommodations, alternative formats, auxiliary aids and services. To request these services, contact 503-823-7700, City TTY 503-823-6868, Relay Service: 711.



Bureau of Planning and Sustainability
 Innovation. Collaboration. Practical Solutions.



City of Portland, Oregon