

# Montgomery Park to Hollywood

## Northwest Plan Discussion Draft - Future Zoning

**Legend**

**Future Zone Changes**

- Future Zone Changes

**Future Zoning**

	Single Dwelling Resident at 5,000 (R5)		Commercial Mixed Use 2 (CM2)
	Resident al Mult -Dwelling 1 (RM1)		Commercial Mixed Use 3 (CM3)
	Resident al Mult -Dwelling 2 (RM2)		General Employment 1 (EG1)
	Resident al Mult -Dwelling 3 (RM3)		Central Employment (EX)
	Commercial Mixed Use 1 (CM1)		General Industrial 1 (IG1)
			Heavy Industrial (IH)

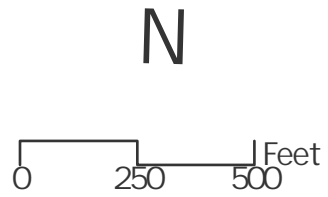
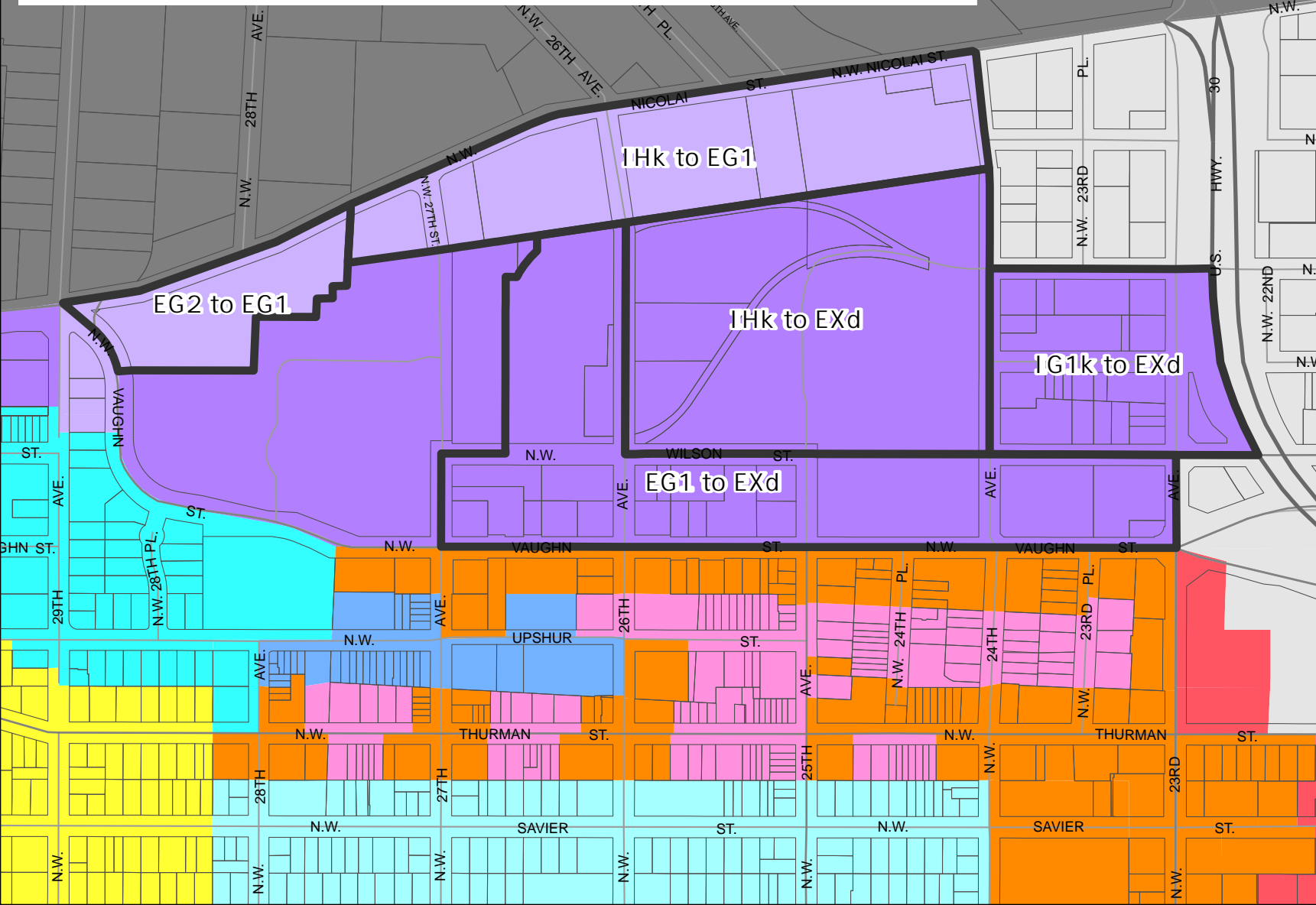

The information on this map was derived from City of Portland GIS databases. Care was taken in the creation of this map but it is provided "as is". The City of Portland cannot accept any responsibility for error, omissions or positional accuracy.

The City of Portland ensures meaningful access to city programs, services, and activities to comply with Civil Rights Title VI and ADA Title II laws and reasonably provides: translation, interpretation, modifications, accommodations, alternative formats, auxiliary aids and services. To request these services, contact 503-823-7700, City TTY 503-823-6868, Relay Service: 711.



Bureau of Planning and Sustainability  
Innovation. Collaboration. Practical Solutions.



City of Portland, Oregon