

Development Services

From Concept to Construction

Phone: 503-823-7300 Email: bds@portlandoregon.gov 1900 SW 4th Ave, Portland, OR 97201
More Contact Info (<http://www.portlandoregon.gov/bds/article/519984>)



APPEAL SUMMARY

Status: Decision Rendered

Appeal ID: 24867	Project Address: 7000 NE Airport Way
Hearing Date: 5/12/21	Appellant Name: Tara Lund
Case No.: B-007	Appellant Phone: 5032261285
Appeal Type: Building	Plans Examiner/Inspector: David Bartley
Project Type: commercial	Stories: 3 Occupancy: A-3, B, S-1 Construction Type: Type IA
Building/Business Name: Port of Portland - PDX	Fire Sprinklers: Yes - Throughout
Appeal Involves: Alteration of an existing structure	LUR or Permit Application No.: 20-124057-STR-01-MG
Plan Submitted Option: pdf [File 1]	Proposed use: Airport

APPEAL INFORMATION SHEET

Appeal item 1

Code Section	2019 OSSC Chapter 33: 3306.7 Covered Walkways
Requires	A walkway shall be provided for pedestrian travel that leads from a building entrance or exit of an occupied structure to a public way. Walkways shall be accessible in accordance with Chapter 11 and shall be designed to support all imposed loads, and the design live load shall be not less than 150 pounds per square foot (psf).
Code Modification or Alternate Requested	Proposed modification to 150 psf live load requirement as noted below.
Proposed Design	<p>Based on project-specific oversight and management of operations, personnel, and materials that will be using the proposed scaffolding, the following design live load for the overhead protection scaffold structure elements and their supporting connections is proposed to be modified as follows: not less than 150 psf over any 5'x5' (25 sf) impact area, with 25 psf outside of impact area.</p> <p>For existing terminal structure floor and roof elements supporting scaffold loading, design scaffold live load shall be not less than 150 psf for elements supporting 5 sf or less tributary scaffold area, and linearly reducing from to 150 psf at 5 sf to 25 psf at 50 sf, and maintain minimum design live load of 25 psf for larger areas.</p> <p>The scaffolding will not occur over, or impede any required means of egress, but will be over pedestrian walkways that provide access between levels as shown on attached exhibits.</p> <p>The conditions proposed in this appeal will be temporary and apply to the following scope of work: soffit demo and reinstallation, rain drain reroutes, structural reinforcements and construction of new outside air shafts at the South Terminal exit lanes and North and South Cores. Loading on the scaffolding will be limited to reduced crews of 4-5 people and the scope of work is predominantly lightweight. The scaffolding is anticipated to be in place approximately 4 months starting in May, 2021 and anticipated to finish in September, 2021. We are requesting the</p>

proposed conditions be approved as part of the Occupancy Safety Plan measures that will be implemented during the construction of the Terminal improvements.

The scaffolding work platform will be roughly 19' above enplaning floor and the area of work will range 10'-0" to 15'-0" above the work platform. The platform will have netting, guardrails and toe boards as required to meet OSHA standards. Any work that involves heavier construction elements, including movement of rain drains, will take place during the night shift with the area below vacated of all non-construction personnel.

Reason for alternative The load capacity of the scaffolding is limited by the point load capacity of the existing terminal roof and enplaning floor structure in this area. The proposed scaffolding is meant to operate as a working platform for work with limited risk of falling debris and therefore, the platform will not be subject to loads that would require overhead fall protection in the magnitude of the 150 psf live loading across large areas of the scaffold platform.

Final design of scaffolding will be submitted as an attachment to OSP.

Please see: EX1, EX2, EX3 & EX4

APPEAL DECISION

Modification to the minimum scaffold live load requirement: Granted as proposed.

The Administrative Appeal Board finds that the information submitted by the appellant demonstrates that the approved modifications or alternate methods are consistent with the intent of the code; do not lessen health, safety, accessibility, life, fire safety or structural requirements; and that special conditions unique to this project make strict application of those code sections impractical.

Pursuant to City Code Chapter 24.10, you may appeal this decision to the Building Code Board of Appeal within 90 calendar days of the date this decision is published. For information on the appeals process, go to www.portlandoregon.gov/bds/appealsinfo, call (503) 823-7300 or come in to the Development Services Center.

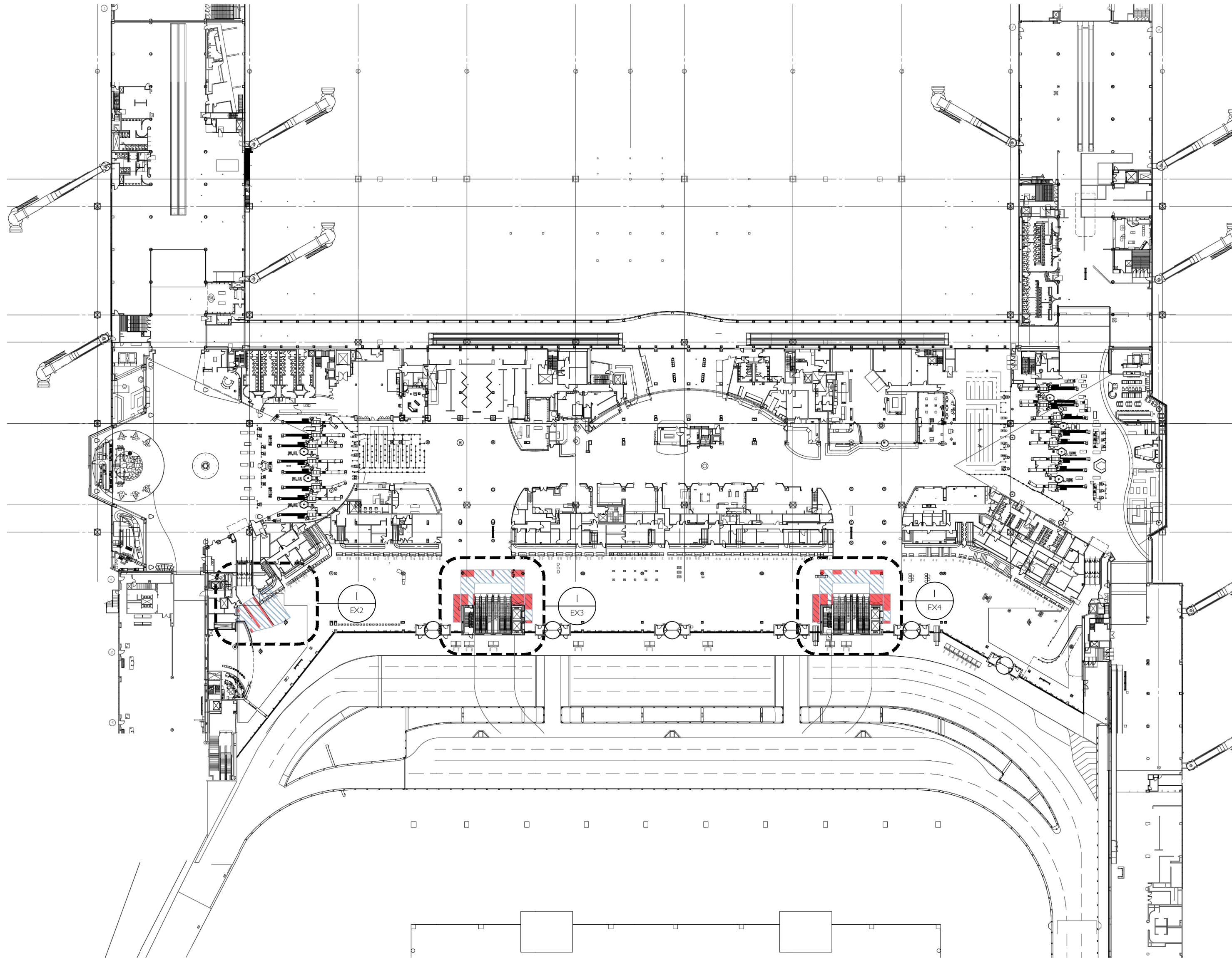

ENPLANING TERMINAL PLAN

SCALE: NTS

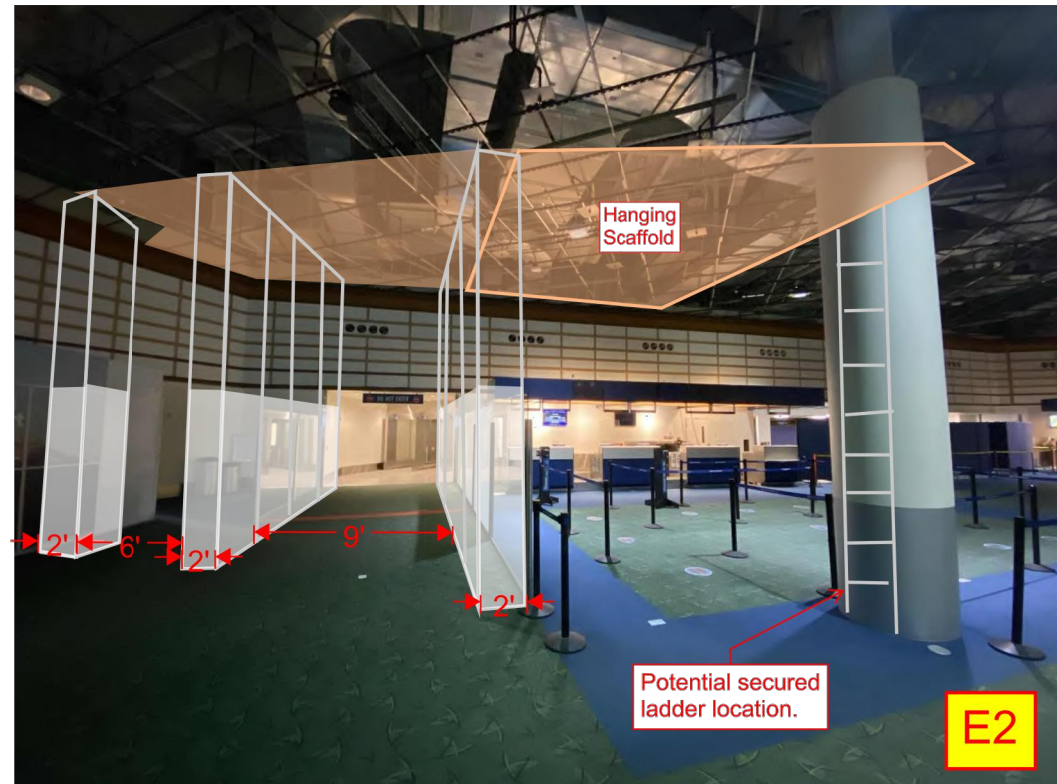
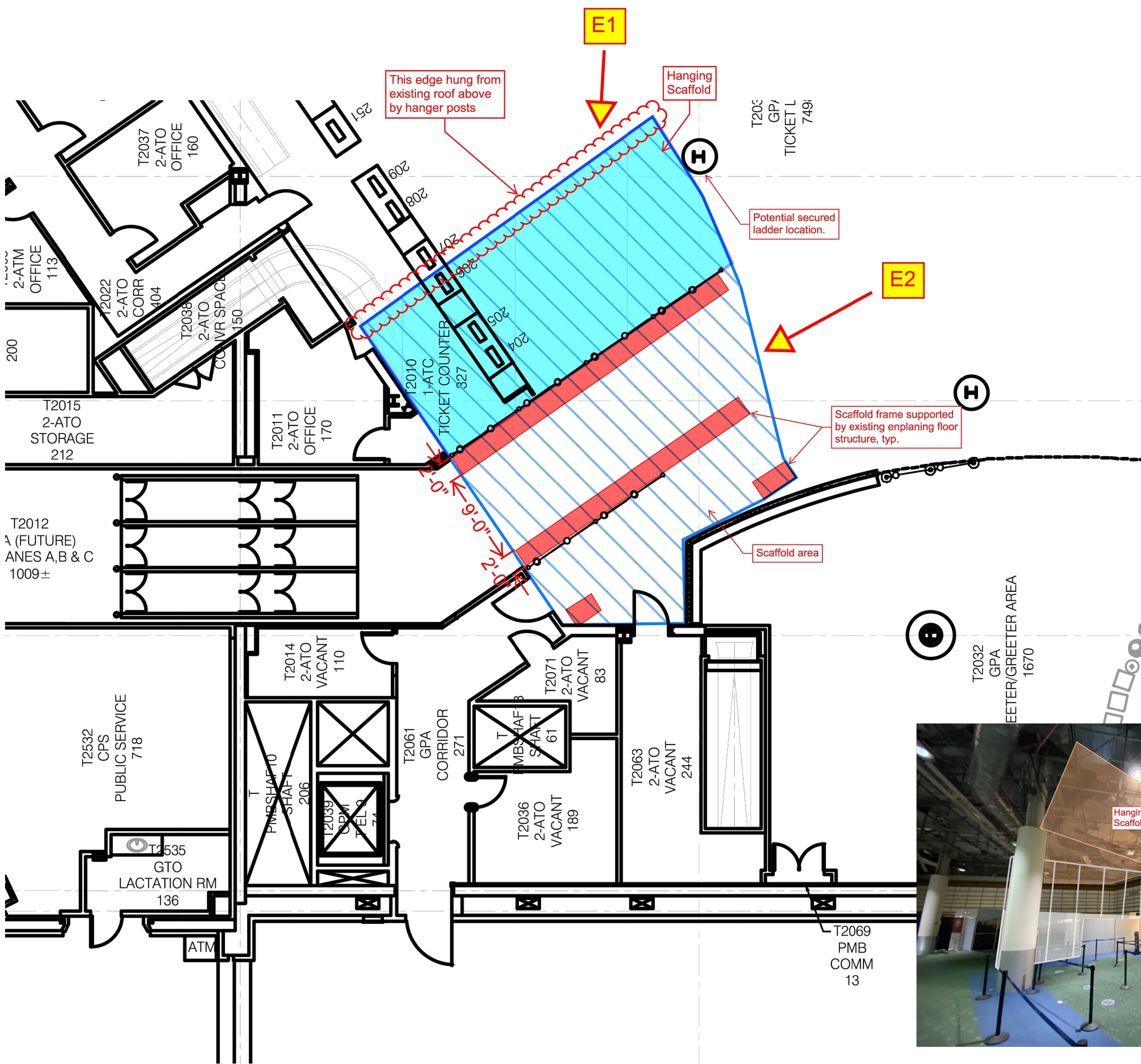

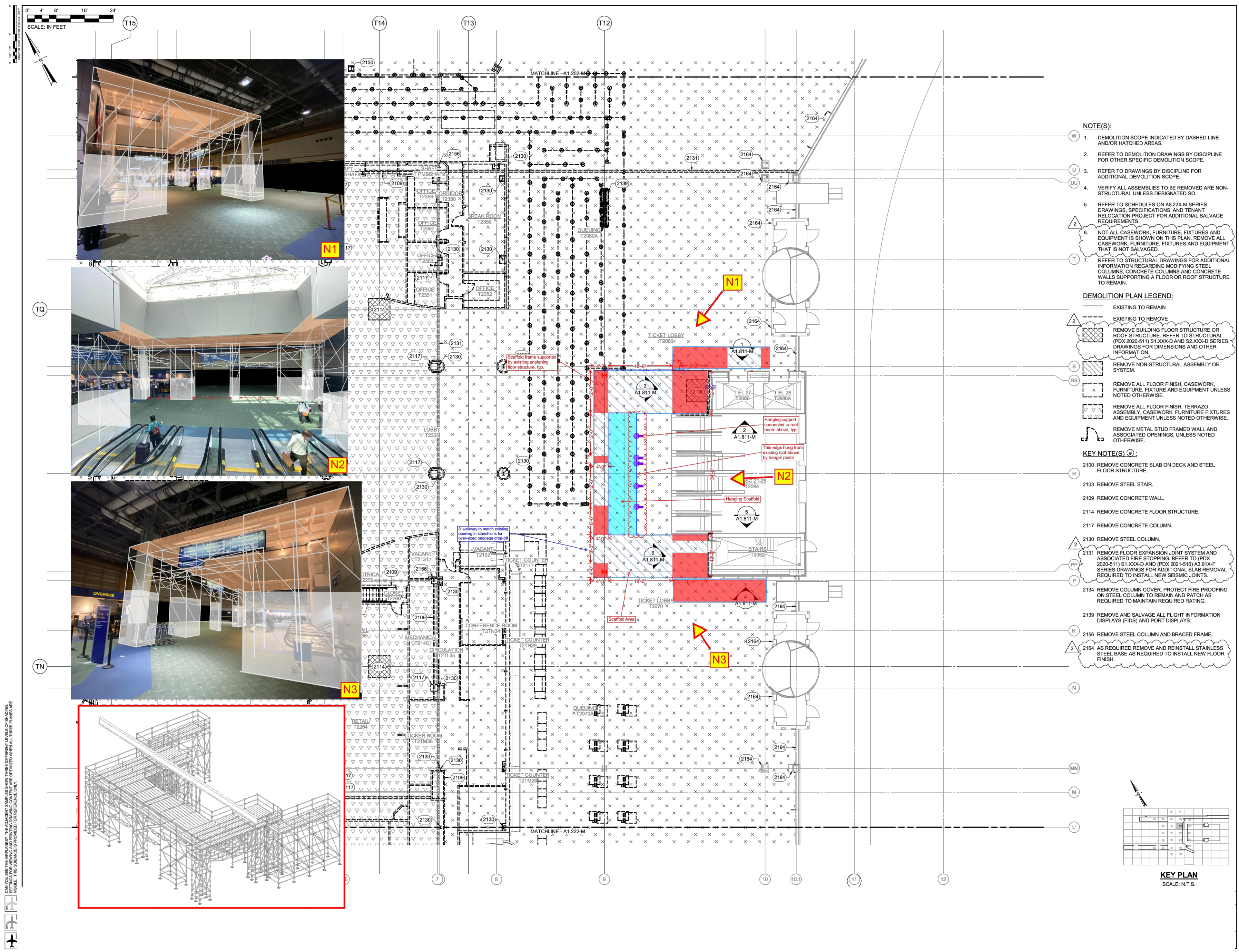

- NOTE(S):**
1. DEMOLITION SCOPE INDICATED BY DASHED LINE AND/OR HATCHED AREAS.
 2. REFER TO DEMOLITION DRAWINGS BY DISCIPLINE FOR OTHER SPECIFIC DEMOLITION SCOPE.
 3. REFER TO DRAWINGS BY DISCIPLINE FOR ADDITIONAL DEMOLITION SCOPE.
 4. VERIFY ALL ASSEMBLIES TO BE REMOVED ARE NON-STRUCTURAL UNLESS DESIGNATED SO.
 5. REFER TO SCHEDULES ON A8.22X-M SERIES DRAWINGS, SPECIFICATIONS, AND TENANT RELOCATION PROJECT FOR ADDITIONAL SALVAGE REQUIREMENTS.
 6. NOT ALL CASEWORK, FURNITURE, FIXTURES AND EQUIPMENT IS SHOWN ON THIS PLAN. REMOVE ALL CASEWORK, FURNITURE, FIXTURES AND EQUIPMENT THAT IS NOT SALVAGED.
 7. REFER TO STRUCTURAL DRAWINGS FOR ADDITIONAL INFORMATION REGARDING MODIFYING STEEL COLUMNS, CONCRETE COLUMNS AND CONCRETE WALLS SUPPORTING A FLOOR OR ROOF STRUCTURE TO REMAIN.
- DEMOLITION PLAN LEGEND:**
- EXISTING TO REMAIN
- EXISTING TO REMOVE
- REMOVE BUILDING FLOOR STRUCTURE OR ROOF STRUCTURE. REFER TO STRUCTURAL (PDX 2020-511) S1 XXX-D AND S2 XXX-D SERIES DRAWINGS FOR DIMENSIONS AND OTHER INFORMATION.
- REMOVE NON-STRUCTURAL ASSEMBLY OR SYSTEM.
- REMOVE ALL FLOOR FINISH, CASEWORK, FURNITURE, FIXTURE AND EQUIPMENT UNLESS NOTED OTHERWISE.
- REMOVE ALL FLOOR FINISH, TERRAZZO ASSEMBLY, CASEWORK, FURNITURE FIXTURES AND EQUIPMENT UNLESS NOTED OTHERWISE.
- REMOVE METAL STUD FRAMED WALL AND ASSOCIATED OPENINGS, UNLESS NOTED OTHERWISE.
- KEY NOTE(S) @:**
- 2100 REMOVE CONCRETE SLAB ON DECK AND STEEL FLOOR STRUCTURE.
- 2103 REMOVE STEEL STAIR.
- 2109 REMOVE CONCRETE WALL.
- 2114 REMOVE CONCRETE FLOOR STRUCTURE.
- 2117 REMOVE CONCRETE COLUMN.
- 2130 REMOVE STEEL COLUMN.
- 2131 REMOVE FLOOR EXPANSION JOINT SYSTEM AND ASSOCIATED FIRE STOPPING. REFER TO (PDX 2020-511) S1 XXX-D AND (PDX 2021-510) A3 91X-F SERIES DRAWINGS FOR ADDITIONAL SLAB REMOVAL REQUIRED TO INSTALL NEW SEISMIC JOINTS.
- 2134 REMOVE COLUMN COVER. PROTECT FIRE PROOFING ON STEEL COLUMN TO REMAIN AND PATCH AS REQUIRED TO MAINTAIN REQUIRED RATING.
- 2139 REMOVE AND SALVAGE ALL FLIGHT INFORMATION DISPLAYS (FIDS) AND PORT DISPLAYS.
- 2156 REMOVE STEEL COLUMN AND BRACED FRAME.
- 2164 AS REQUIRED REMOVE AND REINSTALL STAINLESS STEEL BASE AS REQUIRED TO INSTALL NEW FLOOR FINISH.

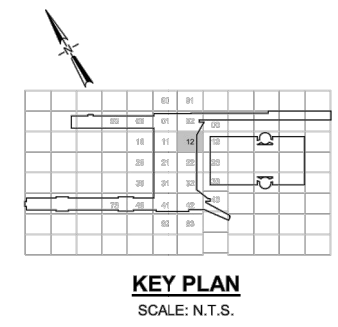

DO NOT USE THE AREA WHERE THE ARCHITECT HAS SHOWN THESE DIFFERENT LINES OF WORK. SETTING FOR VIEWING AND PRINTING DRAWINGS CONTENT ARE OPTIMIZED WHEN ALL THESE RANGES ARE VISIBLE. THE GUIDANCE IS PROVIDED FOR REFERENCE ONLY.