

Portland Curbsider

Bureau of Planning and Sustainability

July 2021 – June 2022

Keep this Curbsider - the next one comes out June 2022

Your Guide to BIN BASICS

You'll find the key things you need to know about garbage and recycling in this Curbsider, so hold on to it for reference. Many Portlanders keep the recycling guide and schedule on their fridge, inside a cupboard door, or in their garage, so it's easy to double check.

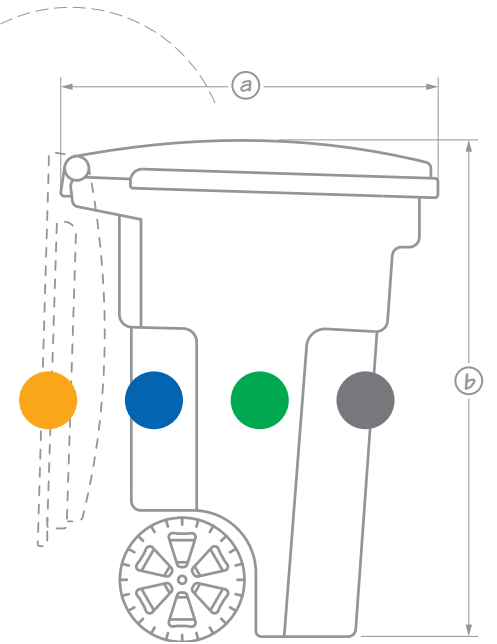

HOW TO SET OUT YOUR BINS

Make it easy for collection drivers to empty your bins.

Place all bins within 3 feet of the curb. Leave space between cars, trees, poles, and other bins. Roll cart handles should face your home, not the street. Lids should be closed.



WHAT TO DO WITH EXTRAS

Can't fit it all in your bin?

Set out extra garbage, yard waste, and holiday trees for a small fee. Flatten and cut cardboard to fit in recycling bin; when full, extra cardboard can be flattened and set next to bin.

For large items, call your garbage company for a cost estimate and pickup date before setting out.

Renters: Ask your landlord before setting out extra items with fees.



If your bin is full, flatten extra cardboard and set next to bin.

Set holiday trees and extra yard waste bags/bundles next to your compost bin.

Call your garbage company before setting out large items. Put extra garbage bags next to garbage bin.

WHERE TO TAKE THE OTHER STUFF

The following things must be dropped off for safe disposal and cannot go in any of your bins. Find your closest drop-off location at the links below. For information on any item you're unsure about call 503-234-3000 or go to www.oregonmetro.gov/findarecycler.

- **Electronics** | TVs, computers, monitors, printers, keyboards, and mice: www.oregonecycles.org
- **Hazardous waste** | Old cleaning supplies, propane tanks, flammable items, and more: 503-234-3000 or www.oregonmetro.gov/askmetro
- **Batteries & CFL bulbs** | Batteries, things with batteries in them, and fluorescent light bulbs (LED and incandescent bulbs can go in the garbage): www.oregonmetro.gov/findarecycler
- **Medications** | Leftover or expired drugs: www.ordeq.org/drugtakeback

Find all of this information and more at www.portland.gov/garbage-recycling

2021-2022 COLLECTION SCHEDULE

Look up your collection day
www.portland.gov/garbage-day

JULY 2021

S	M	T	W	T	F	S
				1	2	3
4	5*	6*	7*	8*	9*	10
11	12	13	14	15	16	17
18	19	20	21	22	23	24
25	26	27	28	29	30	31

AUGUST 2021

S	M	T	W	T	F	S
1	2*	3*	4*	5*	6*	7
8	9	10	11	12	13	14
15	16	17	18	19	20	21
22	23	24	25	26	27	28
29	30*	31*				

SEPTEMBER 2021

S	M	T	W	T	F	S
			1*	2*	3*	4
5	6	7	8	9	10	11
12	13	14	15	16	17	18
19	20	21	22	23	24	25
26	27*	28*	29*	30*		

OCTOBER 2021

S	M	T	W	T	F	S
					1*	2
3	4	5	6	7	8	9
10	11	12	13	14	15	16
17	18	19	20	21	22	23
24	25*	26*	27*	28*	29*	30
31						

NOVEMBER 2021

S	M	T	W	T	F	S
	1	2	3	4	5	6
7	8	9	10	11	12	13
14	15	16	17	18	19	20
21	22*	23*	24*	25*	26*	27
28	29	30				

DECEMBER 2021

S	M	T	W	T	F	S
			1	2	3	4
5	6	7	8	9	10	11
12	13	14	15	16	17	18
19	20*	21*	22*	23*	24*	25
26	27	28	29	30	31	

JANUARY 2022

S	M	T	W	T	F	S
						1
2	3	4	5	6	7	8
9	10	11	12	13	14	15
16	17*	18*	19*	20*	21*	22
23	24	25	26	27	28	29
30	31					

FEBRUARY 2022

S	M	T	W	T	F	S
		1	2	3	4	5
6	7	8	9	10	11	12
13	14*	15*	16*	17*	18*	19
20	21	22	23	24	25	26
27	28					

MARCH 2022

S	M	T	W	T	F	S
		1	2	3	4	5
6	7	8	9	10	11	12
13	14*	15*	16*	17*	18*	19
20	21	22	23	24	25	26
27	28	29	30	31		

APRIL 2022

S	M	T	W	T	F	S
					1	2
3	4	5	6	7	8	9
10	11*	12*	13*	14*	15*	16
19	18	19	20	21	22	23
24	25	26	27	28	29	30

MAY 2022

S	M	T	W	T	F	S
1	2	3	4	5	6	7
8	9*	10*	11*	12*	13*	14
15	16	17	18	19	20	21
22	23	24	25	26	27	28
29	30	31				

JUNE 2022

S	M	T	W	T	F	S
			1	2	3	4
5	6*	7*	8*	9*	10*	11
12	13	14	15	16	17	18
19	20	21	22	23	24	25
26	27	28	29	30		



Garbage is picked up every other week on the **orange** days.

* Customers with every-four-week pickup indicated with an asterisk.



Recycling, compost, and glass bins are picked up **every week**.



Make sure your bins are at the curb before 6 a.m. to avoid missing a pickup. Bring them back to your house within 24 hours after collection.

COLLECTION REMINDERS

- **Get a garbage day reminder.** Join the 30,000+ Portlanders who get day-before email reminders of which bins to set out at the curb. Sign up at www.garbage-day-reminders.com.
- **No holiday delays this year.** Garbage and recycling companies pick up all days, even holidays. The only exception is Christmas and New Year's Day, but those fall on Saturdays this year.
- **Snow, ice, or smoke delays.** In case of hazardous driving conditions, like ice, snow, or heavy wildfire smoke, your pickup may be delayed. Leave your bins at the curb and they will be emptied as soon as it's safe to do so.

GARBAGE

RECYCLE

COMPOST

GLASS



GARBAGE

Coffee cups/lids/pods, paper/plastic plates, take-out food containers/wrappers, drink cups/straws, cutlery, frozen food packaging/trays, plastic caps/lids, plastic bags, facial tissue, wipes (all), painted/stained wood, plywood, incandescent light bulbs, garden hoses, fireworks (soak in water first).



MUST BE BAGGED

Pet waste, cat litter, diapers, feminine hygiene products, ashes, sawdust, packaging peanuts, broken glass, disposable gloves and masks.



PUT IN SEALED CONTAINER

Put kitchen fats/oil/grease in sealed container before putting in garbage.



PLASTIC

Bottles with a neck (6 oz or larger), plastic round containers (6 oz or larger), plant pots (4" diameter or larger), buckets (5 gal or smaller).



METAL

Aluminum, tin and steel food cans, empty dry metal paint cans, empty aerosol cans, aluminum foil, scrap metal (shorter than 30" long and less than 30 lbs).



PAPER

Newspapers, magazines, catalogs, phone books, flattened cardboard boxes, scrap paper, cartons (milk, juice, soup), shredded paper (in paper bag).



FOOD SCRAPS

Meat, poultry, seafood, bones, cheese, eggshells, bread, pasta, grains, beans, nuts, fruits, vegetables, coffee grounds, spoiled food.



YARD WASTE

Weeds, leaves, vines, grass, small branches, flowers, house plants, plant clippings.



OTHER

Paper napkins, paper towels, coffee filters, tea bags, pizza delivery boxes.



GLASS

Place in yellow bin or other plastic container with a "glass only" sticker.



JARS & BOTTLES

All colors of glass. Labels are OK too.



DEPOSIT BOTTLES

Redeem at BottleDrop Centers or recycle at the curb.

MOTOR OIL Put in a clear plastic jug with lid and place next to bins for recycling.



NO: Computers, monitors, TVs, batteries, compact fluorescent lightbulbs (CFLs), hazardous waste, chemicals, batteries (Call for disposal options: 503-234-3000).



NO: Plastic bags, plastic caps/lids, diapers, propane cylinders, coffee cups/lids/pods, take-out containers, styrofoam, containers under 6 oz, medicine bottles.



NO: "Compostable"/"Biodegradable" containers, household garbage, pet waste, diapers, plastic bags, lumber, dirt, ashes, rocks, branches larger than 4" thick and 36" long.



NO: Light bulbs, drinking glasses, vases, broken glass, ceramics, Pyrex.



PARTNER MESSAGES

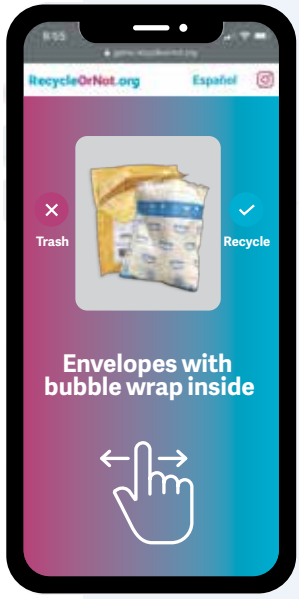

SWIPE RIGHT TO RECYCLE

Test your recycling skills with a new game made for the greater Portland area.

Hint:

Swipe left on plastic-padded envelopes, they go in the trash!

Play the game!

www.RecycleOrNot.org

Juegue el juego!

www.ReciclarONo.org

HELP CLEAN UP PORTLAND

Volunteer litter cleanups happen all around the city, all year round! Sign up for one, or organize your own for friends, neighbors or coworkers with SOLVE's free supplies and planning support.

Find an event or plan your own at

www.solveoregon.org.

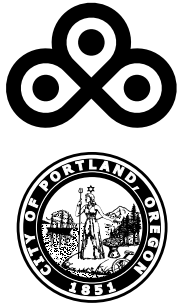

THE BUREAU OF PLANNING & SUSTAINABILITY

1810 SW 5th Ave, Ste 710, Portland, OR 97201
www.portland.gov/bps | 503-823-7202

[facebook.com/PortlandBPS](https://www.facebook.com/PortlandBPS)
twitter.com/PortlandBPS

PRSR STD
US POSTAGE
PAID
PORTLAND OR
PERMIT NO 653

FIND INSIDE >>>>

Recycling guide and
12-month garbage schedule:
Save until June 2022

Portland Curbsider

RATE CHANGES

GARBAGE BILLS INCREASE JULY 1

Residential garbage bills will go up starting July 1, 2021. The change is primarily due to higher regionwide garbage disposal fees, as well as the larger amounts of garbage, recycling, yard waste and food scraps collected from households.

Find the new rates at

www.portland.gov/garbage-rates

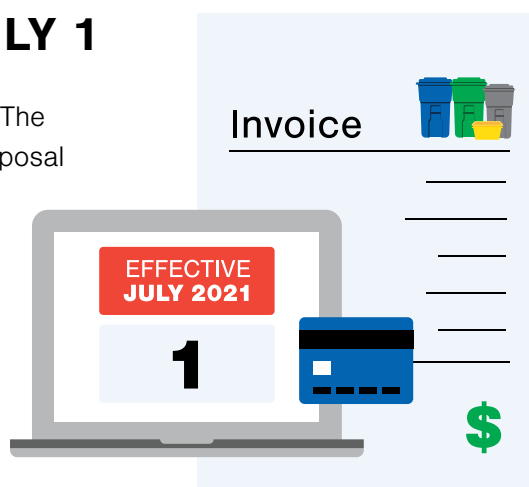

See new garbage rates at:

Nuevas tarifas disponibles en:

Bảng giá mới có sẵn tại:

在这里可以查看新的费率:

Новые расценки см. по адресу

Qiimayaasha qashinka cusub ka eeg:

Нові тарифи за вивіз сміття:

Noile prețuri sunt disponibile la:

नयाँ दरहरू नमिन्मा उपलब्ध छन्:

Ekewe minafon rates mi kawor ren:

www.portland.gov/garbage-rates

The City of Portland is committed to providing meaningful access. To request translation, interpretation, modifications, accommodations, or other auxiliary aids or services, contact 503-823-7700, Relay: 711.

Traducción e Interpretación | Biên Dịch và Thông Dịch | अनुवादन तथा व्याख्या | 口笔译服务 | Устный и письменный перевод | Turjumaad iyo Fasiraad |
Письмовий і усний переклад | Traducere și interpretariat | Chiaku me Awewen Kapas | 翻訳または通訳 | ການແປພາສາ ຫຼື ການອະທິບາຍ | أديفشلل وأ أديريرحلتلأ قمجرتلأ

503-823-7700 | www.portland.gov/bps/accommodation