



# 19-247351-REV-01-CO

## City of Portland, Oregon - Bureau of Development Services

1900 SW Fourth Avenue • Portland, Oregon 97201 | 503-823-7300 | [www.portlandoregon.gov/bds](http://www.portlandoregon.gov/bds)

### Permit Revision Submittal Requirements and Application

A Permit Revision is required when there are proposed changes to the project after the permit has been issued. This may arise due to discrepancies between the city-approved permit drawings and actual field conditions, or the customer has changed their mind about an aspect of the project. In all cases, a revision to the existing permit must be submitted, reviewed and approved.

#### Applicants will provide:

- ☒ A copy of this application
- ☒ Three (3) sets of plans that clearly reflect the proposed change(s).  
Drawings and calculations must be stamped and signed by the Architect and/or the Engineer of Record, if applicable.

- ☐ One (1) copy of the original city approved permit drawings. (NOTE: If your project has an assigned process manager please contact them regarding submittal of the revision).
- ☐ Two (2) sets of calculations, if applicable
- ☐ Inspector's correction notice, if revision is due to an inspection correction
- ☐ Revision fee (paid at time of submittal)

#### Contact Information:

Contact name Josh Lighthipe, KPFF  
 Address 111 SW 5th Avenue, Suite 2600  
 City Portland State Oregon Zip Code 97204  
 Phone 503-542-3840 Email josh.lighthipe@kpff.com  
 Value of proposed revision \$0 Issued permit # 19-247351-GRD-01-CO  
 Job site address 5828 N Van Houten Pl  
 Description of revision Revised work area on Erosion and Sediment Control Plan for Preload Area (Sheet C1.0A-d). Revision requested by erosion control inspector.

#### Fees:

The Permit Revisions are subject to fees associated with plan review, processing and any increase in project value. Additional fees may apply if adding plumbing fixtures.

The Bureau of Development Services fee schedule is available under the fees tab on the BDS web site at: [www.portlandoregon.gov/bds](http://www.portlandoregon.gov/bds). Fees are updated annually on July 1st.

#### Helpful Information:

**Bureau of Development Services**  
 City of Portland, Oregon  
 1900 SW 4th Avenue, Portland, OR 97201  
[www.portlandoregon.gov/bds](http://www.portlandoregon.gov/bds)

#### Submit your plans in person to:

Development Services Center (DSC), First Floor,  
 For Hours Call 503-823-7310

#### Important Telephone Numbers:

BDS main number .....503-823-7300  
 DSC automated information line .....503-823-7310  
 Building code information .....503-823-1456  
 BDS 24 hour inspection request line .....503-823-7000  
 Residential information for  
 one and two family dwelling .....503-823-7388  
 General Permit Processing and  
 Fee Estimate info .....503-823-7357  
 City of Portland TTY .....503-823-6868



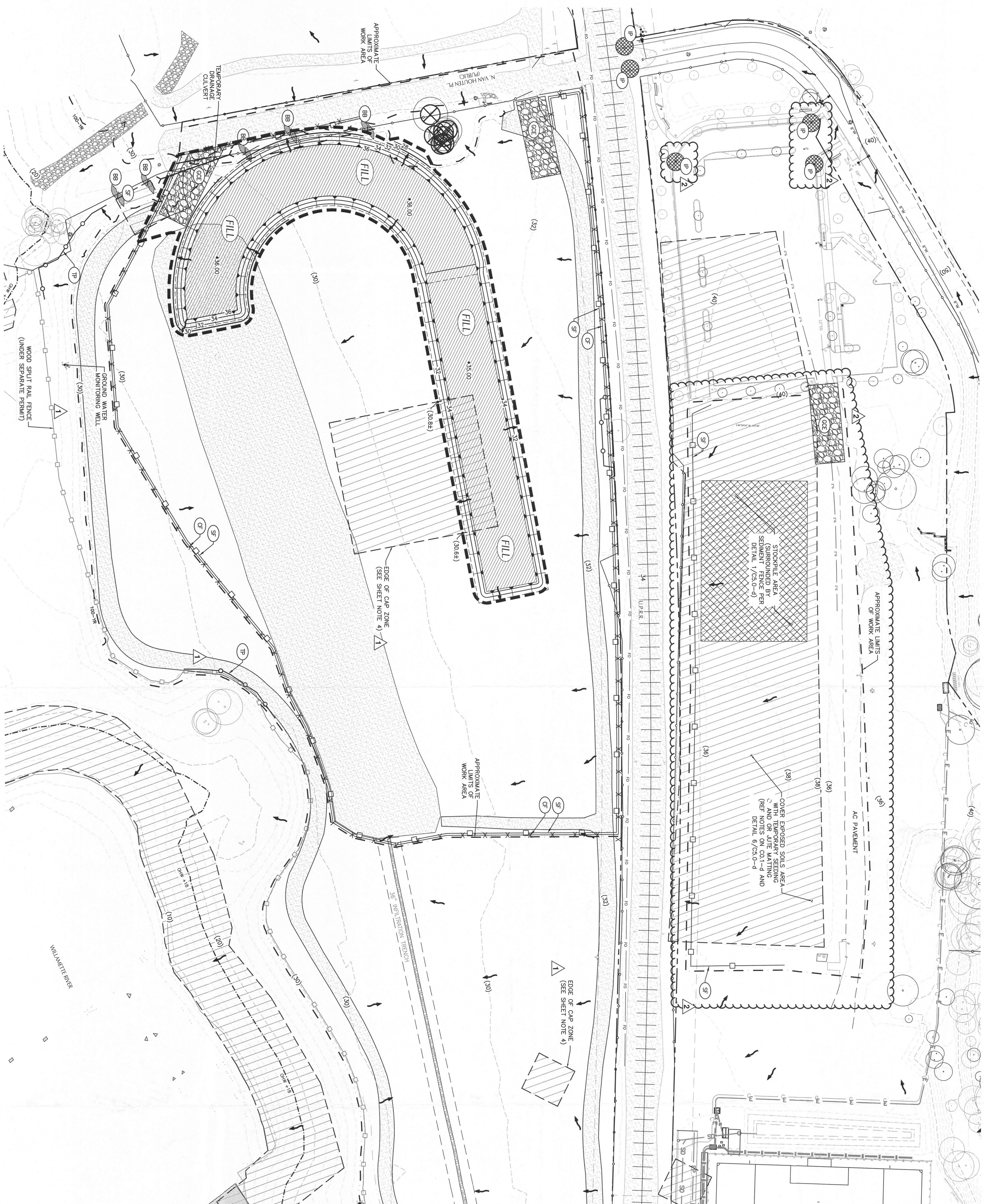

SEE SHEET C0.2-d FOR LEGENDS AND NOTES

ANY FIELD CHANGES SHALL BE IN SUBSTANTIAL CONFORMANCE WITH APPROVED LU 19000-1000 EN GW EXHIBITS C.6 THROUGH C.41.

19-247351-REV-01-C0

ScotN

## SHEET NOTES

1. SEE CO-1-4 AND CO-2-6 FOR 1200-C NOTES AND PLAN LEGEND.
2. GRADING PLAN BASED UPON ANTICIPATED CONTOURS AT THE COMPLETION OF PRELOD EARTHWORK.
3. SOME EROSION CONTROL ITEMS ARE SHOWN OFFSET FOR CLARITY.
4. CAP ZONES IN AREAS EXPOSED TO EARTHWORK SHALL HAVE METAL STAKES WITH RED TAPE FLAGS INSTALLED AT ALL CORNERS AND EVERY 100'.

City of Portland  
BUREAU FOR CODE COMPLIANCE  
FEB - 4 2020  
Permit Number

[illegible]