

3705 SW DOSCH CT.

RS01-140889

RS.01.140889

E

SEP 10 2002
MICROFILMED

2



PORTLAND, OREGON
OFFICE OF PLANNING AND DEVELOPMENT REVIEW
PO Box 8120
Portland, OR 97207-8120



LIFE SAFETY CHECKSHEET

Review Date: June 15, 2001

Application #: 01-140889-000-00-RS
IVR #: 2103497

To:	OWNER	TIMOTHY W HELTZEL 3705 SW DOSCH CT PORTLAND, OR 97221-4137	
-----	-------	--	--

From:	PLANS EXAMINER	JERRY ENGELHARDT	Phone: 503-823-7534 Fax: 503 823-7692 e-mail: engelhardtj@ci.portland.or.us
-------	----------------	------------------	---

cc:	OWNER	TIMOTHY W HELTZEL & ELLEN E HELTZEL 3705 SW DOSCH CT PORTLAND, OR 97221-4137	
-----	-------	--	--

PROJECT INFORMATION

Street Address:	3705 SW DOSCH CT					
Description of Work:	Permit to legalize ELEVATED TRAIL STRUCTURE, WALKWAY that was built ON ADJACENT VACANT LOT (1S1E08BD 12700) owned by Mr. Timothy Heltzel. SEE 00-155524-CC					
The following assumptions were made when reviewing your project:						
Occupancy group	Construction Type	Square Footage	Stories	Sprinklers	Alarms	Detection
U2	V-N	N/A	N/A	N/A	N/A	N/A

PLAN REVIEW

Based on the plans submitted, the following items appear to be missing or not in conformance with: ☐ Oregon Structural Specialty Code OR ☐ Oregon 1&2 Family Dwelling Specialty Code, and/or other city, state, or federal requirements:

Item #	Location on plans	Code Section	Clarification / Correction Required
1		315.3 315.4	All portions of the walkway that are over 30 inches above the adjacent ground surface are to be equipped with code-complying guardrails that extend at least 36 above the walking surface and have intermediate members spaced so that a 4 inch sphere cannot pass through. Indicate on the plans that these guardrails and intermediates will be added to the walkway structures. Show the details for construction and attachment of these guardrails.
2			Show the type and size of fasteners used to connect the various members of this structure.

- To respond to this checksheet, visit Document Services (the second floor of 1000 City Hall between 7:30 a.m. and 3:00 p.m.) and update all four sets of the originally submitted drawings. To update your drawings, you may either replace the original sheets with new sheets, or edit the originally submitted sheets. (Specific instructions for updating plans are posted in Document Services.)

Please complete the attached Checksheet Response Form and include it with your re-submittal.

If you have specific questions concerning this Checksheet, please call me at 503-823-7534. To check the status of your project, please call 503 823-7000 and select option 4. Your Plan Review Status will be faxed to you, so please be ready to provide a fax number. If you don't have a fax number you may dial 503 823-7357 to request a Plan Review Status or visit Document Services.

You may receive separate Checksheets from other City agencies that will require separate responses.

Life Safety Checksheet Response

Permit #: 01-140889-000-00-RS

Date: 9/5/01

Customer name and phone number: _____

Note: In the spaces below, please provide specific information concerning the changes that you have made in response to the checklist. Note the checklist item number, your response or a description of the revision, and the location of the change on the plans (i.e. page number and/or detail number). Use as many lines as needed. *If the item is not in response to a checklist, write "Applicant" in the column labeled "Checksheet item number."*

[illegible]

Plan Bin Location: FILE

BY _____ DATE _____
 TPKU MY _____ DATE _____

SUBJECT Plan Showing Walkways
Lot H Tuckerm View Park
City of Portland Multnomah Co.

SHEET NO. 1 OF 3
 JOB NO. _____
 Scale 1"=60'

MICRO (2)

City of Portland
 Office of Planning
 and Development Review
*No Engineering Review Required
 per Chapter 51A-0201*
 By Registration Date 06/15/2001
 Approved by _____
 Planning and Zoning Review

Planning & Zoning Note:
 All Future Activities/Development
 are subject to 33.430 and
 any other applicable zoning
 regulations.

Sweet break D.R.

3705 SW Dosch Ct.
 City of Portland
 APPROVED
 SEP 21 2001
 01-140889-RS
 Permit Number

Condition #1
 11 segments

Condition 2
 4 segments

Hand Sign

40'±

Overall Length 87'-6"

Hand Sign

#2

Overall Length 46'

Adjacent Residence
 3705 Dosch Ct

Trail

370.04'

01-140889-RS

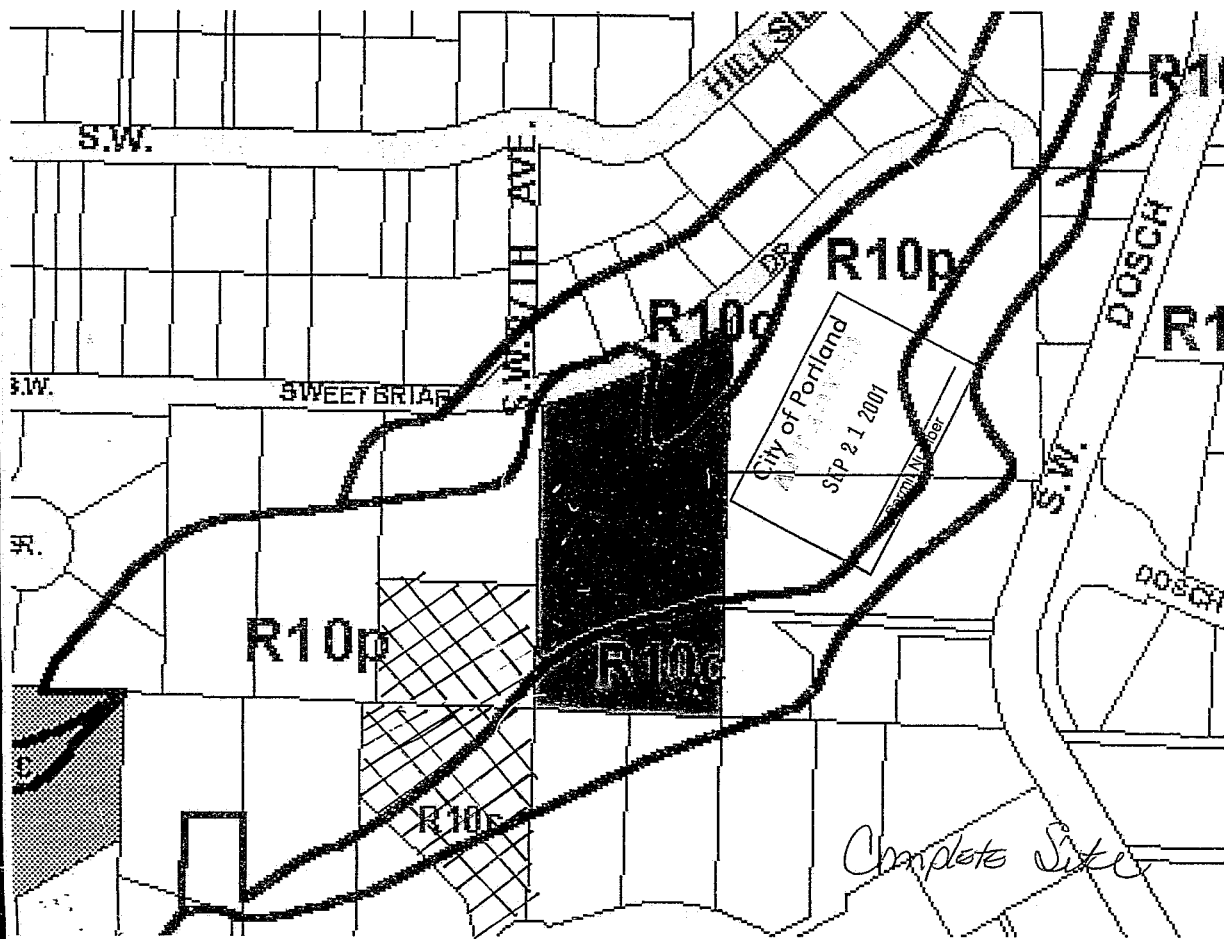

S.W.

HILLS

R1

S.W. HIGH AVE.

R10p

R10c

R1

S.W.

SWEETBRIAR

City of Portland
SEP 21 2001

R.

S.W. DOSCH

R10p

R10c

DOSCH

R10s

Complete Site



CITY OF

PORTLAND, OREGON

OFFICE OF PLANNING AND DEVELOPMENT REVIEW

1900 S.W. 4th Avenue, Suite 5000
Portland, Oregon 97201
(503) 823-7300
FAX: (503) 823-6983
TDD: (503) 823-6868
<http://www.opdr.ci.portland.or.us>

May 1, 2001

Timothy and Ellen Heltzal
3705 S.W. Dosch Court
Portland, Oregon 97221-4137

Re: **3705 S.W. Dosch Court**
Tax Acct. No. R-847000420
Case No. 00-155524-CC
PERMIT AND APPROVED INSPECTION REQUIREMENTS

Thank you for coming to our office yesterday to discuss your case. As per our discussion, a building permit is required to legalize the existing walkway structures. However, an environmental review is not required, assuming the width of trail structures do not exceed 30". Please present this letter to the permit center intake person to substantiate the appropriate scope of your permit.

I would encourage you to prepare all requisite plans as soon as possible. Penalty fees may be suspended upon DSC's acceptance of plans for review and approval. Penalties may be suspended for the duration of the permit assuming prompt payment of permit fees and regular approved inspections.

I have enclosed a copy of a brochure that may be useful in developing your plans. Please do not hesitate to contact me if I may be of assistance in expediting the resolution of this matter.

Regards,

David Meltzer
Code Specialist II
Code Compliance
(503)823-7047

c: Time File
Enclosure(s): 1

F:\Meltzer_D\CC CORRESPONDENCE\3705 SW DOSCH - PROGRESS LETTER.doc

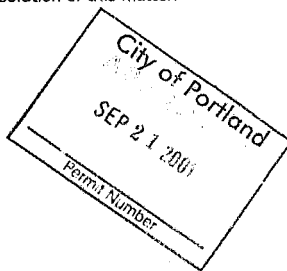
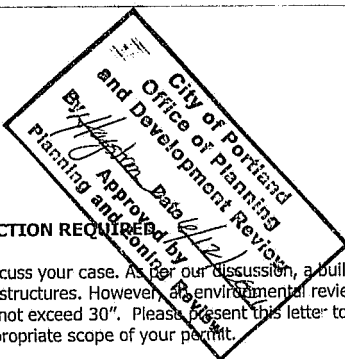

BY... DATE...
CHKD. BY... DATE...

SUBJECT Plan Showing Walkways
Lot H Tract in View Park
City of Pe Multnomah Co.

SHEET NO. 1 OF 3
JOB NO. _____
Scale 1" = 40'

RECEIVED
SEP 21 2001

OFDR
DOCUMENT SERVICES

S.W. Street Bridge Dr.

Hand railings are placed where
even trail height exceeds
30" from the existing terrain

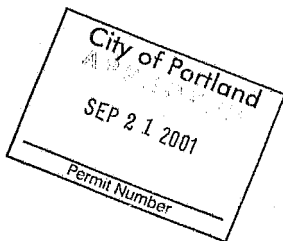

Added
Railing

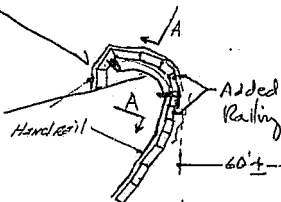

426.16'

#2

Overall Length 37'-6"

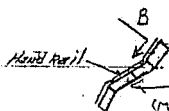

No railing required
on east side, trail does
not exceed 30"

#2

Overall Length 46'

Adjacent Residence
3705 Dosh Ct.

370.04'

BY _____ DATE _____
CHKD BY _____ DATE _____

SUBJECT Section View Walkway #1
Lat H Traction View Rack

SHEET NO. 2 OF 3
JOB NO. Sec 1/2 1/2" = 10'

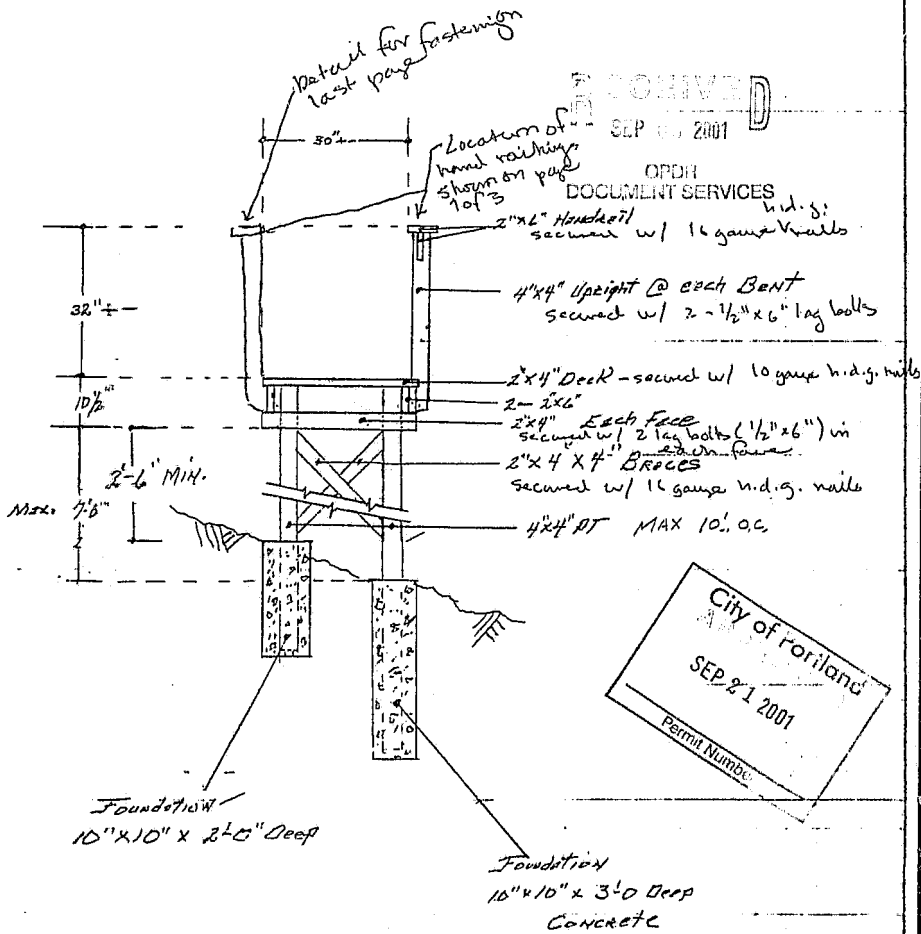

RECEIVED
SEP 06 2001
ORDH
DOCUMENT SERVICES

City of Portland
SEP 21 2001
Permit Number:

Section View
CONDITION 1 Detail A
Shows 1 of 11
LOCATIONS

Note: All Materials
D.F. #2 RT.

BY _____ DATE _____
CHKD. BY _____ DATE _____

SUBJECT Section View Walkway #2
Det H Tanglefoot View Park

SHEET NO. 3 OF 3
JOB NO. _____
Scale 1/2" = 1'-0"

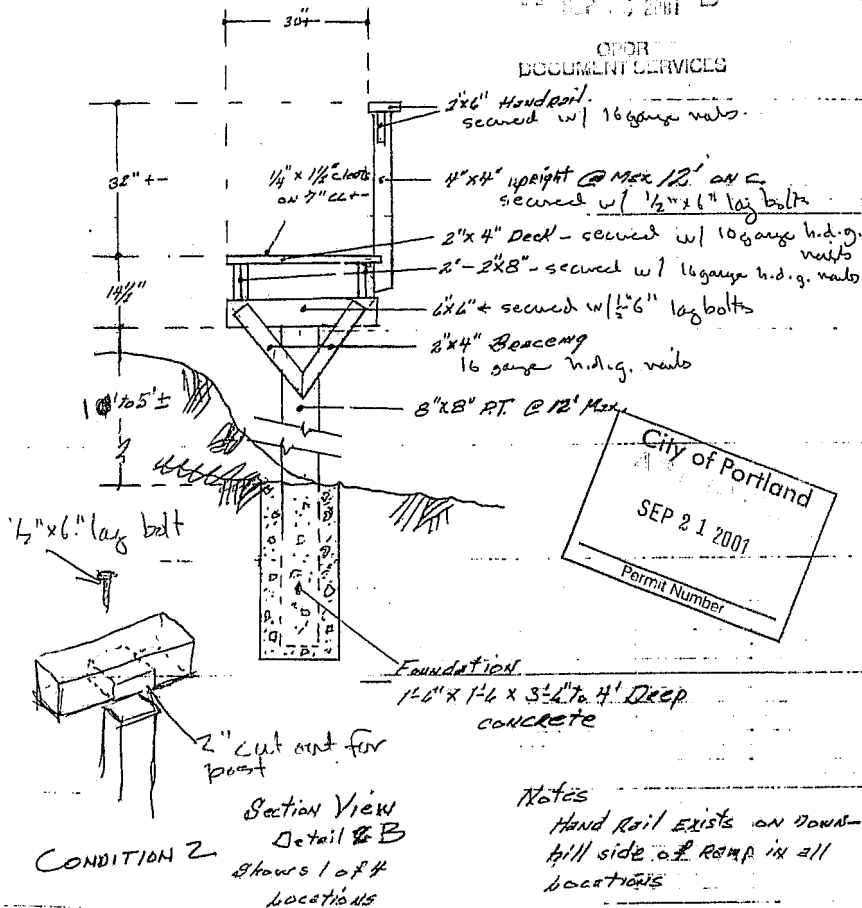

Fasteners for Railing

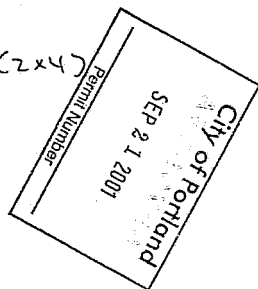
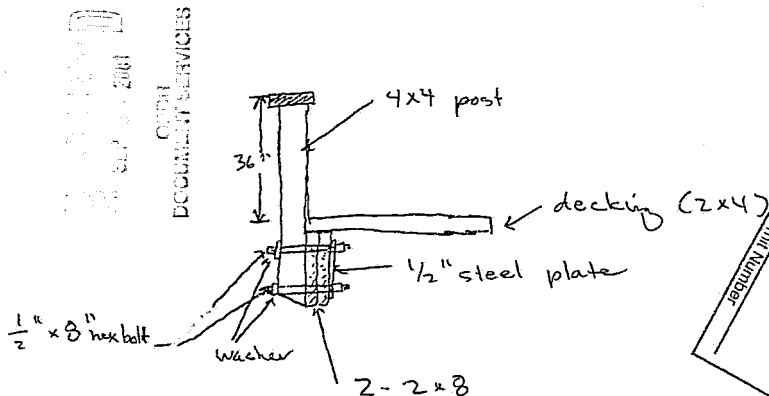

Repair for Railing

