

July 28, 2016

Portland Planning and Sustainability Commission
Bureau of Planning and Sustainability
1900 SW 4th Avenue, Suite 7100
Portland, Oregon 97201

RE: CCNE01: NE 12th Avenue Interstate 84 Overpass – Central City and Westside North Viewpoint.

The focal feature of this view is the Central City skyline and West Hills. The view is challenged by vegetation and high rise structures on the eastside. We investigated the corridor between NE 12th and NE Martin Luther King along Lloyd Boulevard for the best focal point along Lloyd Boulevard.

An elevated view point at the southeast corner of NE Grand Avenue and Lloyd is the superior viewpoint. An ADA accessible elevated viewpoint would be constructed on City owned property looking west across the urban development and the West Hills. We have provided pictures of the view and the location.

The view would be framed on the south side by the newly built "Yard" (on the east end of the Burnside Bridge) and on the north side by our future building (NE Lloyd and Grand Avenue). The site angle provides the best view of the downtown skyline and West Hills without the interference of the I-5/I-84 interchange.

Joseph Angel owns the block between NE Grand Avenue, Lloyd, Martin Luther King, and the Sullivan's Gulch. The Portland Development Commission helped finance a Development Opportunity Strategy in 2006 to identify various appropriate high-rise buildings that could anchor the Oregon Convention Center/Lloyd District southwestern corner and be a gateway building for the district. The building would be consistent with the urban edge of the buildings along Lloyd Boulevard.

Our proposed view point would be iconic and special. The view point would be elevated and constructed artfully to maximize the view and attractiveness of the view.

The proposed location is well served by street car that runs adjacent. The location is closely proximate to the Oregon Convention Center. The Grand/King couplet is a major pedestrian corridor. The view point would be a major feature along the Planning and Sustainability's proposed "Green Loop."

We respectfully request that this view point/corridor be the preferred view.

Sincerely,



Peter Finley Fry for Joseph Angel

**303 NW Uptown Terrace #1B
Portland, Oregon USA 97210
peter@finleyfry.com**

📷 Snapshot



Snapshot

viewpoint



view point

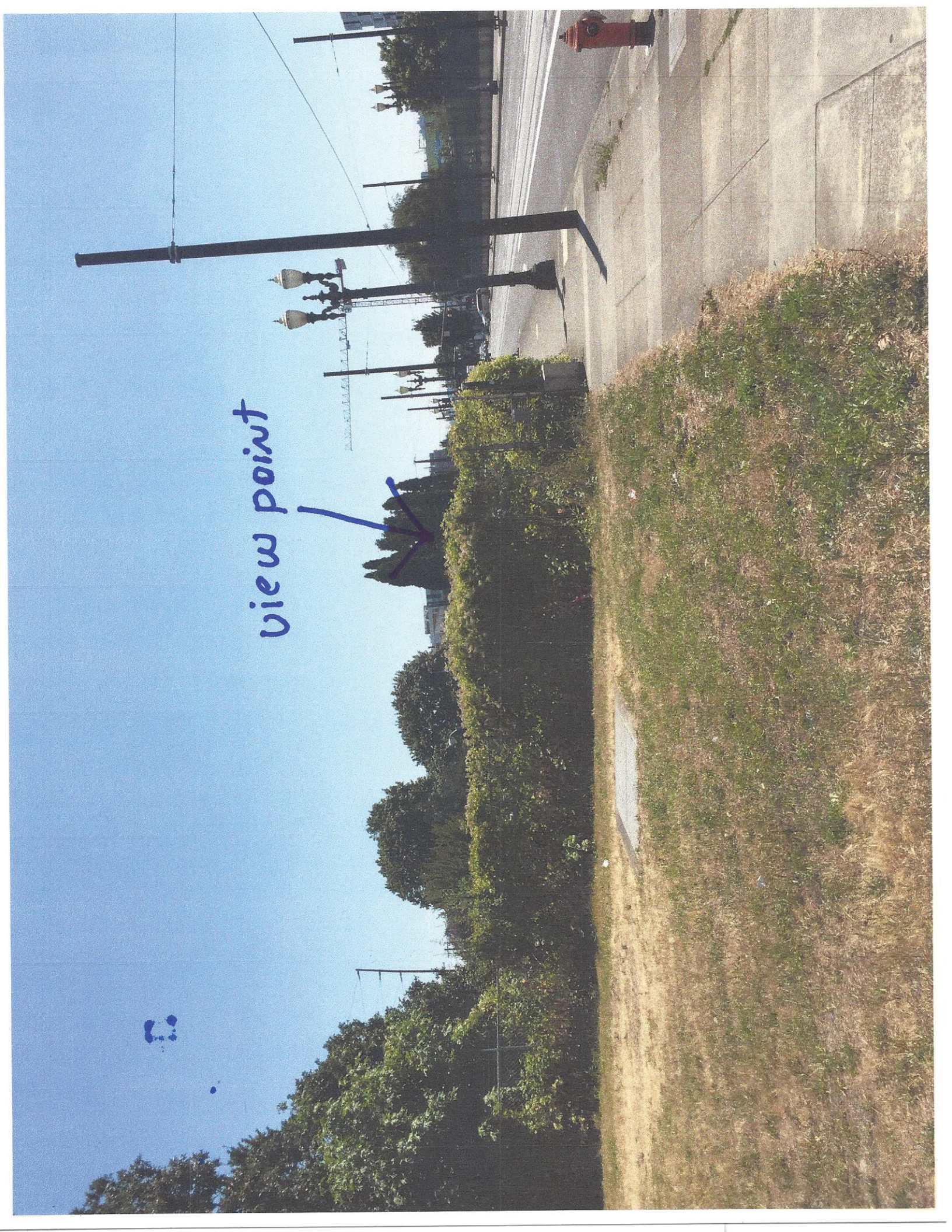

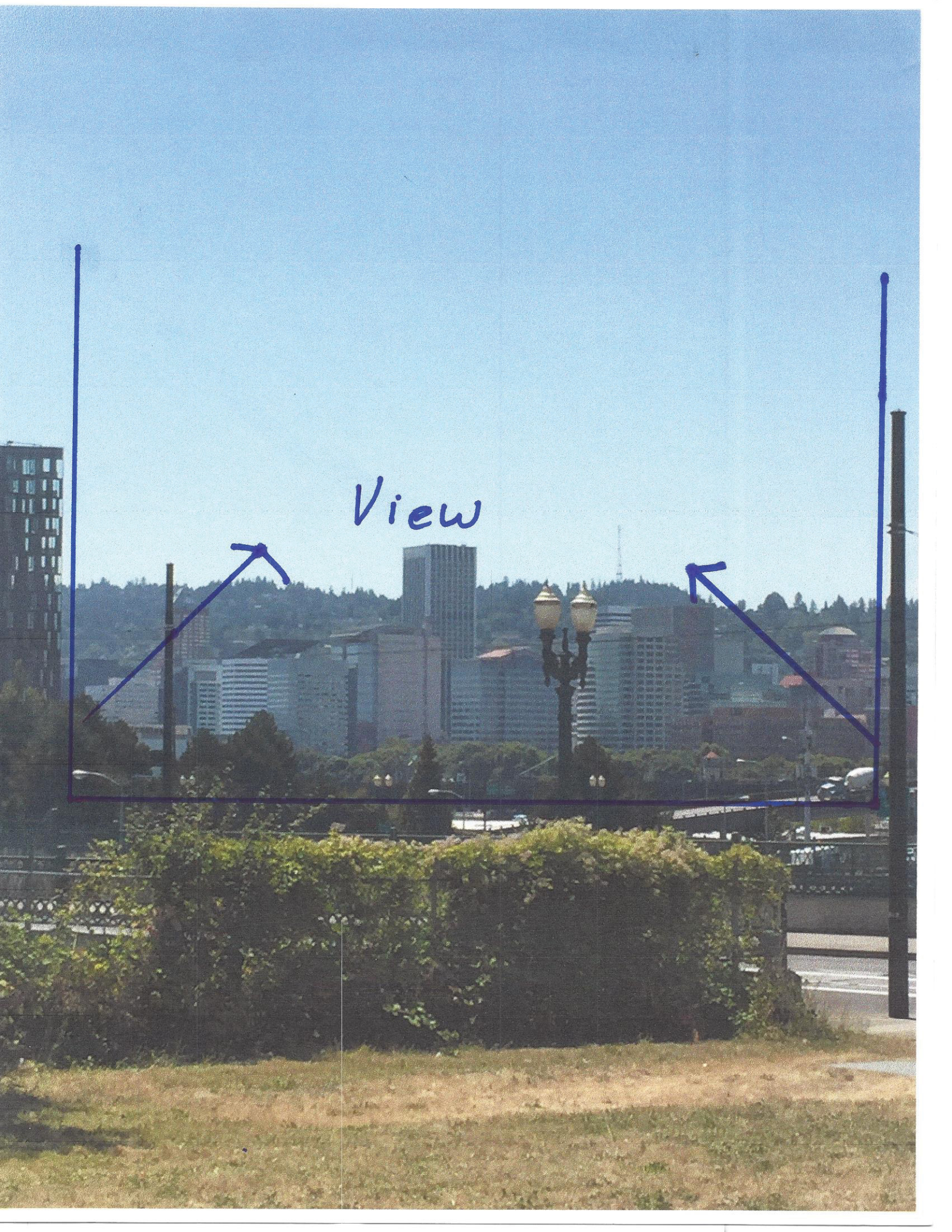

View

View Point

