



MULTNOMAH COUNTY CENTRAL COURTHOUSE
DESIGN ADVICE REQUEST HEARING 2 | July 7 2016

EA #16-130513 DA



SRG PARTNERSHIP INC
CGLRICCI GREENE

A Vision for the new Multnomah County Central Courthouse

The new Multnomah County Central Courthouse (MCCCH) will enhance confidence in the justice system, inspire civic engagement and urban vitality, and provide a restorative human experience within a resilient and responsible community landmark.

Project Charter Mission Statement: To design and build a sustainable, accessible, functional, landmark Courthouse that is a symbol of the importance of our system of justice and a source of civic pride. The new Courthouse will incorporate 21st Century best practices in operations, security, and design; it will be capable of adapting to changing needs over a planned 100-year useful life. The project delivery team will work in a trusting and collaborative manner, with key community partners, to achieve the County's goals and objectives stated in the Project Charter.

INDEX

Security Context.....	C.9
Elevator Analysis.....	C.14
Naito Parkway Pedestrian Experience.....	C.18
Madison Street Pedestrian Experience.....	C.35
Jefferson Street Pedestrian Experience.....	C.48
First Avenue Pedestrian Experience.....	C.53

PROJECT TEAM

Owner

Multnomah County
401 N Dixon Street
Portland, OR 97227-1865

Architect

SRG Partnership Inc.
621 SW Morrison Street, Suite
200
Portland, OR 97205

CGL Ricci Greene Associates
158 West, 27th Street,
10th Floor
New York, NY 10001

Landscape Architect

PLACE
735 NW 18th Avenue
Portland, OR 97209

Structural Engineer

KPFF
111 SW Fifth Avenue, Suite 2500
Portland, OR 97204

Mechanical & Plumbing Engineer

Interface Engineering
100 SW Main Street, Suite 1600
Portland, OR 97204

Electrical Engineer

PAE
522 SW 5th Avenue, Suite 1500
Portland, OR 97204







AGENDA/TOPICS

- Security Context
- Elevator Analysis
- Naito Parkway Pedestrian Experience
- Madison Street Pedestrian Experience
- Jefferson Street Pedestrian Experience
- First Avenue Pedestrian Experience

- Security Context
- Elevator Analysis
- Naito Parkway Pedestrian Experience
- Madison Street Pedestrian Experience
- Jefferson Street Pedestrian Experience
- First Avenue Pedestrian Experience

SIGNIFICANT BUILDING EVENTS

- **Marion County Courthouse**, Salem - suspicious packages - occupants shelter - April 15, 2016
- **Linn County Courthouse**, Albany - bomb threat - building evacuated - January 27, 2015
- **Columbia County Circuit Court**, St Helens - bomb threats - building evacuated - May 1, August 27, October 6, 2013
- **Jackson County Courthouse**, Medford - homemade bomb explodes outside courthouse - November 13, 2013
- **Baker, Benton, Clatsop, Crook, Curry, Deschutes, Gilliam, Grant, Jackson, Jefferson, Klamath, Lake, Lane, Lincoln, Malheur, Marion, Morrow, Multnomah, Polk, Sherman, Tillamook, Umatilla, Union, Wallowa, Wasco, Washington, Wheeler and Yamhill** - 28 Oregon bomb threats, 22 buildings evacuated - November 19, 2012
- **West Coast Bank**, Woodburn - bombing (2 killed) - December 13, 2008
- **Washington County Courthouse**, Hillsboro - bomb threat - building evacuated - November 19, 2008
- **Marion County Courthouse**, Salem - truck driven into courthouse, fires set in building - November 12, 2005
- **Grant County Jail connected to Courthouse** - jeep driven into building - February 25, 2002
- **Oklahoma Alfred P. Murrah Federal Building** (168 killed, 680 injured) - Bombing - April 19, 1995

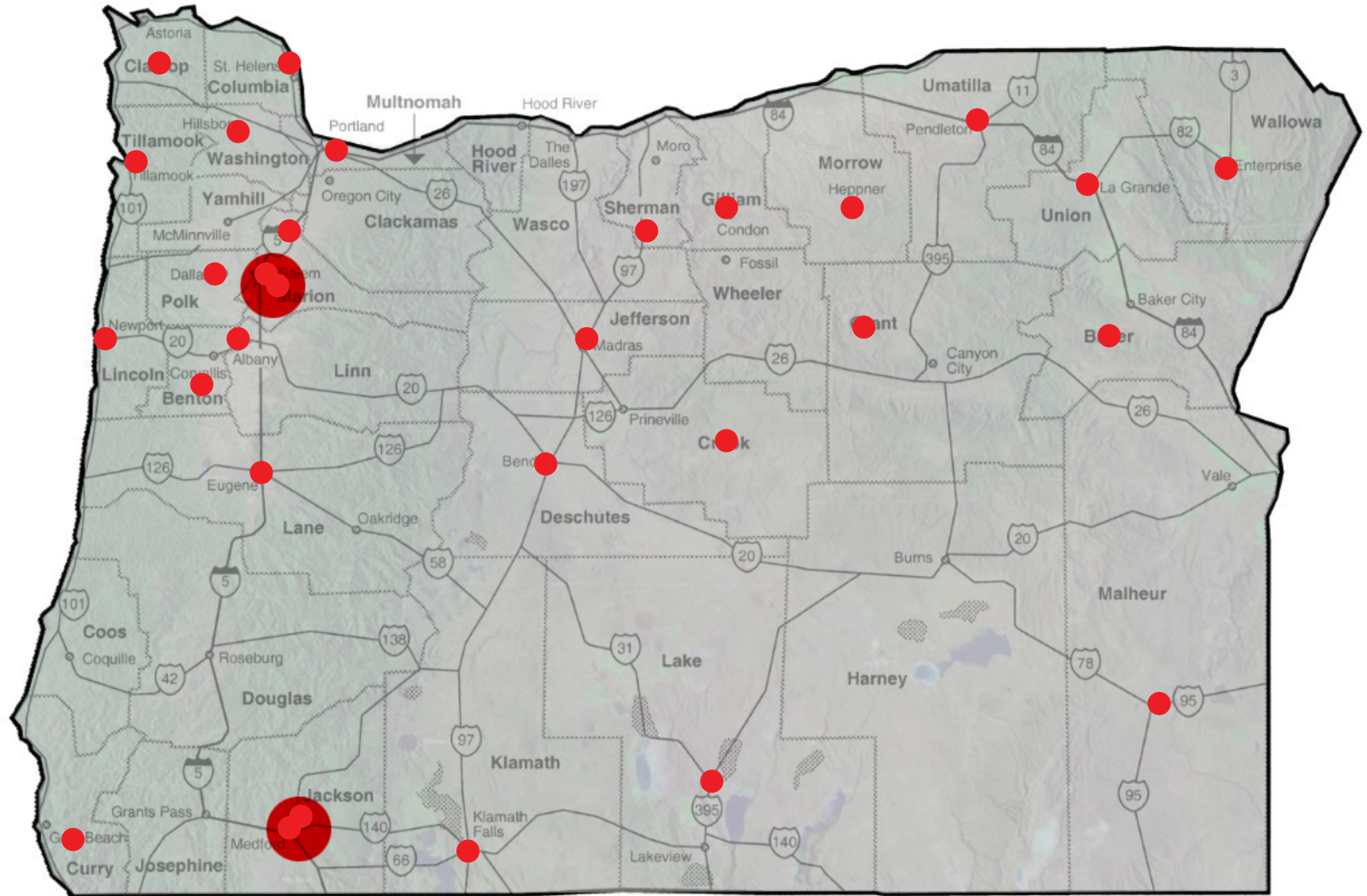

Significant Building Events - Oregon (2002 - Present)

SHERIFF OFFICE LOCATION FACTORS

- Site constraints – water level, vehicular access, elevators
- Safe dignified in custody defendant access
- Locating public functions as convenient as possible
- Daylighting people occupied spaces

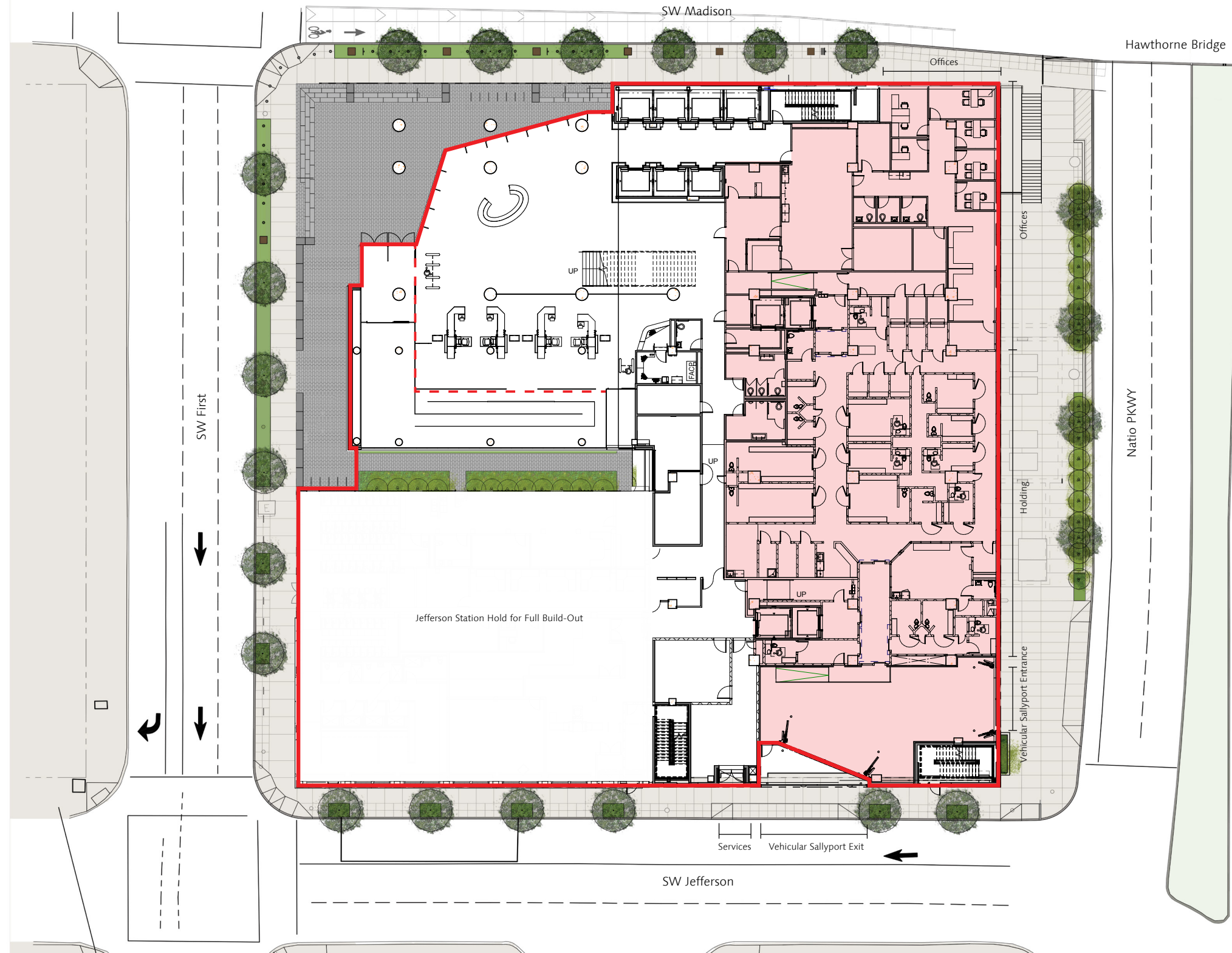





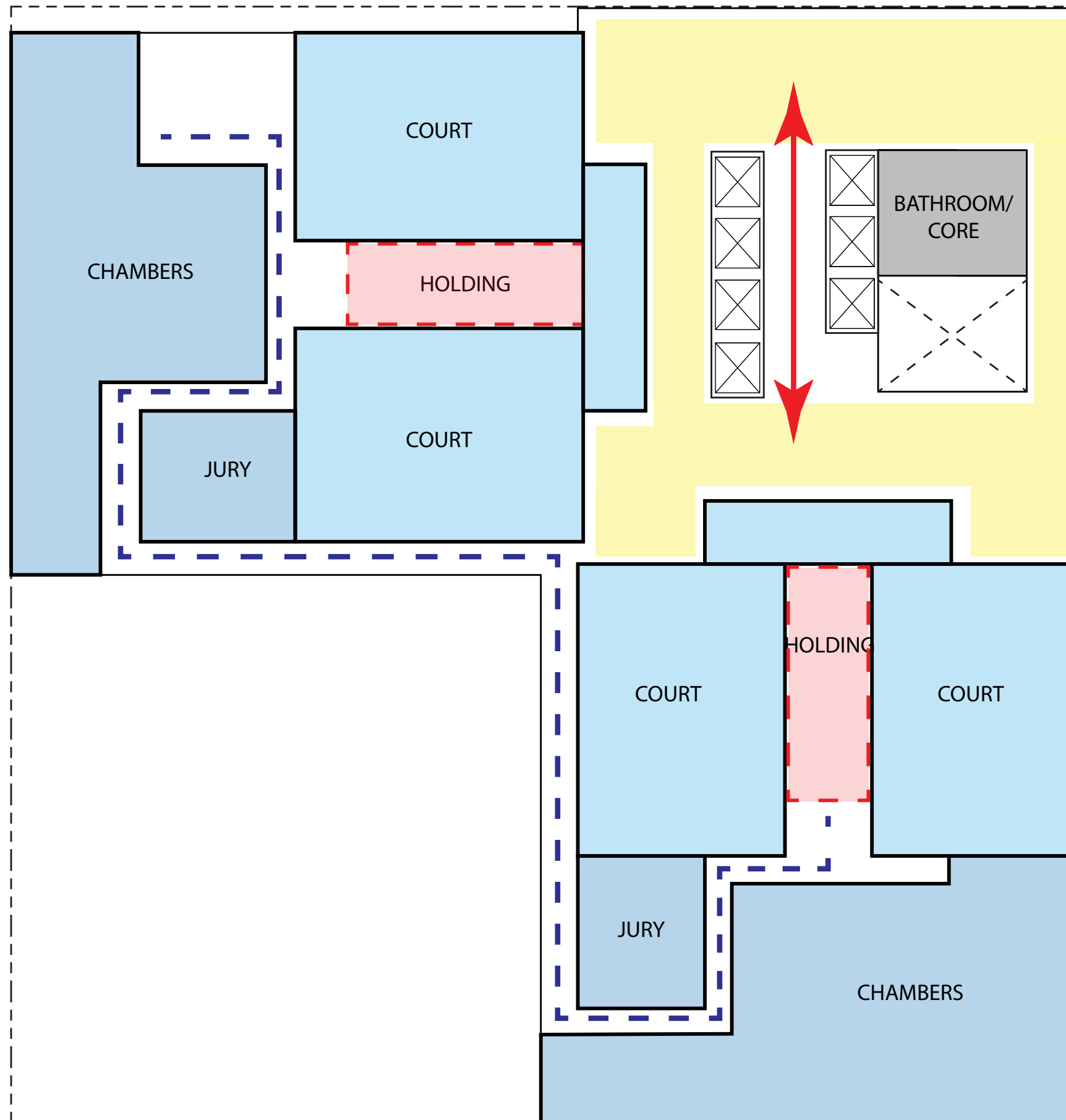

- Secure Perimeter
- Security Screening
- MCSO

Secure Perimeter







- Security Context
- Elevator Analysis
- Naito Parkway Pedestrian Experience
- Madison Street Pedestrian Experience
- Jefferson Street Pedestrian Experience
- First Avenue Pedestrian Experience

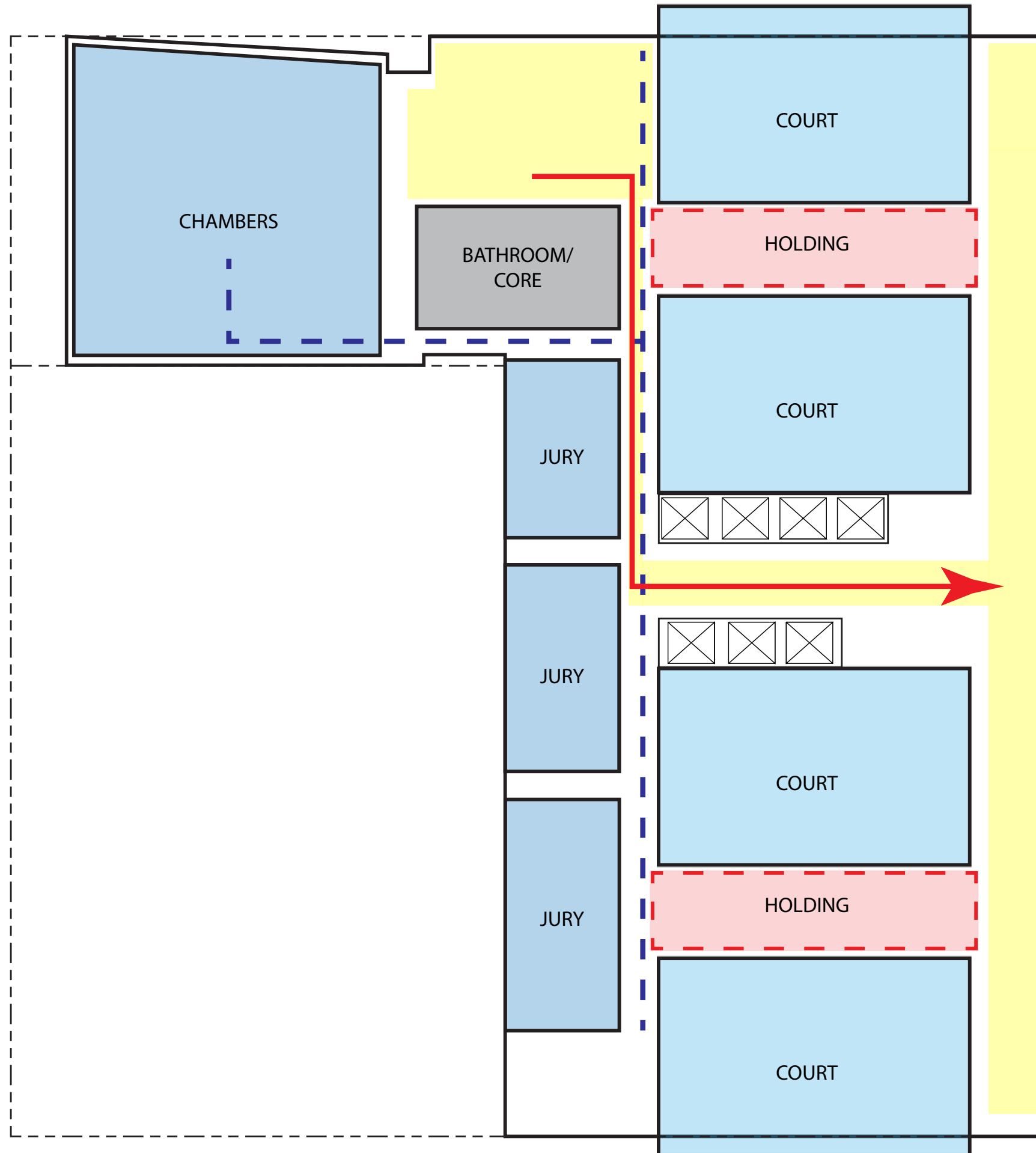

- N 
-  Court and Support Spaces
-  Holding Cells
-  Public Space
-  Judge and Jury Circulation
-  Public Circulation







L-Scheme with Atrium Diagram

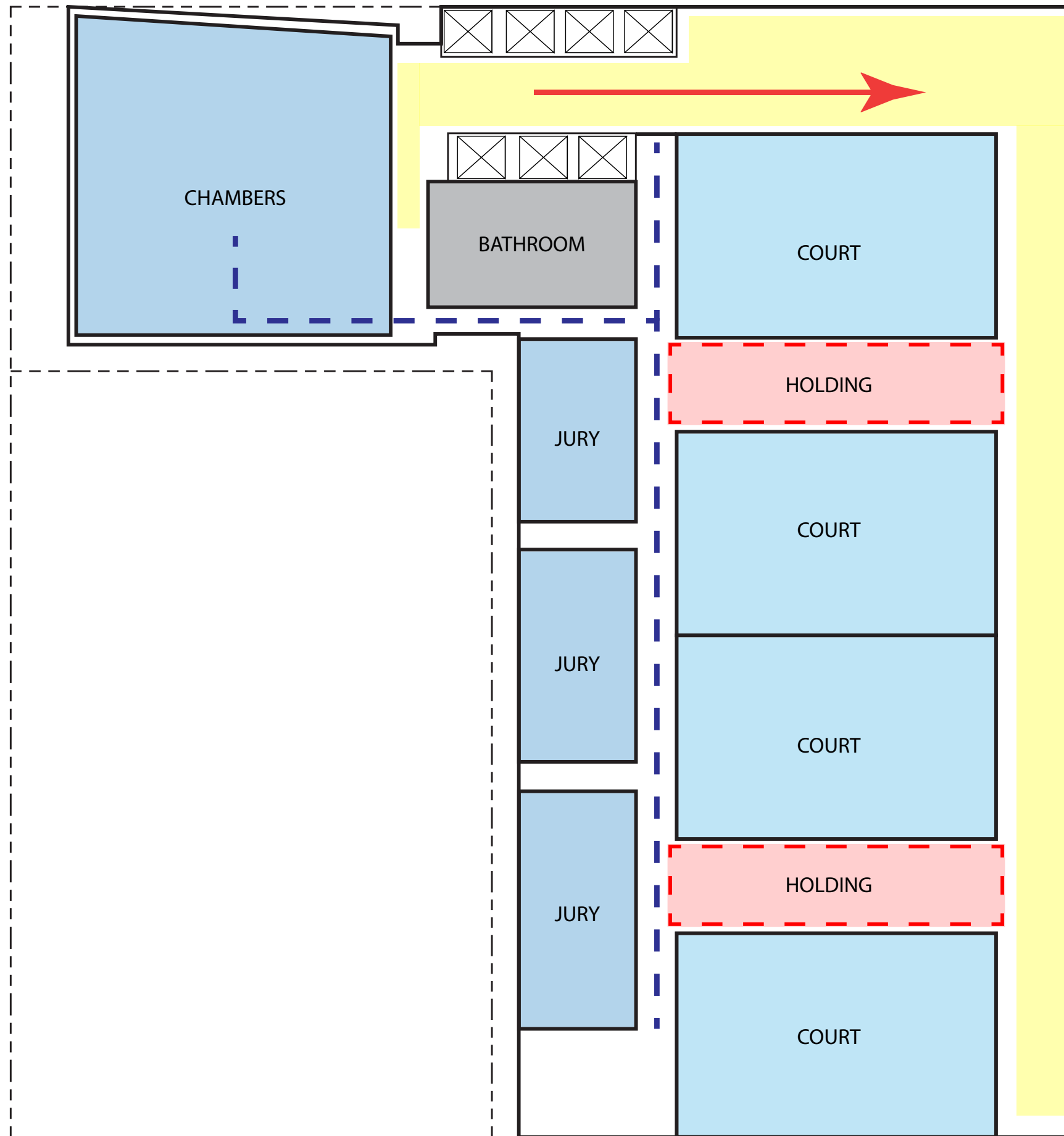

- N 
-  Court and Support Spaces
-  Holding Cells
-  Public Space
-  Judge and Jury Circulation
-  Public Circulation

Central Core Diagram



-  N
-  Court and Support Spaces
-  Holding Cells
-  Public Space
-  Judge and Jury Circulation
-  Public Circulation

North Core Diagram

- Security Context
- Elevator Analysis
- Courthouse Character
- Naito Parkway Pedestrian Experience
- Madison Street Pedestrian Experience
- Jefferson Street Pedestrian Experience
- First Avenue Pedestrian Experience



1914



1997

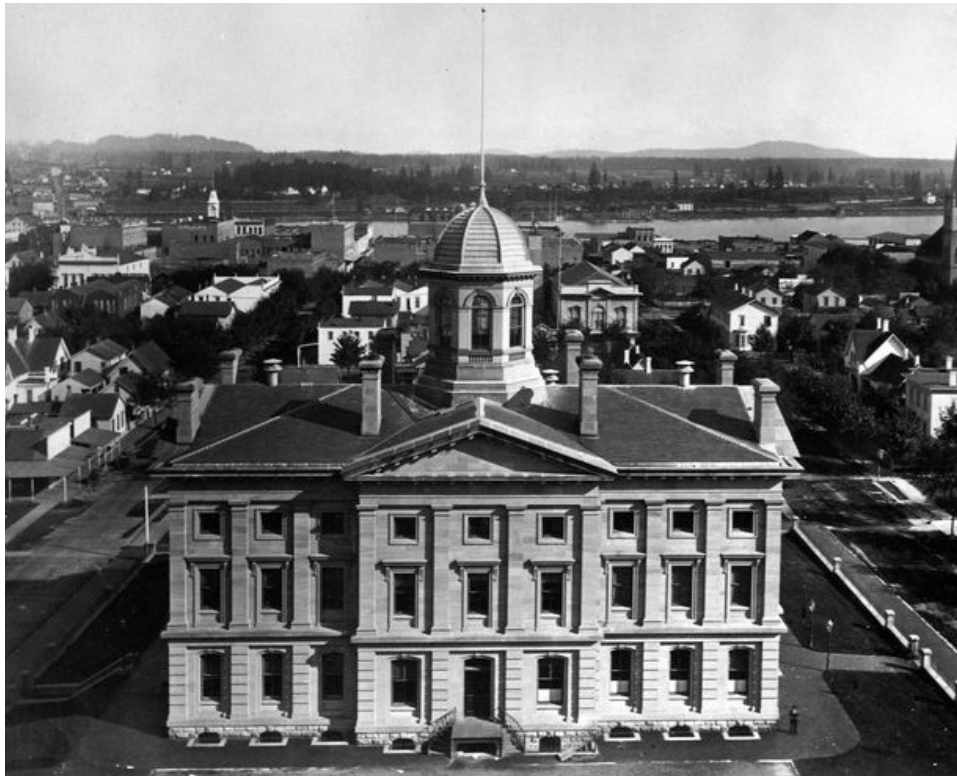

1869



1933



Composition, Materiality and Depth - Design Drivers



Portland Courthouses

Multnomah County Central Courthouse | DAR Hearing 2 | July 7 2016
EA #16-130513 DA

SRG Partnership | CGL Ricci Greene



Multnomah County Courthouse - 1914



American Bank Building - 1913



American Bank Building - 1913

Portland Mixed-Use



Fox Tower - 2000



American Bank Building - 1913



Fox Tower - 2000

Portland Mixed-Use



American Bank Building - 1913



Multnomah County Courthouse - 1914

Portland Mixed-Use



Multnomah County Courthouse Street Character

Multnomah County Central Courthouse | DAR Hearing 2 | July 7 2016
EA #16-130513 DA

SRG Partnership | CGL Ricci Greene



Multnomah County Courthouse Street Engagement

Multnomah County Central Courthouse | DAR Hearing 2 | July 7 2016
EA #16-130513 DA

SRG Partnership | CGL Ricci Greene

- Security Context
- Elevator Analysis
- Naito Parkway Pedestrian Experience
- Madison Street Pedestrian Experience
- Jefferson Street Pedestrian Experience
- First Avenue Pedestrian Experience





Federal Courthouse

Multnomah County Central Courthouse | DAR Hearing 2 | July 7 2016
EA #16-130513 DA

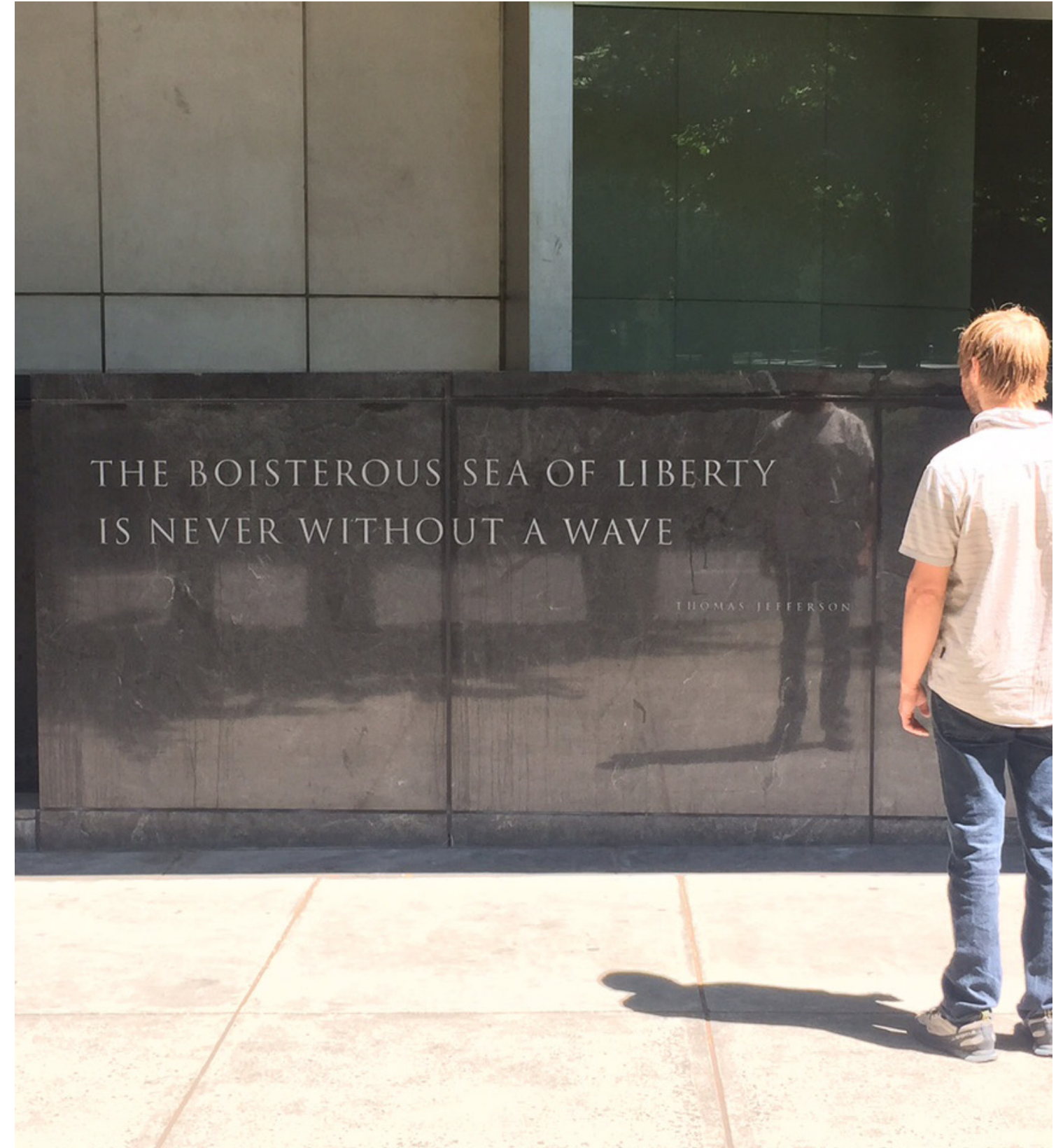

SRG Partnership | CGL Ricci Greene
Exhibit C.19

...TO MAKES
...ORLD FOUNDED UPON
...FREEDOMS. THE FIRST IS FREE
...ND EXPRESSION - EVERYWHERE IN THE WO
SECOND IS FREEDOM OF EVERY PERSON TO WORSE
IN HIS OWN WAY - EVERYWHERE IN THE WORLD. T
IS FREEDOM FROM WANT... EVERYWHERE IN TH
THE FOURTH IS FREEDOM FROM FEAR... ANYWHE
WORLD. THAT IS NO VISION OF A DISTANT MIL
... A DEFINITE BASIS FOR A KIND OF WORLD AT
... AND GENERATION.



INJUSTICE ANYWHERE IS A THREAT TO JUSTICE EVERYWHERE. WE ARE
CAUGHT IN AN INESCAPABLE NETWORK OF MUTUALITY, TIED IN
A SINGLE GARMENT OF DESTINY. WHATEVER AFFECTS
ONE DIRECTLY, AFFECTS ALL INDIRECTLY.

ALABAMA, 1963

Stone Engraving - Precedents

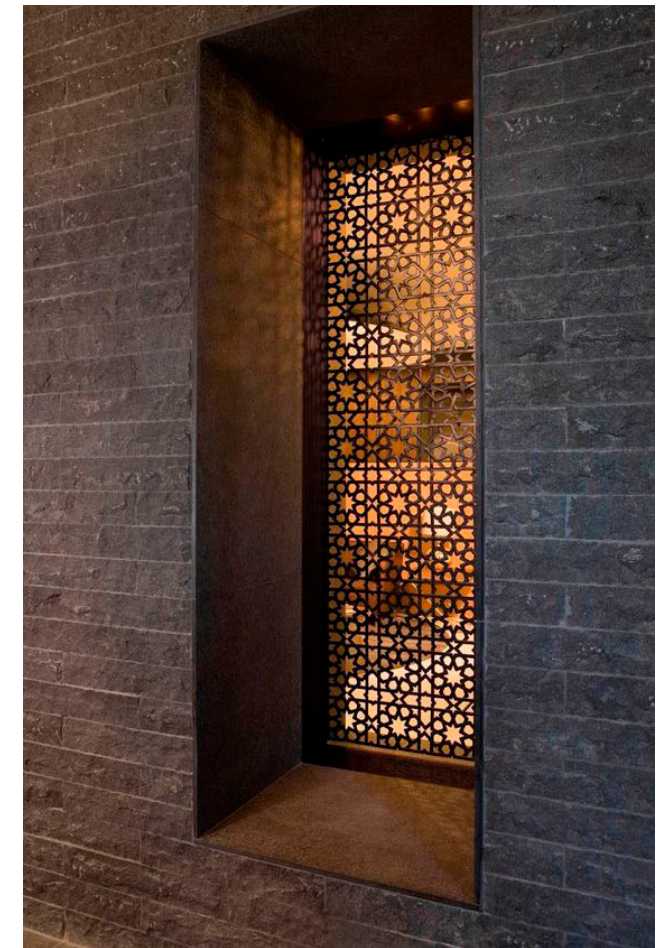
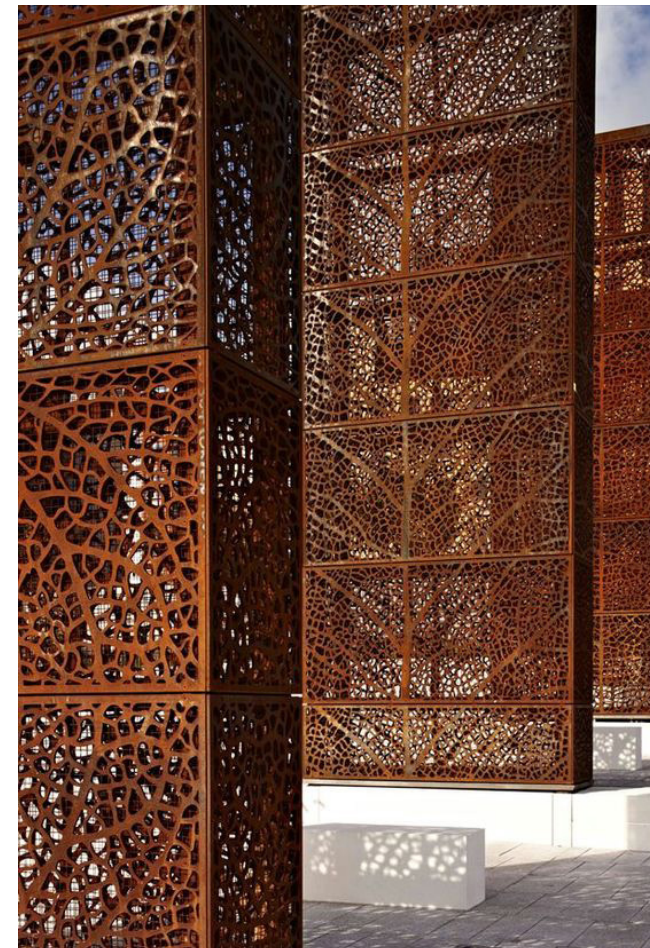
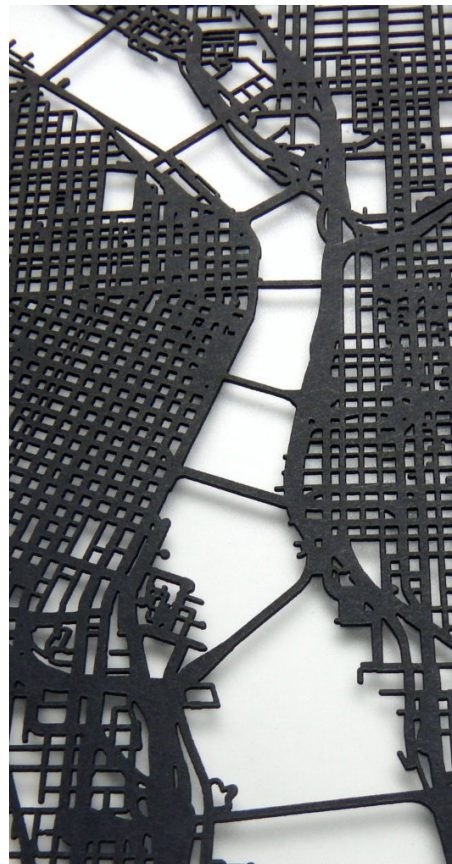

Metal Art Panels - Precedents

Multnomah County Central Courthouse | DAR Hearing 2 | July 7 2016
EA #16-130513 DA

SRG Partnership | CGL Ricci Greene
Exhibit C.21



Naito Parkway Elevation - DAR 1



Naito Parkway Elevation - Current Design

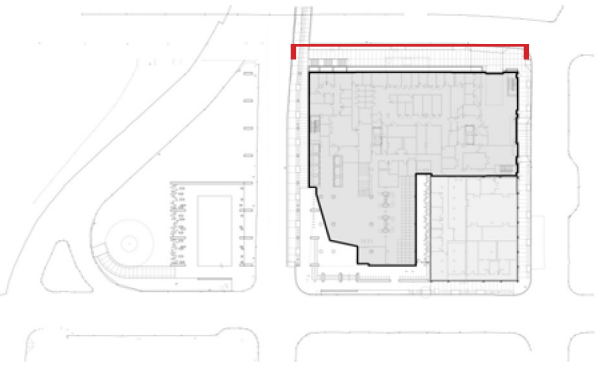

Naito Parkway Elevation - No Chamfer

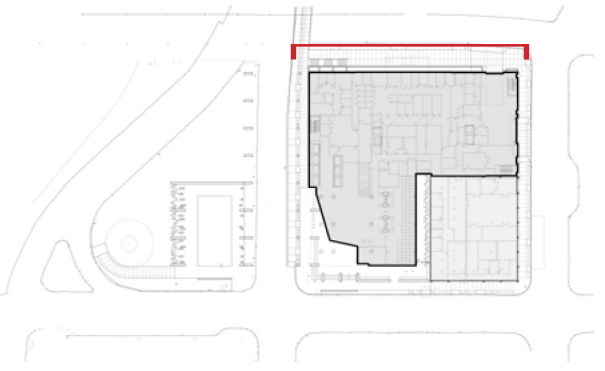

Naito Parkway Elevation - Spandrel Stone Without Canopies

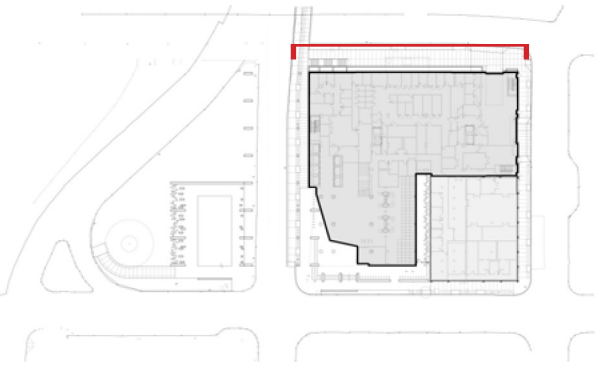

Naito Parkway Elevation - Spandrel Glass Without Canopies

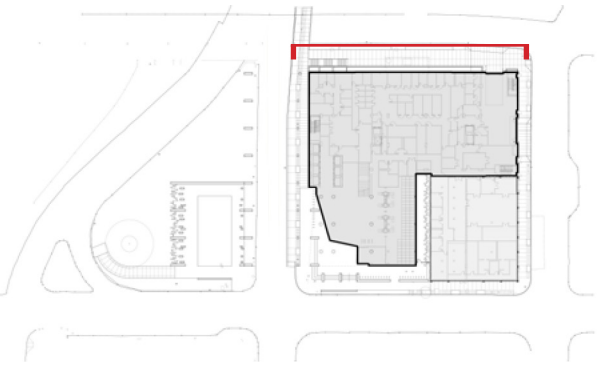

Naito Parkway Elevation - Spandrel Glass With Canopies

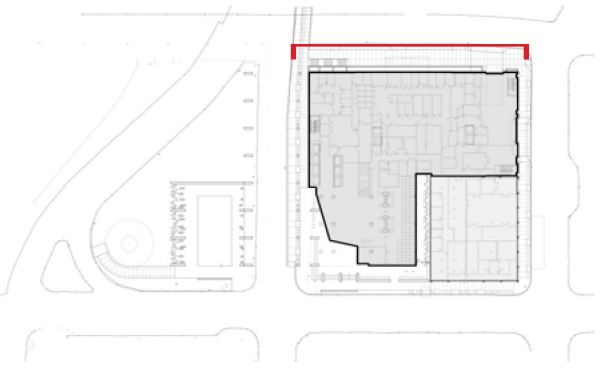

Naito Parkway Elevation - Light Stone Base

Multnomah County Central Courthouse | DAR Hearing 2 | July 7 2016
EA #16-130513 DA

SRG Partnership | CGL Ricci Greene
Exhibit C.27

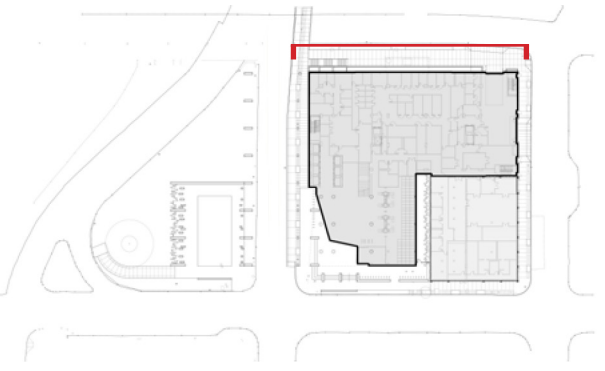

Naito Parkway Elevation - Spandrel Glass With Light Stone Base

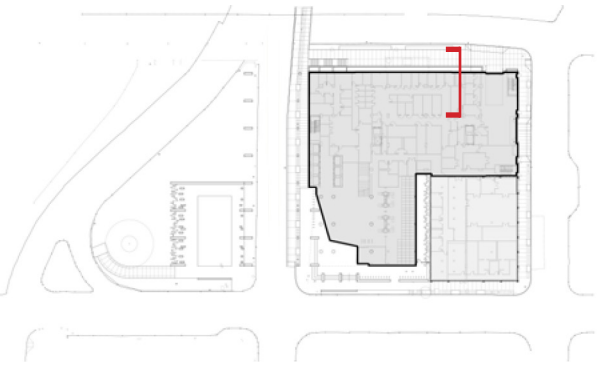

Naito Parkway Section

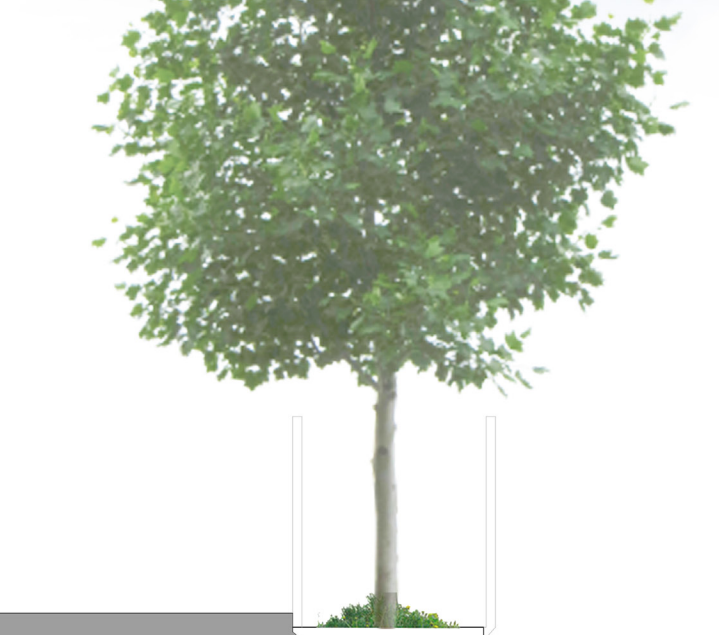
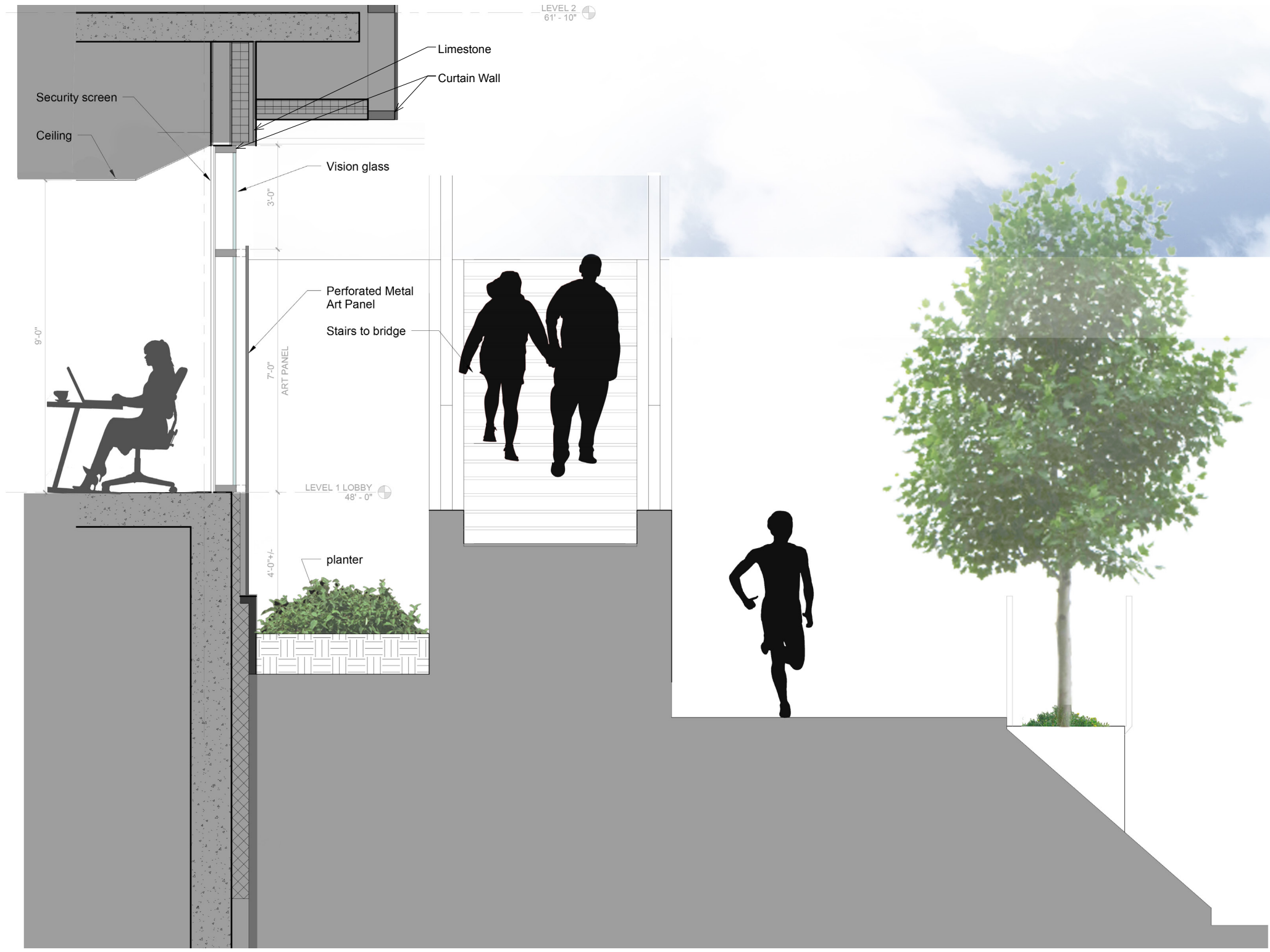
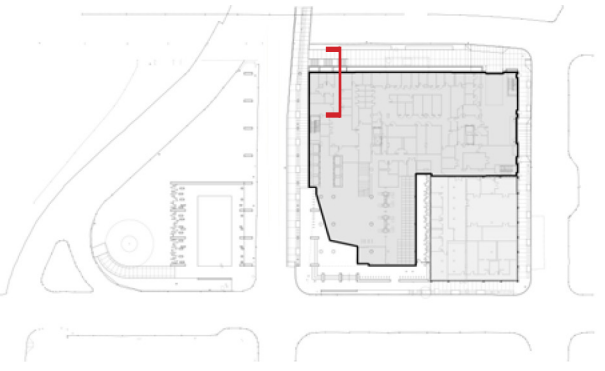

Naito Parkway Section

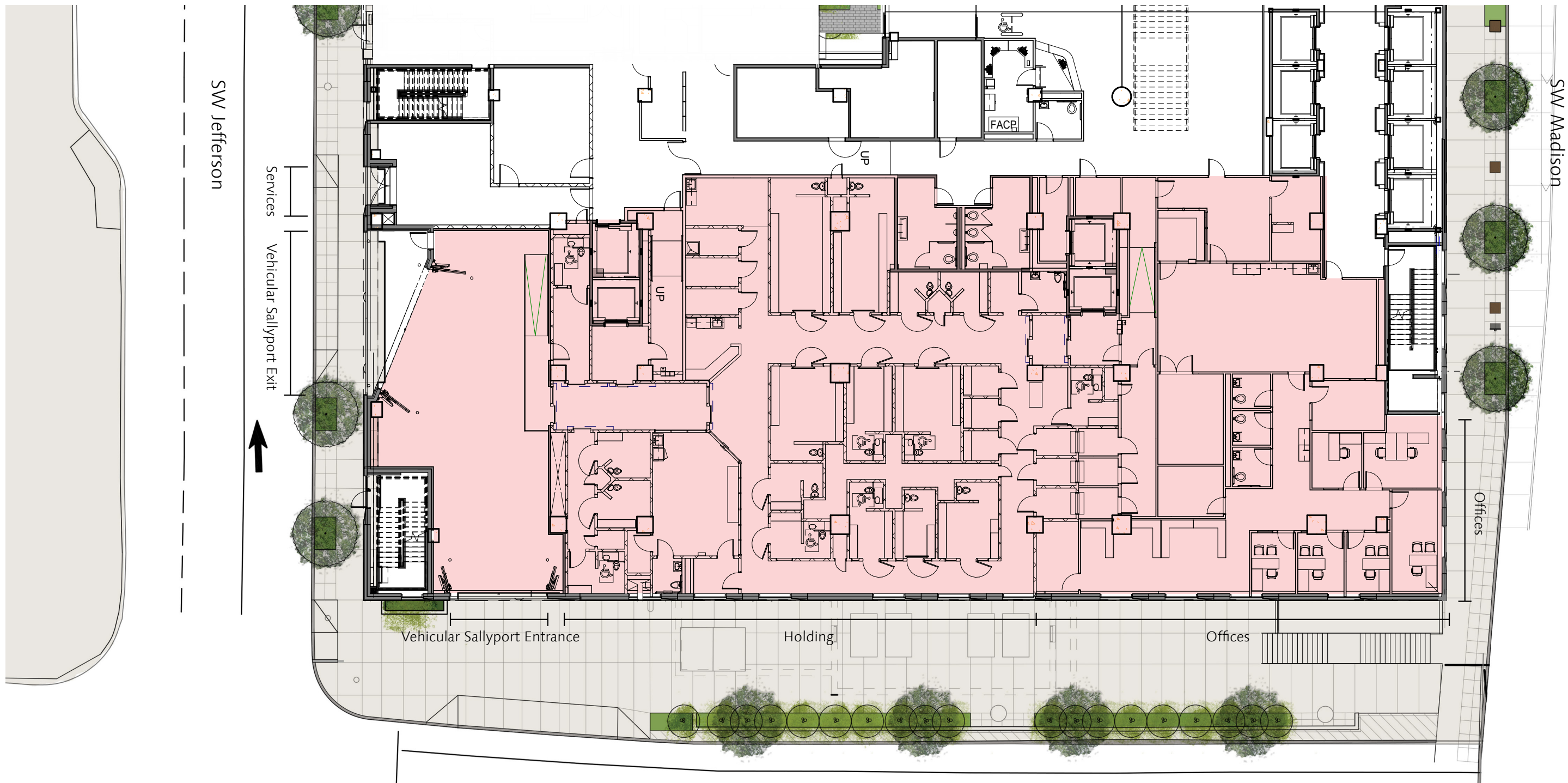

Naito Parkway Plan

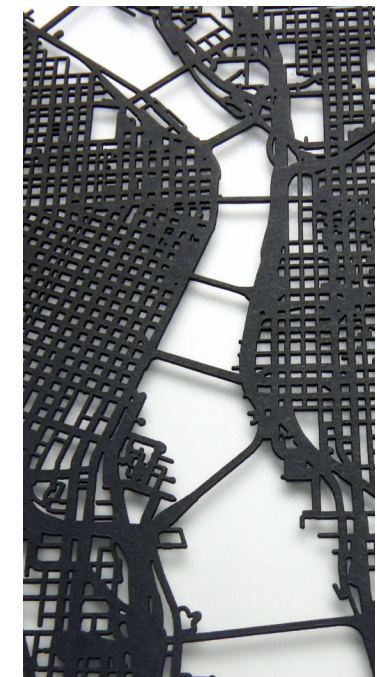
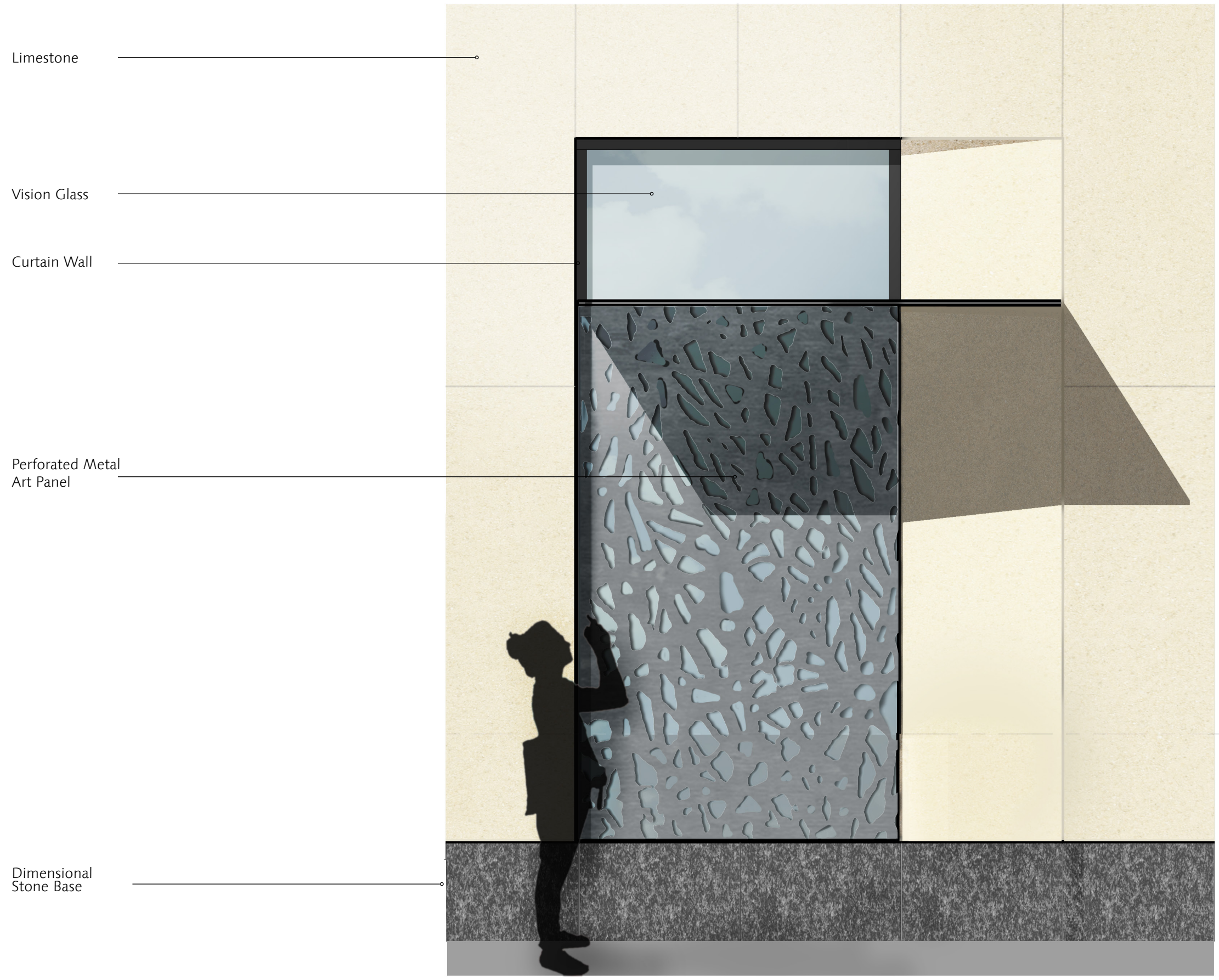

Panel Precedents

Naito Parkway Materials - Metal Art Panel

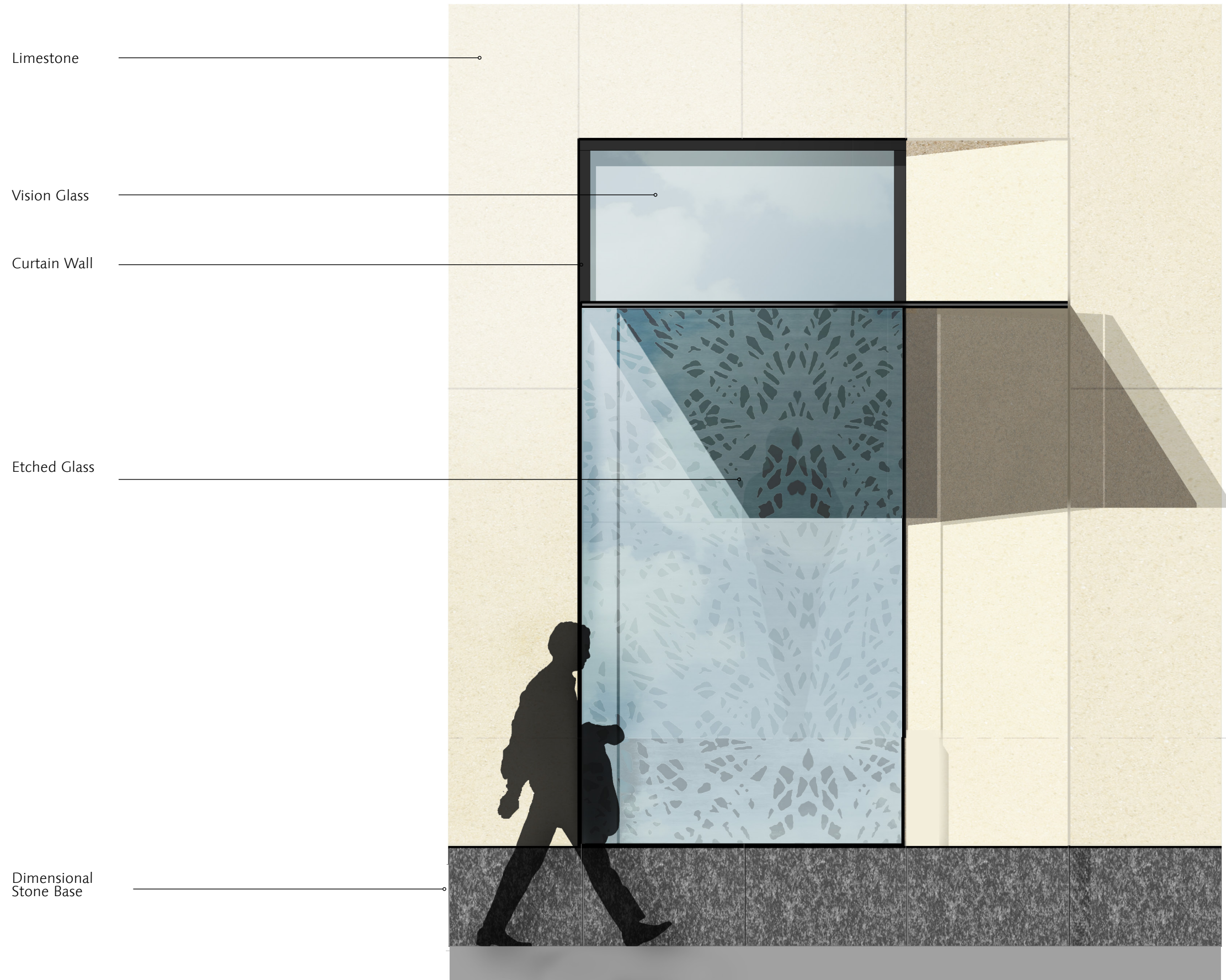

Naito Parkway Materials - Etched Glass

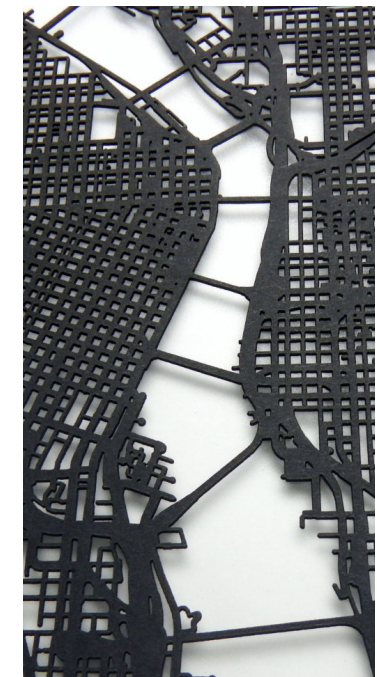
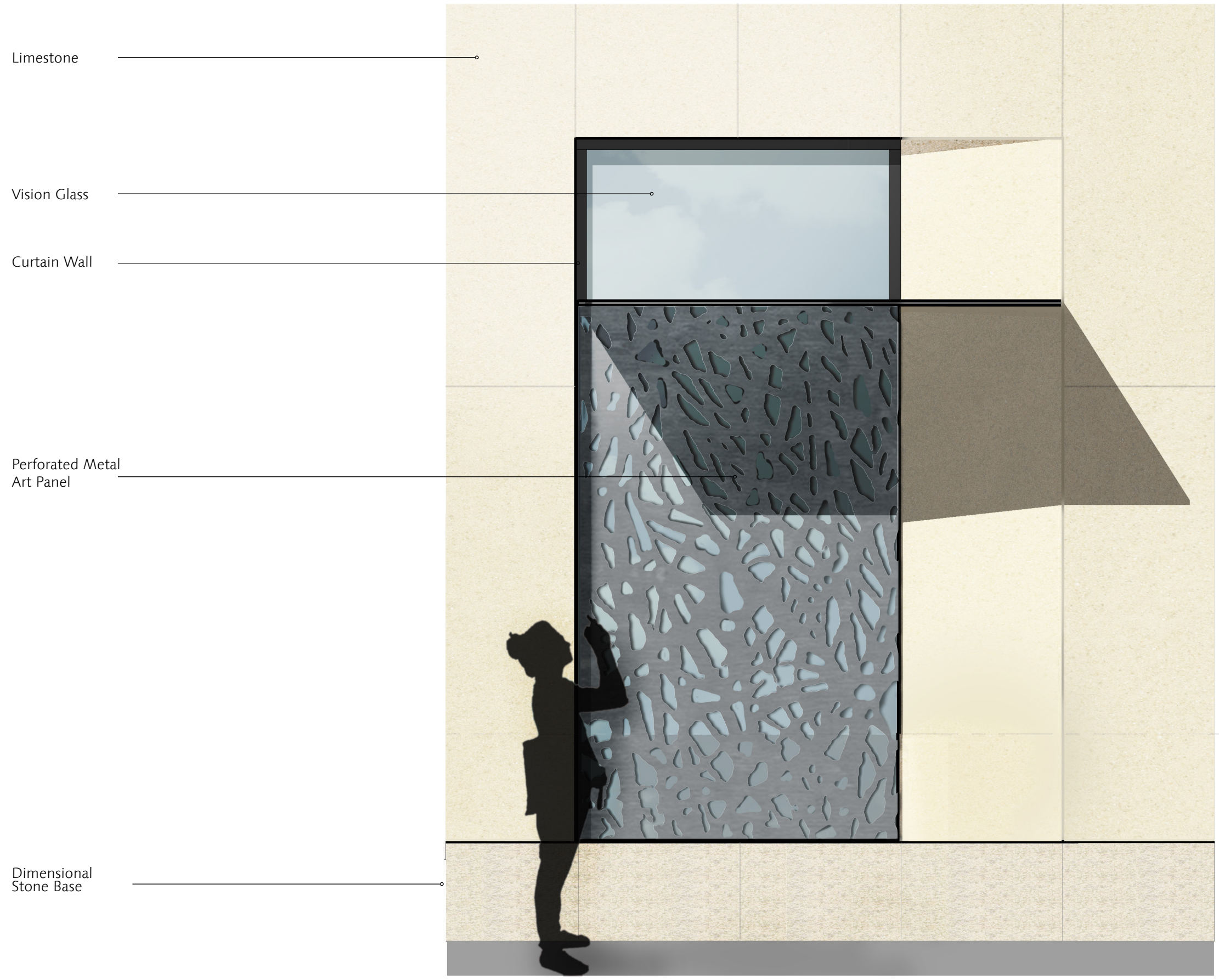

Panel Precedents

Naito Parkway Materials - Metal Art Panel With Light Stone Base



Naito Parkway Perspective

Multnomah County Central Courthouse | DAR Hearing 2 | July 7 2016
EA #16-130513 DA

SRG Partnership | CGL Ricci Greene
Exhibit C.33

- Security Context
- Elevator Analysis
- Naito Parkway Pedestrian Experience
- Madison Street Pedestrian Experience
- Jefferson Street Pedestrian Experience
- First Avenue Pedestrian Experience

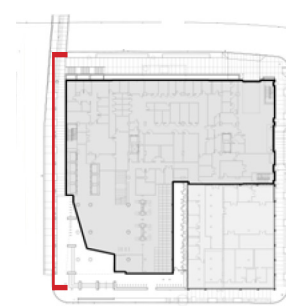

Madison Street Elevation - DAR1



Madison Street Elevation - Current Design



- Curtain Wall
- Spandrel Glass
- Vision Glass
- Limestone



Dimensional Stone Base

Madison Street Elevation - Spandrel Stone

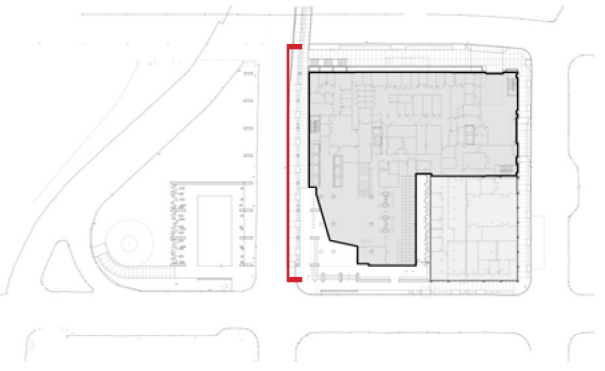

Madison Street Elevation - Spandrel Stone



- Curtain Wall
- Vision Glass
- Limestone
- Spandrel Glass



Dimensional Stone Base

Madison Street Elevation - Spandrel Glass

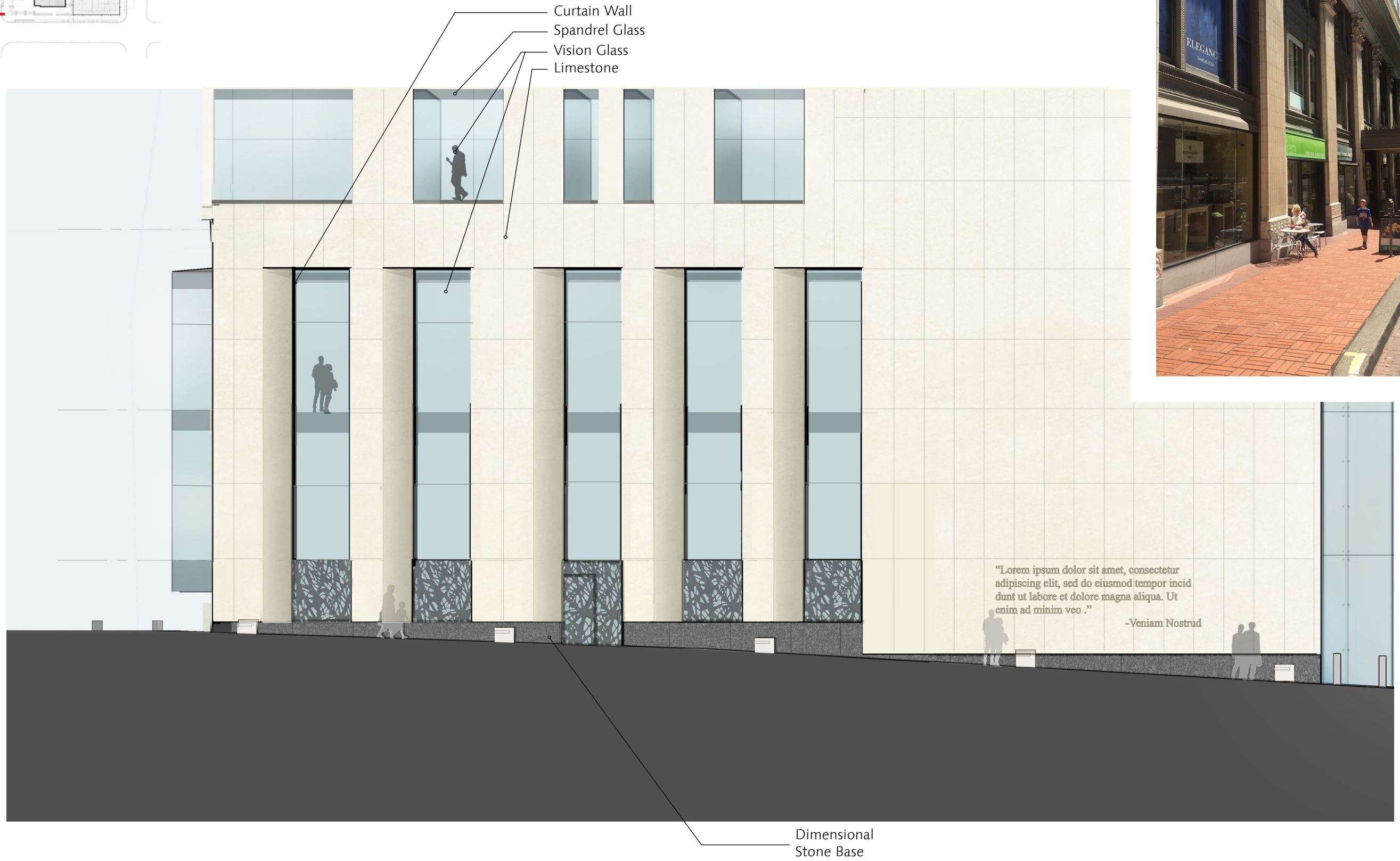
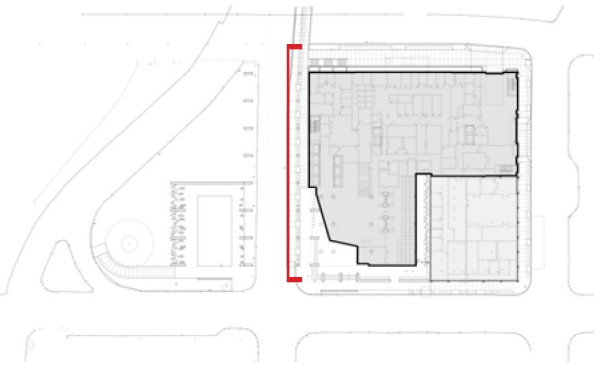

Madison Street Elevation - Spandrel Glass



- Curtain Wall
- Vision Glass
- Limestone
- Spandrel Glass



Dimensional Stone Base

Madison Street Elevation - Spandrel Glass With Light Stone Base

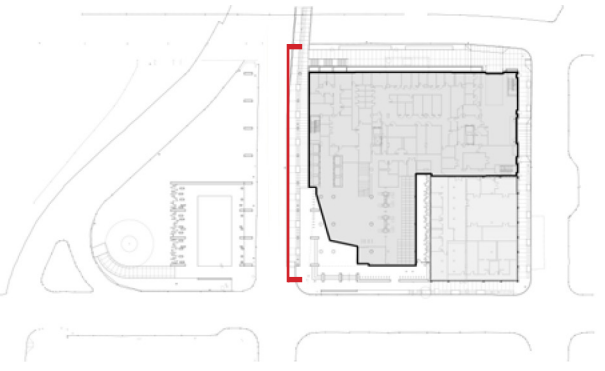

Dimensional Stone Base

Madison Street Elevation - Spandrel Glass With Light Stone Base

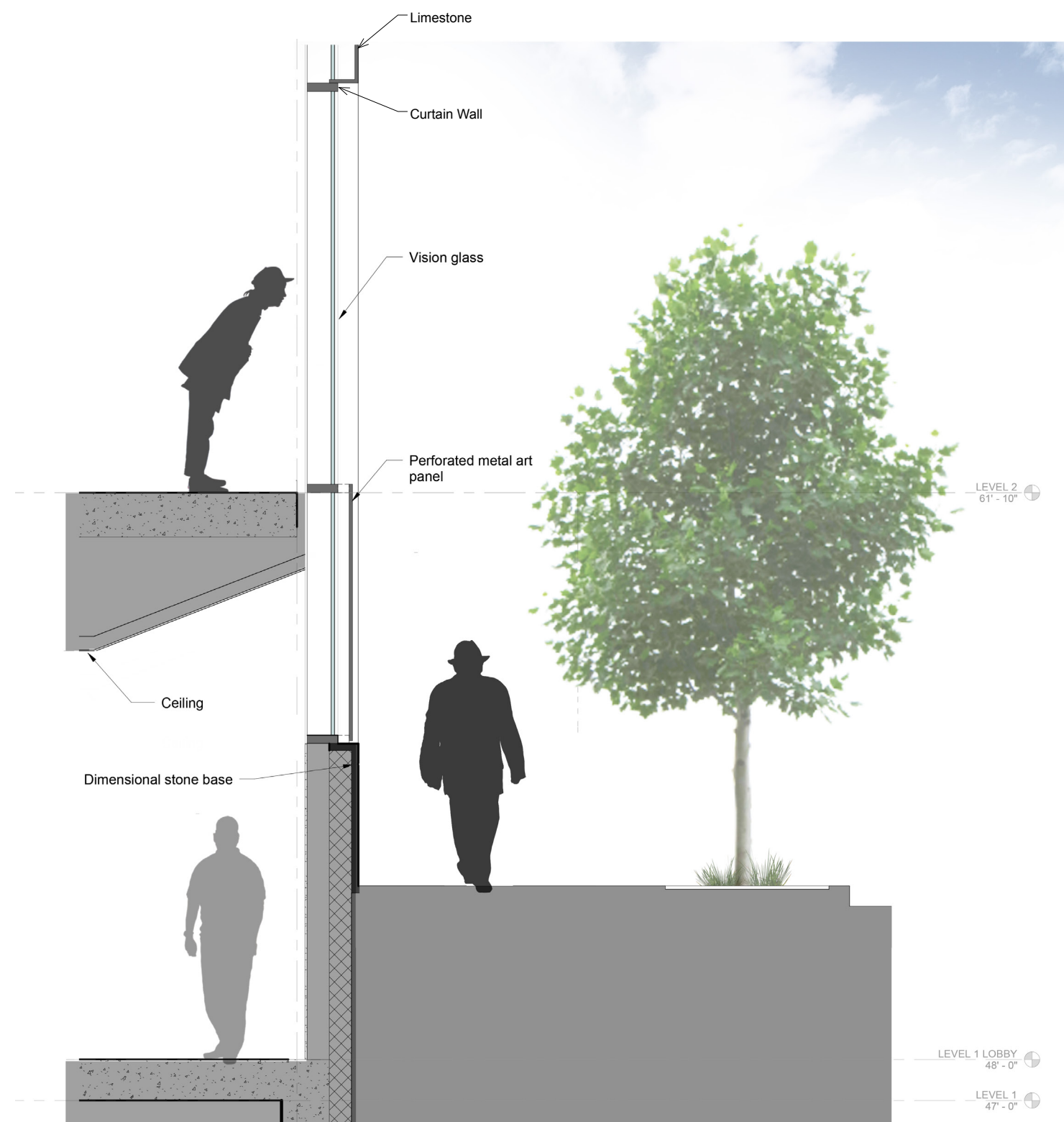
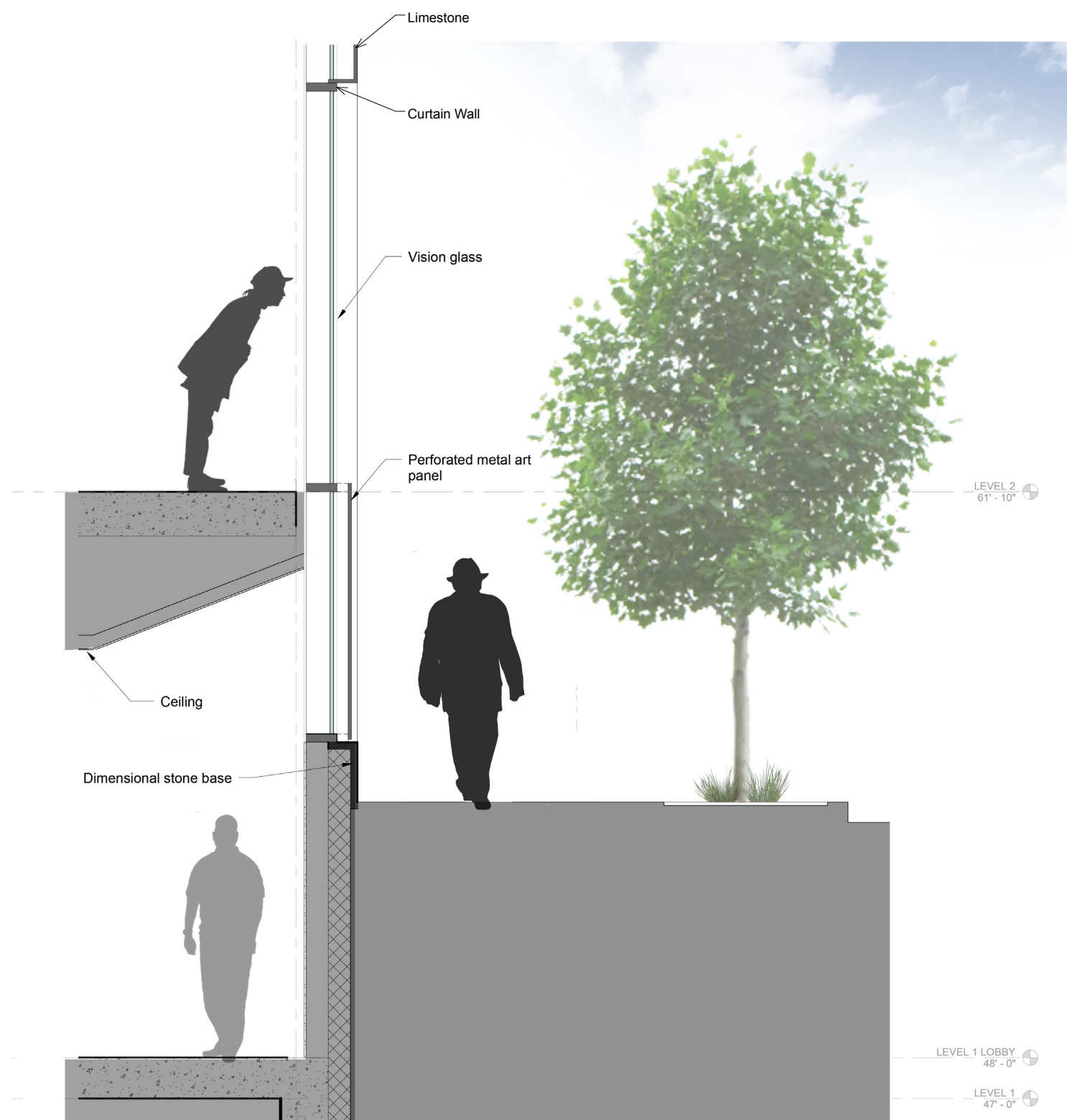

Madison Street Sections - Best and Worst Case

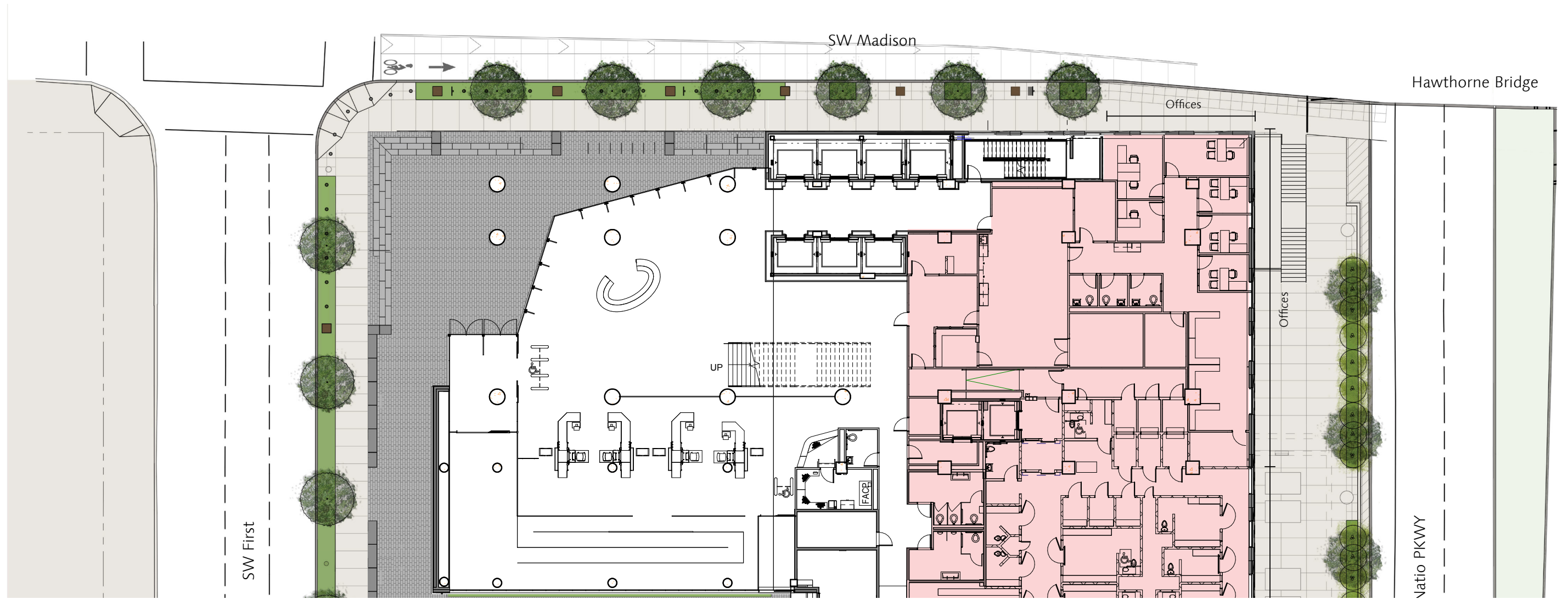

Madison Street Plan



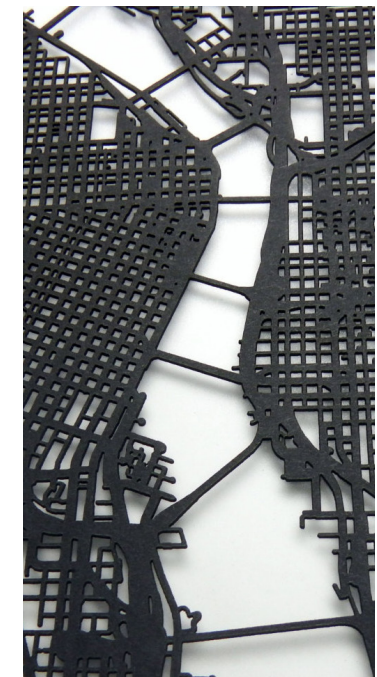

Panel Precedents

LEVEL 2
61' - 10"

Madison Street Materials - Metal Art Panel

Limestone

Vision Glass

Curtain Wall

Perforated Metal
Art Panel

Dimensional
Stone Base

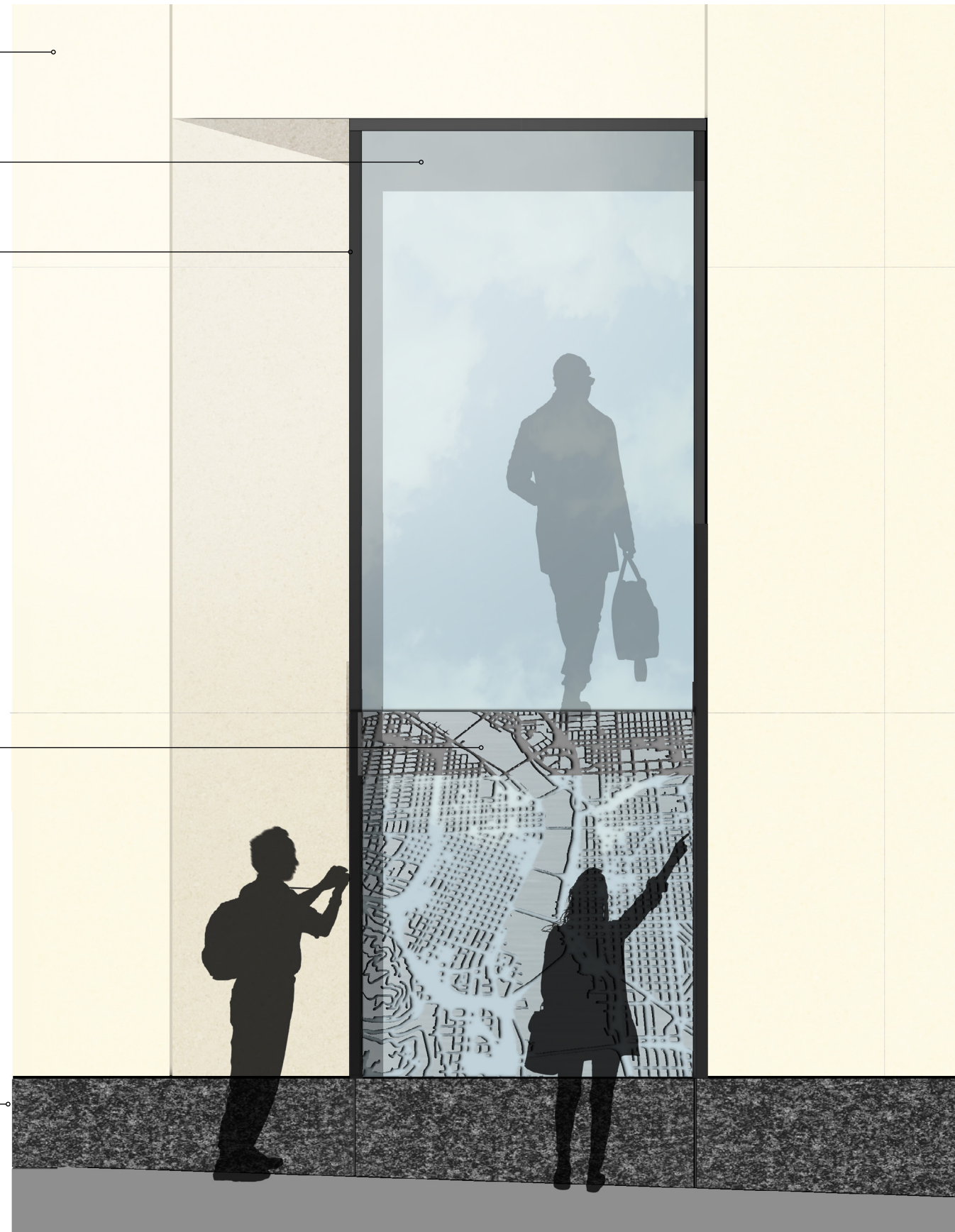

Panel Precedents

Madison Street Materials - Metal Art Panel

Multnomah County Central Courthouse | DAR Hearing 2 | July 7 2016
EA #16-130513 DA

SRG Partnership | CGL Ricci Greene
Exhibit C.43



Madison Street Materials - Etched Glass

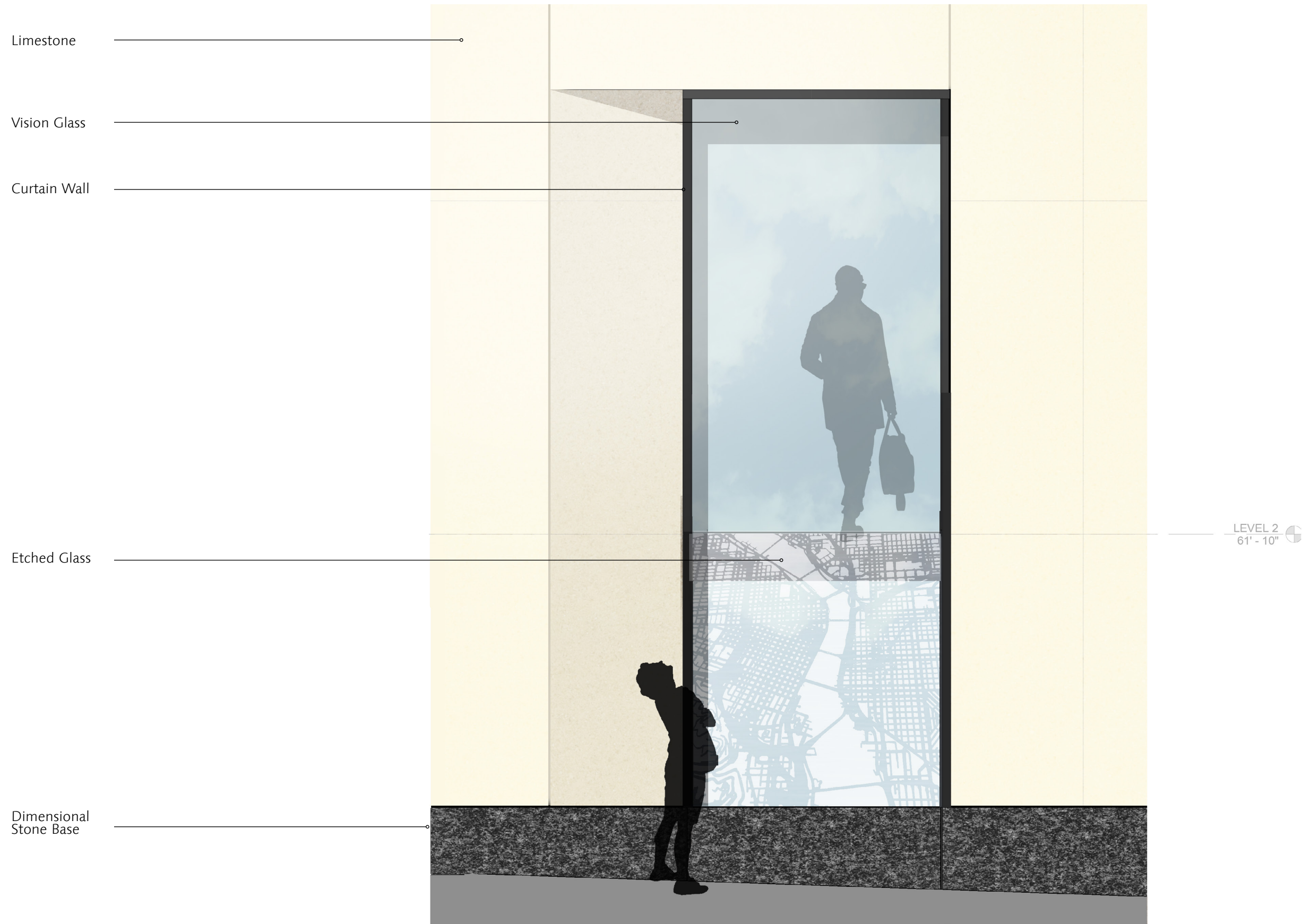

Madison Street Materials - Etched Glass

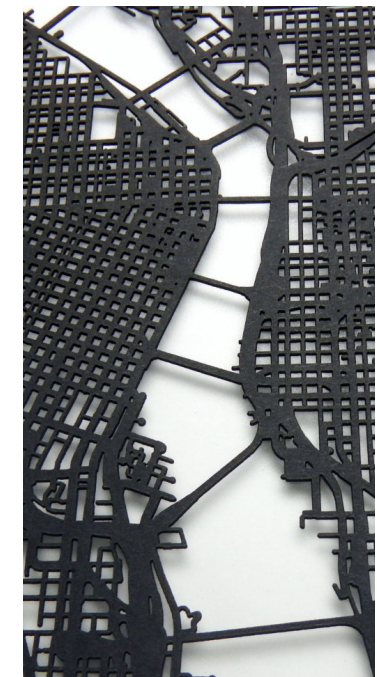

Panel Precedents

LEVEL 2
61' - 10"

Madison Street Materials - Metal Art Panel With Light Stone Base



Madison Street Perspective

Multnomah County Central Courthouse | DAR Hearing 2 | July 7 2016
EA #16-130513 DA

SRG Partnership | CGL Ricci Greene
Exhibit C.46

- Security Context
- Elevator Analysis
- Naito Parkway Pedestrian Experience
- Madison Street Pedestrian Experience
- Jefferson Street Pedestrian Experience
- First Avenue Pedestrian Experience



Jefferson Street Elevation - DAR1



Jefferson Street Elevation - Current Design

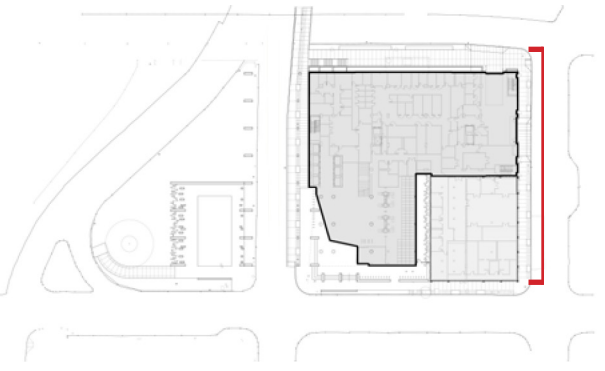

Jefferson Street Elevation - Spandrel Stone

Multnomah County Central Courthouse | DAR Hearing 2 | July 7 2016
EA #16-130513 DA

SRG Partnership | CGL Ricci Greene
Exhibit C.49

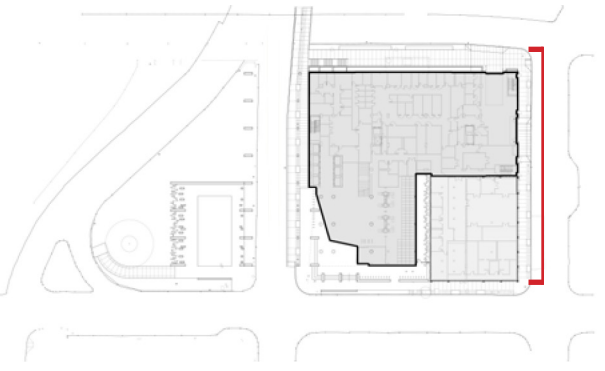

Jefferson Street Elevation - Spandrel Glass

Multnomah County Central Courthouse | DAR Hearing 2 | July 7 2016
EA #16-130513 DA

SRG Partnership | CGL Ricci Greene
Exhibit C.50

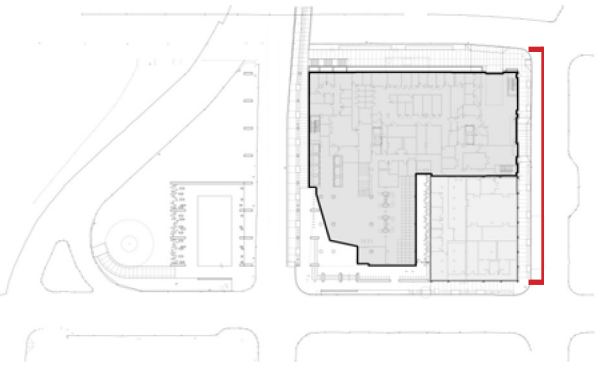

Jefferson Street Elevation - Spandrel Glass With Light Stone Base

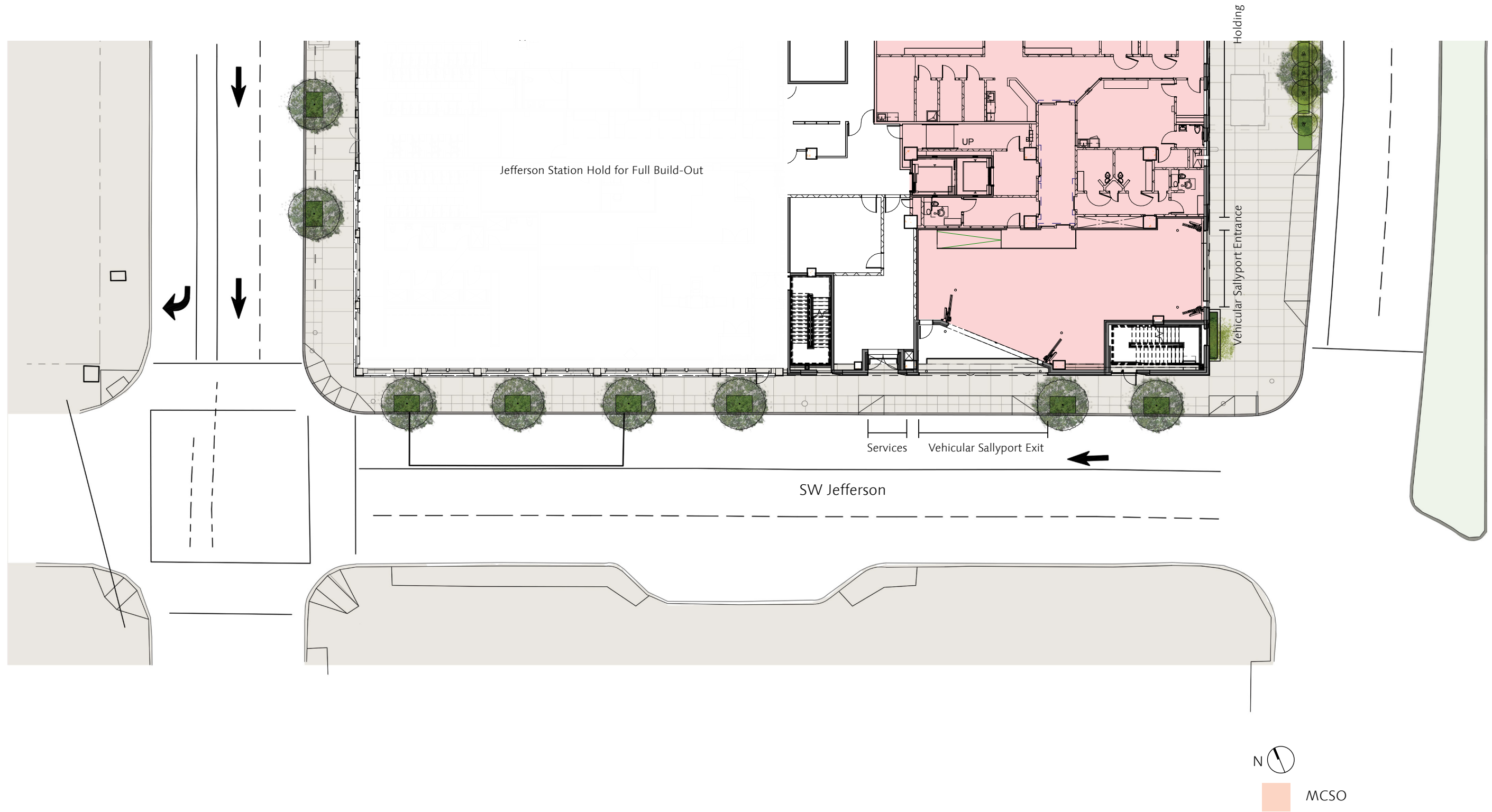

Jefferson Street Plan

- Security Context
- Elevator Analysis
- Naito Parkway Pedestrian Experience
- Madison Street Pedestrian Experience
- Jefferson Street Pedestrian Experience
- First Avenue Pedestrian Experience



First Ave. Street Elevation - DAR1



First Ave. Street Elevation - Current Design

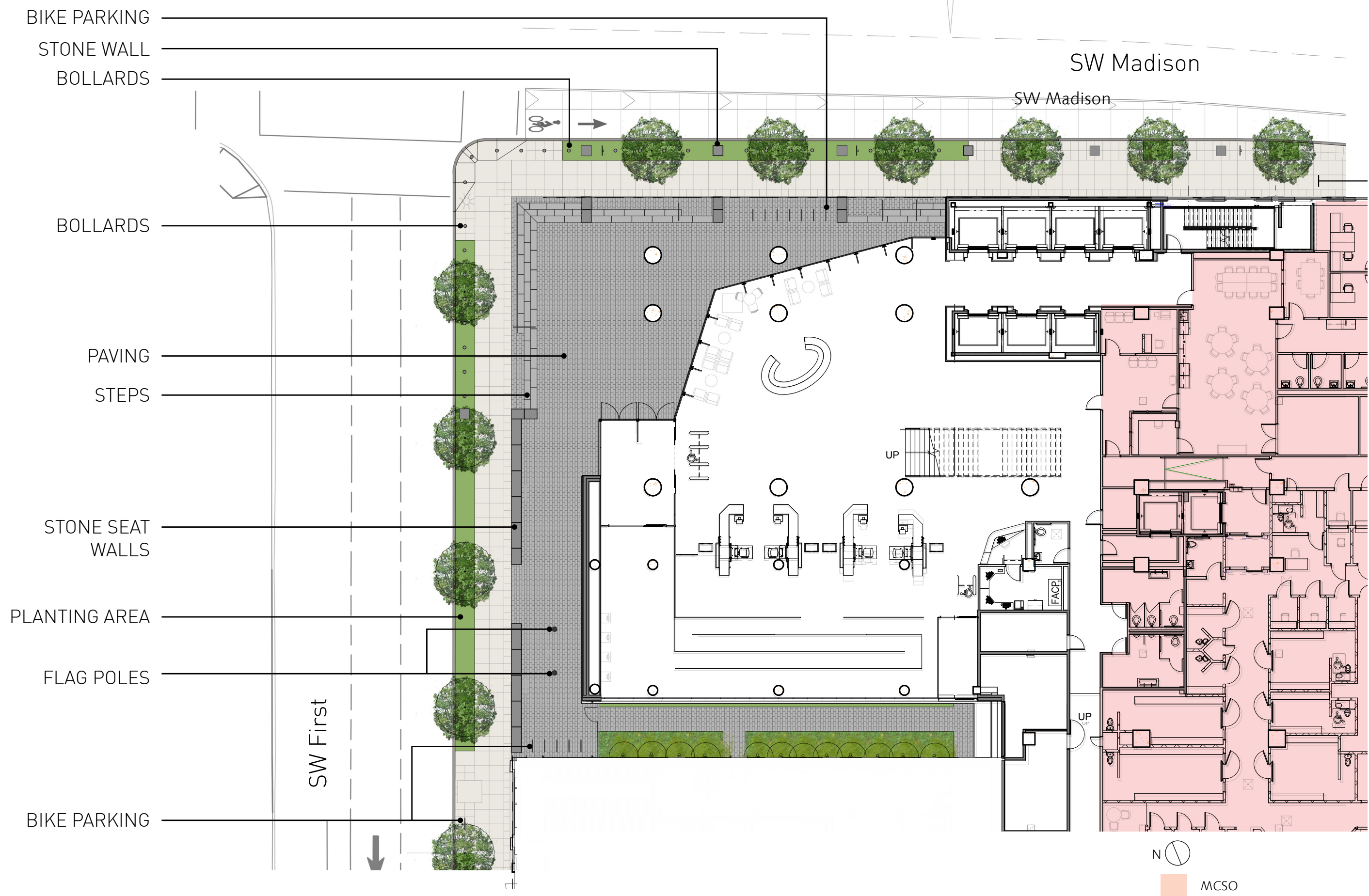

First Ave Plan





1914



1997

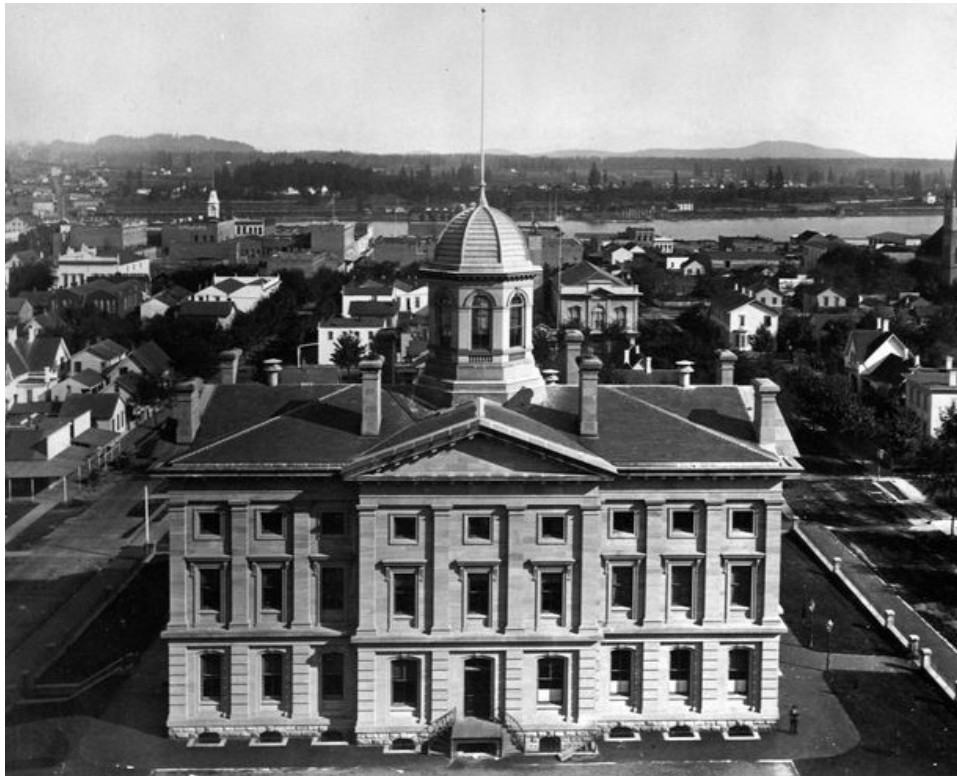

1869



1933



Composition, Materiality and Depth - Design Drivers



Portland Courthouses

Multnomah County Central Courthouse | DAR Hearing 2 | July 7 2016
EA #16-130513 DA

SRG Partnership | CGL Ricci Greene