

RECORDING REQUESTED BY:
Fidelity National Title Company of Oregon

GRANTOR'S NAME:
J Jene Holdings LLC

GRANTEE'S NAME:
The City of Portland

SEND TAX STATEMENTS TO:
The City of Portland
Portland Parks and Recreation
1120 SW 5th Ave, Room 1302
Portland, OR 97204

AFTER RECORDING RETURN TO:

Escrow No: 20100015643-FTPOR01

Multnomah County Official Records
C. Swick, Deputy Clerk

2010-148311



\$46.00

00756169201001483110030030

11/23/2010 03:33:17 PM

1R-B&S DEED

Cnt=1 Stn=43 ATRGW

\$15.00 \$11.00 \$15.00 \$5.00

SPACE ABOVE THIS LINE FOR RECORDER'S USE

BARGAIN AND SALE DEED – STATUTORY FORM
(INDIVIDUAL or CORPORATION)

J Jene Holdings LLC, an Oregon limited liability company, Grantor, conveys to The City of Portland, an Oregon municipal corporation, Grantee, the following described real property, situated in the County of Multnomah, State of Oregon,

That tract of land in the City of Portland, County of Multnomah and State of Oregon, lying in the James Thompson Donation Land Claim in the Southeast quarter of Section 21, Township 1 North, Range 1 East of the Willamette Meridian, described as follows:

Beginning at the Northwest corner of OVERLOOK, said corner also being the Southwest corner of the Griswold tract, according to the recorded plats thereof, and as referred to in Book 643, Page 55; and running thence Southerly along the Westerly line of OVERLOOK 165.0 feet to the true place of beginning of the tract of land herein described; thence Southwesterly at right angles to said Westerly line of said OVERLOOK, a distance of 70 feet; thence Southerly, parallel to said Westerly line of OVERLOOK, a distance of 100 feet; thence Northeasterly a distance of 70 feet to a point in said Westerly line of OVERLOOK, which point is 100.0 feet Southerly of the true point of beginning; thence Northerly a distance of 100.00 feet to the true point of beginning.

BEFORE SIGNING OR ACCEPTING THIS INSTRUMENT, THE PERSON TRANSFERRING FEE TITLE SHOULD INQUIRE ABOUT THE PERSON'S RIGHTS, IF ANY, UNDER ORS 195.300, 195.301 AND 195.305 TO 195.336 AND SECTIONS 5 TO 11, CHAPTER 424, OREGON LAWS 2007, AND SECTIONS 2 TO 9 AND 17, CHAPTER 855, OREGON LAWS 2009. THIS INSTRUMENT DOES NOT ALLOW USE OF THE PROPERTY DESCRIBED IN THIS INSTRUMENT IN VIOLATION OF APPLICABLE LAND USE LAWS AND REGULATIONS. BEFORE SIGNING OR ACCEPTING THIS INSTRUMENT, THE PERSON ACQUIRING FEE TITLE TO THE PROPERTY SHOULD CHECK WITH THE APPROPRIATE CITY OR COUNTY PLANNING DEPARTMENT TO VERIFY THAT THE UNIT OF LAND BEING TRANSFERRED IS A LAWFULLY ESTABLISHED LOT OR PARCEL, AS DEFINED IN ORS 92.010 OR 215.010, TO VERIFY THE APPROVED USES OF THE LOT OR PARCEL, TO DETERMINE ANY LIMITS ON LAWSUITS AGAINST FARMING OR FOREST PRACTICES, AS DEFINED IN ORS 30.930, AND TO INQUIRE ABOUT THE RIGHTS OF NEIGHBORING PROPERTY OWNERS, IF ANY, UNDER ORS 195.300, 195.301 AND 195.305 TO 195.336 AND SECTIONS 5 TO 11, CHAPTER 424, OREGON LAWS 2007, AND SECTIONS 2 TO 9 AND 17, CHAPTER 855, OREGON LAWS 2009.

J Jene Holdings LLC

BY:

Joanne Jene Member

Joanne Jene, Sole Member

State of OREGON

COUNTY of Multnomah

This instrument was acknowledged before me on November 18, 2010 by Joanne Jene, Sole Member of J Jene Holdings LLC, an Oregon limited liability company.

_____, Notary Public - State of Oregon

My commission expires: 1-31-2013



Bargain & Sale Deed dated 11/18/2010 is approved by:

Nick Fish

Nick Fish, Commissioner, Parks & Recreation of
The City of Portland

STATE OF OREGON)

COUNTY OF MULTNOMAH)

On November 22, 2010, before me personally appeared Nick Fish whose identity was established to my satisfaction and who said he is the Commissioner, Parks and Recreation of the City of Portland, that the seal if any, affixed to the foregoing instrument is the corporate seal of the corporation, that the instrument was executed on behalf of the corporation by the authority of its Board of Directors; and that he acknowledges the instrument as the free act and deed of the corporation.

IN WITNESS WHEREOF, I have hereunto set my hand and affixed by official seal on the date first written above.

Don Connolly
Notary Public for Oregon
My commission expires: 7.24.12

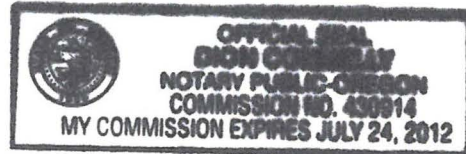

Don Connolly
430914

APPROVED AS TO FORM

Linda Nguyen
CITY ATTORNEY

PortlandMaps

[New Search](#) | [Mapping](#) | [Advanced](#) | [Google Earth](#) | [Help](#) | [PortlandOnline](#)
**NO ADDRESS AVAILABLE - OVERLOOK -
PORTLAND**
[Explorer](#) | **[Property](#)** | [Maps](#) | [Projects](#) | [Crime](#) | [Census](#) |
[Environmental](#) | [Transportation](#)
[Summary](#) | **[Assessor](#)** | [Permits/Cases](#) | [Block](#) | [Schools](#) | [Parks](#) | [Development](#) | [Garbage/Recycling](#) | [Noise](#) | [Historic](#)
[Permits](#) | [Water](#)
General Information

Property ID	R316041
County	MULTNOMAH
State ID	1N1E21DB 2000
Alt Account #	R941210660
Map Number	2628 OLD
Site Info	
Site Address	N SKIDMORE TER
City/State/Zip	PORTLAND OR 97217
Owner Info (Privacy)	
Owner(s) Name	PORTLAND CITY OF % PORTLAND PARKS & RECREATION
Owner Address	1120 SW 5TH AVE #1302
City/State/Zip	PORTLAND OR 97204

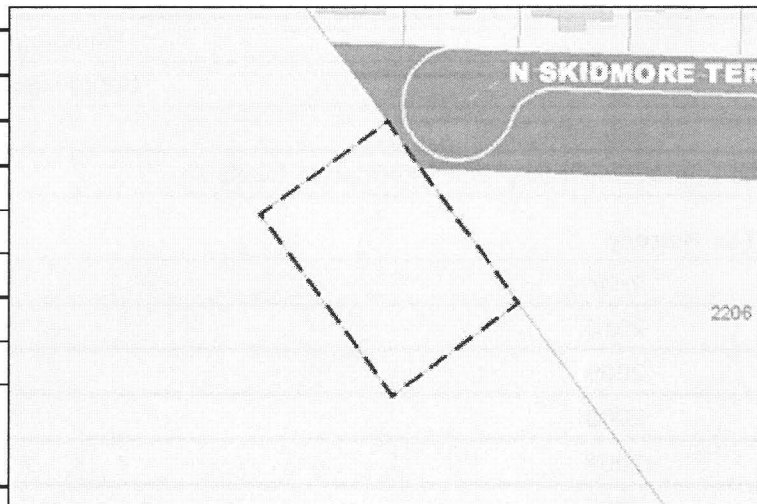
**Property Description**

Tax Roll	SECTION 21 1N 1E, TL 2000 0.16 ACRES	Use	VACANT LAND
Lot	TL 2000	Block	
Tax Districts			
101	PORT OF PORTLAND	130	CITY OF PORTLAND
130L	CITY OF PORTLAND CHILDREN LOP	130M	CITY OF PORTLAND PARKS LOP
143	METRO	164	EAST MULT SOIL/WATER
170	MULTNOMAH COUNTY	170L	MULT CO LIBRARY LOCAL OPT TAX
171	URBAN RENEWAL PORTLAND	173	URB REN SPECIAL LEVY - PORTLAND
198	TRI-MET TRANSPORTATION	304	MULTNOMAH CO ESD
309	PORTLAND COMM COLLEGE	311	PORTLAND SCHOOL DIST #1

Deed Information

Sale Date	Type	Instrument	Sale Price
11/18/2010	BARGAIN & SALE DEED	2010148311	\$210,000.00
	INST	BP08541158	\$0.00
	WARRANTY DEED	2009071636	\$0.00

Land Information

Type	Acres	SQFT
RESIDENTIAL LAND	0.1600	7,000

Improvement Information

Improvement Type
Improvement Value \$0.00

Room Descriptions	
Building Class	
Actual Year Built	Effective Year Built
Number of Segments	Construction Style
Foundation Type	Interior Finish
Roof Style	Roof Cover Type
Flooring Type	Heating/AC Type
Plumbing	Fireplace Type

Improvement Details

# Segment Type	Class	Total Area
No Improvement Segment Information Available		

Tax History

Year	Property Tax	Total Tax
2010	\$25.59	\$25.59
2009	\$25.69	\$25.69
2008	\$25.41	\$25.41
2007	\$25.50	\$25.50
2006	\$25.30	\$25.30
2005	\$25.41	\$25.41
2004	\$29.81	\$29.81
2003	\$27.10	\$27.10
2002	\$281.04	\$281.04
2001	\$268.91	\$268.91
2000	\$230.93	\$230.93
1999	\$222.02	\$222.02
1998	\$216.22	\$216.22
1997	\$226.79	\$226.79

Assessment History

Year	Improvements	Land	Special Mkt/Use	Real Market	Exemptions	Assessed
2010	\$0.00	\$1,600.00	\$0.00	\$1,600.00	\$0.00	\$1,600.00
2009	\$0.00	\$1,600.00	\$0.00	\$1,600.00	\$0.00	\$1,600.00
2008	\$0.00	\$1,600.00	\$0.00	\$1,600.00	\$0.00	\$1,600.00
2007	\$0.00	\$1,600.00	\$0.00	\$1,600.00	\$0.00	\$1,600.00
2006	\$0.00	\$1,600.00	\$0.00	\$1,600.00	\$0.00	\$1,600.00
2005	\$0.00	\$1,600.00	\$0.00	\$1,600.00	\$0.00	\$1,600.00
2004	\$0.00	\$1,760.00	\$0.00	\$1,760.00	\$0.00	\$1,760.00
2003	\$0.00	\$1,600.00	\$0.00	\$1,600.00	\$0.00	\$1,600.00
2002	\$0.00	\$16,470.00	\$0.00	\$16,470.00	\$0.00	\$16,470.00
2001	\$0.00	\$15,680.00	\$0.00	\$15,680.00	\$0.00	\$15,680.00
2000	\$0.00	\$13,520.00	\$0.00	\$13,520.00	\$0.00	\$13,520.00
1999	\$0.00	\$13,000.00	\$0.00	\$13,000.00	\$0.00	\$13,000.00

1998	\$0.00	\$12,600.00	\$0.00	\$12,600.00	\$0.00	\$12,600.00
1997	\$0.00	\$12,900.00	\$0.00	\$12,900.00	\$0.00	\$12,900.00

City of Portland, Corporate GIS

Assessor Data Updated 1/31/2011

THE GIS APPLICATIONS ACCESSED THROUGH THIS WEB SITE PROVIDE A VISUAL DISPLAY OF DATA FOR YOUR CONVENIENCE. EVERY REASONABLE EFFORT HAS BEEN MADE TO ASSURE THE ACCURACY OF THE MAPS AND ASSOCIATED DATA. THE CITY OF PORTLAND MAKES NO WARRANTY, REPRESENTATION OR GUARANTEE AS TO THE CONTENT, SEQUENCE, ACCURACY, TIMELINESS OR COMPLETENESS OF ANY OF THE DATA PROVIDED HEREIN. THE USER OF THESE APPLICATIONS SHOULD NOT RELY ON THE DATA PROVIDED HEREIN FOR ANY REASON. THE CITY OF PORTLAND EXPLICITLY DISCLAIMS ANY REPRESENTATIONS AND WARRANTIES, INCLUDING, WITHOUT LIMITATION, THE IMPLIED WARRANTIES OF MERCHANTABILITY AND FITNESS FOR A PARTICULAR PURPOSE. THE CITY OF PORTLAND SHALL ASSUME NO LIABILITY FOR ANY ERRORS, OMISSIONS, OR INACCURACIES IN THE INFORMATION PROVIDED REGARDLESS OF HOW CAUSED. THE CITY OF PORTLAND SHALL ASSUME NO LIABILITY FOR ANY DECISIONS MADE OR ACTIONS TAKEN OR NOT TAKEN BY THE USER OF THE APPLICATIONS IN RELIANCE UPON ANY INFORMATION OR DATA FURNISHED HEREUNDER. FOR UPDATED INFORMATION ABOUT THE MAP DATA ON PORTLANDMAPS PLEASE REFER TO [CITY'S METADATA](#). FOR QUESTIONS ABOUT ASSESSMENT INFORMATION PLEASE CONTACT THE COUNTY ASSESSORS OFFICE IN YOUR COUNTY.

[Address](#) | [Mapping](#) | [Advanced](#) | [Google Earth](#) | [Help](#) | [About](#)

PortlandMaps © 2011 [City of Portland, Oregon](#)