

Multnomah County Official Records
R Weldon, Deputy Clerk

2015-067945



01518601201500679450040043

\$51.00

06/09/2015 07:46:21 AM

2R-ORDINANC
\$20.00 \$11.00 \$20.00

Pgs=4 Stn=23 ATPRC

CITY OF PORTLAND
Office of the City Auditor
1221 SW Fourth Avenue, Room 130
Portland, OR 97204-1900

I hereby certify this Ordinance No. 186408 to be a complete and exact copy of the original as the same appears on file and of record in my office and in my care and custody on June 4, 2015.

Mary Hull Caballero
Auditor of the City of Portland

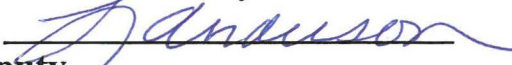
By 
Deputy

ORDINANCE No. 186408

*Return ownership and control of a parcel of real property located at SW McDonnell Terrace and SW Council Crest Drive to the Bureau of Environmental Services (Ordinance; repeal Ordinance No. 183123)

The City of Portland ordains:

Section 1. The Council finds:

1. Ordinance No. 183123, passed by City Council on August 19, 2009, designated and assigned a parcel of real property located at SW McDonnell Terrace and SW Council Crest Drive to the Bureau of Planning and Sustainability for use in the Diggable Cities Program.
2. This assignment was made in error. The intent of the ordinance was to designate and assign a parcel of property at SE Sherrett & 34th, not the property described in the ordinance.
3. The Bureau of Environmental Services acquired the property legally described below as a result of a legal settlement with George & Marietta Spada in July 2006, and has managed and maintained said property since acquiring ownership rights.
4. The Bureau of Planning and Sustainability acknowledges that the property was assigned in error and without any transfer of funds for fair market value.
5. There is no cost to either the Bureau of Environmental Services or the Bureau of Planning and Sustainability for this action.

NOW, THEREFORE, the Council directs:

- a. That Ordinance No. 183123 is repealed in its entirety and the following described property is hereby returned to the ownership and control of the Bureau of Environmental Services.

Lot 9, Block 9, Replat of Healy Heights, in the City of Portland, County of Multnomah and State of Oregon, as depicted on the attached Exhibit A. (1S1E09CD 1400; R178250)

- b. That the Auditor shall return a certified copy of this Ordinance to the Facilities/Administrative Services Manager in the Bureau of Environmental Services for recording in the Multnomah County Deed Records. The original recorded Ordinance shall be returned to the Auditor and the Bureau of Environmental Services shall keep a copy for their records and send a copy of the recorded Ordinance to the Bureau of Planning and Sustainability.

Section 2. The Council declares that an emergency exists because a delay in clarifying the ownership and control of the property might cause confusion in the public record and prevent the Bureau of Environmental Services from actively managing this site. Therefore, this ordinance shall be in full force and effect from and after its passage by the Council.

Passed by the Council,
Commissioner Nick Fish

JAN 08 2014

Scott Turpen / lb
November 25, 2013

ESBS000004 - ord

LaVonne Griffin-Valade
Auditor of the City of Portland

By 

Deputy

Exhibit A

PortlandMaps

[New Search](#) | [Mapping](#) | [Advanced](#) | [Google Earth](#) | [Help](#) | [PortlandOnline](#)

NO ADDRESS AVAILABLE - HEALY HEIGHTS/SOUTHWEST HILLS - PORTLAND

[Explorer](#) | [Property](#) | [Maps](#) | [Projects](#) | [Crime](#) | [Census](#) | [Environmental](#) | [Transportation](#)

Explore the area, view different themes

[Property Detail](#)

Long -122.69752 Lat 45.49213

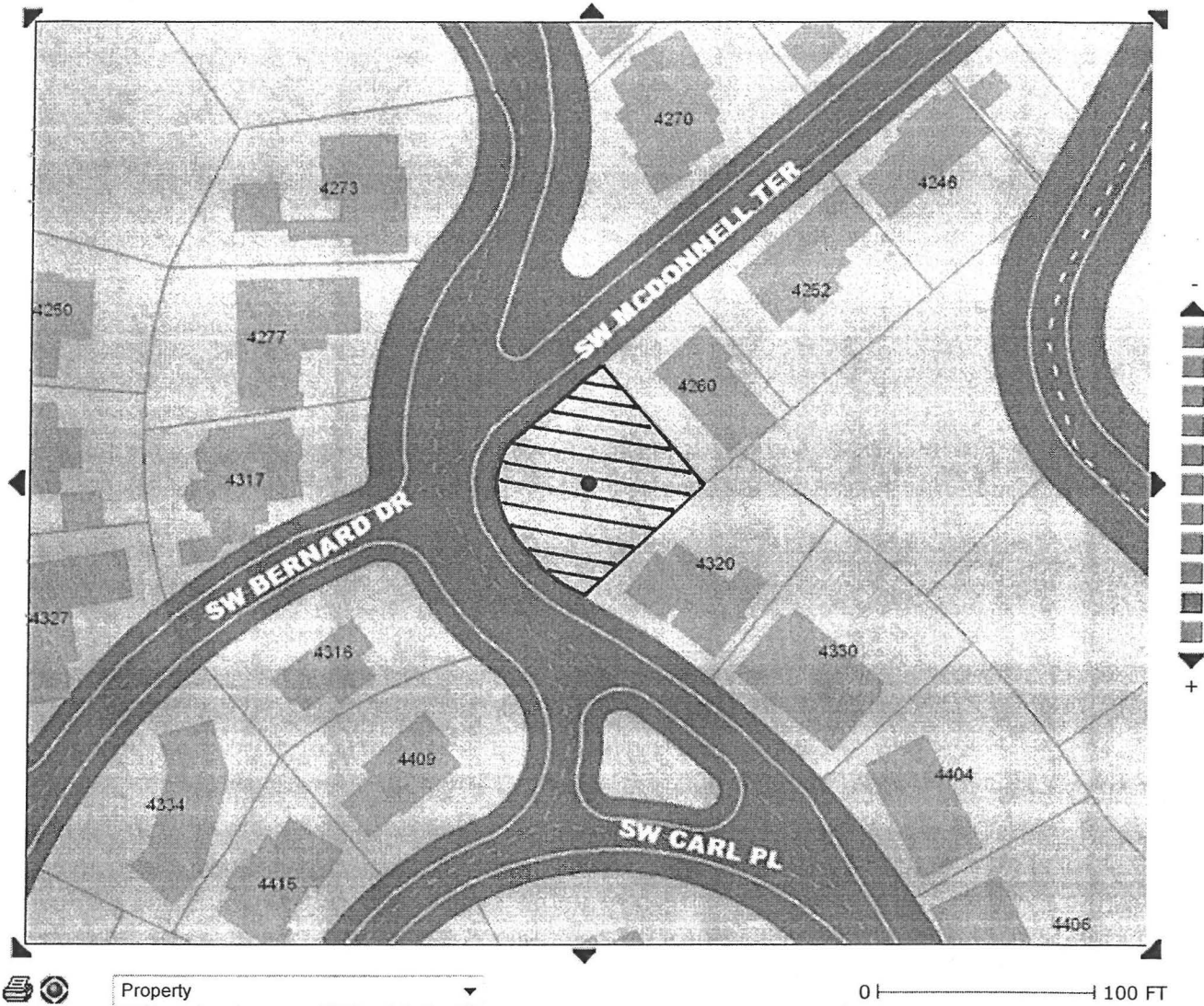

City of Portland, Corporate GIS

11/26/2013

THE GIS APPLICATIONS ACCESSED THROUGH THIS WEB SITE PROVIDE A VISUAL DISPLAY OF DATA FOR YOUR CONVENIENCE. EVERY REASONABLE EFFORT HAS BEEN MADE TO ASSURE THE ACCURACY OF THE MAPS AND ASSOCIATED DATA. THE CITY OF PORTLAND MAKES NO WARRANTY, REPRESENTATION OR GUARANTEE AS TO THE CONTENT, SEQUENCE, ACCURACY, TIMELINESS OR COMPLETENESS OF ANY OF THE DATA PROVIDED HEREIN. THE USER OF THESE APPLICATIONS SHOULD NOT RELY ON THE DATA PROVIDED HEREIN FOR ANY REASON. THE CITY OF PORTLAND EXPLICITLY DISCLAIMS ANY REPRESENTATIONS AND WARRANTIES, INCLUDING, WITHOUT LIMITATION, THE IMPLIED WARRANTIES OF MERCHANTABILITY AND FITNESS FOR A PARTICULAR PURPOSE. THE CITY OF PORTLAND SHALL ASSUME NO LIABILITY FOR ANY ERRORS, OMISSIONS, OR INACCURACIES IN THE INFORMATION PROVIDED REGARDLESS OF HOW CAUSED. THE CITY OF PORTLAND SHALL ASSUME NO LIABILITY FOR ANY DECISIONS MADE OR ACTIONS TAKEN OR NOT TAKEN BY THE USER OF THE APPLICATIONS IN RELIANCE UPON ANY INFORMATION OR DATA FURNISHED HEREUNDER. FOR UPDATED INFORMATION ABOUT THE MAP DATA ON PORTLANDMAPS PLEASE REFER TO [CITY'S METADATA](#). FOR QUESTIONS ABOUT ASSESSMENT INFORMATION PLEASE CONTACT THE COUNTY ASSESSORS OFFICE IN YOUR COUNTY.

[Address](#) | [Mapping](#) | [Advanced](#) | [Google Earth](#) | [Help](#) | [About](#)

PortlandMaps © 2013 [City of Portland, Oregon](#)