



## One North

Comprised of three buildings,  
built by two development teams.

**Karuna II Properties, LLC.**

The East Building

Approx. 38,000 sf

The West Building

Approx. 35,000 sf

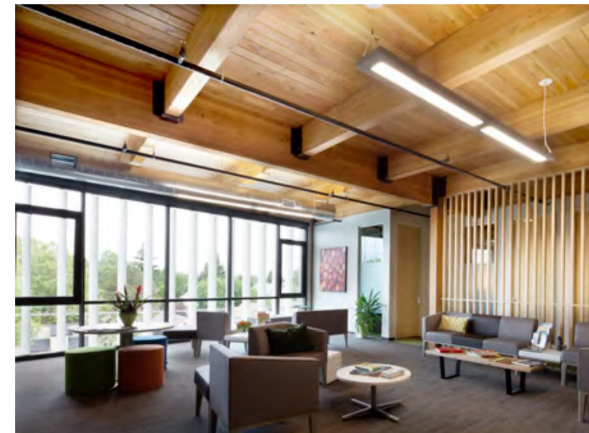

**Kaiser Group, Inc.**

The Radiator

Approx. 36,000 sf



## The Courtyard at One North

### 14,000 square feet of open space

Landscape architect: Lango Hansen

Contractor: R&H Construction

- Notable design elements
  - **Native plant selection** that reflects the natural environment and provides the foundation for urban studies and ecology programs led by Catlin Gabel's PLACE program.
  - **Interactive and engaging features** that encourage exploration from passerby (benches, thresholds, paths, and outdoor spaces that allow for socializing).
  - **Inviting entryways** that welcome pedestrians from the south side and provide connectivity to the Life Change Church from the north side.
  - **Integrated community artwork** - Decorative steel bands engraved with quotes from artists, authors, scientists and members of the community.
- Board of Advisors
  - Community advisory group of thirteen members who meet quarterly to discuss feedback on the courtyard, upcoming events, and future programming.
  - A mix of historic members of the community, neighborhood leaders, and One North tenant representatives.





the CENTER

## One North Partnership with PLACE

- West Building tenant occupying approximately 850 square feet.
- Provided with street-facing access from Vancouver and direct access to the courtyard.
- PLACE is a youth urban planning program of the Catlin Gabel School (Planning and Leadership Across City Environments).
- Engaged to help activate the courtyard and provide urban studies and urban ecology education to youth.
- Evolved into a joint coalition of six non-profit organizations (the CENTER):
  - Black United Fund
  - Catlin Gabel (PLACE)
  - De La Salle North
  - iUrban Teen
  - Kairos PDX
  - Urban League of Portland