

SW DOLPH CT-SPRING GARDEN ST LOCAL IMPROVEMENT DISTRICTIF YOU WISH TO SPEAK TO CITY COUNCIL, **PRINT** YOUR NAME, ADDRESS, AND EMAIL.

NAME (print)

ADDRESS AND ZIP CODE

Email

~~DAVID ~~DAVIS~~ DAVIS~~~~Joseph WALKER~~

✓ Christine M. Abernathy

3218 S.W. Freeman St. Portland 97219

abernathyck@comcast.net

~~Peter McMin~~~~3220 SW Spring Garden 97219~~~~petemcminn@gmail.com~~

187 740

RECEIVED

APR 22 2016

TRANSPORTATION

Peter McMinn
3220 SW Spring Garden St.
Portland OR 97219
503-892-3928
petemcminn@gmail.com

4/22/16

Andrew Aiebi
Local Improvement District Administrator
City of Portland PBOT

Dear LID Administrators and Committee members:

I am a long-term resident on SW Spring Garden St, at the northeast corner of Spring Garden Park. Over recent years, we've watched crews mark the street for improvements only to see no action afterwards. The road continues to deteriorate and is increasingly hazardous to the many walkers and cyclists in the area. The most concerning hazard is not caused by the widening potholes, however. The fact of speeding automobiles is by far the most dangerous aspect of the stretch of Spring Garden from 30th to 35th.

Spring Garden St. is also frequented by several public and private utility vehicles, some of which are quite heavy. These include construction vehicles looking for straight routes between Multnomah and Barbur and regular fire truck and school bus usage. Combined with the coming parade of machinery and equipment used for developing the park, this usage continues to erode the already crumbling asphalt.

When it was revealed recently that only the section of road along the park is to be improved, we—neighbors on Spring Garden St—were dismayed. Not only is the road falling apart, traffic cutting through from Barbur and Capital is only increasing. Many drivers not living in the immediate area use it as a shortcut; and with the increased foot traffic that the new park will bring, the potential of an accident will surely increase.

I request a) that street improvements on Spring Garden St. from SW 30th to SW 35th be vigorously reconsidered; and b) that permanent speed suppression be implemented as part of a progressive plan that prioritizes the health and safety of the neighborhood.

I have noticed many young families moving into our neighborhood. With the park development completed within two years, will an unimproved Spring Garden Street at that point be more of a hazard to our community than it is now? I strongly urge the Portland Bureau of Transportation to ensure safe driving on this street as use of the park increases.

Thank you for your time and effort in making out streets safe.

Sincerely,

Peter McMinn

Aebi, Andrew

From: Chris Powers <cdesignportland@comcast.net>
Sent: Tuesday, April 26, 2016 12:32 PM
To: Aebi, Andrew
Subject: Re: Spring Garden Park

Hi Andrew,

Thank you for your clarifications regarding the status of the Spring Garden LID. In light of our conversation, I am withdrawing my remonstrance from consideration.

Christine Powers
 3301 SW Spring Garden Street
 Portland, OR 97219

From: "Aebi, Andrew" <Andrew.Aebi@portlandoregon.gov>
Date: Tuesday, April 26, 2016 12:19 PM
To: Chris Powers <cdesignportland@comcast.net>
Subject: RE: Spring Garden Park

Chris, thank you for the opportunity to discuss this today. I understand that you wish to withdraw your remonstrance. If you could confirm that via return e-mail, that would be helpful.

Thank you,

Andrew

Andrew Aebi MBA

Local Improvement District Administrator | City of Portland | Bureau of Transportation
 voice 503.823.5648 | fax 503.823.7371
 e-mail: andrew.aebi@portlandoregon.gov
 website: www.portlandoregon.gov/transportation/article/82647

Public Records Law Disclosure: This e-mail is a public record of the City of Portland and is subject to public disclosure unless exempt from disclosure under Oregon Public Records Law. This e-mail is also subject to applicable retention schedules.

Equal Access Disclosure: The City of Portland complies with all non-discrimination, Civil Rights laws including Civil Rights Title VI and ADA Title II. To help ensure equal access to City programs, services and activities, the City of Portland will reasonably modify policies/procedures and provide auxiliary aids/services to persons with disabilities. Call 503-823-5185, TTY 503-823-6868 or Oregon Relay Service: 711 with such requests, or visit <http://bit.ly/13EWaCg>

From: Chris Powers [<mailto:cdesignportland@comcast.net>]
Sent: Tuesday, April 26, 2016 12:06 PM
To: Aebi, Andrew <Andrew.Aebi@portlandoregon.gov>
Subject: Spring Garden Park

Hi Andrew,

Thank you for your phone call this morning. I assume it was regarding my letter to Mary Hull Caballero. Rather than wait for the finish of your meeting with Matt Dinsmore and later clarifications regarding LID responsibilities, I simply decided to beat the April 27th deadline for submission, and drop off my objection.

Reading through the initial LID announcement, the colored boundaries seemed clear to me that even though our properties were identified, it didn't appear that any of our properties were included in the LID. I have to say that it was the verbage that brought our responsibility into question.

We are all breathing a sigh of relief. Thank you for your time and attention to our concerns. We appreciate it.

Regards,

Caroline Powers
graphic design +



tel 503 381 8361
carolinepowers@comcast.net
1000 SW 10th Avenue, Suite 1000, Portland, OR 97204

187 740

APR 25 16 01:50 PM

AUDITOR

April 25, 2016

Auditor Mary Hull Caballero
City of Portland, OR
1221 SW Fourth Avenue
Portland, OR 97204

Re: Property assessments for infrastructure at Spring Garden Park

Dear Ms. Hull Caballero,

I live across the street from Spring Garden Park and have been receiving notices of the improvements that will be taking place at Spring Garden Park. Of particular concern is the financial responsibility of adjacent property owners' assessments for the new infrastructure abutting the park property on both Spring Garden Street and Dolph Court. The communications suggest that the properties that front the north side of Dolph Street will be assessed for improvements, but many of us along Spring Garden Street and on the south side of Dolph Court opposite the park are unsure of how or whether we will be assessed for the cost of improvements.

Rather than wait for further clarification, I am sending this remonstrance (as suggested by Andrew Aebi, PBOT) to request I be allowed to withdraw my property from any assessment for and installation of sidewalk/road construction for civic access to the park along Spring Garden Street. I am retired and on a fixed income and will have to give up homeownership if billed for the construction. Neighbors have calculated the assessment to be about \$42,000 financed over a 20-year span. I'm 68 years of age and have owned my home for 28 years with only nine years left on my mortgage. Adding an estimated \$2,000 annually to my living expenses will jeopardize my financial security.

Thank you for consideration of my remonstrance -- objection to inclusion for financial assessment for the said improvements.

Sincerely,



Christine Powers
3301 SW Spring Garden St.
Portland, OR 97219

503 381 8281

PROPOSED IMPROVEMENT

Notice is hereby given that the Council of the City of Portland intends to construct street, sidewalk, and stormwater improvements in the proposed SW Dolph Court - Spring Garden Street Local Improvement District.

City Council passed Resolution No. 37200 on April 6, 2016 initiating local improvement district formation proceedings. A public hearing for consideration of the proposed street, sidewalk and stormwater improvement is scheduled for May 4, 2016 beginning at 9:30 a.m. in the Council Chambers at City Hall, 1221 SW Fourth Avenue.

The general character and scope of the improvement along the Spring Garden Park frontages is to remove the existing dirt, gravel and/or hard surface; grade the street to its proper subgrade; construct an asphaltic concrete street with an aggregate base; construct stormwater drainage facilities including stormwater planters; construct curb and sidewalk on the park side of the street; extend stormwater sewer and sidewalk along the west side of SW Dolph Court along properties east of Spring Garden Park; and plant street trees adjacent to newly-installed sidewalk of combined widths of 9 feet or more excluding curb.

A map of the area proposed for inclusion in the local improvement district is shown below.

187 740

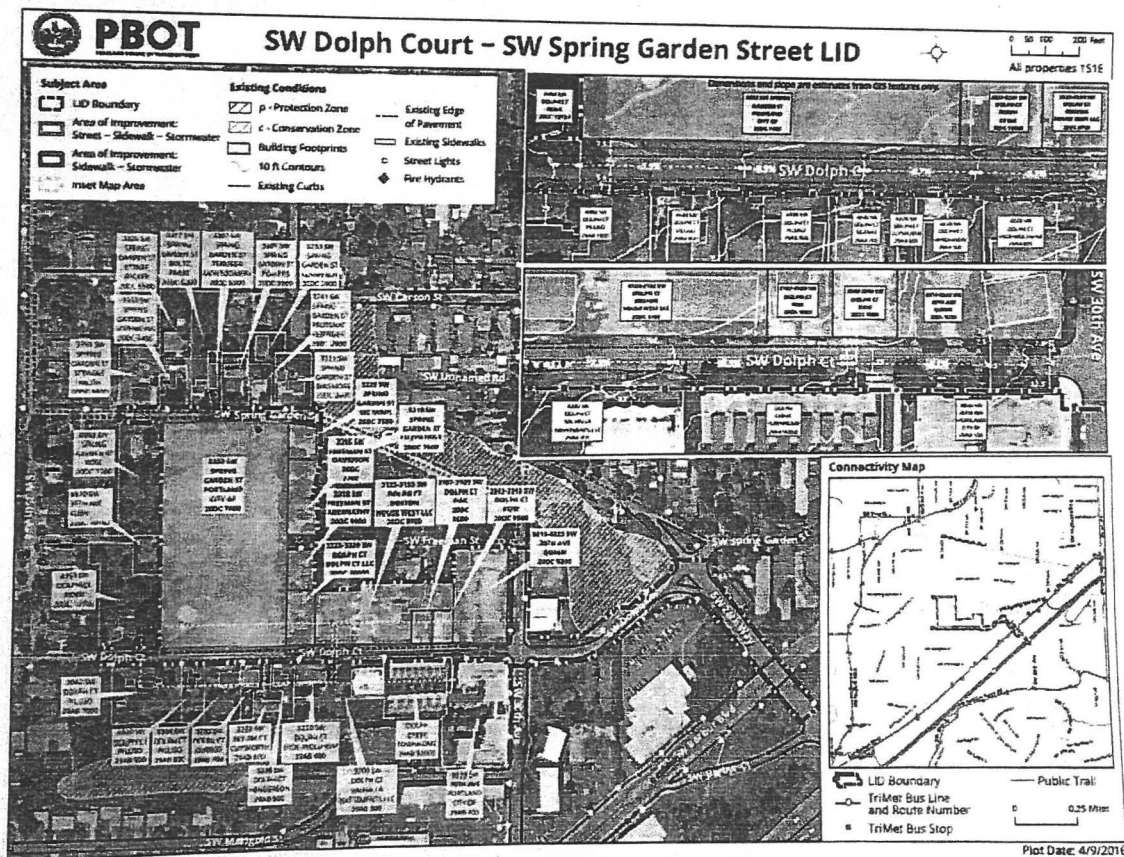

The preliminary estimate of the total cost of the improvements is \$1,462,502.16. The property owners' estimated share is \$1,272,551.79 and properties would be assessed on a combination abutting square footage and equivalent dwelling unit (EDU) basis in two (2) assessment zones. This proposal could be modified as a result of the testimony at the LID Formation Hearing. Property owners should attend the hearing to have an opportunity to testify on proposed changes.

Owners of property in the LID as shown on Multnomah County tax records may file a written remonstrance against the proposed improvement. Any person acting as agent or Attorney with power to act in signing the remonstrance shall, in addition to describing the property affected, file with the remonstrance a copy in writing of the authority to represent the owner or owners of property. Remonstrances must be received by the City Auditor by 5:00 PM on April 27, 2016 and must be sent via first-class mail or delivered in person.

The Local Improvement District Administrator may be contacted via telephone at 503-823-5648 or via e-mail at andrew.aebi@portlandoregon.gov