

E. 35TH ST.

E. 35TH ST.

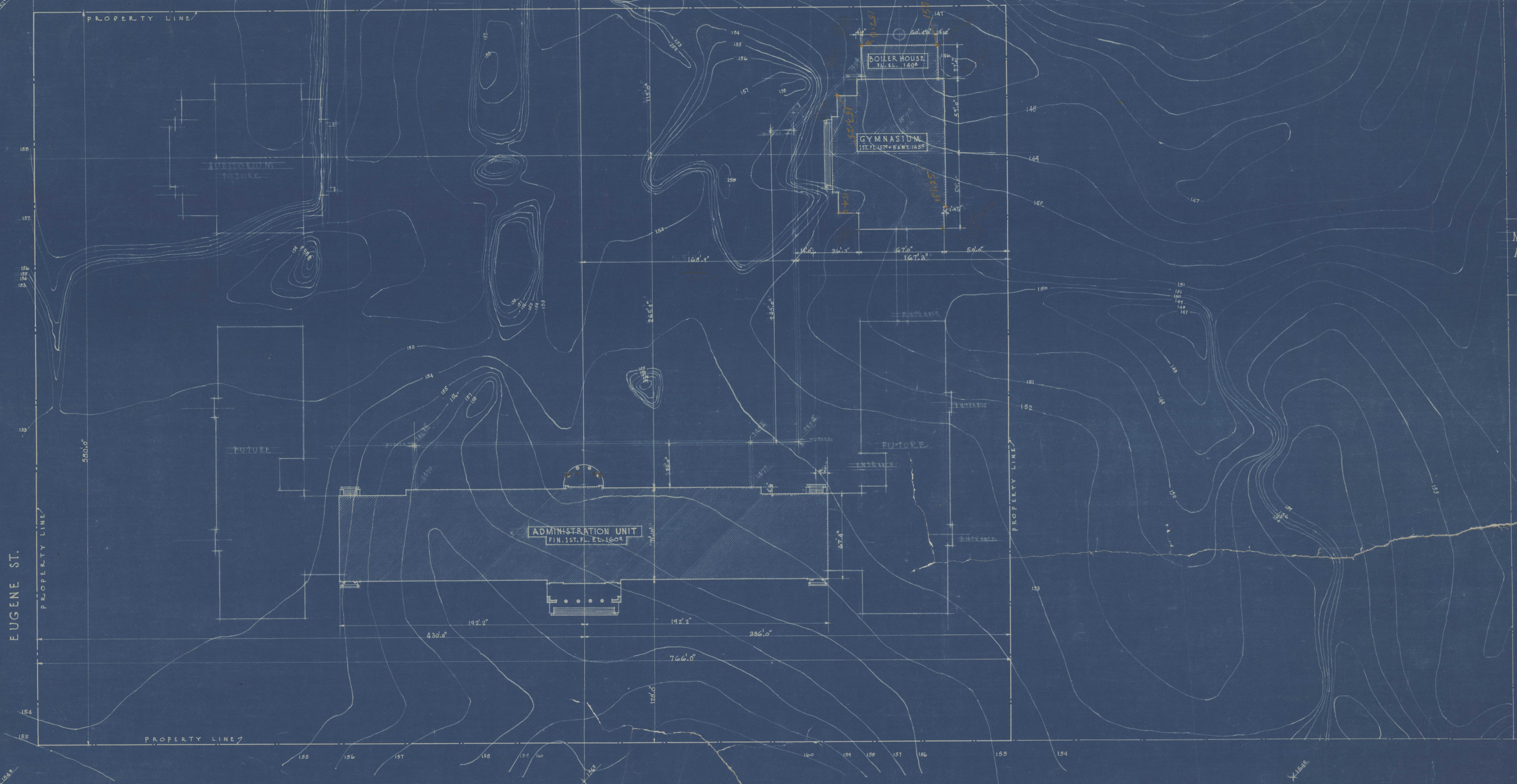

EUGENE ST.

MARG AV.

E. 36TH ST.

THOMPSON ST.

BRAZEE ST.

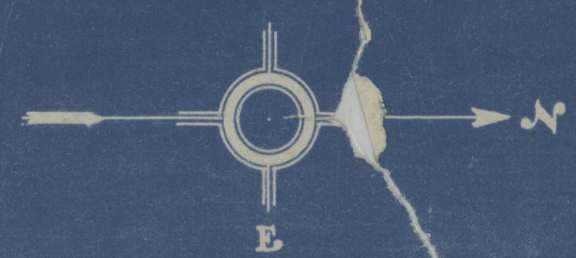

GRADING NOTE:
 FINISH GRADE AROUND BUILDING TO BE EL. 157.7 AS SHOWN
 ON ELEVATIONS & SECTIONS OF BUILDING. ALL EARTH
 AROUND BUILDING TO BE CUT TO THIS EL. 157.7 UNDER
 ANOTHER CONTRACT.
 EXCAVATION BELOW EL. 157.7 FOR WALLS, FOOTINGS,
 FAN ROOM, TRENCHES ETC. TO BE DONE UNDER CONTRACTS
 FOR BUILDING.
 FINISH GRADING TO BE DONE BY OTHERS.