

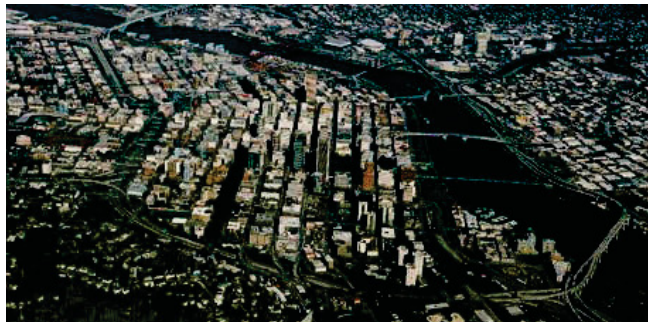

Bureau of Planning and Sustainability
Innovation. Collaboration. Practical Solutions.



Central City 2035: West Quadrant Plan

City Council Hearing on Amendments

March 5, 2015



West Quadrant Districts

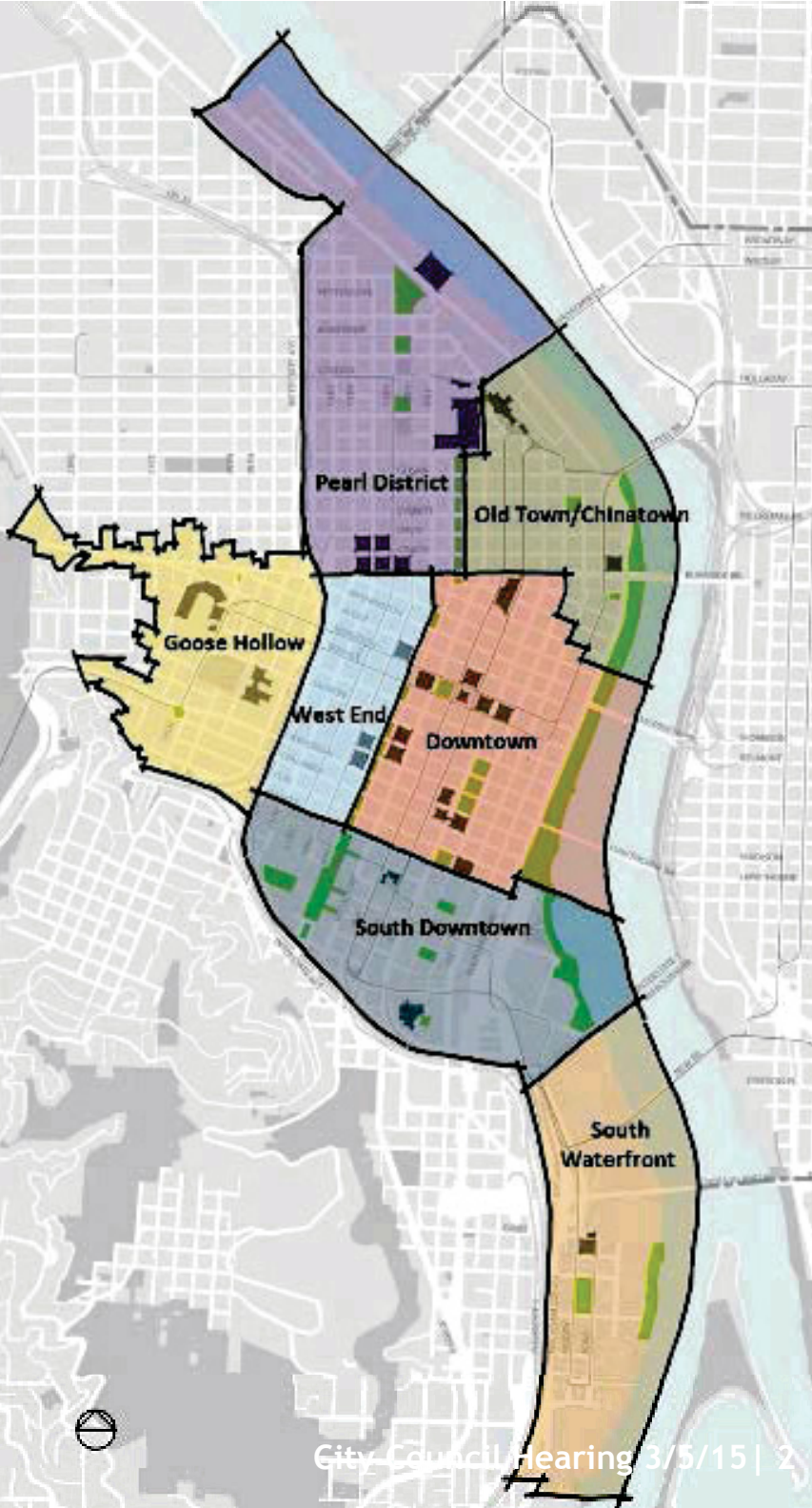

Request of Council

- Adopt the West Quadrant Plan as amended (by resolution)
- Direct BPS to complete CC2035 work program including:
 - SE Quadrant Plan
 - Affordable Housing Bonus Study
 - Scenic Resources Inventory
 - Combined CC2035 Plan including the updated zoning code

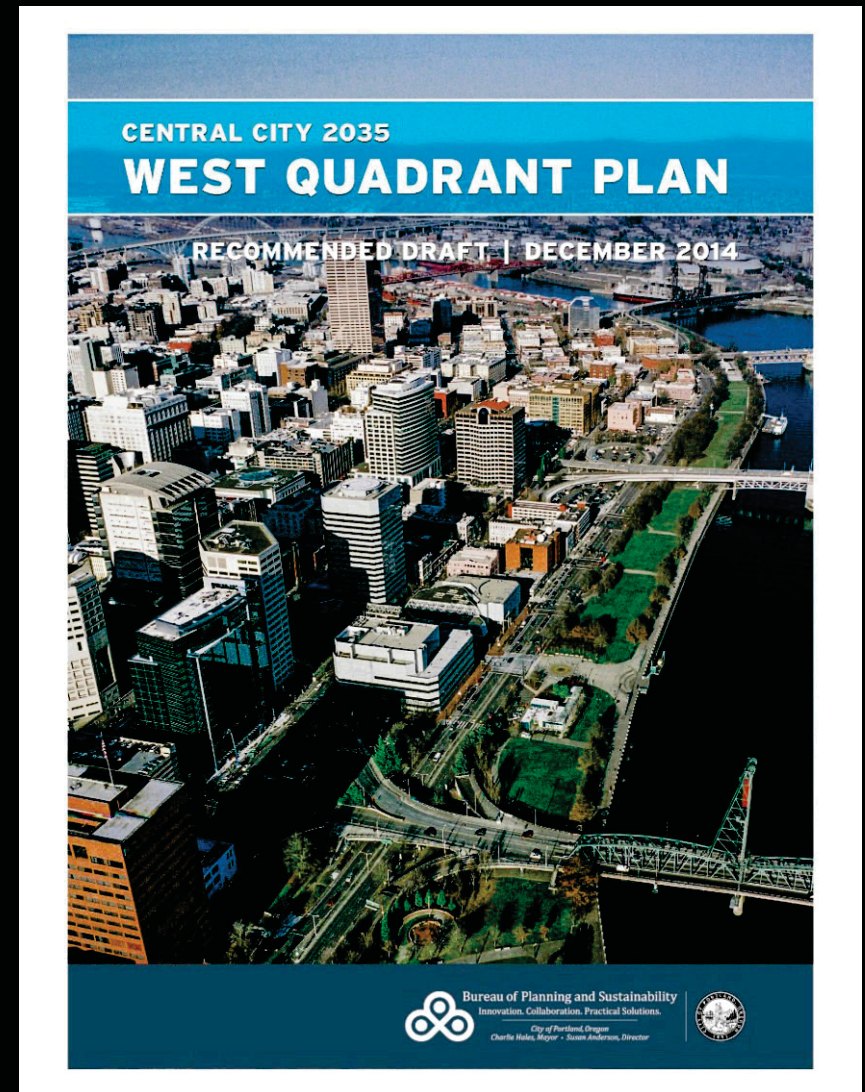

Public Testimony on Amendments

please reference the amendment # (far left column) in testimony

Proposed Amendments to the Recommended Draft West Quadrant Plan

This list contains amendments proposed by Mayor Hales and Commissioners Fritz and Novick. BPS staff have also recommended some amendments based on public testimony and discussions with other bureaus.

Amendments are organized by page number within each topic area: A) Willamette River, Environment & Parks; B) Building Height & Step Down; C) Residential Development; D) Other; and E) Implementer, Lead & Timeline Changes. **The public is welcome to testify on any of the proposed amendments at the March 5, 2015 City Council Hearing. Please reference the Amendment # (far left column) in testimony.**

Note to Commissioners: Under the "Discuss" column, BPS staff has indicated with a check mark which issues they recommend for discussion. Please let us know before or during council proceedings if there are additional items you wish to discuss. Other items will be considered consent unless Commissioners specifically ask to discuss them.

A. WILLAMETTE RIVER, ENVIRONMENT & PARKS

#	Source	TOPIC Page #/ Reference	Proposed Amendment	Rationale for Proposed Amendment	BPS Recommendation	Discuss?
1	BPS/PHLC/ Deanna Mueller- Crispin	ADAPTIVE REUSE p. vii/Executive Summary	A new generation of innovative <u>new construction and adaptive reuse buildings</u> , technologies, green infrastructure ...	Add "adaptive reuse" to low-carbon-city discussion	Support.	<input type="checkbox"/>
2	BPS/Willie Levenson	BIG PIPE p. 9/Changes to the Natural Landscape section, add as new paragraph at end of section.	<u>In 2011 the City of Portland completed a \$464 million sewer construction project called the East Side Big Pipe Project to control combined sewer overflows into the Willamette and Columbia rivers. For the Central Reach, the project resulted in improved river health for people, fish and other wildlife and created a safer environment for public access into the river. A large sewer pipe was installed paralleling the Willamette River from Southeast Portland to North Portland, with conveyance to the Columbia Boulevard Wastewater Treatment Plant. Combined sewer overflows are infrequent and occurring only during heavy rain episodes. Today, you will find more people seasonally swimming and recreating in the river.</u>	Need to mention the Big Pipe project as a significant investment to improving water quality in the Central Reach, creating a safer environment for public access into the river.	Support.	<input type="checkbox"/>

Draft 2/26/2015, 5 p.m.

1

Amendment Proposal Groups

TOPIC

AMENDMENT

- | | |
|---|----------------|
| ■ Habitat | 7-11 |
| ■ Waterfront Park and Trails | 18, 24, 57, 69 |
| ■ Bridgehead Heights | 40 |
| ■ Pearl District Waterfront | 43 |
| ■ Goose Hollow Required Residential in CX | 45-46 |

Habitat Amendments #7-11

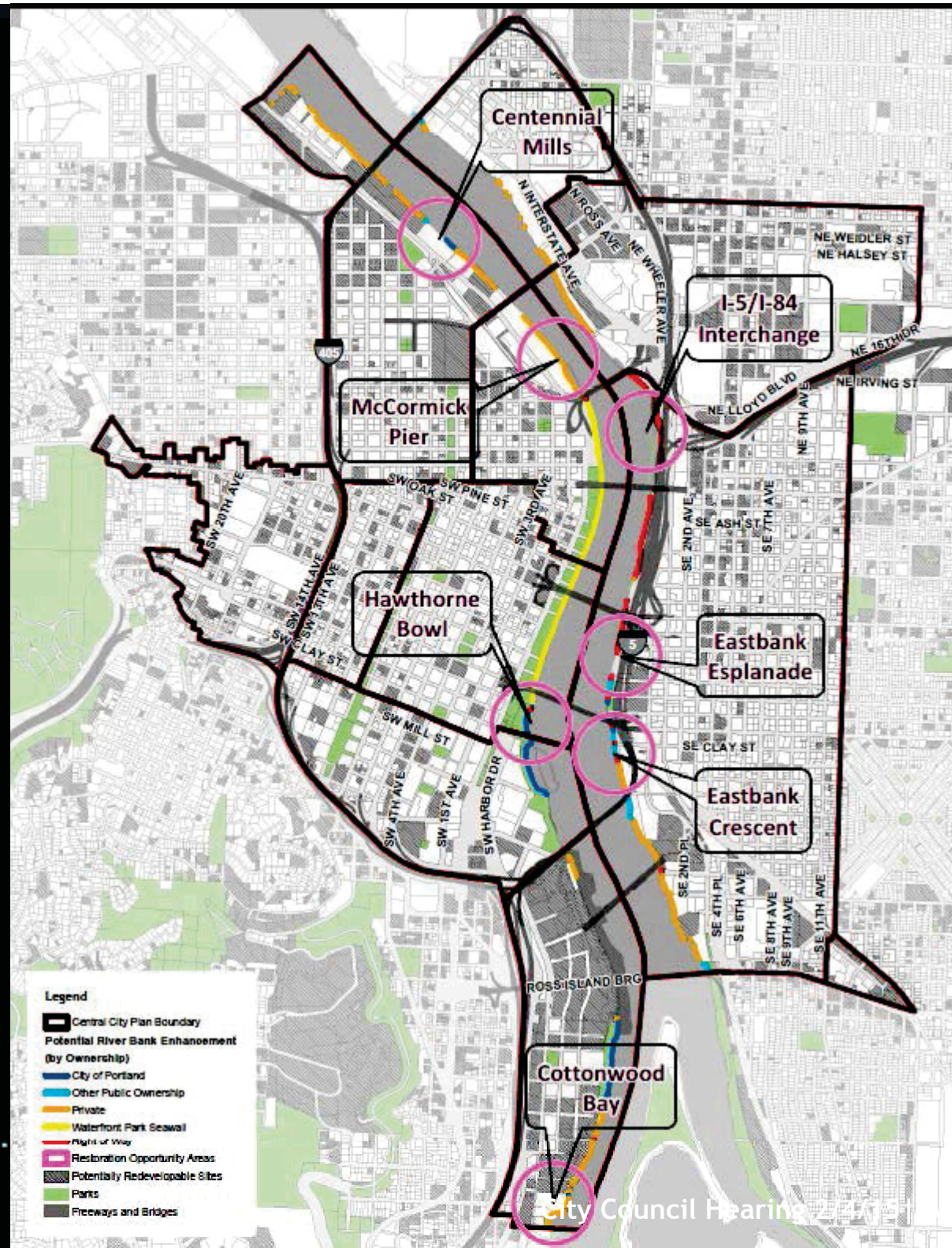

Waterfront Park and Trails

Amendments #18, 24, 57, 69

Waterfront Park Master Plan

Portland, Oregon

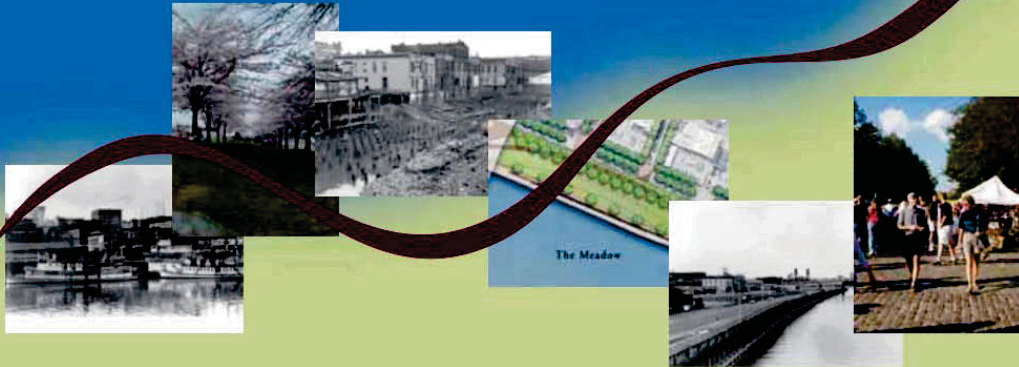

Bridgehead Heights Amendment #40

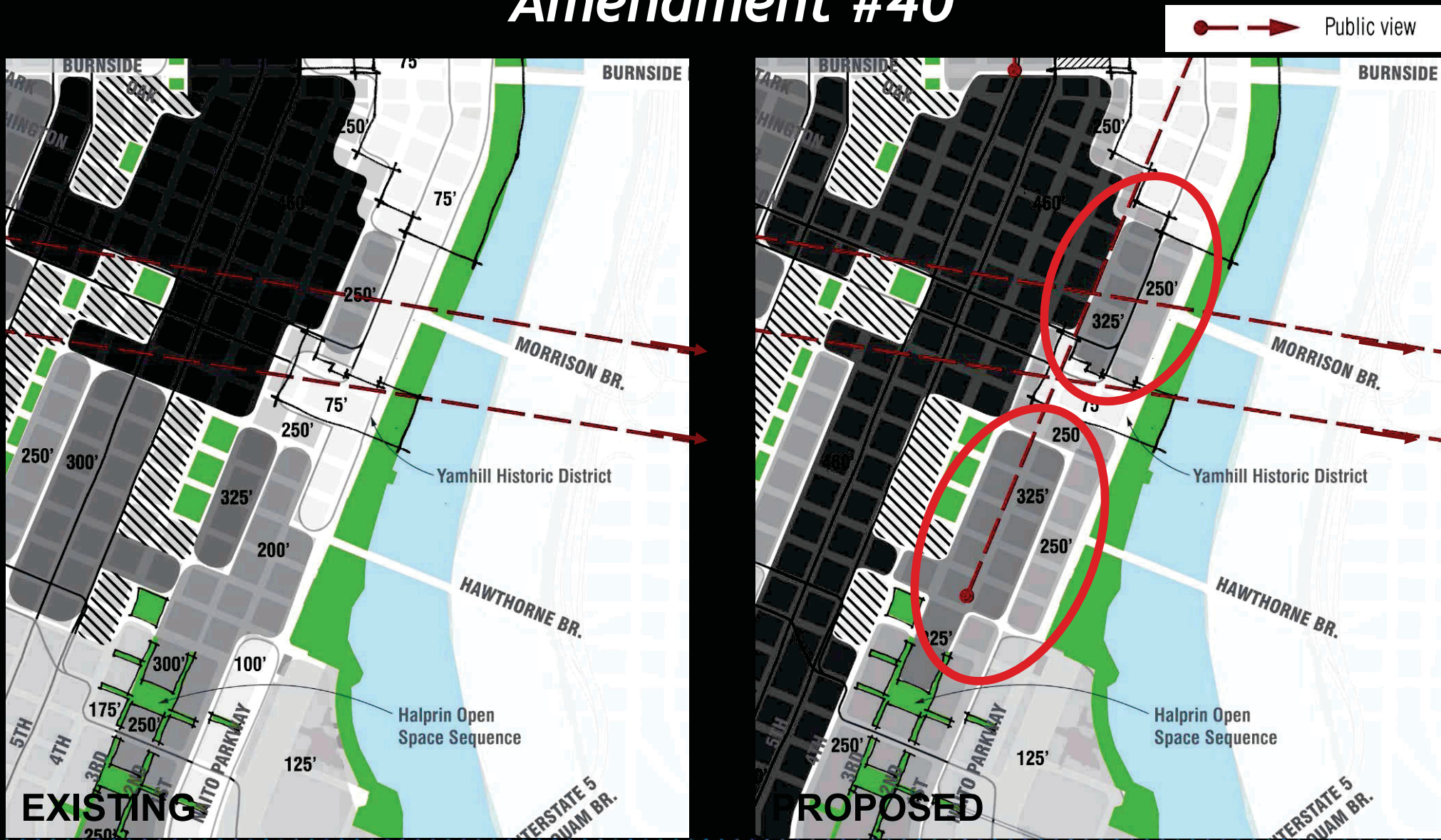

Pearl District Waterfront Amendment #43

Public view

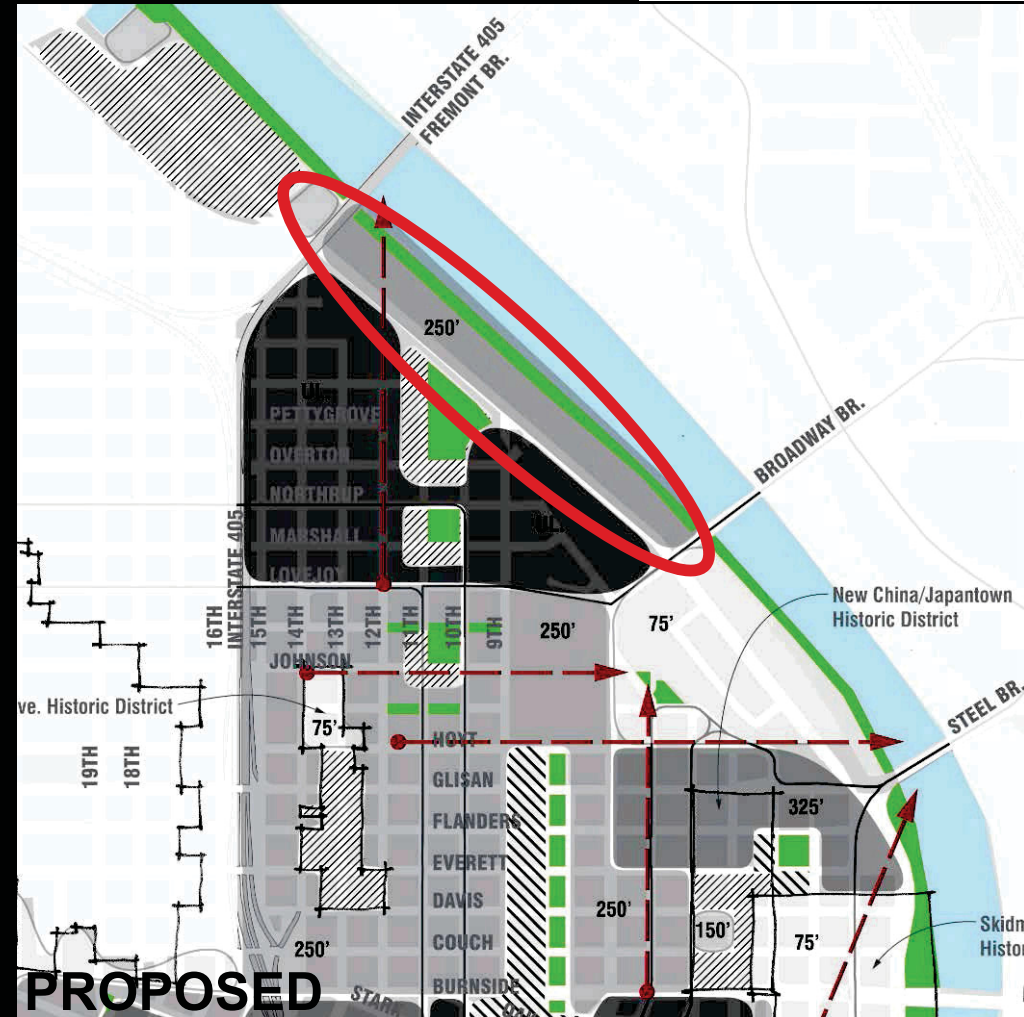
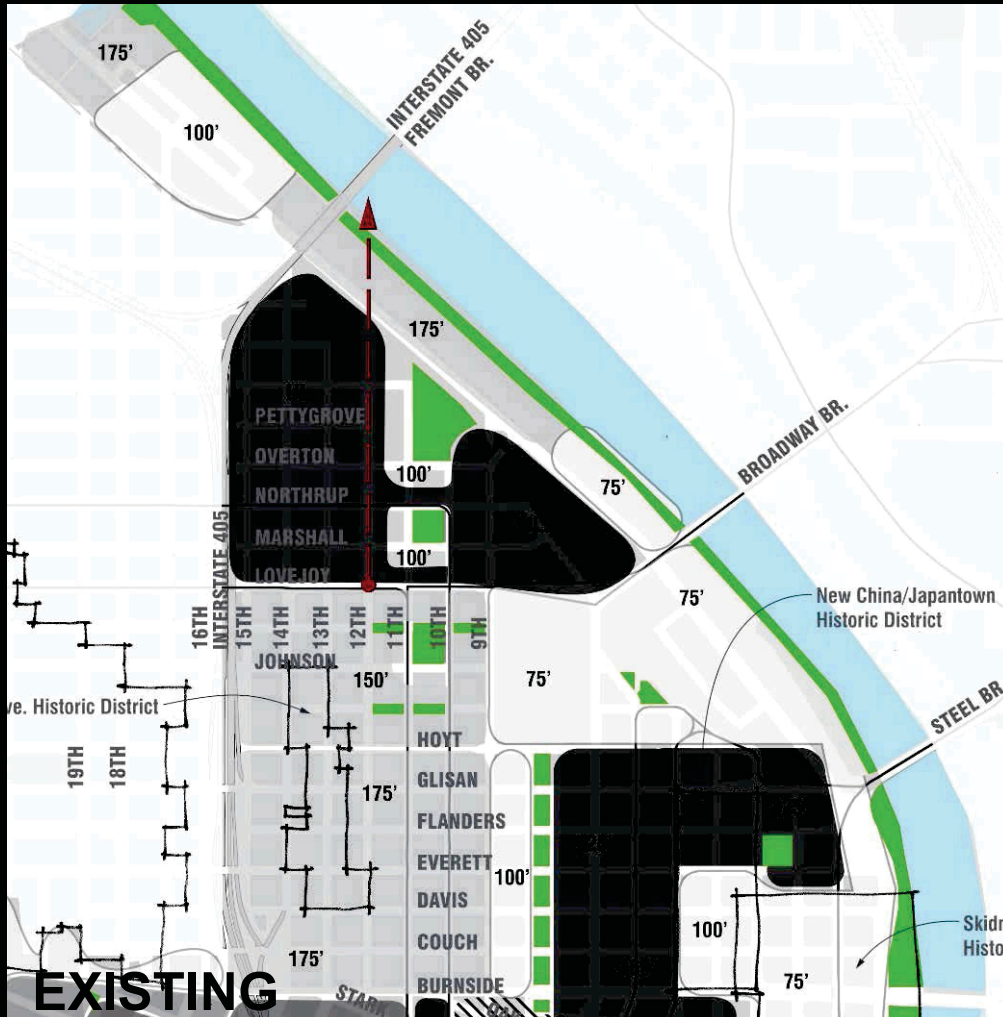

Goose Hollow Required Residential in CX Amendments #45-46

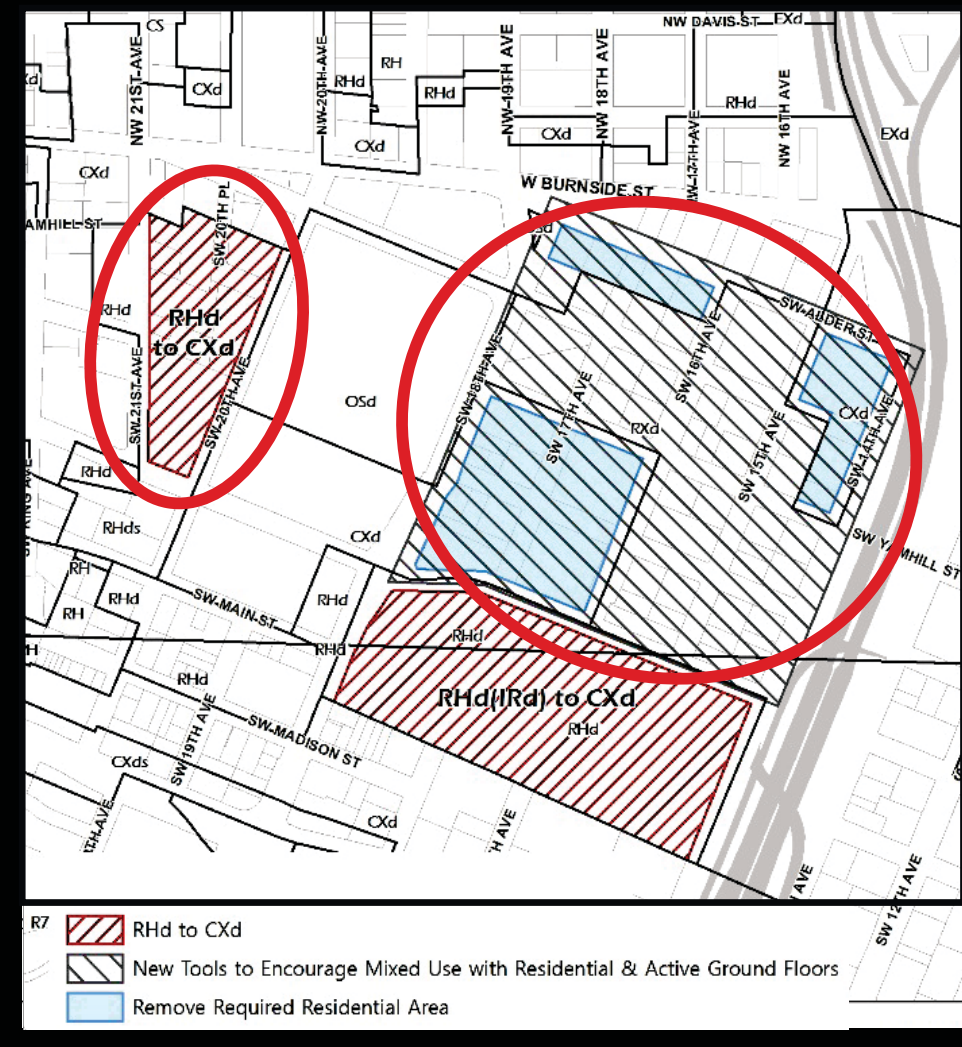
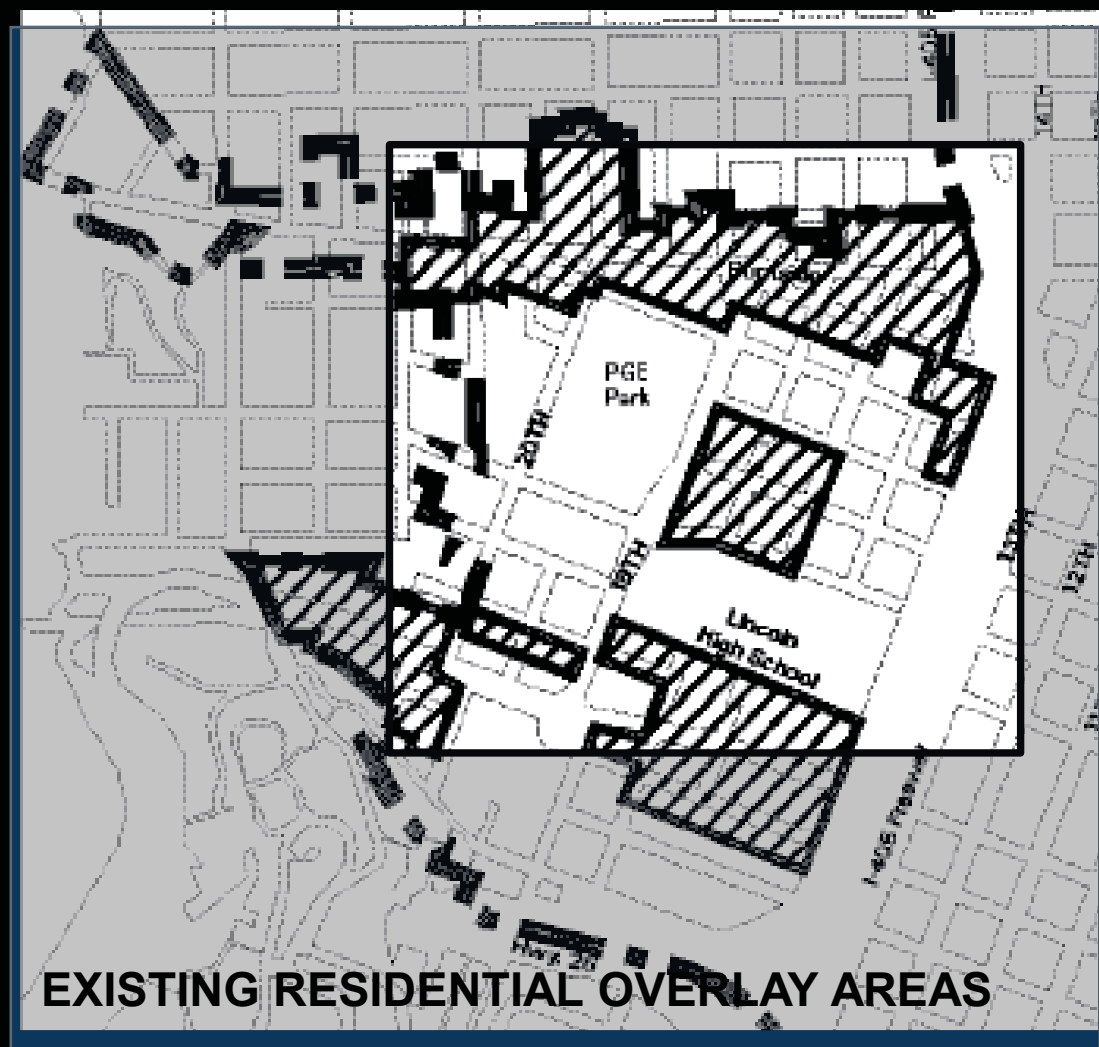

Goose Hollow Required Residential in CX Amendment #46

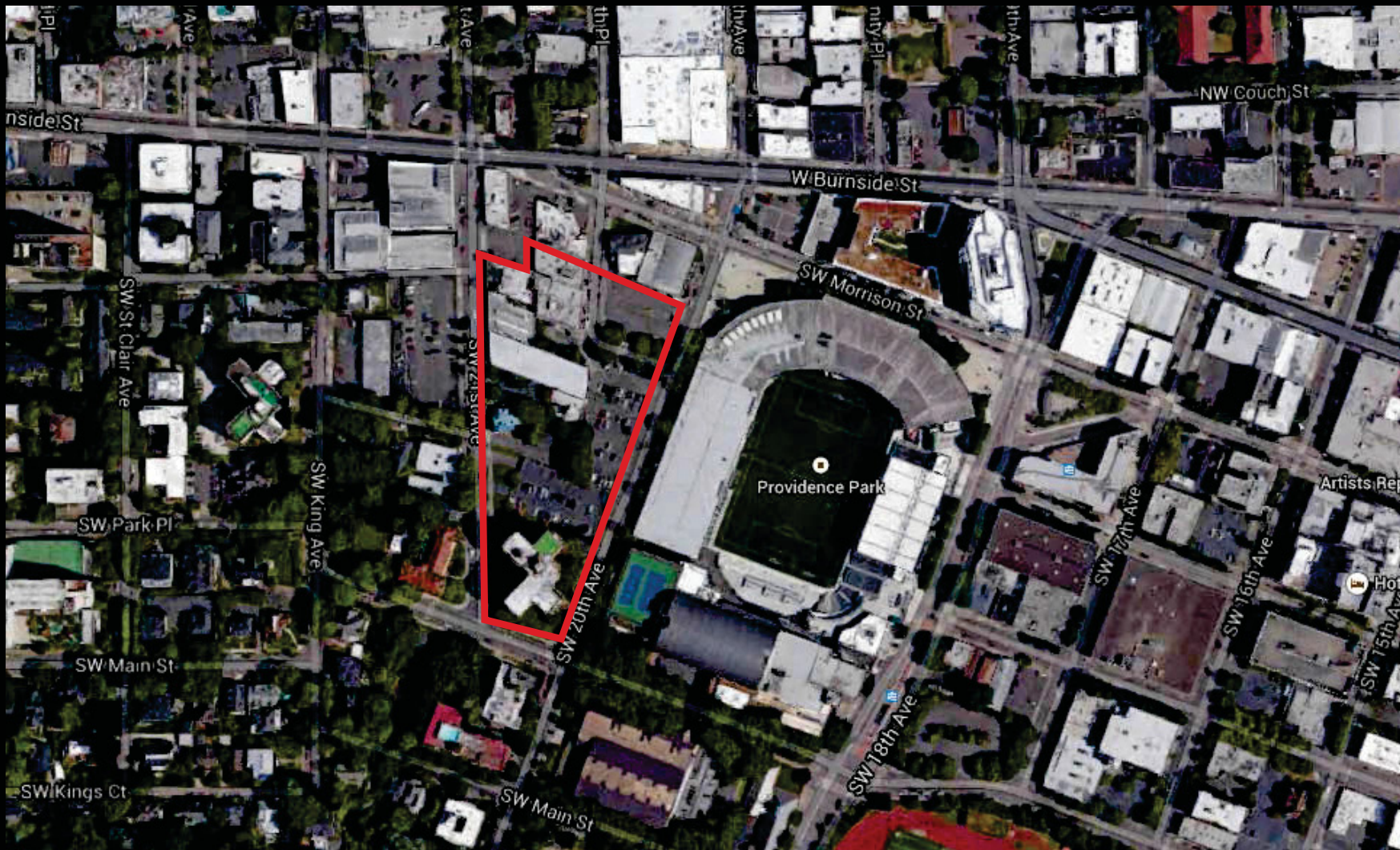

Request of Council

- Adopt the West Quadrant Plan as amended (by resolution)
- Direct BPS to complete CC2035 work program including:
 - SE Quadrant Plan
 - Affordable Housing Bonus Study
 - Scenic Resources Inventory
 - Combined CC2035 Plan including the updated zoning code

