

CITY OF PORTLAND

Redevelopment of the ADA Title II Transition Plan



Goals for the Transition Plan

- Document existing conditions
- Establish priorities and action plans with involvement of staff and community members
- Provide effective planning tools to track and report accessibility improvements

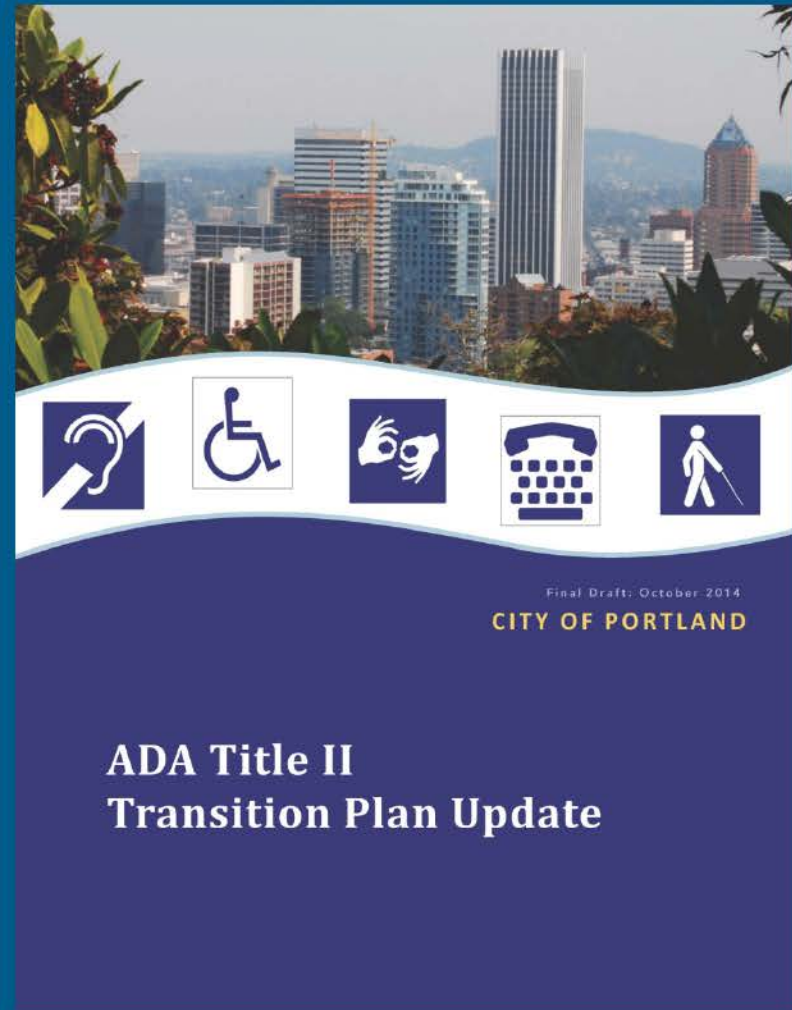

Exceptional Staff Involvement and Public Engagement

- A liaison from each City Bureau
- Portland Commission on Disabilities
- Stakeholder Advisory Committee
 - Staff from all City Bureaus
 - Community members



Facility Reports

- Reference Diagram
- Barrier Identification Table
- Conceptual Solution
- Code References
- Cost Estimate
- Category of Barrier

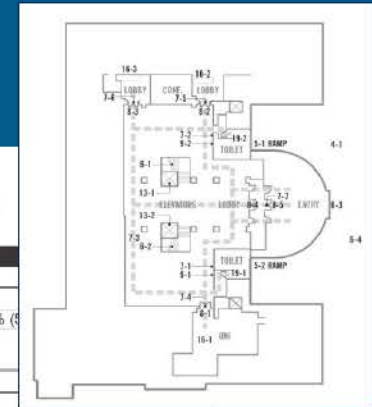

City-5: City Hall

Exterior	
4 - 1	Walk
Regrade surface	
Notes: Running slope along courtyard is 5.1% to 6.1% (5.1% max.)	
State: ---	
Federal: 403.3	
5 - 1	Ramp
Regrade or replace ramp	
Notes: Ramp slope is 10.7% (8.33% max.)	
State: ---	
Federal: 405.2	
Install or modify handrails	
Notes: Top ends of the handrails do not return to the wall.	
State: ---	
Federal: 505.10.1	
5 - 2	Ramp Category: 1
Regrade or replace ramp	
Notes: Ramp slope is 9.3% (8.33% max.)	
State: ---	
Federal: 405.2	
Install or modify handrails	
Notes: Top ends of the handrails do not return to the wall.	
State: ---	
Federal: 505.10.1	
6 - 3	Stairway Category: 5
Replace stairs	
Notes: Two riser steps. Non-uniform riser heights 4-1/4" and 6".	
State: ---	
Federal: 504.2	
Repair stair nosings	
Notes: Tread overhangs riser horizontally at 90 degrees (30 degrees max.) at a depth of 7/8"	
State: ---	
Federal: 504.5	
Install or modify handrails	
Notes: No handrails provided on both sides of the stairs.	
State: ---	
Federal: 505.2	

10/13/2013

Exterior
City-5: City Hall

Page 1



Removing Barriers in Facilities

1. Access to the main entrance or path of travel to where programs, activities and services are provided
2. Access to the area where programs are provided
3. Access to amenities
4. Features that are not required to be modified for accessibility

Kenton Firehouse

- Home to ONI programs
- Historic structure with no accessible path of travel to the second floor
- City staff has shifted their programs from the second to the first floor
- Second floor is Staff only



Prioritizing the Transition Plan

- Level of use by the public
- Program uniqueness
- Geographic distribution
- Critical nature of the service provided
- Identified complaints
- City-owned facilities
- Social need / equity





Implementation Plan

Each Bureau is managing an active spreadsheet that monitors and tracks the removal of barriers.

Years 1 – 2: Fiscal years 2014/15 – 2015/16

Years 3 – 5: Fiscal years 2016/17 – 2017/18

Years 6 – 10: Fiscal years 2019/20 – 2023/24

Years 11+: Fiscal years 2024/25 +

Typical Transition Plan Schedule

*ADA Self-Evaluation and Transition Plan
May 2014*

Buildings

Municipal Services Building	33 Arroyo Drive	1-3 years
City Hall Historic	400 Grand Avenue	1-3 years
City Hall Annex	400 Grand Avenue	1-3 years
City Hall Campus	400 Grand Avenue	1-3 years
Main Library	840 West Orange Avenue	1-3 years
Grand Avenue Branch Library	306 Walnut (City Hall Campus)	1-3 years
Orange Park Pool	781 Tennis Drive	4-6 years
Magnolia Senior Center	601 Grand Avenue	4-6 years
Westborough Recreation Center	2380 Galway	4-6 years
Orange Park Recreation Center	781 Tennis Drive	4-6 years

Facility Name
Facility Location
Implementation Years



The Portland Transition Plan Schedule

- City ID Number
- Name and Location
- Floor
- Map Key
- Barrier Type
- Barrier Removal Action
- Existing Condition
- Barrier Category
- Cost Estimate
- Project Type
- Scheduled Plan Year
- Scheduled Start Date
- Scheduled End Date
- Duration
- Mitigation Date
- Notes
- State Code
- Federal Standard



Next Steps

- Conduct an evaluation of City Policies and Programs
- Conduct an accessibility evaluation of the City's pedestrian Rights-of-Way
- Continue to implement the ADA Transition Plan

CITY OF PORTLAND

Redevelopment of the ADA Title II Transition Plan



Exceptional Staff Involvement and Public Engagement

- A liaison from each City Bureau
- Portland Commission on Disabilities
- Stakeholder Advisory Committee
 - Staff from all City Bureaus
 - Community members



Facility Reports

- Reference Diagram
- Barrier Identification Table
- Conceptual Solution
- Code References
- Cost Estimate
- Category of Barrier

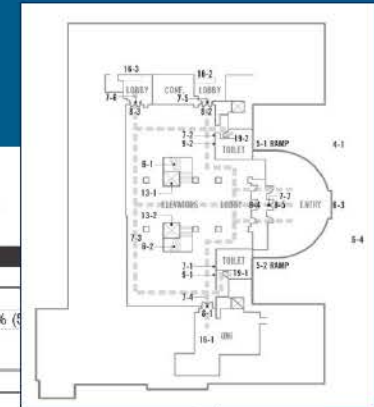

City-5: City Hall

Exterior	
4 - 1	Walk
Regrade surface	
Notes: Running slope along courtyard is 5.1% to 6.1% (5.1% max.)	
State: ---	
Federal: 403.3	
5 - 1	Ramp
Regrade or replace ramp	
Notes: Ramp slope is 10.7% (8.33% max.)	
State: ---	
Federal: 405.2	
Install or modify handrails	
Notes: Top ends of the handrails do not return to the wall.	
State: ---	
Federal: 505.10.1	
5 - 2	Ramp Category: 1
Regrade or replace ramp	
Notes: Ramp slope is 9.3% (8.33% max.)	
State: ---	
Federal: 405.2	
Install or modify handrails	
Notes: Top ends of the handrails do not return to the wall.	
State: ---	
Federal: 505.10.1	
6 - 3	Stairway Category: 5
Replace stairs	
Notes: Two riser steps. Non-uniform riser heights 4-1/4" and 6".	
State: ---	
Federal: 504.2	
Repair stair nosings	
Notes: Tread overhangs riser horizontally at 90 degrees (30 degrees max.) at a depth of 7/8"	
State: ---	
Federal: 504.5	
Install or modify handrails	
Notes: No handrails provided on both sides of the stairs.	
State: ---	
Federal: 505.2	

10/13/2013 Exterior
City-5: City Hall Page 1

Removing Barriers in Facilities

1. Access to the main entrance or path of travel to where programs, activities and services are provided
2. Access to the area where programs are provided
3. Access to amenities
4. Features that are not required to be modified for accessibility

Kenton Firehouse

- Home to ONI programs
- Historic structure with no accessible path of travel to the second floor
- City staff has shifted their programs from the second to the first floor
- Second floor is Staff only



Prioritizing the Transition Plan

- Level of use by the public
- Program uniqueness
- Geographic distribution
- Critical nature of the service provided
- Identified complaints
- City-owned facilities
- Social need / equity

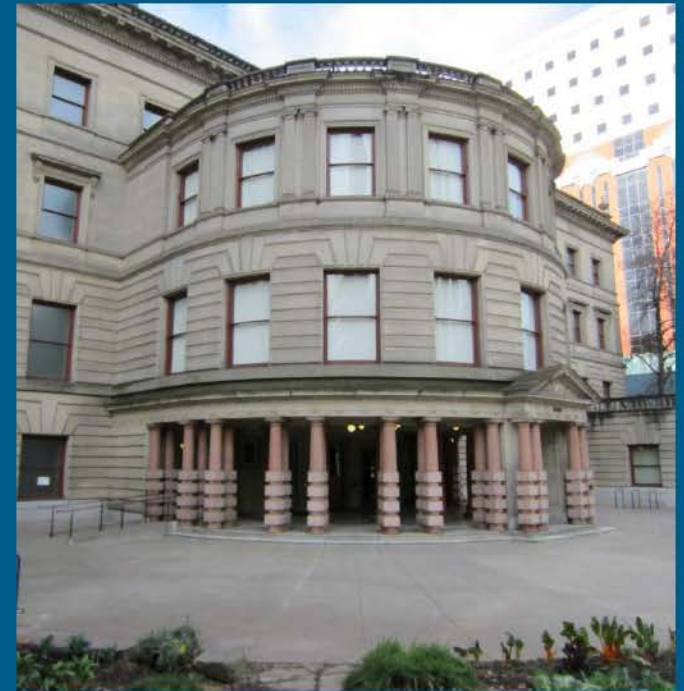

Implementation Plan

Each Bureau is managing an active spreadsheet that monitors and tracks the removal of barriers.

Years 1 – 2: Fiscal years 2014/15 – 2015/16

Years 3 – 5: Fiscal years 2016/17 – 2017/18

Years 6 – 10: Fiscal years 2019/20 – 2023/24

Years 11+: Fiscal years 2024/25 +

Typical Transition Plan Schedule

*ADA Self-Evaluation and Transition Plan
May 2014*

Buildings

Municipal Services Building	33 Arroyo Drive	1-3 years
City Hall Historic	400 Grand Avenue	1-3 years
City Hall Annex	400 Grand Avenue	1-3 years
City Hall Campus	400 Grand Avenue	1-3 years
Main Library	840 West Orange Avenue	1-3 years
Grand Avenue Branch Library	306 Walnut (City Hall Campus)	1-3 years
Orange Park Pool	781 Tennis Drive	4-6 years
Magnolia Senior Center	601 Grand Avenue	4-6 years
Westborough Recreation Center	2380 Galway	4-6 years
Orange Park Recreation Center	781 Tennis Drive	4-6 years

Facility Name
Facility Location
Implementation Years

The Portland Transition Plan Schedule

- City ID Number
- Name and Location
- Floor
- Map Key
- Barrier Type
- Barrier Removal Action
- Existing Condition
- Barrier Category
- Cost Estimate
- Project Type
- Scheduled Plan Year
- Scheduled Start Date
- Scheduled End Date
- Duration
- Mitigation Date
- Notes
- State Code
- Federal Standard

Next Steps

- Conduct an evaluation of City Policies and Programs
- Conduct an accessibility evaluation of the City's pedestrian Rights-of-Way
- Continue to implement the ADA Transition Plan