

August 16, 2014

Dear Planning and Sustainability Commission

We have lived at 2011 SE 143 Avenue, Portland, Oregon for over 60 years so you know we are now in our 80's. We take pride in maintaining our property as an asset to the neighborhood. We do not want the property to be rezoned single-dwelling 7,000. We grow a garden full of vegetables and several fruit trees in our back yard that feed us and we share with others.

Our home takes up most of the width of the property with little access to the back yard from the street in front and no access from the back or sides of the property to other streets. The street front of the property has a 70 year old fir tree on south side near the property line and is very close to a utility pole on the north property line. Please do not rezone!

Enclosed is a drawing showing our house location on the property.

Sincerely,

John H. Yeager — John A. Yeager
Virginia M. Yeager — Virginia M. Yeager

Not to scale

Lot #1
2011 SE 143rd Ave
Portland, OR

← North
↓ West

→ South
↑ East

Utility
pole

2 1/2 foot bank in front SE 143rd Lot 1 street

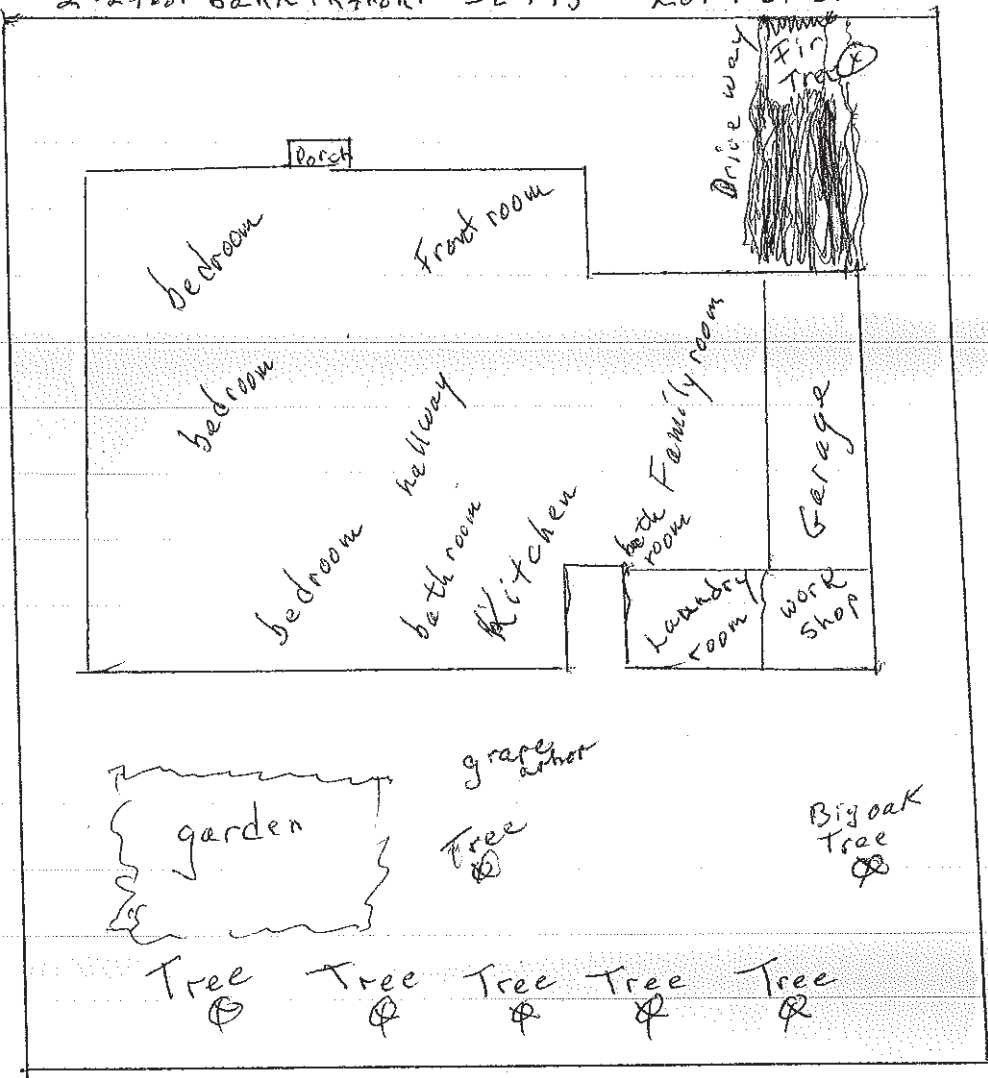

John & Virginia Yeager
P.O. Box 93062
Portland, OR 97292-3062

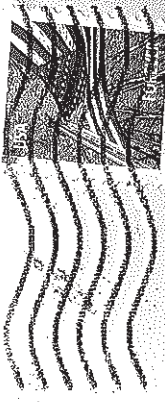

PORTLAND, OR 970
18 AUG 2014 PM 6 L

Commission

RECEIVED
AUG 20 2014
City of Portland
Bureau of Planning and Sustainability

Portland Planning and Sustainability
Comprehensive Plan Update
1900 SW 4th Avenue
Suite 7100
Portland, OR 97201

97201536075

