



City of Portland Bureau of Development Services

Staff Presentation to the
City Council

Land Use Review 13-182710 CP ZC
Castaway Bronze 1900 NW 18th



Summary of the Proposal

- **A Comprehensive Plan Map Amendment and Zone Map Amendment:**
- **From Industrial Sanctuary and IG1 zone**
- **To Central Employment and EXd zone**



Approval Criteria

- **33.810.050 Comprehensive Plan Map Amendments**
- **33.855.050 Zoning Map Amendments**



Existing Zoning Map

10,000 sq ft lot

10,000 sq ft building

NW Plan District

Transitional Subarea

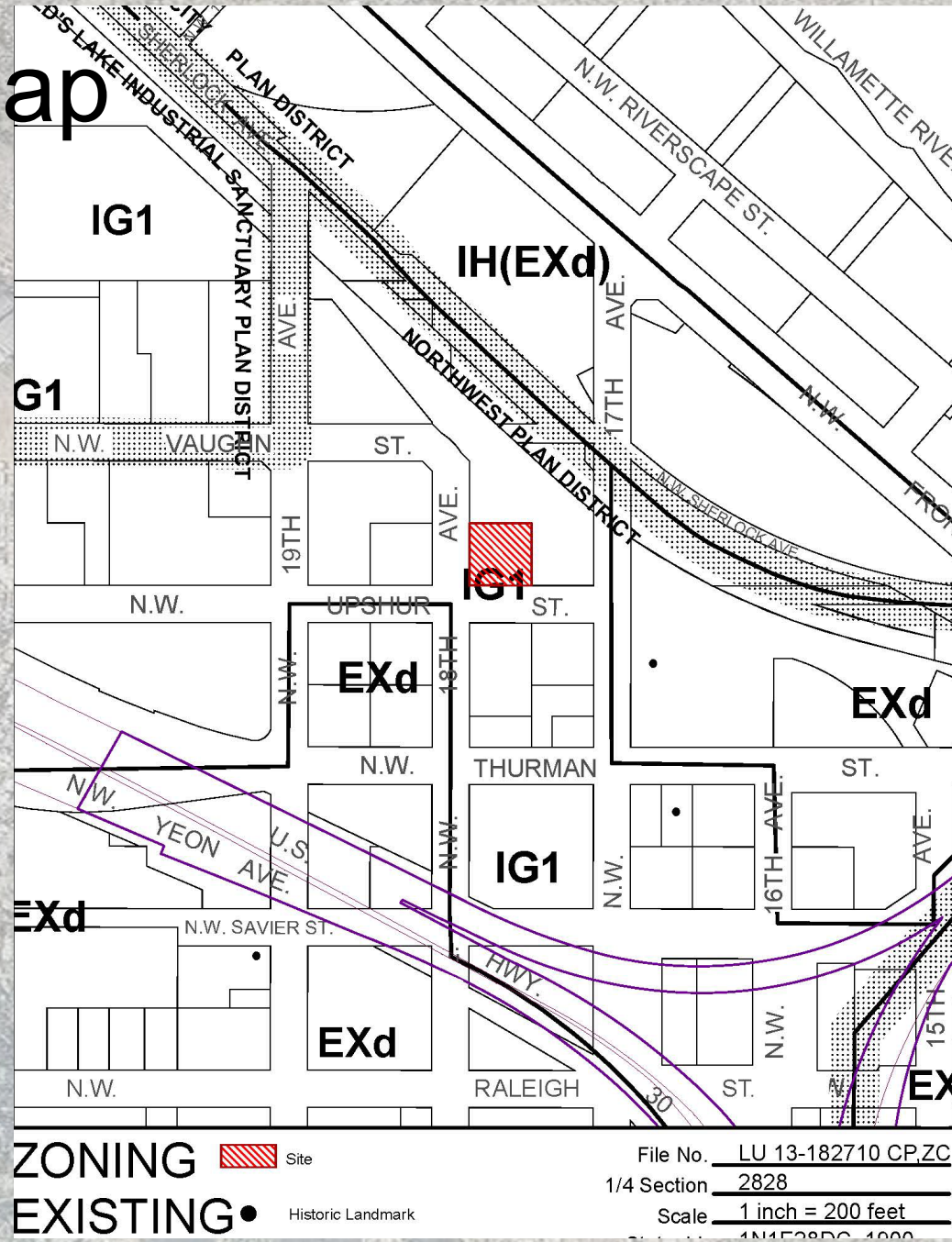



Proposed Zoning Map

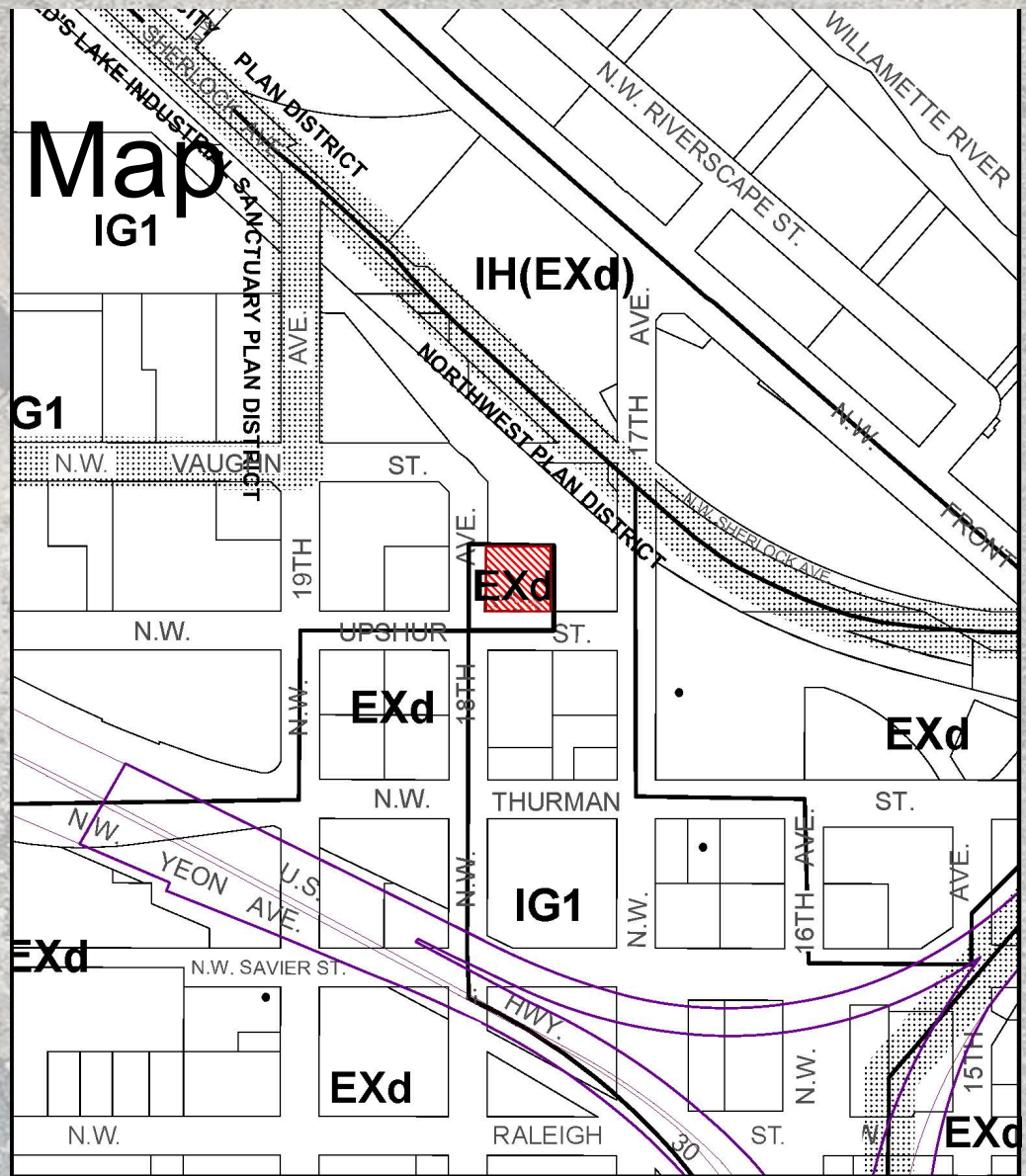

ZONING
PROPOSED



Site



Historic Landmark

File No. LU 13-182710 CP,ZC

1/4 Section 2828

Scale 1 inch = 200 feet

20150203

Adopted Northwest District Plan

SITE



Northwest District Plan

Policy 13: Transition Subarea

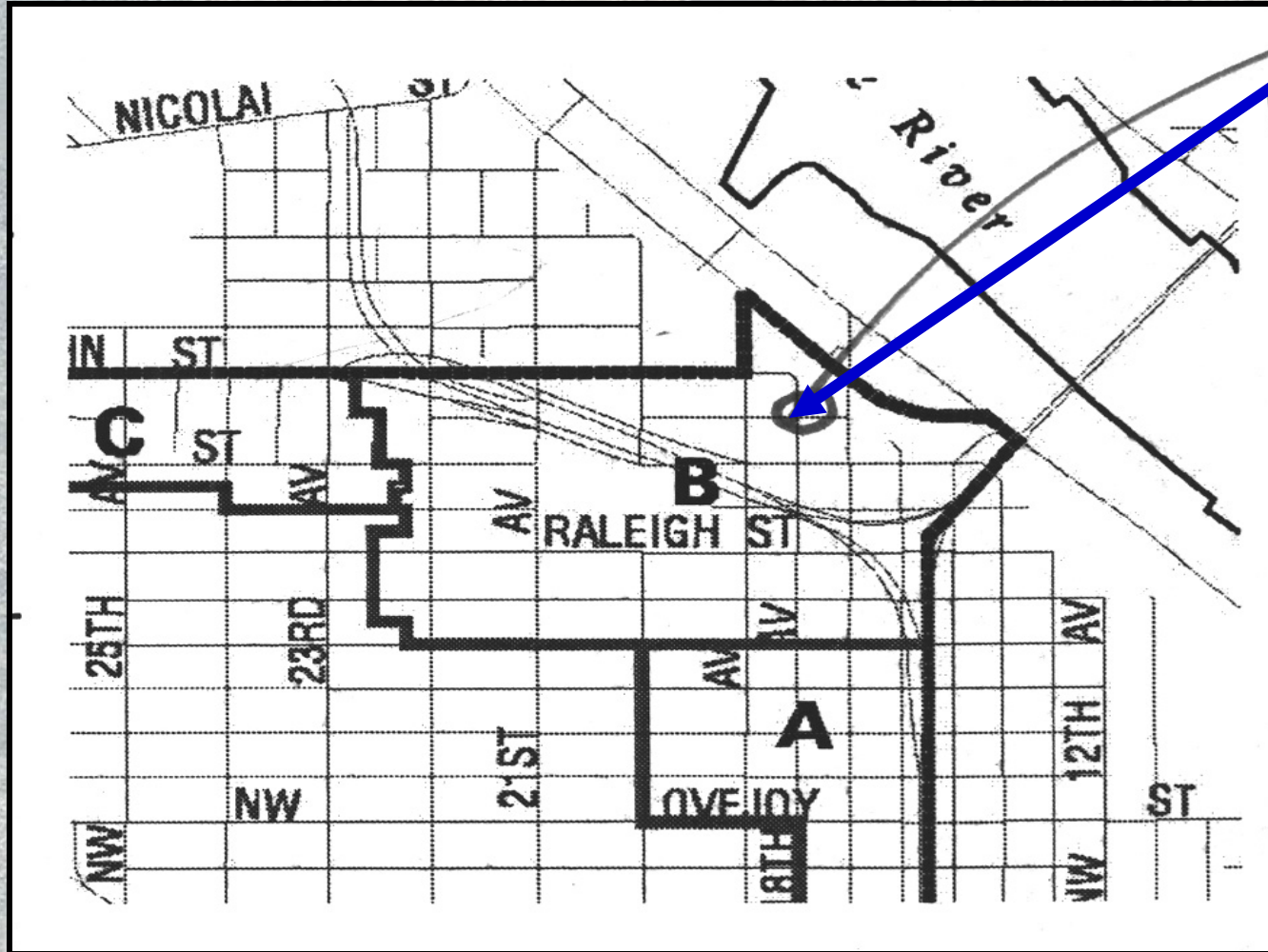

SITE



Northwest District Plan

Policy 13: Transition Subarea

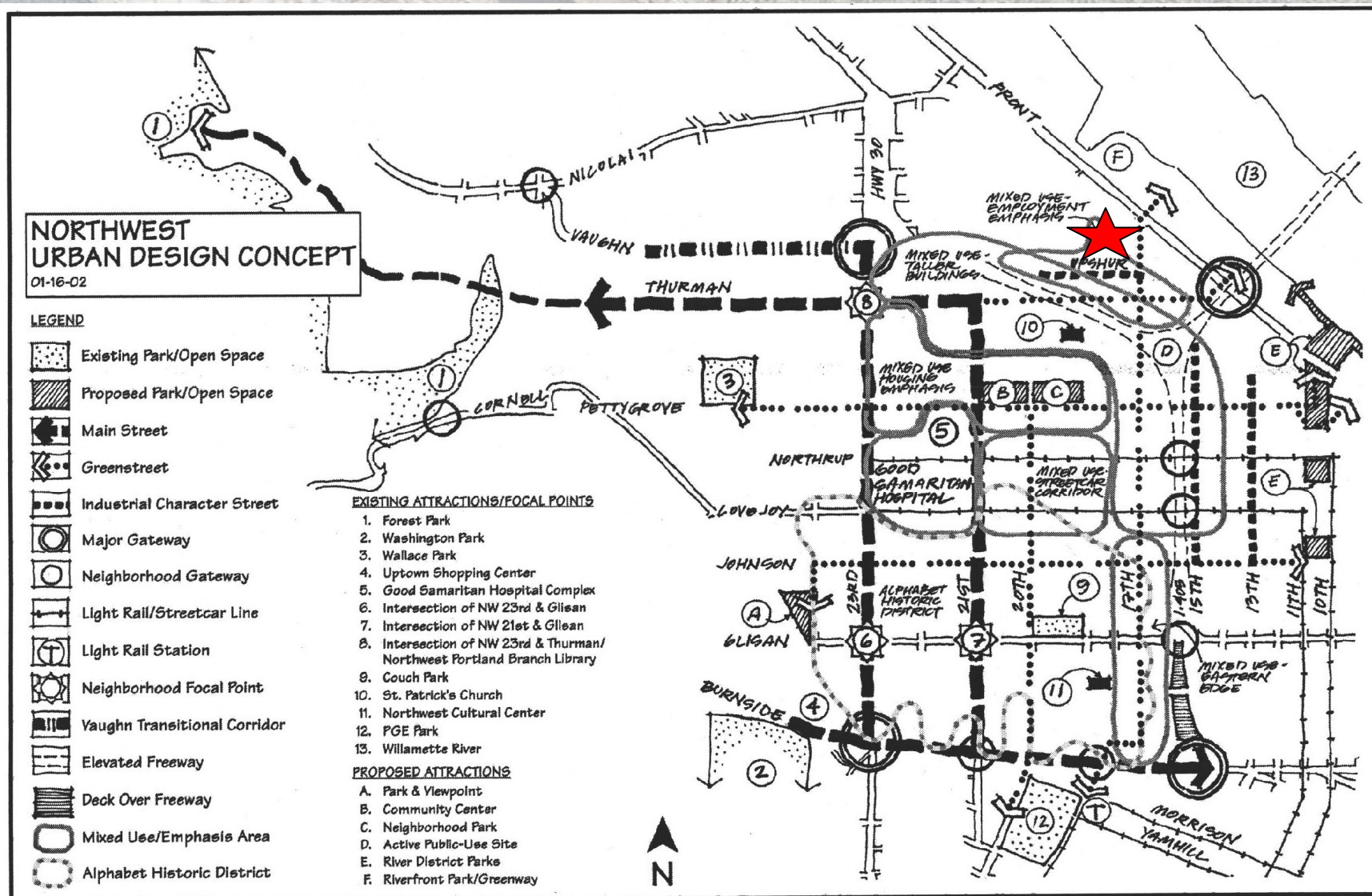



Northwest District Plan

Policy 13: Transitional Subarea

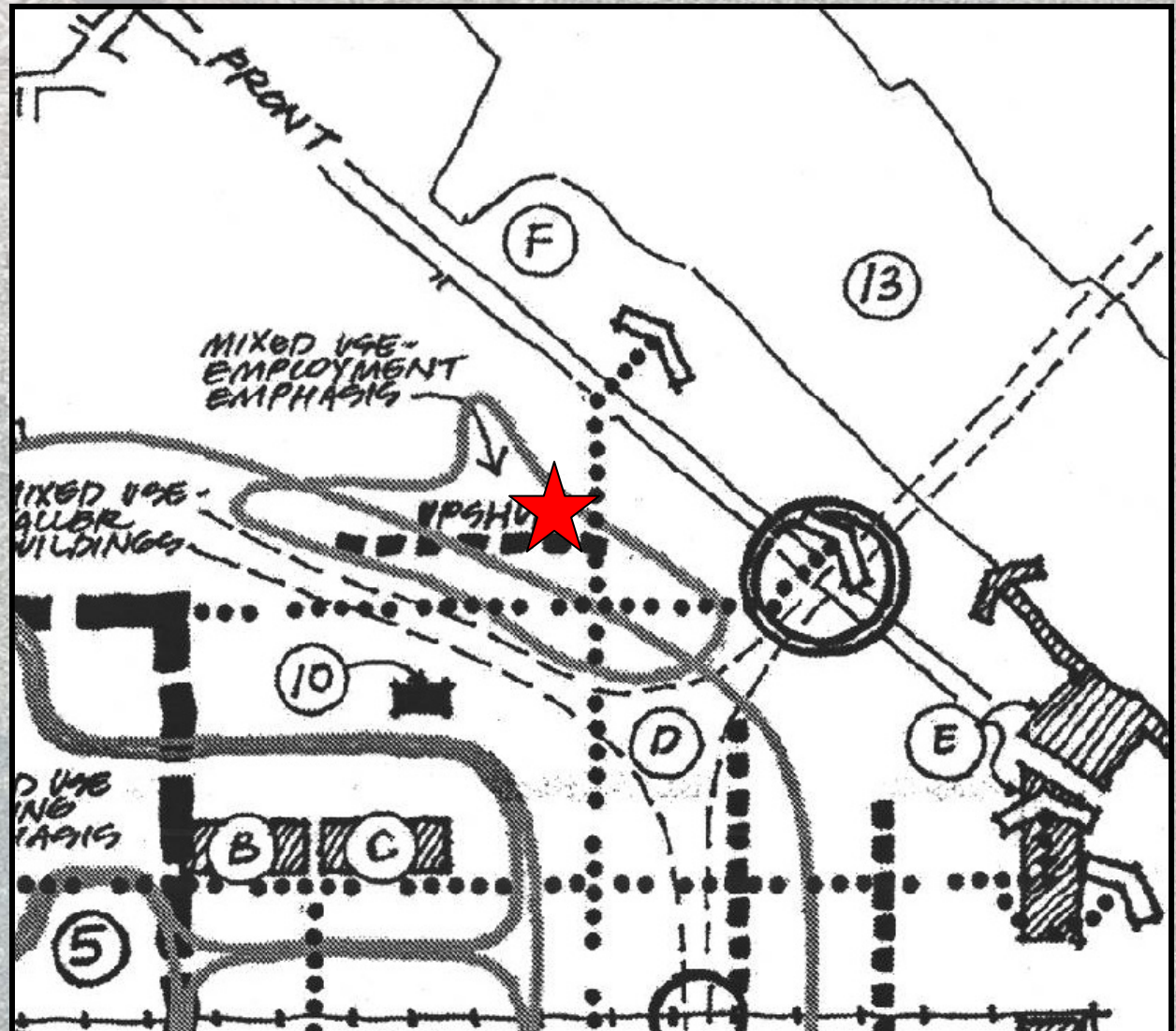



Summary

Staff Recommendation

Approval of:

- **A Comprehensive Plan Map Amendment to change the designation on the subject site from Industrial Sanctuary to Central Employment; and**
- **A Zone Map Amendment to change the zoning on the subject site from IG1, General Industrial 1, to EXd, Central Employment with Design overlay.**



Site Tour: Aerial View

