

MAP OF
CARUTHERS ADDITION
 to the
CITY OF PORTLAND

1-35.

As laid out by the South Portland Real Estate Association. The same being portions of the Finis Caruthers and Elizabeth Thomas Donation Land Claims situated in sections 3, 4, 9 & 10 of Township one South Range one East of the Willamette Meridian. All Blocks are two hundred feet square, except Blocks 132 to 139 inclusive which are fractional and their south boundary is thirty feet North of the South boundary of the Elizabeth Thomas donation land claim. All streets are 60 feet wide except South First Street, and the Street lying along the South boundary of the Elizabeth Thomas land claim. South First Street is sixty three and six tenths feet wide. It commences at the North side line of the Finis Caruthers Claim, where the same is intersected by First Street in the City of Portland, and extends to the South boundary of the Elizabeth Thomas Claim, on a course of South 1° 12' West at right angles to the North side line of the Finis Caruthers claim. The Street along the South line of the Elizabeth Thomas Claim is thirty feet wide. All sixty feet streets are parallel, or at right angles with South First Street.

Scale one inch to three hundred feet.
 + Stone Monuments.

Surveyed April & May 1872
 by C. W. Burrage C. E.

Portland Homestead Association

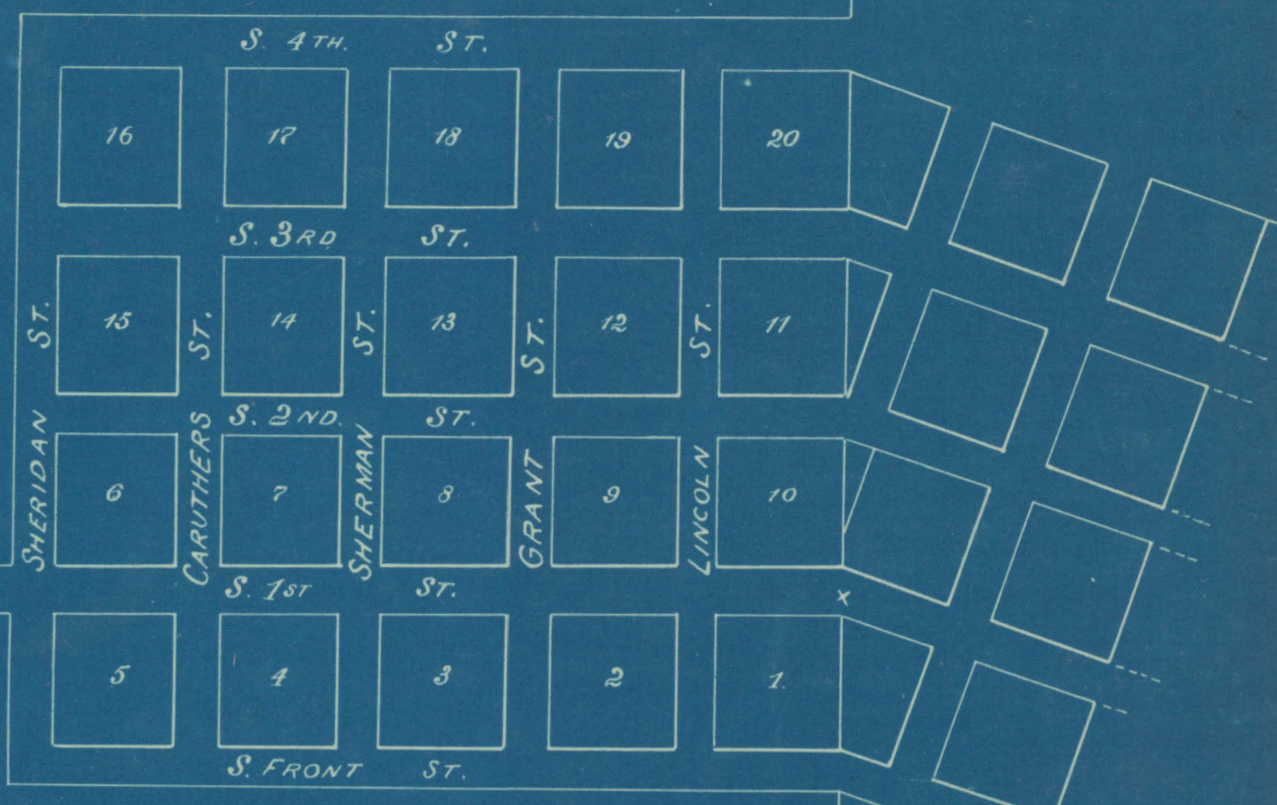
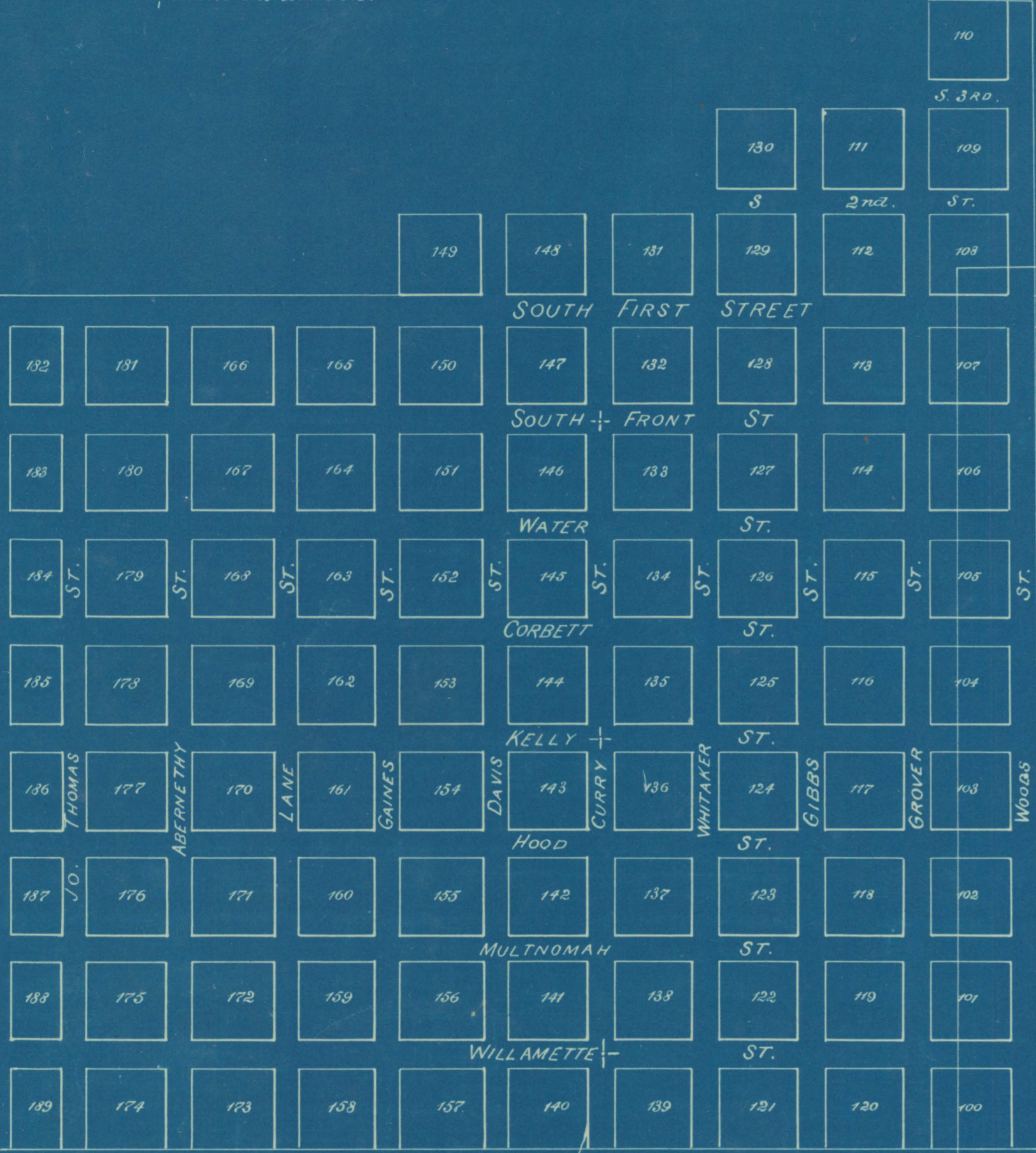

Order of numbering

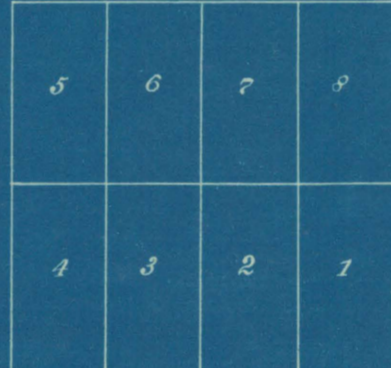

Lots in a Block

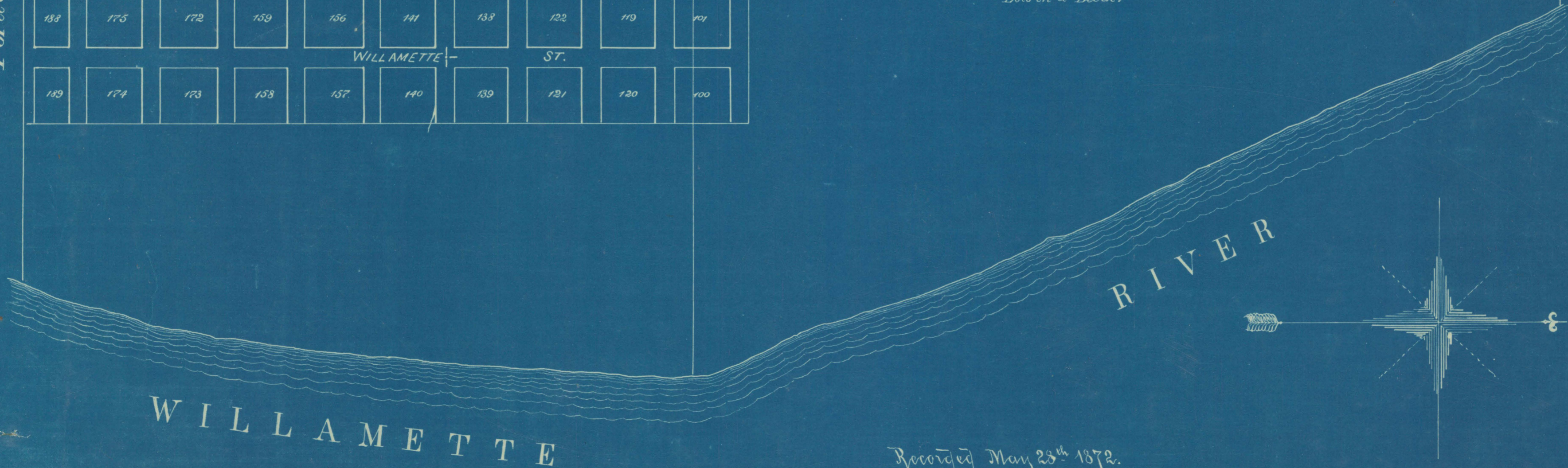

WILLAMETTE

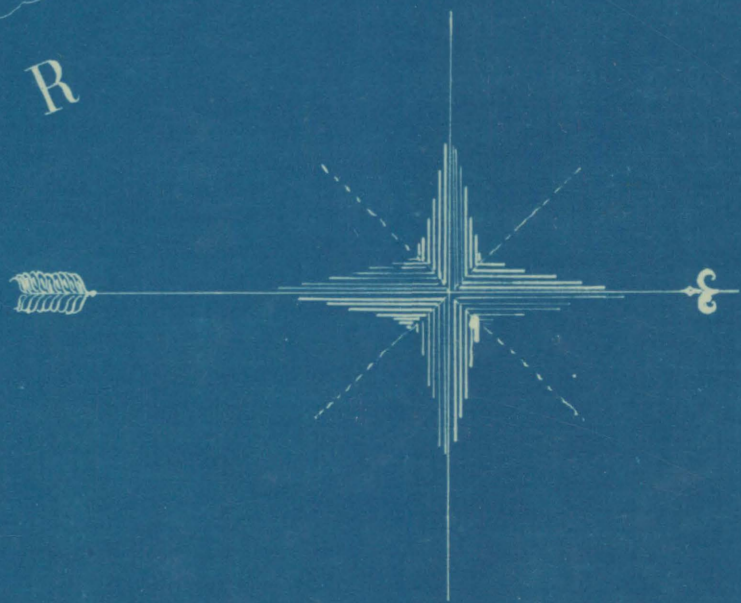

Recorded May 28th 1872.

53