

**Exhibit A**

May 12, 2011

PERMANENT UNDERGROUND POWER EASEMENT

A portion of PARCEL 1 in Partition Plat 1992-164, recorded December 18, 1995 Multnomah County Plat Records, situated in the northeast quarter of Section 28, T1N, R1E, W.M., in the City of Portland, State of Oregon, described as follows;

Commencing at the most southeasterly corner of said PARCEL 1, said corner being the most southerly corner of TRACT "A", Partition Plat 1992-164; thence N 37° 54' 10" W, along the southwesterly line of said TRACT "A", a distance of 1,051.92 feet to the northwesterly line of a 20 foot wide public sewer easement recorded in book 38, page 101, on March 24, 1941; thence S 48° 56' 25" W, along said northwesterly line, a distance of 74.97 feet to the Point of Beginning of the tract herein described; thence S 29° 26' 19" E, a distance of 2.97 feet; thence S 69° 14' 20" W, a distance of 12.31 feet to the vault wall of the permanent pipeline structure; thence N 41° 03' 50" W, along said vault wall, a distance of 5.27 feet; thence N 69° 14' 20" E, a distance of 13.38 feet; thence S 29° 26' 19" E, a distance of 2.03 feet to the Point of Beginning.

Contains 63 square feet, more or less.

**Exhibit B**

May 12, 2011

PERMANENT PAD EASEMENT

A portion of PARCEL 1 in Partition Plat 1992-164, recorded December 18, 1995 Multnomah County Plat Records, situated in the northeast quarter of Section 28, T1N, R1E, W.M., in the City of Portland, State of Oregon, described as follows;

Commencing at the most southeasterly corner of said PARCEL 1, said corner being the most southerly corner of TRACT "A", Partition Plat 1992-164; thence N 37° 54' 10" W, along the southwesterly line of said TRACT "A", a distance of 1,051.92 feet to the northwesterly line of a 20 foot wide public sewer easement recorded in book 38, page 101, on March 24, 1941; thence S 48° 56' 25" W, along said northwesterly line, a distance of 69.86 feet to the Point of Beginning of the tract herein described; thence S 29° 26' 19" E, a distance of 3.99 feet; thence S 60° 30' 41" W, a distance of 5.00 feet; thence N 29° 26' 19" W, a distance of 5.00 feet; thence N 60° 30' 41" E, a distance of 5.00 feet; thence S 29° 26' 19" E, a distance of 1.01 feet to the Point of Beginning.

Contains 25 square feet, more or less.

# Exhibit C

TEMPORARY CONSTRUCTION EASEMENT		
NO.	BEARING	DISTANCE
1	S 54°07'18" W	5.21'
2	S 35°52'41" E	4.00'
3	S 54°07'18" W	3.00'
4	N 35°52'41" W	9.00'
5	N 54°07'18" E	8.21'
6	S 35°52'39" E	5.00'

PERMANENT UNDERGROUND POWER EASEMENT		
NO.	BEARING	DISTANCE
7	S 29°26'19" E	2.97'
8	S 29°26'19" E	2.03'

5'X5' PERMANENT PAD EASEMENT		
NO.	BEARING	DISTANCE
9	S 29°26'19" E	3.99'
10	S 60°33'41" W	5.00'
11	N 29°26'19" W	5.00'
12	N 60°30'41" E	5.00'
13	S 29°26'19" E	1.01'

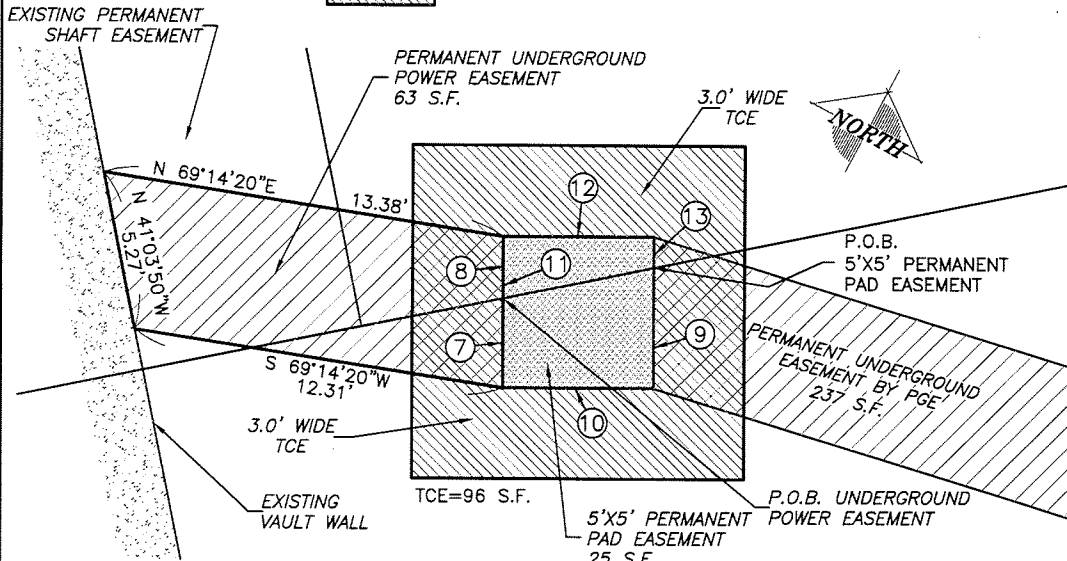

"DETAIL B"  
SCALE: 1"=4'

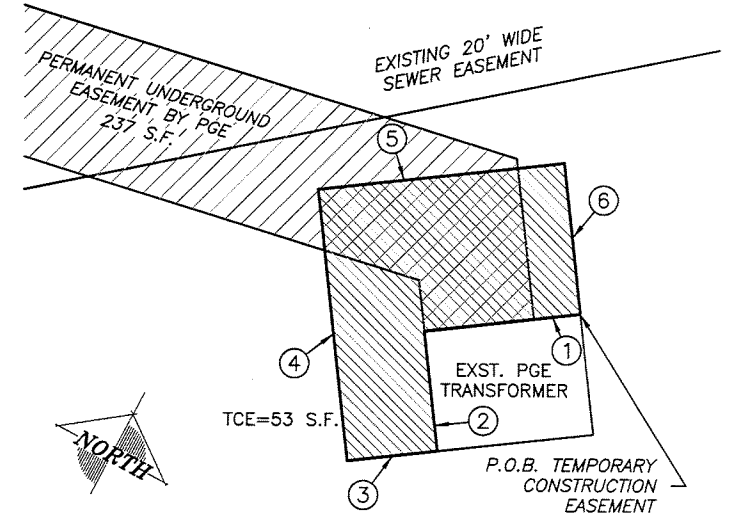

AshGrove-PGE Ease.dwg. 05/12/11 at 12:57

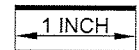

BAR EQUALS ONE INCH WHEN DRAWING IS PLOTTED FULL SIZE. IF NOT, SCALE ACCORDINGLY

PROPERTY OWNER:  
ASH GROVE CEMENT COMPANY  
STATE ID: 1N1E28A 500  
RNO: R237733  
PROJECT ID: 3056

CITY OF PORTLAND  
ENVIRONMENTAL SERVICES

EAST SIDE COMMUNICATION AND CONTROL  
OUTFALL 46  
SEWER LEVEL MONITORING

1/4 SECTION  
JOB NO.  
E10223  
SHEET NO.  
2 of 2