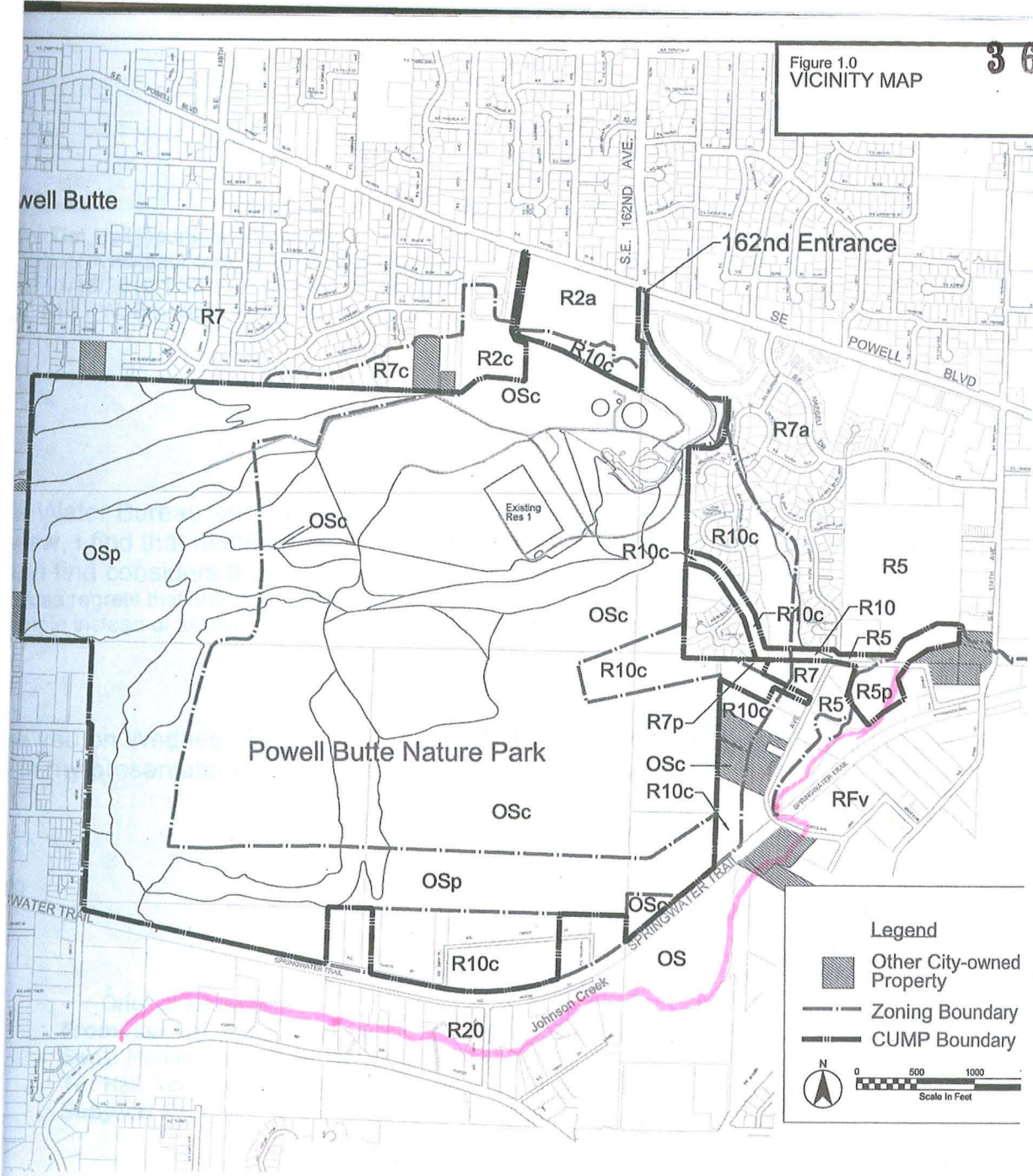

Figure 1.0
VICINITY MAP

36837



PRELIMINARY



POWELL BUTTE RESERVOIR 2

Theresa Elliott, Principal Engineer, PE No 19174

Date

Linda Bauer

12/15/10
submitted
by Linda
Bauer

Theresa Elliott, Teresa
Sent: Monday, November 01, 2010 12:06 PM

Wednesday, December 15, 2010 AOL: lbaue@ps...



City of Portland
Bureau of
**Planning and
Sustainability**

Sam Adams, Mayor
Susan Anderson, Director

Planning

1900 S.W. 4th Ave., Ste. 7100
Portland, OR 97201-5350

Phone 503-823-7700
FAX 503-823-7800
TTY 503-823-6868

Sustainability

721 N.W. 9th Ave., Ste. 195
Portland, OR 97209-3447

Phone 503-823-7222
FAX 503-823-5311
TTY 503-823-6868

www.portlandonline.com/bps

An equal opportunity employer

 Printed on recycled paper

36837

December 13, 2010

TO: Mayor Sam Adams
Commissioner Nick Fish
Commissioner Amanda Fritz
Commissioner Randy Leonard
Commissioner Dan Saltzman

FROM: Susan Anderson



SUBJECT: Portland Natural Hazard Mitigation Plan 2010

I am pleased to support the 2010 Portland Natural Hazard Mitigation Plan (NHMP). The Bureau of Planning and Sustainability (BPS) has been an active participant in the development of both the 2004 and the 2010 NHMPs, and continues to be listed as an implementing partner for a number of the actions.

The NHMP is comprehensive and forward-thinking, and will complement and inform many City activities. For example, the NHMP information on landslides, flooding, wildfire and other hazards will be considered during the designing and evaluation of alternative growth scenarios through the Portland Plan. The NHMP recommended actions will also help advance the City's climate change adaptation efforts and strategies to make the City more resilient to climate change impacts.

The Portland Office of Emergency Management has done a commendable job coordinating this NHMP and responding to emerging information and City policy direction. The 2010 plan addresses several additional hazards, including those associated with invasive plants. This addition reinforces City government and community investments in controlling the spread of invasive plants, including substantial code improvements approved by Council earlier this year.

The NHMP also calls for actions to align City vegetation management regulations with goals to reduce risks in wildfire prone areas of the city. BPS and other bureaus will soon come to Council with recommendations to increase allowances for tree pruning in environmental zones as part of the Citywide Tree Project proposal. Portland Fire and Rescue has strongly supported this proposal as an important step in the direction of regulatory alignment to reduce impacts of urban wildfire.

I urge the Council to approve the resolution endorsing the NHMP. The plan sets important priorities to guide City investments and provides a tool to access critical project funding.

36837

From: Tim.Hall@portlandoregon.gov
To: lbauerpvna@aol.com, davidahyde@earthlink.net
Sent: 11/15/2010 1:33:12 P.M. Pacific Standard Time
Subj: RE: FW: Emailing: storm, storm manual

Linda,

The Water Bureau will officially respond to your concerns. However, in my quick review, I find that neither the Corp of Engineers nor FEMA, or any disaster agency I could find considers the need for **disaster planning for such a Missoula flood type event.**

Teresa regrets that she attempted to simplify her response by using a hypothetical 1,000 year example instead of focusing on a 100 year event, which we are prepared for..

See you on Wednesday at the NA meeting. Is there anything you want me to focus on in my presentation?

Tim

-----Original Message-----

From: lbauerpvna@aol.com [mailto:lbauerpvna@aol.com]
Sent: Monday, November 15, 2010 12:58 PM
To: Hall, Tim; davidahyde@earthlink.net
Subject: Re: FW: Emailing: storm, storm manual

Teresa's 1,000-yr event refers to quantity of water not how often it will happen. I hope it will never happen, but the Water Bureau could have an early warning system, but you can see in Teresa's e-mail that she refuses to develop an escape plan, three times.

Linda Bauer

From: Elliott, Teresa
Sent: Monday, November 01, 2010 12:06 PM

Wednesday, December 15, 2010 AOL: lbauerpvna

36837

To: Bauer, Linda
Cc: Castleberry, Stacey
Subject: FW: Emailing: storm, storm manual

Hi Linda,

3) **Johnson Creek Drainage** - The other is a collection and conveyance system that discharges into the overflow and stormwater pipe that in turn discharges into Johnson Creek. An escape route is not required as determined by BES. As part of the analysis, an escape route was reviewed with respect to the Johnson Creek discharge system. Upon conference with the BES, it was determined that the collection system, meeting the requirements of the 100-year storm event, and the conveyance system which was designed to meet the reservoir overflow rate, would not need a formal escape route. The conveyance system necessary for reservoir overflow, **equivalent to a 1,000-yr event, far exceeds the necessary capacity to convey the stormwater.** The capacity of the overflow conveyance system, being much greater than the required design capacity for stormwater, suffices for the escape route.

Providing designs that over-size these facilities so that they can handle storms even larger than the 100-year event is their "escape route plan".