

36307

# New Columbia

IN NORTH PORTLAND'S PORTSMOUTH NEIGHBORHOOD



The first residents will be  
welcomed home with a  
special grand opening on  
Tuesday, May 3, 2005  
at 10:00 a.m.

Watch for your invitation  
in the mail.

Homecoming Celebration: May 3

a  
**Community  
Campus  
at  
New  
Columbia**

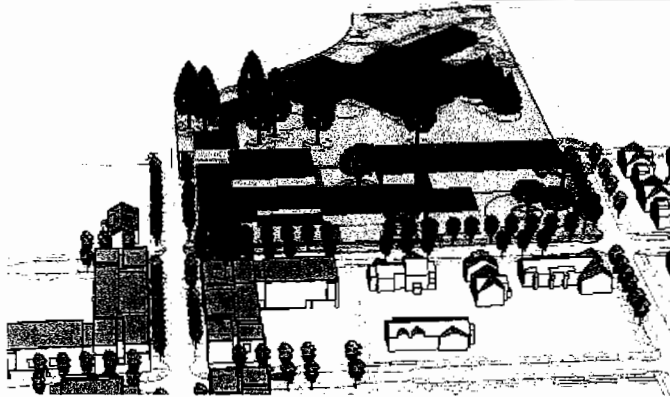

**Project Briefing Book**



*New Columbia*

## The Community Campus at New Columbia

### Success in the Making

The Community Campus at New Columbia is inspired by the joint vision of the Housing Authority of Portland, Portland Public Schools, the Boys & Girls Clubs and Portland Parks & Recreation. New Columbia, an 850-unit, mixed-income housing development is currently under way in North Portland's Portsmouth neighborhood. At 82 acres, this \$150 million dollar project is the largest revitalization ever undertaken in Oregon's history, and is a key element of the ongoing revitalization of North Portland. The New Columbia Community Campus will serve as a center for educational enrichment and community interaction, providing wide access to resources and a wealth of opportunities for students and their families.

**Hope at New Columbia:** The hopeful atmosphere of New Columbia is perhaps most evident in its commitment to children who will call this new neighborhood home. In its pledge to ensure children's educational and social achievement, New Columbia will welcome a new elementary school, co-located with a Boys & Girls Club to the Portsmouth neighborhood. These facilities will "join hands" with the existing University Park Community Center, creating a Community Campus that provides innovative spaces and programs designed to help youth thrive.

**The New School:** The Community Campus partners are committed to giving children an exceptional education in their own neighborhood. In order to accommodate the influx of 500 new elementary students who will begin arriving in the summer of 2005, Portland Public Schools (PPS) has partnered with the Housing Authority of Portland (HAP) to plan for a new school, replacing the aging John Ball Elementary. HAP and PPS set August 2006 as the marker for opening the new school, when nearly all of the residential units at New Columbia will be constructed. Likewise, the construction of a new Boys & Girls Club facility would mark the return of the Club to North Portland.

**The Corps of Discovery:** In the summer of 2004, volunteer leaders from the community came together to explore the prospects and resources needed to make a new school a reality. From this

meeting the "Community Campus" master plan was created. In February 2005, the PPS school board passed a resolution confirming their agreement with the master plan and accepted the donation of land from HAP. PPS also agreed to once again match

HAP's additional \$100,000 to advance the design process. The Corp of Discovery has now focused their attention on identifying resources to raise the needed funds for construction.

**Sharing Space / Reducing Costs:** Partners have come to the table with cooperation on their minds. Reducing the duplication of services and maximizing joint use of space lowers the overall capital cost. If built in isolation, the new school and the BGC would cost upwards of \$22million. By co-locating and creating a Community Campus, the total cost drops to \$12 million. This cost-effective use of public funds is the

type of non-traditional partnership that the public wants to see.

**Shared Vision:** For the roughly 1,400 youth anticipated to be living at New Columbia by 2007, as well as the youth throughout the Portsmouth neighborhood, the Community Campus will be an inviting and thriving center, providing exceptional before, during and after-school programs to the neighborhood's young people and their families.

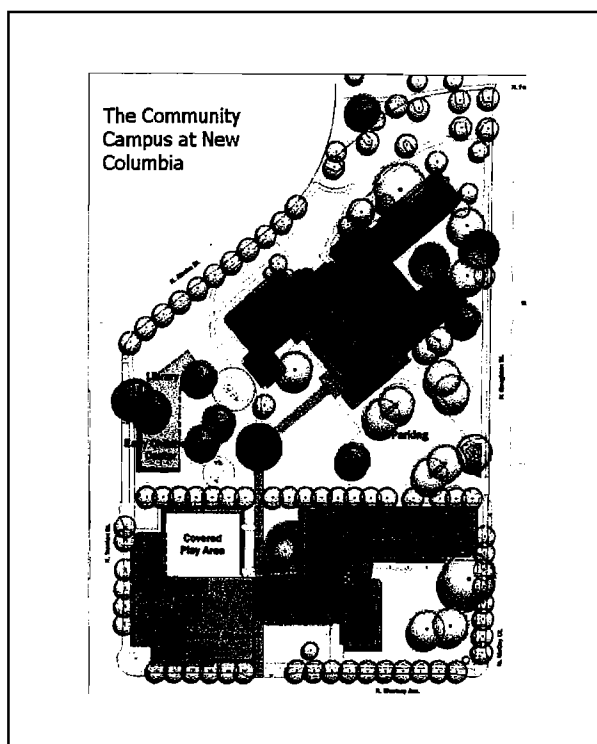

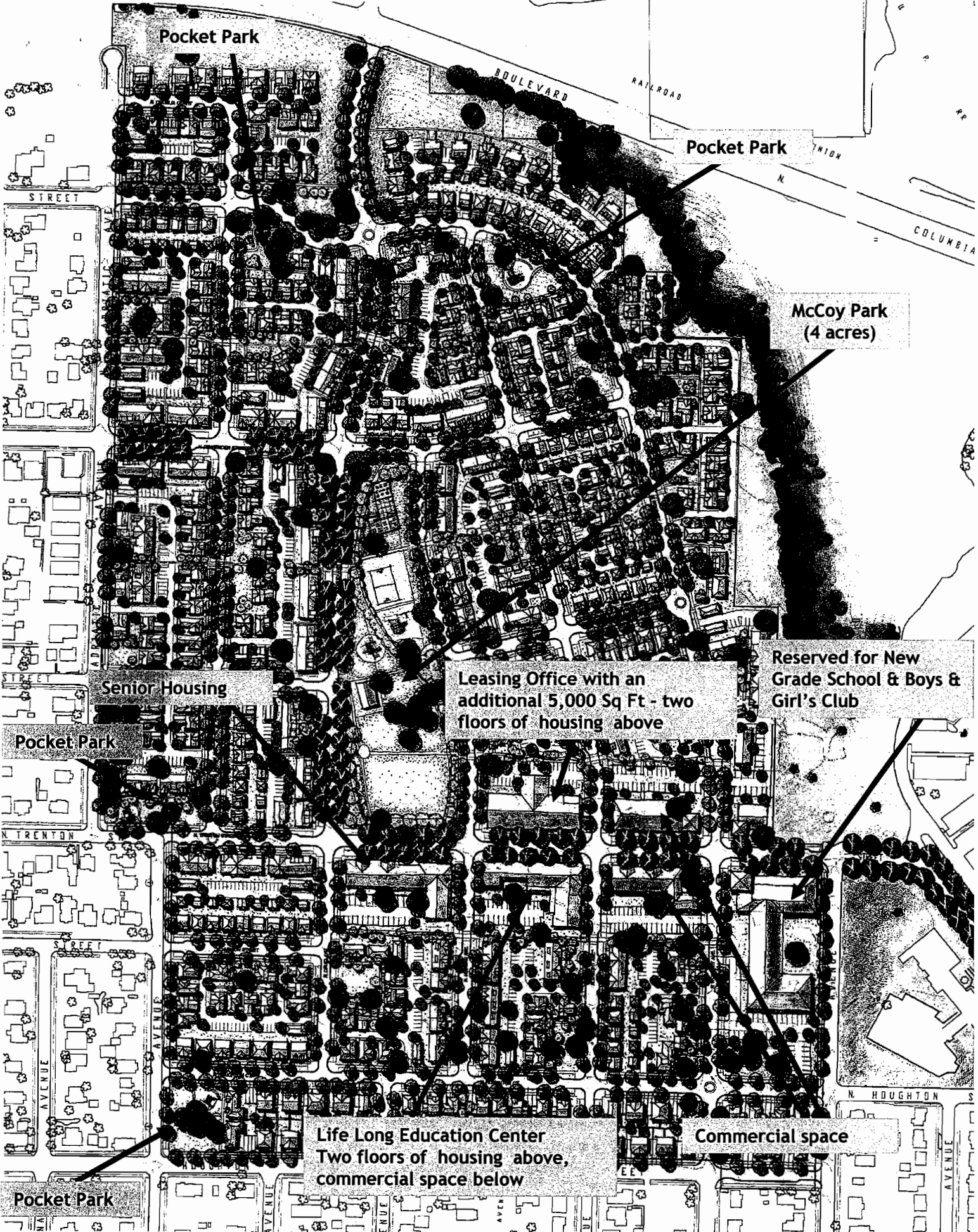

Pocket Park

Pocket Park

McCoy Park  
(4 acres)

Senior Housing

Leasing Office with an  
additional 5,000 Sq Ft - two  
floors of housing above

Reserved for New  
Grade School & Boys &  
Girl's Club

Pocket Park

Life Long Education Center  
Two floors of housing above,  
commercial space below

Commercial space

Pocket Park

# New Columbia - Master Site Plan - July 2003

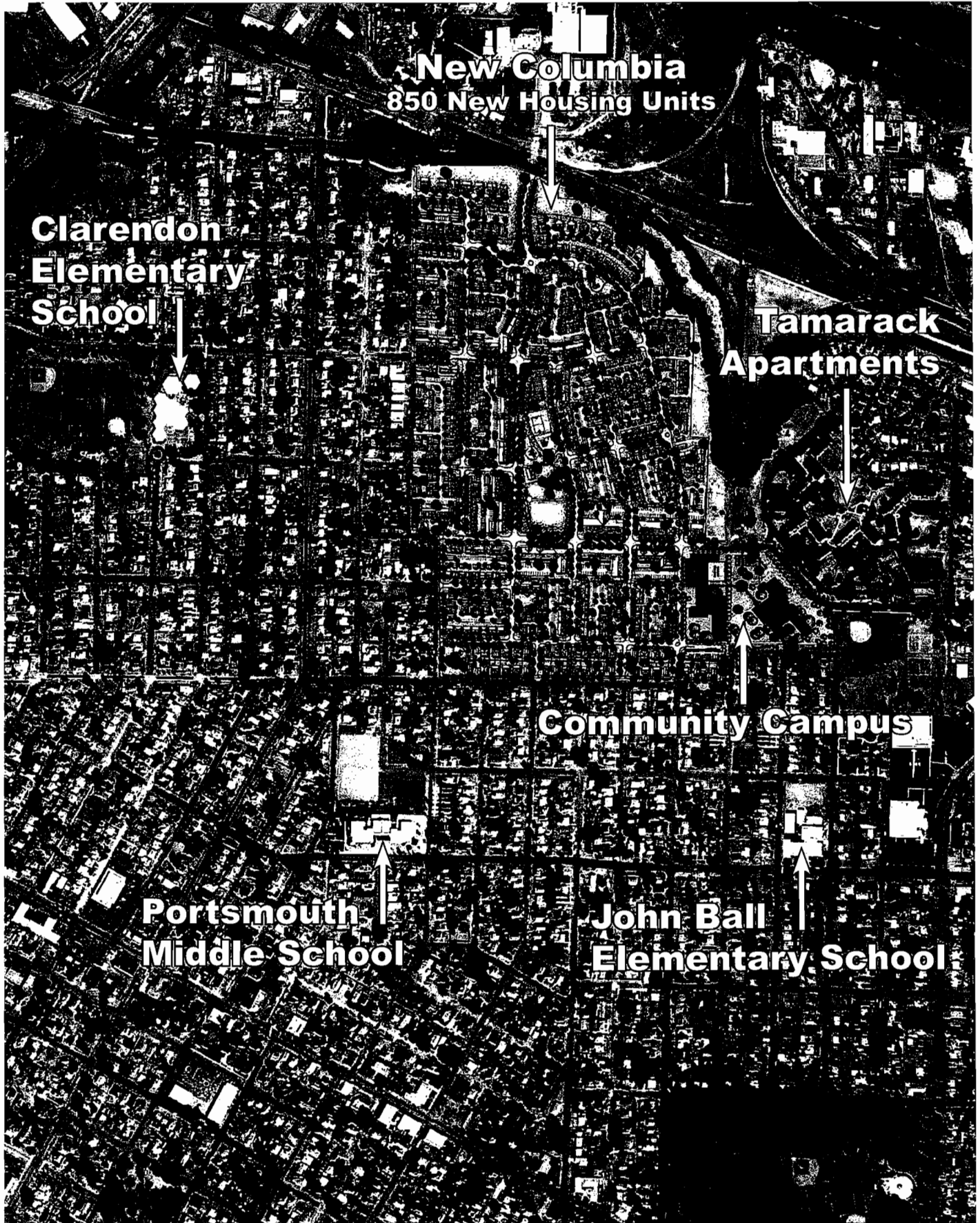

**New Columbia**  
850 New Housing Units

**Clarendon  
Elementary  
School**

**Tamarack  
Apartments**

**Community Campus**

**Portsmouth  
Middle School**

**John Ball  
Elementary School**

DULL OLSON WEEKES  
architects inc.



318 SW WASHINGTON ST. #200 PORTLAND, OR 97204  
T: 503 776 8950 F: 503 273 8192 www.dowa.com

**New Columbia in North Portland's  
Portsmouth Neighborhood**

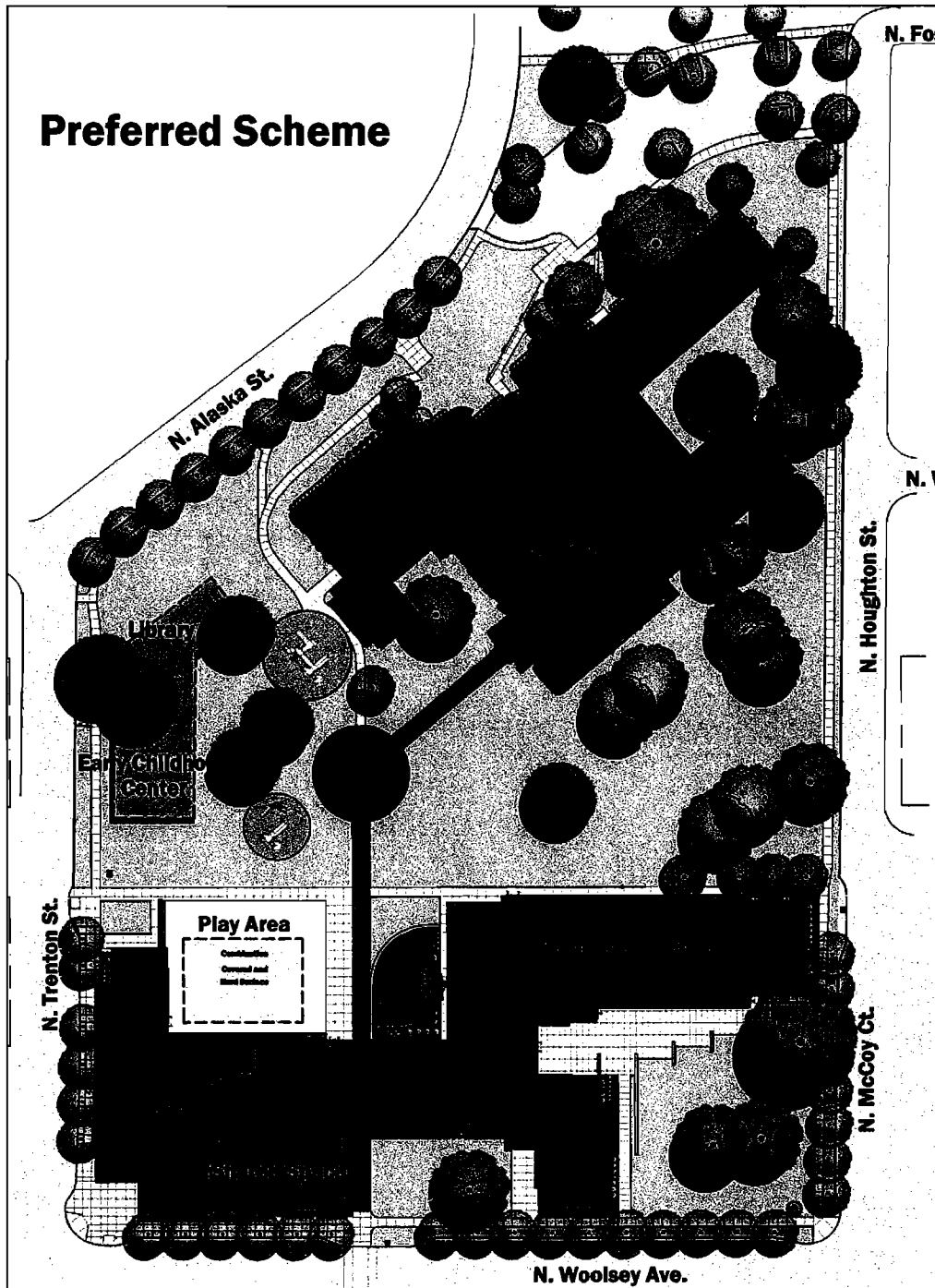

DULL OLSON WEEKES  
architects inc.



**THE COMMUNITY CAMPUS AT NEW COLUMBIA**  
HOUSING AUTHORITY OF PORTLAND /  
PORTLAND PUBLIC SCHOOLS



phase Schematic Design  
date JAN 19, 2005  
project # 04038



315 SW WASHINGTON ST #200 PORTLAND, OR 97204  
T 503 276 8950 F 503 273 9182 www.dow.com

**Site Plan**