

BUM

file? Hoyt  
Location? 1980

DEAR MR. NOZAKI

THANK YOU FOR COMING BY  
AND DISCUSSING THE PARKING PROBLEM  
WITH MRS. HOOVER AND MYSELF ON  
APRIL 24. THIS IS A FOLLOW UP LETTER  
AS TO THE PROGRESS BEING MADE ON  
CHANGING THE METER PARKING TO A  
TRUCK LOADING ZONE IN FRONT OF MY  
RESTUARANT AND THE CHANGING OF THE  
LENGTH OF TIME ON MRS. HOOVERS METERS.  
IF THESE THINGS COULD BE DONE  
IT WOULD BE GREATLY APPRECIATED.

TR# 9658  
WO# 25528  
4-28-80

RECEIVED  
APR 25 1980  
BUREAU OF  
TRAFFIC ENGINEERING

THANK YOU  
Lennis Valley  
OWNER PETTICOAT JUNCTION  
1036 N.W. Hoyt  
224-9274

Wright  
1980

December 4, 1980

C. J. MASCO	
TO: NICKI	
Date: 12-8-80	
Assign To: R. MOORE	
Refer To:	
Refer To:	
Discuss With Me	X
Prepare Memo	
Put Your Info.	
Prepare Answer	
Phone Attend	

Dear Mr. Koening,

Sincerely yours,

Sincerely yours,  
  
Carol M. Angel  
Certified Public Accountant

WO# 28719  
TR# 10913

**RECEIVED**  
**DEC 6 1980**  
**BUREAU OF**  
**NAUTIC ENGINEERING**

UNITED STATES POST OFFICE

PORTLAND, OREGON 97208

*Hoyt*

OUR REF: REC:rbh

DATE: January 2, 1980

SUBJECT: Dangerous and Obstructed Intersection

P.O.CL:

TO: Mr. Don E. Bergstrom  
City Traffic Engineer  
City of Portland  
420 S. W. Main Street  
Portland, Oregon 97204

Dear Mr. Bergstrom:

Recently, the Portland Post Office had a serious motor vehicle accident at the intersection of N.W. 10th Avenue and N.W. Hoyt Street. The primary cause of this accident was the poor visibility of traffic available to our driver.

The business located on this corner has a two stall truck loading zone located on the S. W. corner of N.W. 10th and N.W. Hoyt Street. When two large trucks are parked in this location it is virtually impossible to see the northbound traffic on 10th Street (please refer attached diagram).

Because of the one serious accident we have had and the many near misses, we would like to have this truck parking area removed, if at all possible. Other delivery service type of agencies have also expressed a deep concern for the dangerous character of this intersection.

If we can help in any way or you desire statistical data, please feel free to contact me at your convenience.

Sincerely,

*Raymond E. Clark*

RAYMOND E. CLARK  
Safety Specialist  
U. S. Postal Service

*221-3481*

*221-3518*

*Called Mr. Clark*

*10' to be removed from TLZ*

*Margin 4-29-80*

*T.R. 9009*

RECEIVED

JAN 7 1980

BUREAU OF  
TRAFFIC ENGINEERING

UNITED STATES POST OFFICE

PORTLAND, OREGON 97208

OFFICIAL BUSINESS

S-194

SAFETY OFFICER, U.S. POSTAL SERVICE  
715 N.W. HOYT STREET - ROOM 2  
PORTLAND, OREGON 97208





FIELD SKETCH (Use appropriate one. See reverse side.)

Hometown Hardware

#1-POSTAL VEHICLE

#2-PRIVATE VEHICLE

PARKING LOT

N.W. Hoyt

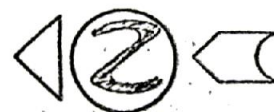

INDICATE NORTH

N.W. 10th

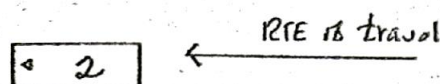
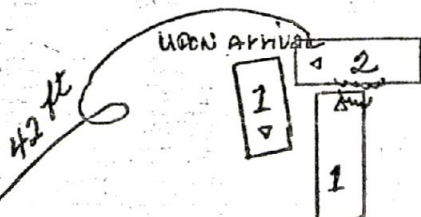

*Very poor visibility from this location.*

3 LOADING ZONE  
Flat Bed truck

STOP

Off Elect.

UPON ARRIVAL

INDICATE  
Width of roadway,  
traffic flow,  
parked vehicles,  
traffic signs or  
signals, etc.

OBTAIN ACCURATE  
MEASUREMENTS FROM  
FIXED OBJECTS

ALSO INDICATE  
Approach of vehicles,  
point of impact and  
place where vehicles  
stopped after accident.

Route of travel

912 MW 20-80

N.W. Hoyt --- 35 ft 10 inches

N.W. 10th --- 42 ft 2 inches

No visible skid #1 or #2

Photographs --- ALL ANGLES  
incl. vehicles

#1 (P.O.) Pulled Forward  
Approx 36' Before Impact

THE CITY OF  
**PORTLAND**



**OREGON**

DEPARTMENT OF  
PUBLIC WORKS  
MIKE LINDBERG  
COMMISSIONER

OFFICE OF  
PUBLIC WORKS  
ADMINISTRATOR

621 S.W. ALDER  
PORTLAND, OR 97205

TEMPORARY STREET CLOSURE PERMIT

A revocable permit in accordance with Section 17.44.020 of the Code of the City of Portland is hereby issued to Laurie Price

to close N.E. Hoyt Street from N.E. 32nd Avenue to N.E. Mirimar Place

temporarily in order to hold a block party

from 2:00 PM - 8:00 PM (time) Saturday, June 21, 1980 (date)  
and to not provide for pedestrian traffic

1. This permit is for the use of the street area only and shall be subject to necessary use by emergency vehicles.
2. This permit shall not exempt the grantee from obtaining any license or permit required by the City Code or Ordinances for any act to be performed under this permit, nor shall this permit waive the provisions of any City Code, Ordinance, or the City Charter except as herein stated.
3. The grantee shall hold the City of Portland, its officers, agents, and employees free and harmless from any claims for damages to persons or property, including legal fees and costs of defending any actions or suits, including any appeals which may result from the use of the street area under this permit by providing evidence of insurance protecting the City of Portland, its officers, agents, and employees as follows:  
Bodily injury \$100,000 for one claimant and \$300,000 for one occurrence,  
property damage \$50,000 for one claimant and \$300,000 for one occurrence, said insurance to be kept in full force and effect at all times. This permit is automatically revoked without further action by the Council if this insurance is permitted to lapse, is cancelled or, for any other reason, becomes inoperative.
4. This permit is revocable at any time, either by the Bureau of Police or the City Engineer, and no expenditure of money or lapse of time or other act or thing shall operate as an estoppel against the City of Portland or be held to give the grantee any vested or other right. Upon revocation of this permit, the grantee shall immediately reopen said street to the normal use of the public.
5. The grantee shall at his own expense provide barricades, signs, and illumination as required by City Engineer and Traffic Engineer.

Additional Permits Required:

Bur. Traffic Eng. (Meter Hoods)  
Bur. Buildings (Street Use)  
Bur. Neighborhood Environ. (Noise)

Insurance On File  
Fee None  
Receipt #             
BUC #           

cc: Bureau of Buildings  
Bureau of Traffic Engineering  
Bureau of Police  
Bureau of Fire

CITY ENGINEER

by

Accepting the terms and conditions of this permit:

Grantee

Date Signed June 17, 1980

Permit No. 5-80