

Connected Centers Street Plan



PBOT

Focus on centers

Jade District and Rosewood

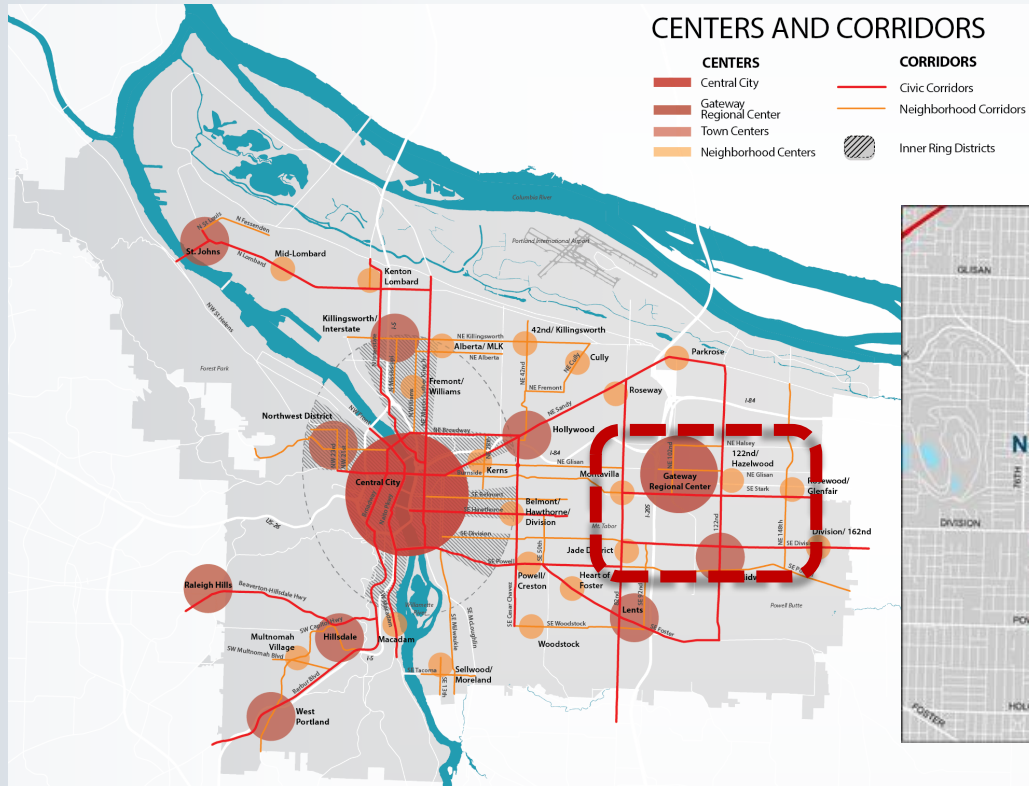

New connections within centers

Neighborhood Center: Jade District blocks

Blocks that exceed street spacing standards:

- North/South
- East/West
- Both

Unimproved
Right-of-Way

Blocks that
exceed street
spacing standards

- Greater than 530 feet North/South
- Greater than 530 feet North/South and East/West
- Greater than 530 feet East/West

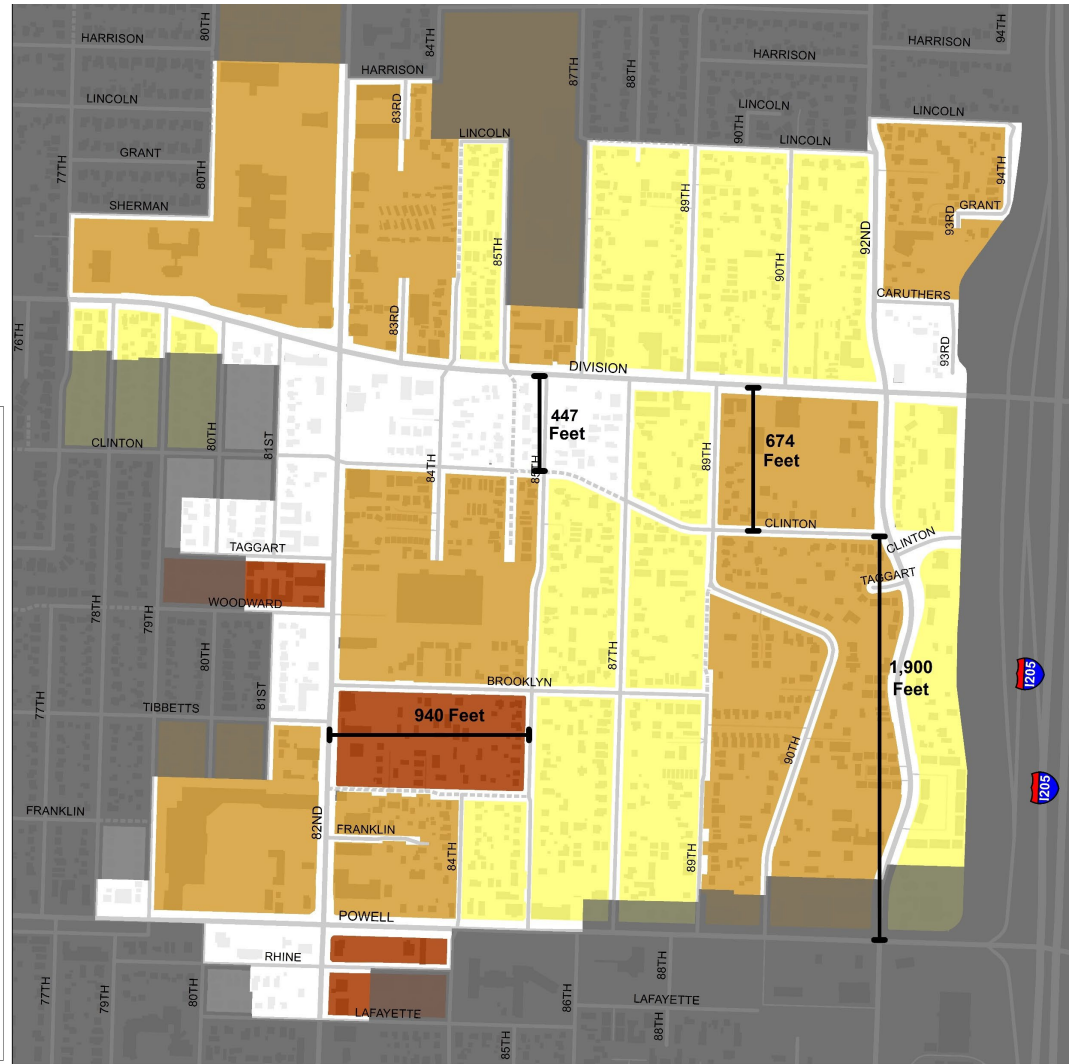

Pedestrian connectivity

- Good
- Fair
- Poor

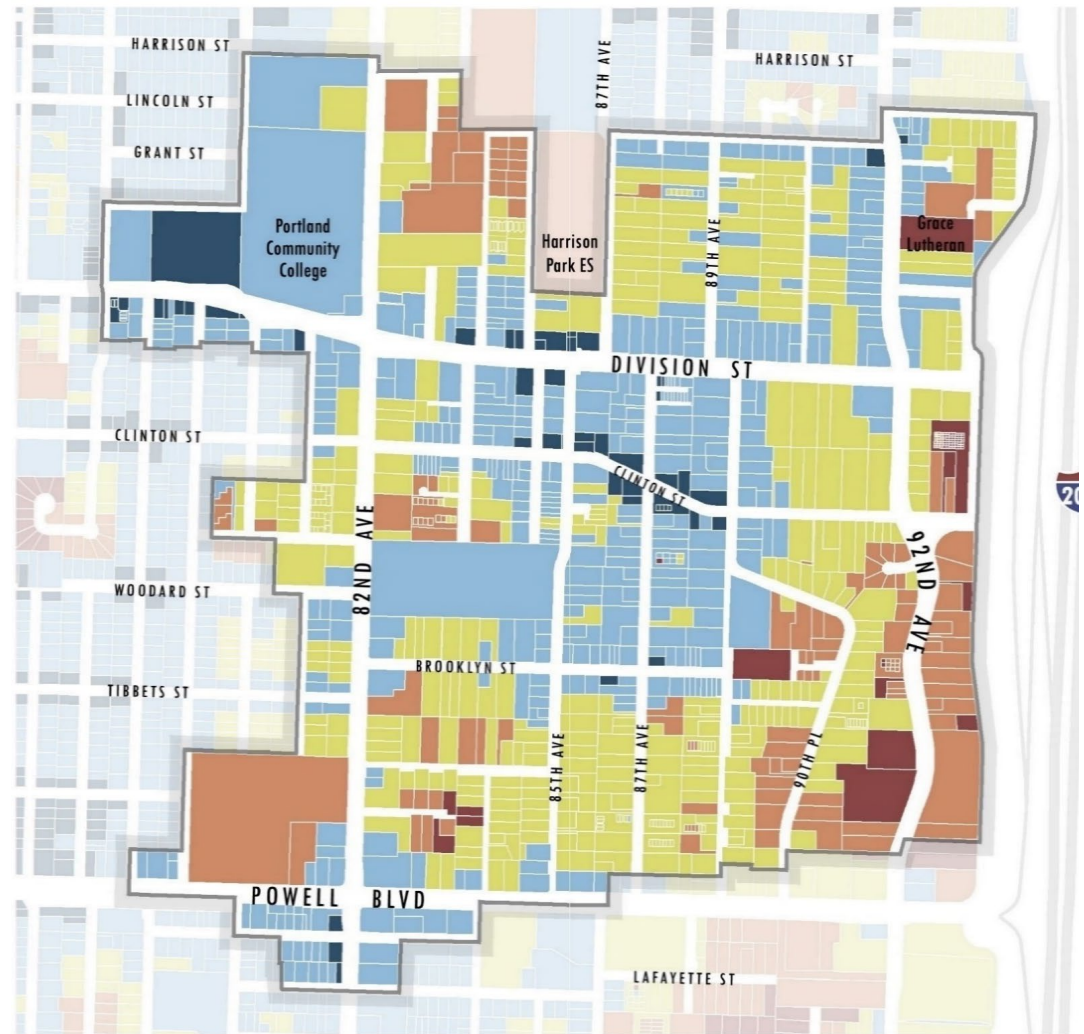
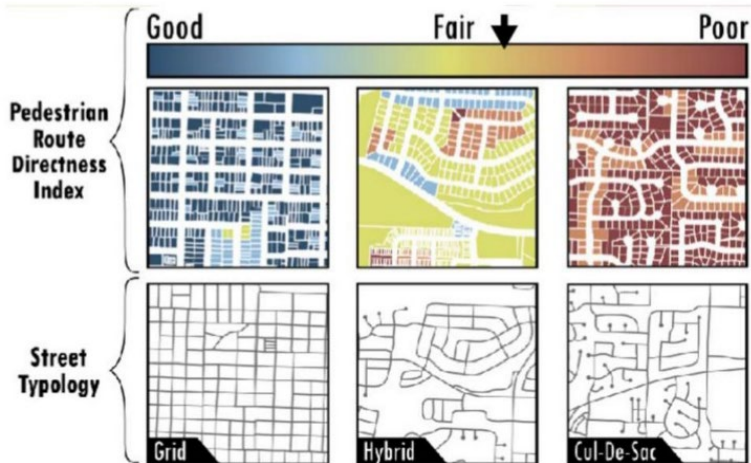

Future connections?

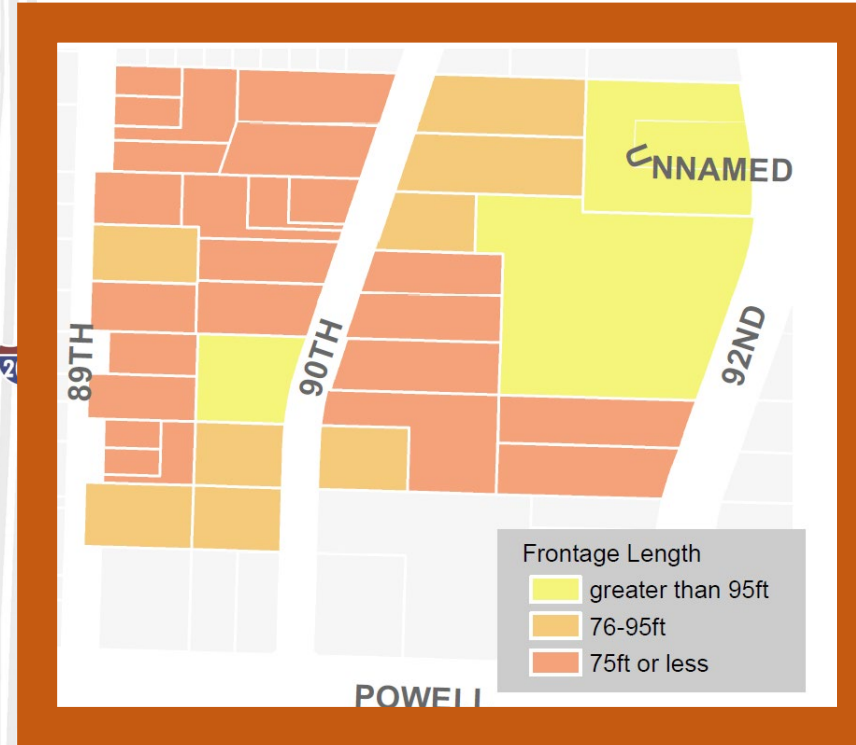
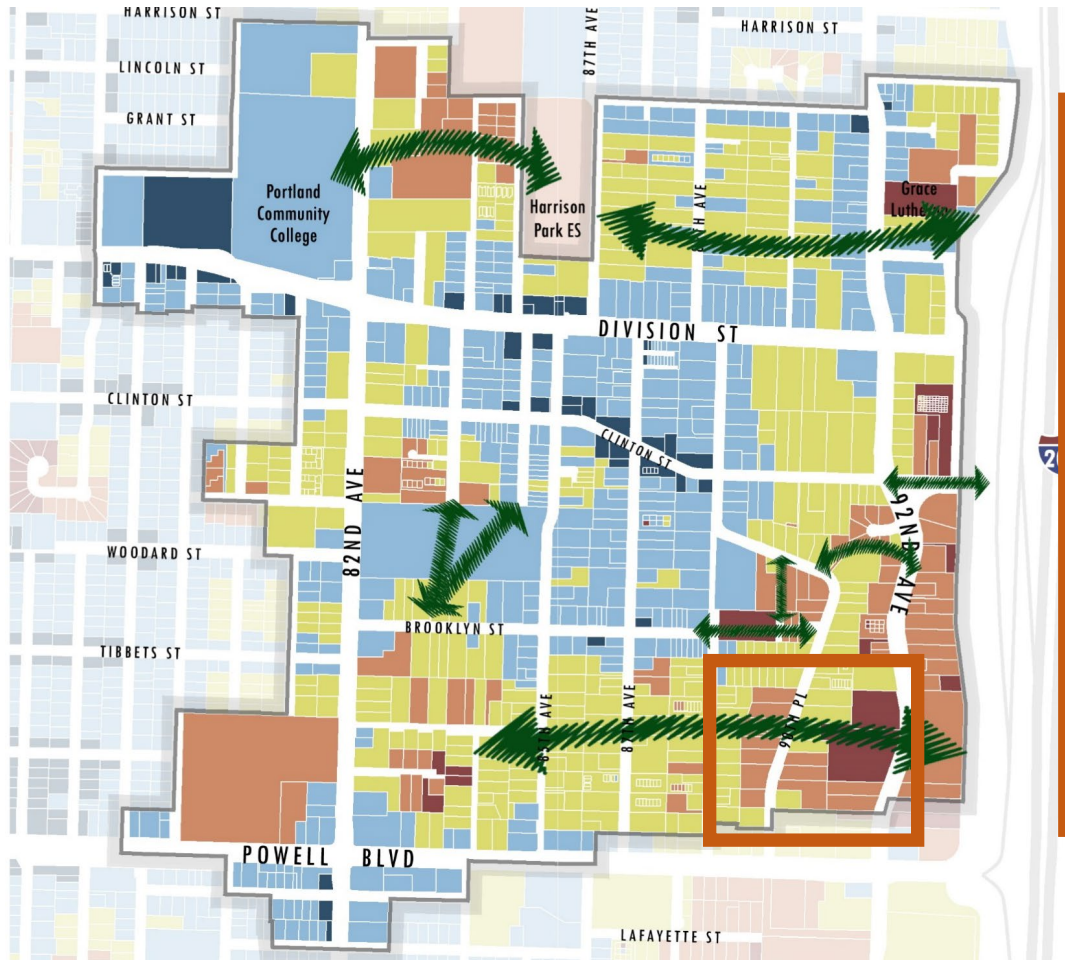

Street connection

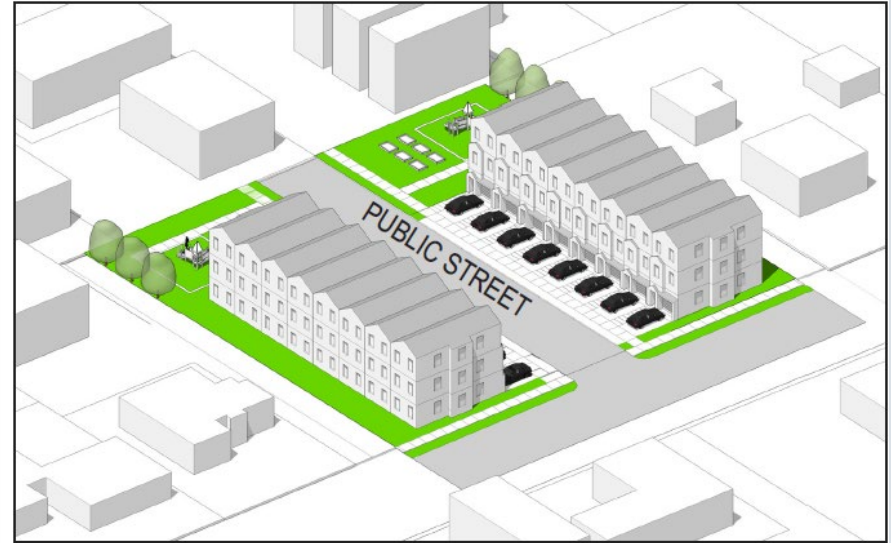

- Typical ROW: 50-60 ft
- Full Street: 46 ft min
- $\frac{3}{4}$ Street: 36 ft min

Public street



Private street/driveway



Pedestrian connection

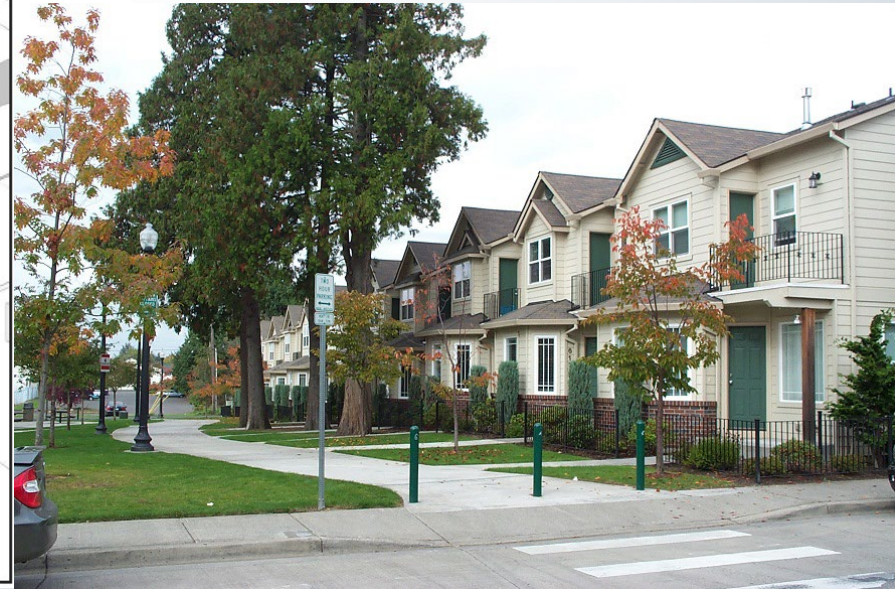
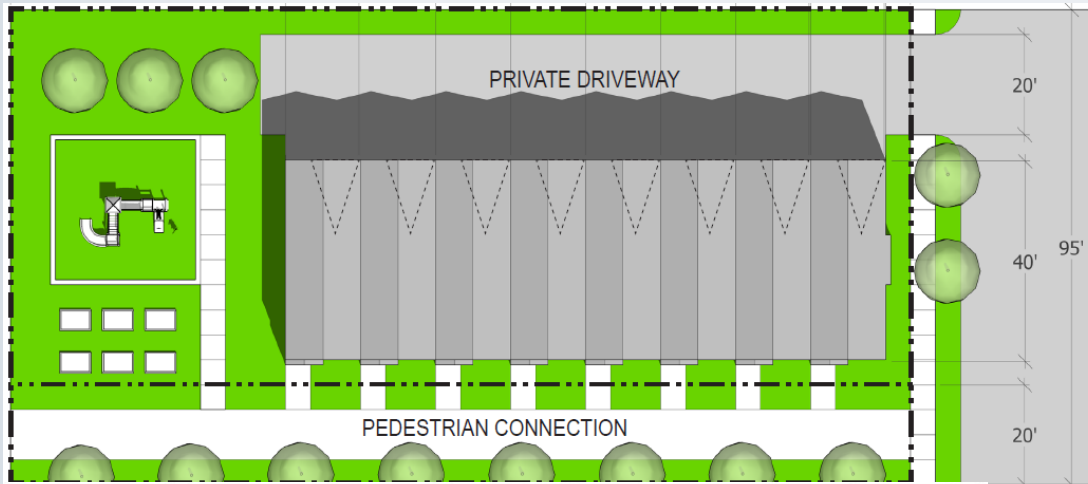

Connection Types

order of
priority

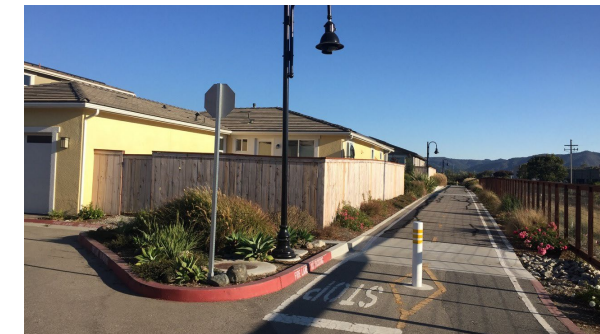
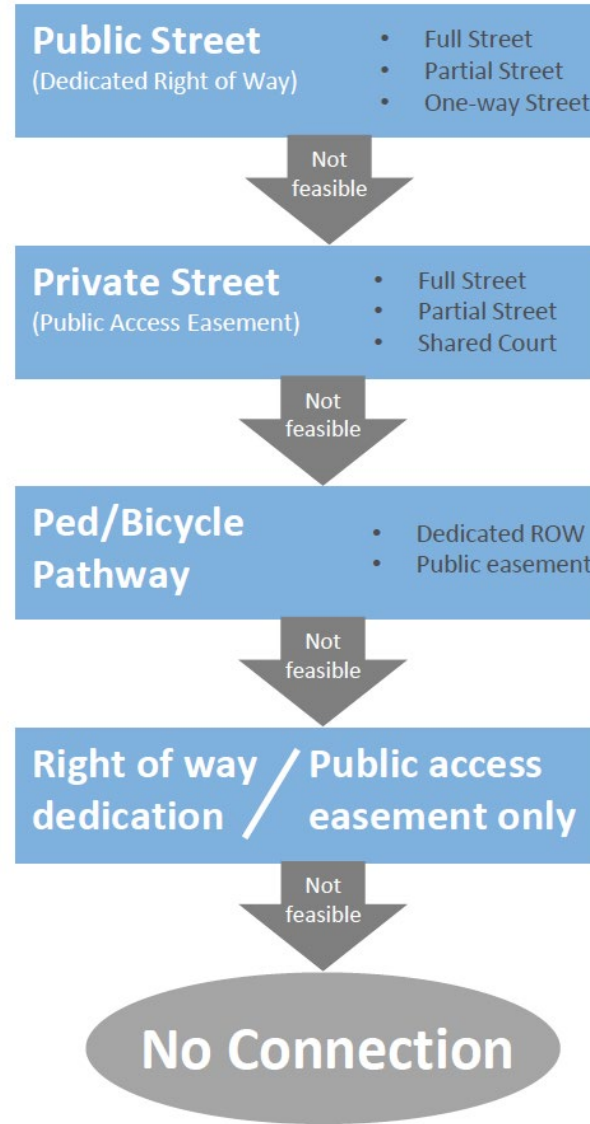

Separate driveways

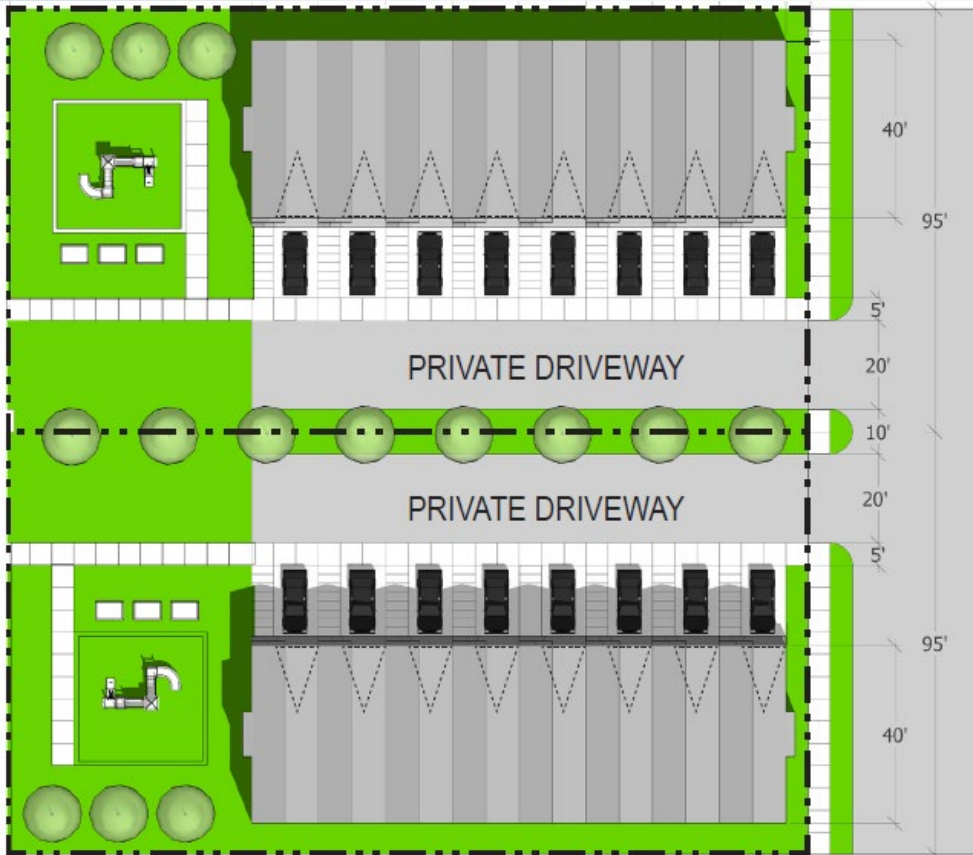

Separate Driveways



Density allowances



Public Street

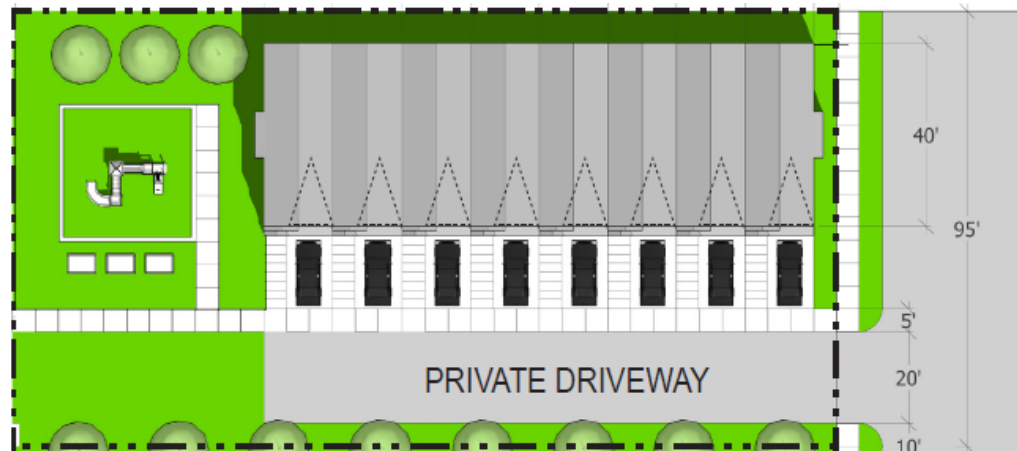

Private Driveway

Site consolidation





Bureau of Planning and Sustainability
Innovation. Collaboration. Practical Solutions.



Incremental Block

