

## Development Services

### From Concept to Construction

Phone: 503-823-7300 Email: [bds@portlandoregon.gov](mailto:bds@portlandoregon.gov) 1900 SW 4th Ave, Portland, OR 97201  
 More Contact Info (<http://www.portlandoregon.gov/bds/article/519984>)



#### APPEAL SUMMARY

**Status:** Hold for Additional Information

<b>Appeal ID:</b> 24368	<b>Project Address:</b> 2801 N Gantenbein Ave
<b>Hearing Date:</b> 11/25/20	<b>Appellant Name:</b> Katherine Ross
<b>Case No.:</b> B-005	<b>Appellant Phone:</b> 5038632491
<b>Appeal Type:</b> Building	<b>Plans Examiner/Inspector:</b> Jeff Rago, Terry Kimmons
<b>Project Type:</b> commercial	<b>Stories:</b> 10 <b>Occupancy:</b> I-2 <b>Construction Type:</b> I-A
<b>Building/Business Name:</b>	<b>Fire Sprinklers:</b> Yes - Throughout
<b>Appeal Involves:</b> Alteration of an existing structure	<b>LUR or Permit Application No.:</b> 20-115059-CO
<b>Plan Submitted Option:</b> pdf [File 1]	<b>Proposed use:</b> I-2, Hospital

#### APPEAL INFORMATION SHEET

##### Appeal item 1

<b>Code Section</b>	Portland Fire Code - 1008.1.9.6
<b>Requires</b>	<p>Portland Fire Code - 1008.1.9.6. Special locking arrangements in door in Group I-1, I-2, R-4, and R-3 facilities providing care. In facilities subject to licensure by state, approved special egress locks shall be permitted in a Group I-1, I-2, R-4, or R-3 facilities providing care where the clinical needs of persons receiving care require such locking. Special egress locks shall be permitted in such occupancies where the building is equipped throughout with automatic sprinkler systems in accordance with Section 903.3.1.1 in Group I-1 and I-2, Section 903.3.1.2 in Group R-4 and Section 903.3.1.3 in Group R-3 facilities providing care, or an approved automatic smoke or heat detection system installed in accordance with Section 907, provided that the doors are installed and operate in accordance with Items 1 through 7 below.</p> <p>The doors unlock upon actuation of the automatic sprinkler system or automatic fire detection system.</p> <p>The doors unlock upon loss of power controlling the lock or lock mechanism.</p> <p>The door locks shall have the capability of being unlocked by a signal from fire command center, a nursing station or other approved location.</p> <p>A building occupant shall not be required to pass through more than two doors equipped with a special egress lock before entering an exit.</p> <p>The procedures for the operation(s) of the unlocking system shall be described and approved as part of the emergency planning and preparedness required by Chapter 4.</p> <p>All clinical staff shall have the keys, codes or other means necessary to operate the locking devices.</p> <p>Emergency lighting shall be provided at the door.</p>
<b>Code Modification or Alternate Requested</b>	The intent of this is appeal is to modify the criteria item #1 for a special locking arrangement so that 2 fire alarm devices must be activated for doors to unlock in order to prevent someone from pulling a fire alarm and eloping with an infant.

**Proposed Design** We are building a Family Birth Center unit on the 9th floor of Randall Children's Hospital. The new unit has 3 entry points doors (98C2, 98C1B, and 98S2) on the 9th floor. All entrances to the unit have card readers for staff to open door from outside and from inside the unit.

We propose that these entries will meet all of the criteria listed with one minor modification in regard to Item #1. We propose that on fire alarm, doors 98C2, 98C1B, and 98S2 will only unlock when two separate fire alarm devices are activated.

---

**Reason for alternative** The design intent with this strategy is to reduce risk of infant abduction if someone were to pull a fire alarm while attempting to elope.

This will provide equivalent life safety to the project by still maintaining the connection between the locking system and the fire alarm system. In the event of a fire, multiple devices would be activated which will unlock the doors. Our team has corresponded with the Fire Marshall, Terry Kimmons, about this and he noted that he had no issues with this strategy.

---

## APPEAL DECISION

**Alternate release method of special egress lock within I-2 facility: Hold for additional information. Appellant may contact John Butler (503 865-6427) or e-mail at [John.Butler@portlandoregon.gov](mailto:John.Butler@portlandoregon.gov) with questions.**

Additional information is submitted as a no fee reconsideration, following the same submittal process and using the same appeals form as the original appeal. Indicate at the beginning of the appeal form that you are filing a reconsideration and include the original assigned Appeal ID number. The reconsideration will receive a new appeal number.

Include the original attachments and appeal language. Provide new text with only that information that is specific to the reconsideration in a separate paragraph(s) clearly identified as "Reconsideration Text" with any new attachments also referenced. No additional fee is required.

---

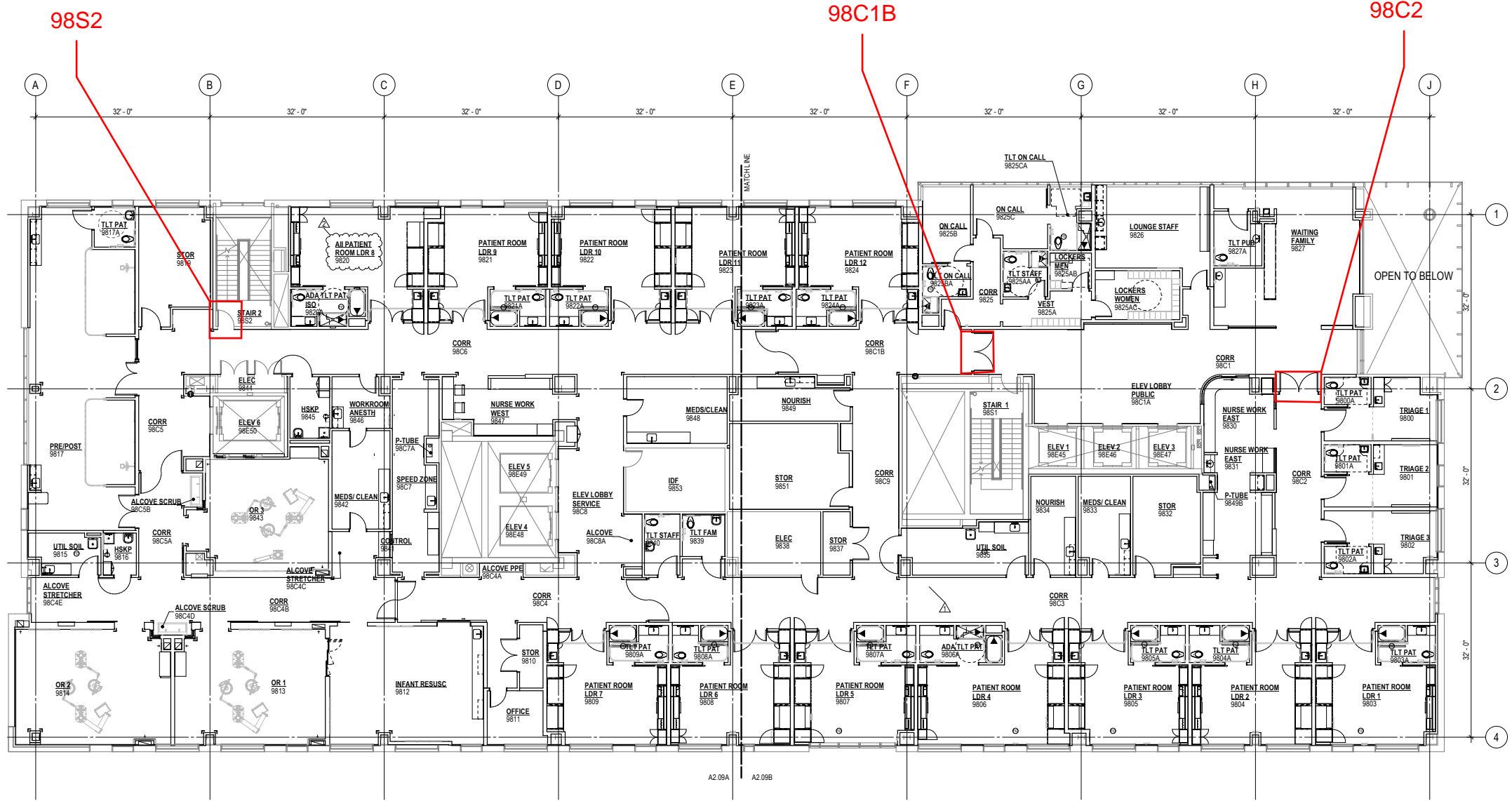

2 NINTH FLOOR PLAN  
A2.09 1/8" = 1'-0"

GENERAL NOTES - FLOOR PLAN

- REFER TO SHEET A0.01 FOR SYMBOLS LEGEND.
- REFER TO LIFE SAFETY, LS \* SERIES SHEETS FOR LOCATION AND EXTENT OF ALL FIRE RATED ASSEMBLIES.
- REFERENCE PLANS AND A8.00 FOR ALL PARTITION TYPES, REQUIREMENTS FOR RECESSED ITEMS IN RATED PARTITIONS, FIRESTOPPING AND WALL BRACING INFORMATION.
- REFER TO SHEET A8.21 FOR DOOR SCHEDULE AND DETAIL REFERENCES.
- SEE MECHANICAL, ELECTRICAL AND PLUMBING DRAWINGS, FOR ADDITIONAL OPENINGS IN WALLS.
- ALL INTERIOR FURRING ON EXISTING WALLS AND RECTANGULAR COLUMN SURROUNDS ARE TYPE  $\frac{1}{2}$ " UNO.
- STANDARD WALL TYPE IS  $\frac{1}{2}$ " UNO.
- PROVIDE REINFORCEMENT IN PARTITIONS AS REQUIRED FOR ANCHORAGE OF CASEWORK, MILLWORK AND ANY WALL SUPPORTED EQUIPMENT AND/OR ACCESSORIES. REFERENCE A7.01 INTERIOR ELEVATIONS FOR LOCATIONS.
- FOR TYPICAL FLOOR TRANSITION DETAILS THAT ARE NOT KEYED ON PLANS REFER TO SHEET A8.02.
- REFER TO SHEET A8.21 FOR RELITE SCHEDULE AND DETAIL REFERENCES.
- CONTRACTOR TO COMPLETE/REPAIR EXTERIOR WALLS AS NECESSARY
- REFER TO REFLECTED CEILING PLANS FOR LOCATIONS AND EXTENTS OF CUBICLE CURTAIN TRACKS.

LEGEND - FLOOR PLAN

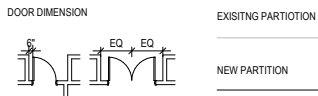

\*PLAN IS NOT TO SCALE