

Development Services

From Concept to Construction

Phone: 503-823-7300 Email: bds@portlandoregon.gov 1900 SW 4th Ave, Portland, OR 97201

More Contact Info (<http://www.portlandoregon.gov/bds/article/519984>)



APPEAL SUMMARY

Status: Hold for Additional Information

Appeal ID: 20489	Project Address: 1510 NE 37th Ave
Hearing Date: 6/12/19	Appellant Name: Kevin Cooley
Case No.: B-003	Appellant Phone: 360-773-5130
Appeal Type: Building	Plans Examiner/Inspector: Robert Keal
Project Type: commercial	Stories: 2 Occupancy: M Construction Type: III-B
Building/Business Name: Cross Mini Golf	Fire Sprinklers: Yes - Basement
Appeal Involves: other: Change of use from retail to miniature golf	LUR or Permit Application No.: 19-157844-CO
Plan Submitted Option: pdf [File 1]	Proposed use: retail and miniature golf

APPEAL INFORMATION SHEET

Appeal item 1

Code Section	1004.1.2
Requires	A miniature golf facility most closely fits an A3 occupancy definition, amusement arcade or bowling alley, but Table 1004.1.2 does not give specific direction in determining the occupancy load of a miniature golf facility. The exception to 1004.1.2, when approved by the building official, allows the use of an actual occupant count in lieu of an area calculation for determination of the design occupant load.
Proposed Design	We will limit the number of holes to twelve. Therefore, a calculation of four occupants per hole yields total occupant load of 48 in the miniature golf area.
Reason for alternative	The miniature golf holes will occupy a portion of the area that was formerly occupied by the Mountain Shop, a sporting goods retailer. The miniature golf use will be a less intensive use of the space than the former retail use, and the low nature of the golf holes will allow improved visibility in the space. The four occupants per hole calculation was allowed by Appeal ID 3849. If we used an occupant load of 15 square feet per occupant for the 2470 square feet of the miniature golf area, it would result in almost 14 occupants per hole. All of the holes will be accessible as defined by ICC A117.1-2009.

APPEAL DECISION

Reduction in occupant load based on the intended function of the space: Hold for additional information. Appellant may contact John Butler (503 823-7339) with questions.

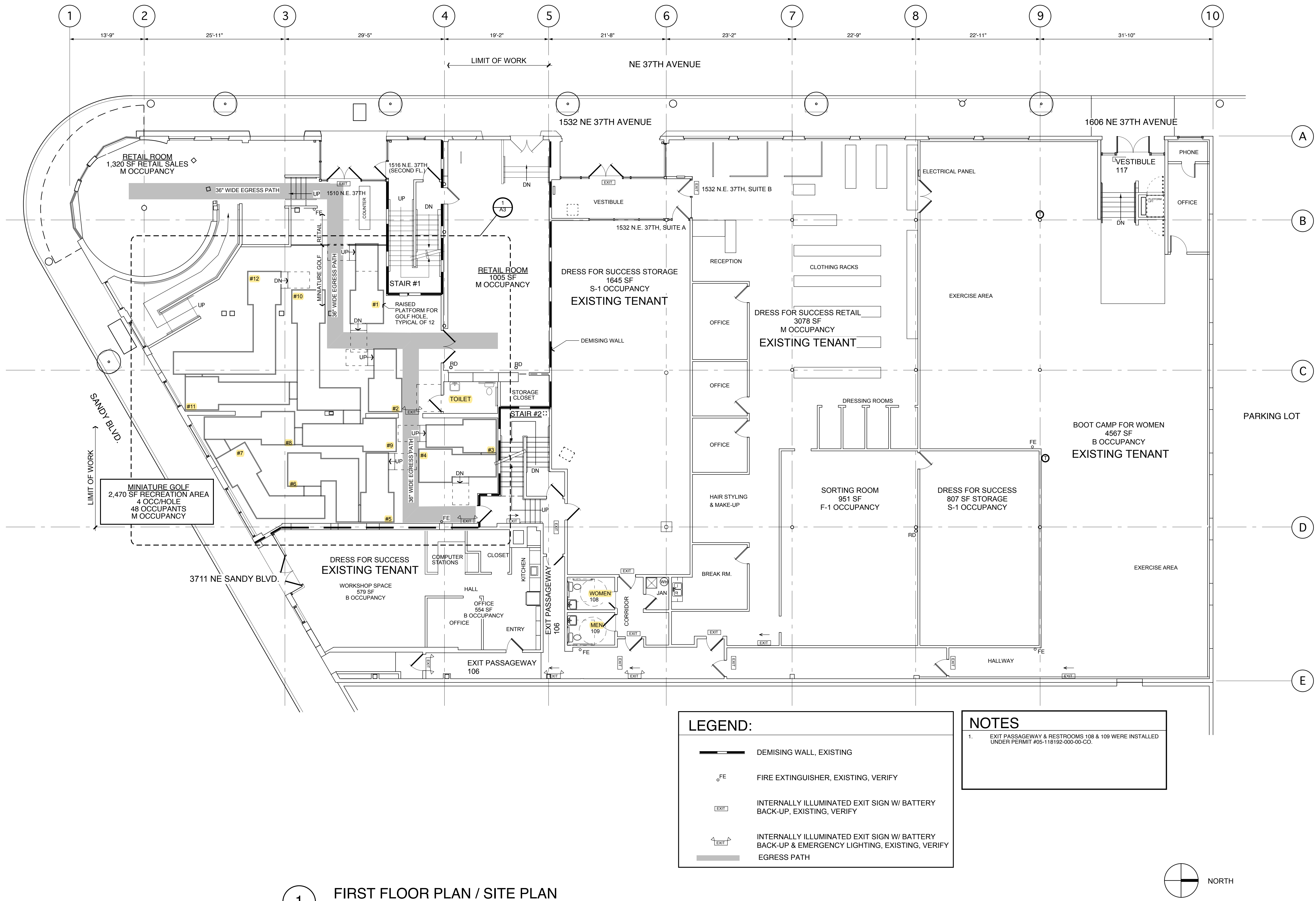

1 FIRST FLOOR PLAN / SITE PLAN
1/8" = 1'-0"

Kevin
Cooley,
Architect
400 E. Evergreen Blvd.
Suite 209
Vancouver, WA 98660
360-773-5130
kcarch54@gmail.com

Curtis Building

FIRST FLOOR CHANGE OF USE
CROSS MINI GOLF
1510 NE 37TH AVENUE
PORTLAND, OR 97212

Owner:
3701 Investors LLC
3514 NE US Grant Place
Portland, OR 97212
(503) 206-1071

Dates/Revisions:
5/9/19
6/5/19



FIRST FLOOR/
SITE PLAN

Sheet Number:
A2
1904