

Planning & Sustainability

Commission Agenda Item January 26, 2021

Street Vacation of SE Grand Avenue and SE Tenino Street
(RWA File No. 6753)

WE KEEP PORTLAND MOVING.



PBOT
PORTLAND BUREAU OF TRANSPORTATION

Proposed Vacation Area

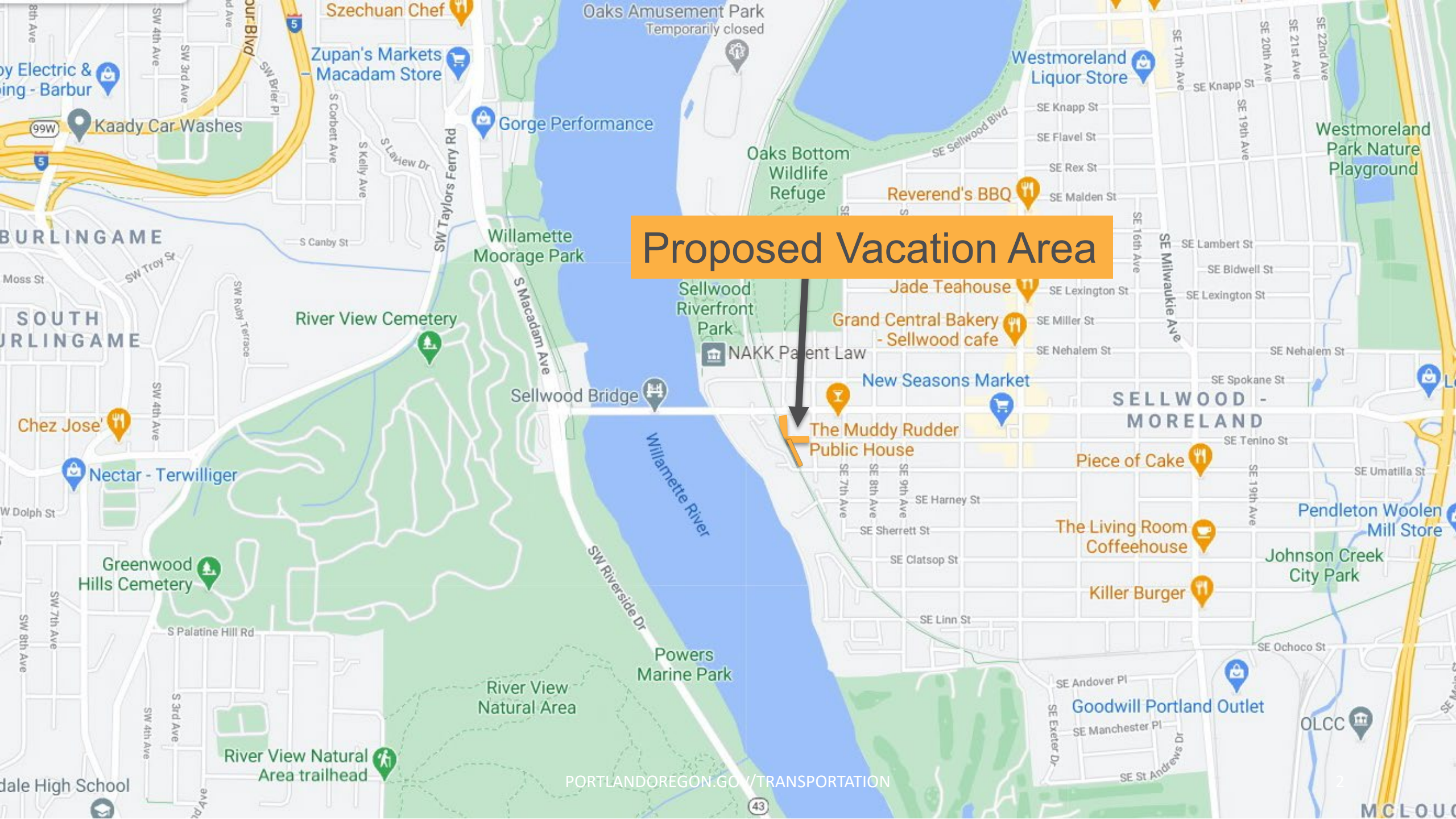

Street Areas to be Vacated: SE Grand Avenue and SE Tenino Street

Exhibit A

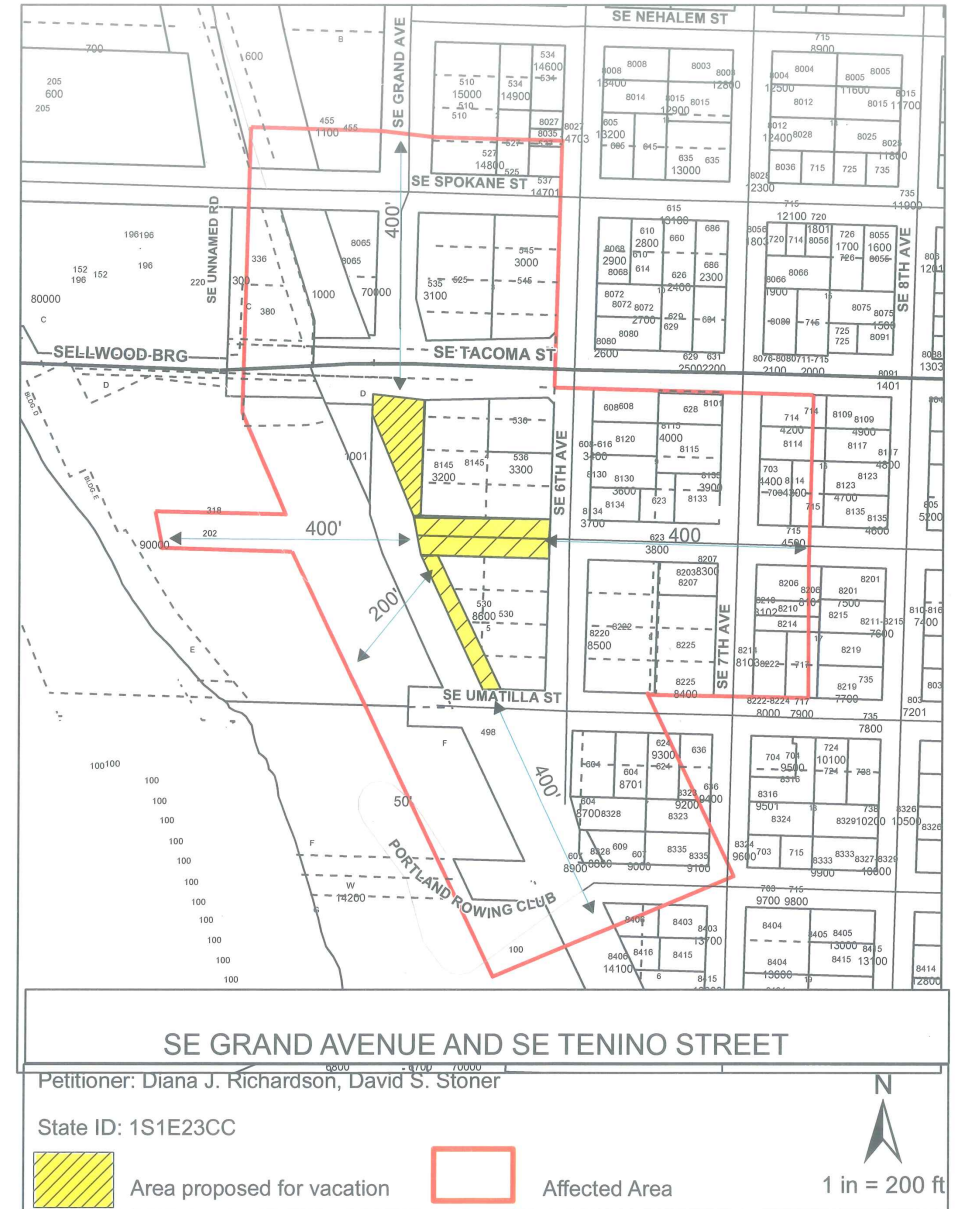

SE Grand Avenue

(aerial view)

Approximate
vacation area



SE Grand Avenue (from SE Tacoma)



SE Grand Ave.

SE Grand Avenue (from Springwater Corridor)



Approximate vacation area



SE 6th AV

TOM DWYER
ACCOUNTING SERVICE
230-2300

SE Tenino St.

SE Tenino Street (from SE 6th Ave.)

Approximate vacation area

South end of SE Grand Avenue
(from SE Umatilla)



Retaining Wall Easement: SE Grand Ave at SE Umatilla



Vacation Area

5 foot easement
for retaining wall



Sewer Lines

(BES to require easements)

Sewer lines in vacation area

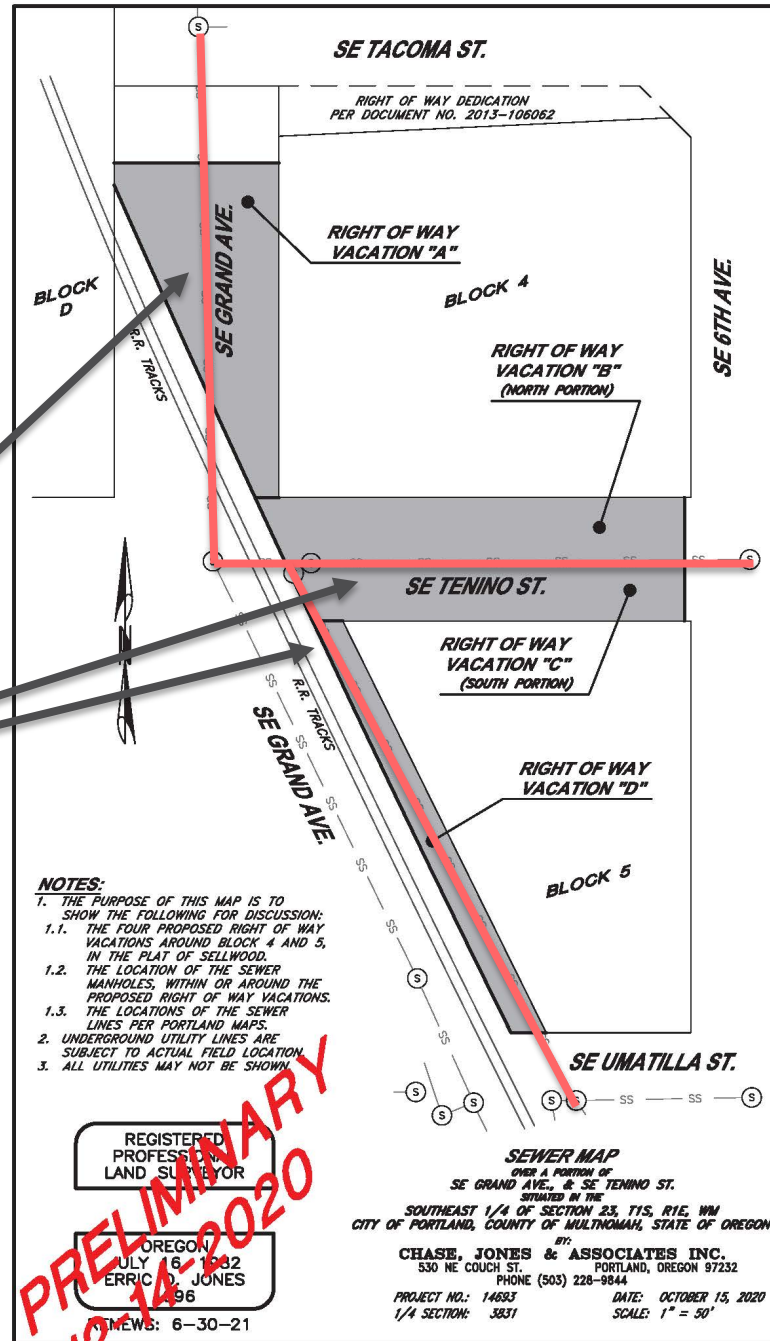

PRELIMINARY
12-14-2020

Thank you!



WE KEEP PORTLAND *MOVING.*



PBOT
PORTLAND BUREAU OF TRANSPORTATION