



City of Portland, Oregon - Bureau of Development Services

1900 SW Fourth Avenue • Portland, Oregon 97201 • 503-823-7300 • www.portlandoregon.gov/bds



Field Issuance Remodel (FIR) Permit Application

SITE ADDRESS: 5739 SW Downs View Ct JOB REFERENCE #: Brewer 36888

SCOPE OF WORK (Please be detailed. Include electrical, plumbing, and mechanical scope of work):
Voluntary Foundation Underpinning Using 5 Push Piers

ELECTRICAL N/A

MECHANICAL N/A

PLUMBING N/A

PROJECT VALUATION: \$ \$10,865.00

Check one of the following:

- ☐ Addition- building square footage is increased
- ☒ Alteration- exterior change not including an addition
- ☐ Demolition Only
- ☐ Interior Alteration Only
- ☐ New Construction

Check all that apply:

- ☐ Major Residential Alteration and Addition (MRAA)
- ☐ Greater than 3 toilets
- ☐ New water line to accessory structure
- ☐ Trees 12" diameter or greater at 4.5 ft onsite
- ☐ Cesspool/septic onsite

Minimum Submittal must include:

- Three (3) sets of plans
- Plans must be drawn to scale (min. 1 inch = 10 feet)
- Plan size minimum 11" x 17"
- Dimensions and notes must be printed to match 12 pt font minimum

Name of Company: TerraFirma FS Address: 13110 SW Wall St., Tigard, OR 97223

Name of Applicant (on site Project Manager) : Ellen Ronquillo

Office Phone: 971-205-5235 Mobile Phone: 503-718-4533 Email: permitting@terrafirmad

Property Owner's Email Address: N/A (owners will be emailed a copy of all check sheets)

Statement of Fact: *I certify that the facts and information set forth in this application are true and complete to the best of my knowledge. I understand that any falsification, misrepresentation or omission of fact (whether intentional or not) in this application or any other required document, as well as any misleading statement or omission, may be cause for revocation of permit and/of certificate of occupancy, regardless of how or when discovered.*

I acknowledge that work related to this Building Permit Application may be subject to regulations governing the handling, removal and/or disposal of asbestos and/or lead-based paint. ER (initials)

FAX this form to (503) 823-7425 or EMAIL this form to BDSFirPermits@portlandoregon.gov

(Continue to other side)

20-188312125



City of Portland, Oregon - Bureau of Development Services

1900 SW Fourth Avenue • Portland, Oregon 97201 • 503-823-7300 • www.portlandoregon.gov/bds



Electrical Fixtures		
Fixture	Quantity	Remarks
Residential Wire 1,000 SF or less		
Residential Wire: Each Additional 500 SF		
Residential Wire: Limited Energy		
Service & Feeder: 200 amps		
Service & Feeder: 201-400 amps		
Service & Feeder: 401-600 amps		
Service Reconnect Only		
Temp. Service & Feeder: 200 amps or less		
Temp. Service & Feeder: 201-400 amps		
Branch Circuit with Service & Feeder		
1 st Branch Circuit w/o Service or Feeder		
Each Additional Branch Circuit w/o Service or Feeder		
Pump or Irrigation Circle		
Limited Energy Panel/Signal Circuits		
Other Electrical Fixture		
Mechanical Fixtures		
Fixture	Quantity	Remarks
Alter Existing HVAC System		
Decorative Gas Fireplace		
Flue Vent for Water Heater/Gas Fireplace		
Woodstove/Pellet Stove		
Gas or Wood Fireplace/Insert		
Chimney/Liner/Flue/Vent		
Range Hood/Other Kitchen Equipment		
Clothes Dryer Exhaust		
Single Duct Exhaust (Bath/Toilet/Utility)		
Air Conditioner		
Gas Fuel Piping (# of outlets)		
Furnace/Burner (includes ductwork/vent/liner)		
Heat Pump		
Air Handling Unit		
Hydronic Hot Water System		
Other HVAC Appliances/Equipment		
Plumbing Fixtures		
Fixture	Quantity	Remarks
Fire Sprinkler (enter Sq ft in Quantity)		
Rain Drain # of Feet		
Sanitary Sewer # of Feet		
Storm Sewer # of Feet		
Water Service # of Feet		
# of Fixtures		
Backflow Preventer		
Replace in Building Water Lines (# of Floors)		
Rainwater Harvesting		
Sewer Cap		
Solar Unit (Potable Water)		
Stormwater Tank/Facility		
Other Plumbing Fixture		



City of Portland, Oregon - Bureau of Development Services

1900 SW Fourth Avenue • Portland, Oregon 97201 | 503-823-7300 | www.portlandoregon.gov/bds



STRUCTURAL CHECKSHEET

Application # : **20-188312-000-00-RS**

Review Date : **September 11, 2020**

Residential 1 & 2 Family Permit

To:	APPLICANT	EMILY SINGLETON TERRAFIRMA FOUNDATION SYSTEMS 7910 SW HUNZIKER ST TIGARD OR 97223	Work:	541 492-5827
			Cellular:	503 746-3204
			e-Mail:	ESingleton@terrafirmas.com
From:	Structural Engineer	David Tarries	Phone:	503-823-5172
			Email:	David.Tarries@portlandoregon.gov
cc:	OWNER	BREWER REV LIV TR 5739 SW DOWNS VIEW CT PORTLAND, OR 97221		

PROJECT INFORMATION

Street Address: 5739 SW DOWNS VIEW CT

Description of Work: *SINGLE PDF* VOLUNTARY FOUNDATION UNDERPINNING USING 5 PUSH PIERS

Based on the plans and specifications submitted, the following items appear to be missing or not in conformance with the Oregon Structural Specialty Code and / or other city, state, or federal requirements.

Item #	Location on plans	Code Section	Clarification / Correction Required
1.	S1	OSSC 107.2.1	It does not appear clear what minimum depth of the existing foundation is available to span between the piles on the drawings so they match the calc assumptions. Please add more information to the drawings to clarify this information for the contractor and inspector.

20-188312RS

STRUCTURAL CHECKSHEET

Application # 20-188312-000-00-RS

Review Date: September 11, 2020

INSTRUCTIONS

To respond to this checksheet, come to the Bureau of Development Services located at 1900 SW Fourth Ave. The Development Service Center (1st floor) and Permitting Services (2nd floor) are open Monday through Friday from 8:00 a.m. to 3:00 p.m. (close at noon on Thursday). Please update all sets of submitted drawings by either replacing the original sheets with new sheets, or editing the originally submitted sheets. You can review "How to Update Your Plans in Response to a Checksheet" at <http://www.portlandoregon.gov/bds/article/93028>. Visit the BDS website for more helpful information and a current listing of services available in the Development Services Center.

Please complete the attached Checksheet Response Form and include it with your re-submittal.

If you have specific questions concerning this Checksheet, please call me at the phone number listed above. To check the status of your project, go to <https://www.portlandmaps.com/advanced/index.cfm?action=permits>. Or, you may request the status to be faxed to you by calling 503-823-7000 and selecting option 4.

You may receive separate Checksheets from other City agencies that will require separate responses.

NEW RECHECK FEE: Please note that for plans submitted on or after July 1, 2010 plan review fees for Life Safety, Structural, Site Development and Planning and Zoning will cover the initial review and up to two checksheets and the reviews of the applicant's responses to those checksheets. All additional checksheets and reviews of applicant responses will be charged \$184.00 per checksheet.

PROJECT ADDRESS:
5739 SW DOWNS VIEW CT
PORTLAND, OREGON

PROJECT DESCRIPTION:
PUSH PIERS/HELICAL ANCHORS ARE TO BE VOLUNTARILY
INSTALLED TO PREVENT FURTHER SUBSIDENCE OF THE EXISTING
BLDG. TIE-BACKS ARE NOT REQUIRED.

LAND USE NOTE:
PILE INSTALLATIONS ARE SUBGRADE & DO NOT AFFECT THE
EXTERIOR APPEARANCE OF THE STRUCTURE.

DESIGN CRITERIA:
CODES:
2018 INTERNATIONAL BUILDING CODE
2019 OREGON STRUCTURAL SPECIALTY CODE
ASCE 7-10

DESIGN LOADS:
ROOF DEAD LOAD: 15 PSF
ROOF SNOW LOAD: 25 PSF
FLOOR DEAD LOAD: 15 PSF
FLOOR LIVE LOAD: 40 PSF
WIND LOAD: NOT APPLICABLE

SOILS:
ALLOWABLE SOIL BEARING: 1500 PSF
ALLOWABLE SOIL PASSIVE: 100 PSF/FT

GENERAL:
ALL DETAIL CUTS SHALL BE CONSIDERED TYPICAL AT LIKE
CONDITIONS. WHERE ANY DISCREPANCIES OCCUR BETWEEN PLANS,
DETAILS, NOTES AND SPECIFICATIONS, THE GREATER REQUIREMENT
SHALL GOVERN.

ESTABLISH AND VERIFY ALL GEOMETRY FOR ARCHITECTURAL,
MECHANICAL, ELECTRICAL, AND PLUMBING CONCERNS PRIOR
TO CONSTRUCTION.

THE CONTRACTOR SHALL BE RESPONSIBLE FOR THE
STRUCTURAL STABILITY OF ALL NEW AND EXISTING STRUCTURES
DURING CONSTRUCTION. THIS INCLUDES EXCAVATIONS, COLUMNS,
EQUIPMENT LOADS, MATERIAL LOADS, AND OTHERS. OBSERVATIONS
BY THE ENGINEER- OF-RECORD DO NOT INCLUDE INSPECTIONS OF
TEMPORARY LOADING AND STABILITY DURING CONSTRUCTION.

HELICAL AND DRIVEN PILES:
ALL PILES, HELICAL BLADES, FOUNDATION BRACKETS,
HARDWARE, ETC., SHALL BE MANUFACTURED BY SUPPORTWORKS,
INC., AND DOCUMENTED IN UES EVALUATION REPORT 289. DRIVEN
& HELICAL PILES ARE TO BE INSTALLED BY
SUPPORTWORKS-CERTIFIED INSTALLERS.

CONCRETE ANCHORS:
CONCRETE ANCHORS (IF REQ'D) SHALL BE SIMPSON OR EQUAL
(SPECIAL INSPECTION REQUIRED)

SPECIAL INSPECTIONS:
SPECIAL INSPECTIONS OF PILE INSTALLATIONS SHALL BE
CONTINUOUS & PERFORMED ACCORDING TO UES ER 289, SECTION
3.4. INSPECTION SCHEDULE SHALL CONSIST OF VERIFYING AND
DOCUMENTING PILE AND BRACKET NUMBERS ON SITE, FOLLOWED BY
OBSERVATION OF THE FIRST INSTALLATION'S LOCATION, EMBEDMENT
DEPTH, AND FINAL INSTALLATION TORQUE VALUE, CORRELATED TO
THE REQUIRED DESIGN LOAD. ON-SITE LOG BOOK FOR REMAINING
INSTALLATIONS WILL BE VERIFIED. A FINAL INSPECTION OF THE
INSTALLED REMAINING PILES AND LOG BOOK DATA WILL BE
DOCUMENTED IN A BRIEF LETTER SUBMITTED TO THE BUILDING
AUTHORITY.

LOAD TESTING:
1. HELICAL ANCHORS/PUSH PIERS
PROOF TESTING SHALL CONSIST OF LOADING AT LEAST ONE
OF THE PIERS IN (6) EQUAL INCREMENTS TO 150% OF THE DESIGN
LOAD. EACH LOAD INCREMENT SHALL BE HELD FOR FIVE (5)
MINUTES AND THE VERTICAL STRAIN MONITORED. IF THE TOTAL
STRAIN IS LESS THAN 0.04", THE ANCHOR MAY BE DEEMED
ACCEPTABLE. HOWEVER, IF THE STRAIN EXCEEDS 0.04", THE
ANCHOR SHOULD BE DEEPENED AND RETESTED OR ABANDONED AND
A NEW PILE INSTALLED AND TESTED.

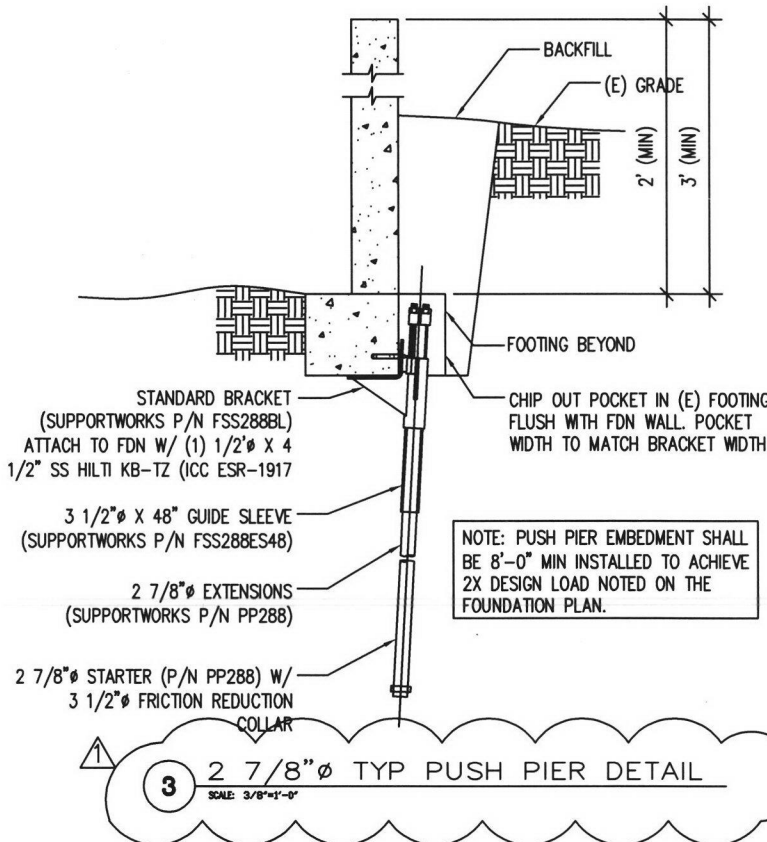
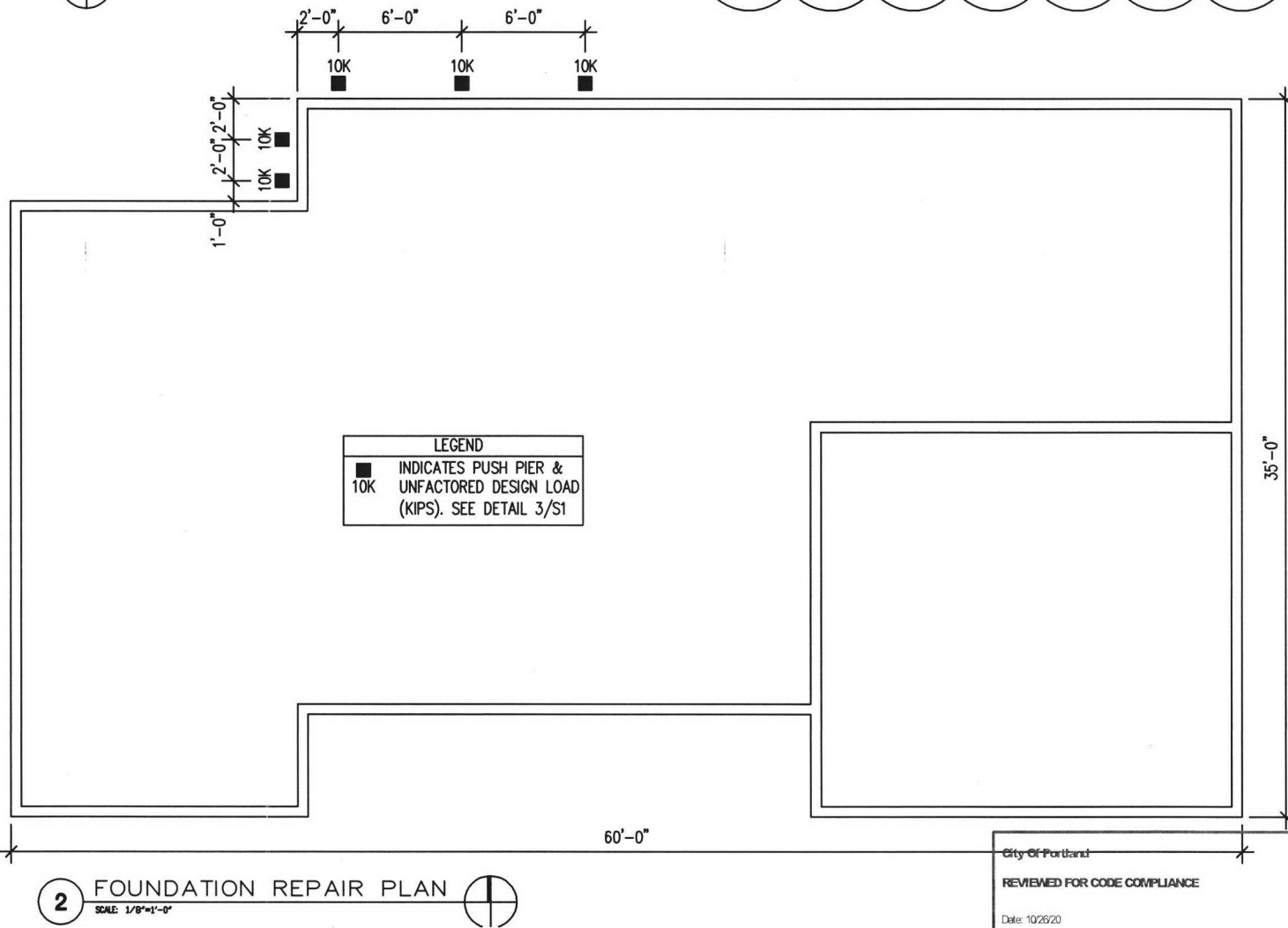
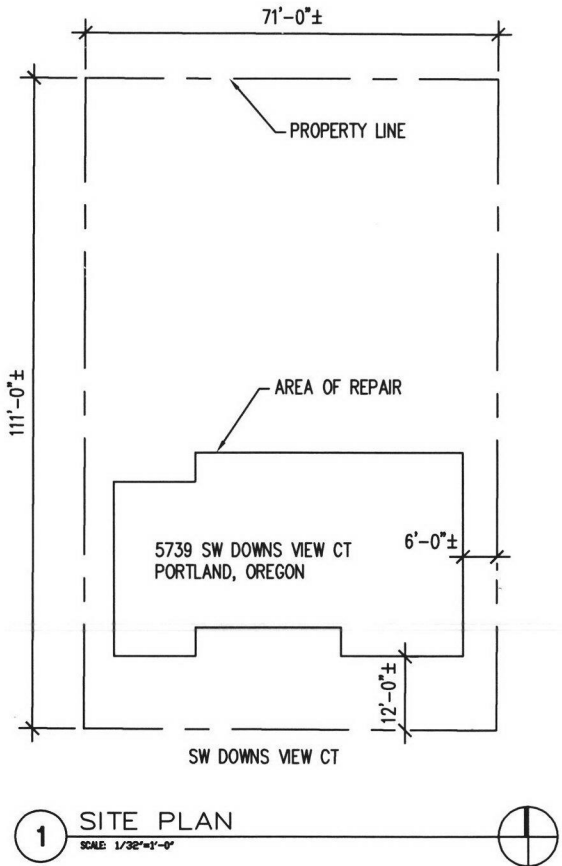

STAMP:
REGISTERED PROFESSIONAL
ENGINEER
74940PE
OREGON
JULY 13, 2004
MATTHEW DANIEL WAYNE STARK
EXPIRES: 06/30/22

STARK
FOUNDATIONS
4400 NE 77TH AVENUE
SUITE 275
VANCOUVER, WA 98662
P: 360.566.7343

CLIENT:
TERRAFIRMA
FOUNDATION SYSTEMS
13110 SW WALL STREET
PORTLAND, OR 97223
P: 866.486.7196

PROJECT:
BREWER RESIDENCE
FOUNDATION REPAIR
5739 SW DOWNS VIEW CT
PORTLAND, OREGON

REVISIONS:
PLAN CHECK 09.16.20

DRAWING TITLE:
FOUNDATION
REPAIR PLAN

SCALE:
SEE PLAN

DATE:
08/31/20

SHEET NO:
S1

City of Portland
REVIEWED FOR CODE COMPLIANCE
Date: 10/26/20
Permit #: 20-188312-000-PS

20-188312125