

ORDINANCE NO. **148981**

An Ordinance establishing C2S zoning in the recently annexed Tax Lot 42, Section 30, T1S, R1E, located at 10727 S.W. Pacific Highway near S.W. Dickinson, and declaring an emergency.

The City of Portland ordains:

Section 1. The Council finds:

1. Tax Lot 42, Section 30, T1S, R1E, located at 10727 S.W. Pacific Highway near S.W. Dickinson, has been annexed to the City.
2. In accordance with Title 33, Planning and Zoning, of the Code of the City of Portland, said area retains the zoning regulations of the former jurisdiction, Multnomah County, until City zoning is established.
3. The City's Hearings Officer by report and recommendation dated December 11, 1979 (Planning Commission File No. 6905), after and as a result of a duly authorized and conducted public hearing held on December 10, 1979, has recommended adoption of C2S zoning in said annexed area.
4. The City Auditor has complied with the notice requirements of the ordinance for the hearing before the Hearings Officer.
5. The City Council after due deliberation in open session adopted the report of the Hearings Officer.
6. The Zoning Code requires the initiation of City zoning on annexed property within six months of the annexation in order that all appropriate and pertinent City codes should become applicable to such property.
7. City policy is to establish City zoning that is equivalent to existing County zoning whenever possible, in accordance with existing land uses and the adjacent City zoning pattern.
8. There is a public need to affix this City zoning designation to the property in order to conform to the Code of the City of Portland and assure that appropriate and pertinent planning, zoning and building regulations of the City shall apply. The zoning designation is in accordance with generally accepted land use planning standards.

NOW, THEREFORE, the Council directs:

- a. The recently annexed Tax Lot 42, Section 30, T1S, R1E, located at 10727 S.W. Pacific Highway near S.W. Dickinson, hereby is zoned C2S, as set forth on the map attached hereto and incorporated herein by this reference and thereby made a part of this ordinance.

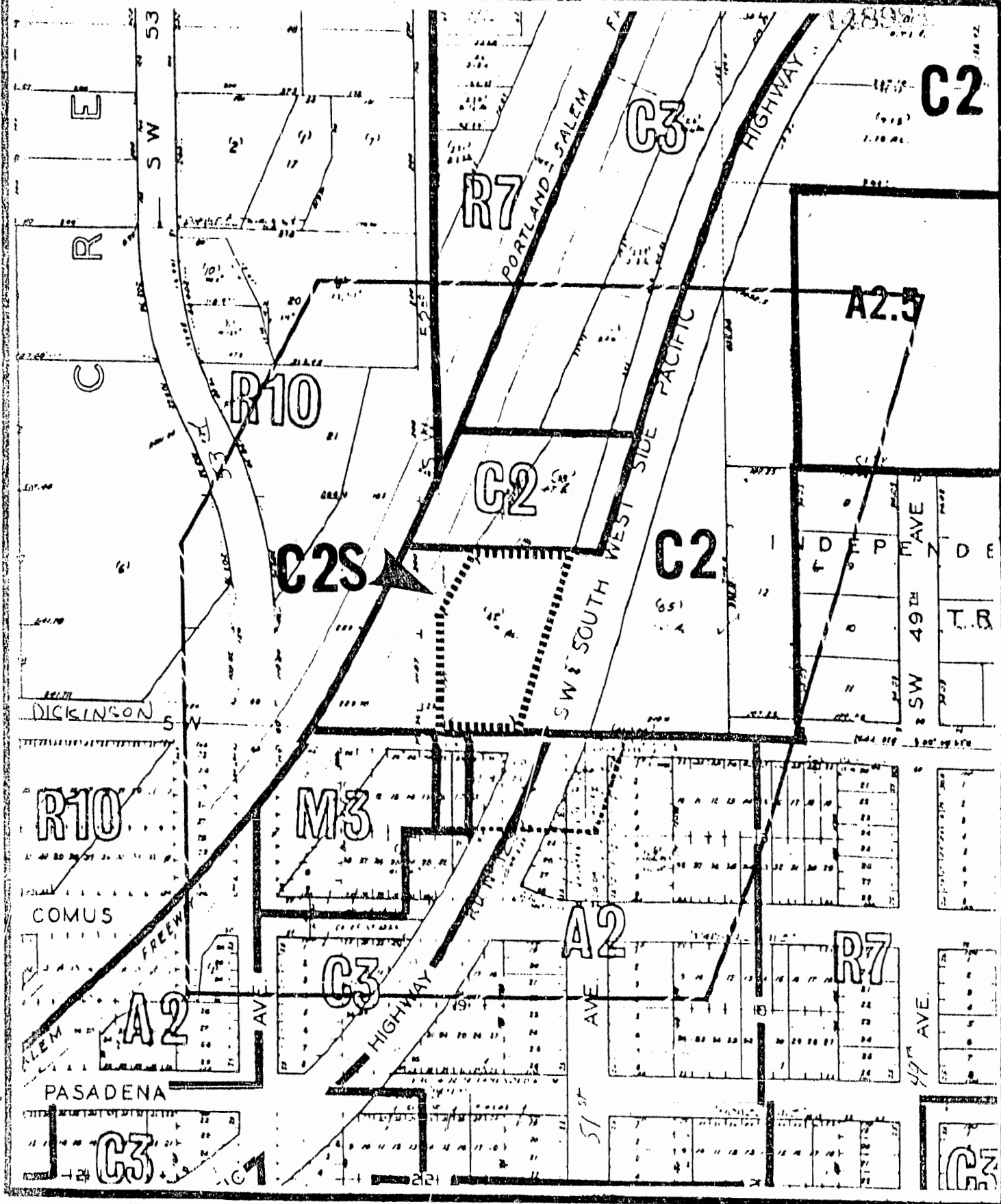

Zoning
proposed



File No.	6905
1/4 Section	4024
Scale	1" = 200'
Request	
Exhibit	

ORDINANCE No.

- b. The City Auditor shall file a certified copy of this ordinance in the appropriate record file of the County in which said annexed property is located. The City Auditor shall enter the property zoned as set forth in Section 1 hereof, in the zoning maps of the City. Establishment of said zone classification is for the benefit of the public and the requirement of acceptance of this ordinance by the property owners is hereby waived.

Section 2. The Council declares that an emergency exists because there should be no delay in the establishment of zone for the annexed area; therefore, this ordinance shall be in force and effect from and after its passage by the Council.

Passed by the Council, **JAN 2 1980**

Mayor McCreedy
December 11, 1979
P.Norr/ja

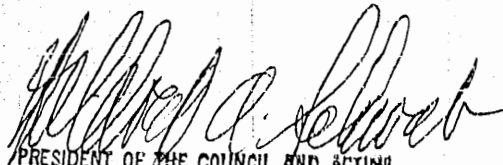
PRESIDENT OF THE COUNCIL AND ACTING
Mayor of the City of Portland

Attest:

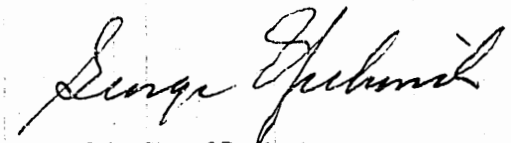
Auditor of the City of Portland

Calendar No. 21

ORDINANCE No. 148981

Title

An Ordinance establishing C2S zoning in the recently annexed Tax Lot 42, Section 30, T1S, R1E, located at 10727 S.W. Pacific Highway near S.W. Dickinson, and declaring an emergency.

THE COMMISSIONERS VOTED AS FOLLOWS:		
	Yeas	Nays
Ivancie	1	
Jordan	1	
Lindberg	1	
Schwab	1	
McCready		

FOUR-FIFTHS CALENDAR	
Ivancie	
Jordan	
Lindberg	
Schwab	
McCready	

INTRODUCED BY

MAYOR MCCREADY

NOTED BY THE COMMISSIONER

Affairs

Finance and
Administration

Safety

Utilities

Works

BUREAU APPROVAL

Bureau:

Hearings Office

Prepared By:

Date:

P. Norr/ja

12/11/79

Budget Impact Review:

☐

Completed

☒

Not required

Bureau Head:

NOTED BY

City Attorney

City Auditor

City Engineer

Filed DEC 14 1979

GEORGE YERKOVICH
Auditor of the CITY OF PORTLAND

By

Deputy