

West Portland Town Center Plan

Planning and Sustainability Commission
June 9, 2020



ROUTE AND STATION LOCATIONS

PREFERRED ALTERNATIVE UPDATED MARCH 2019

Conceptual rendering subject to change

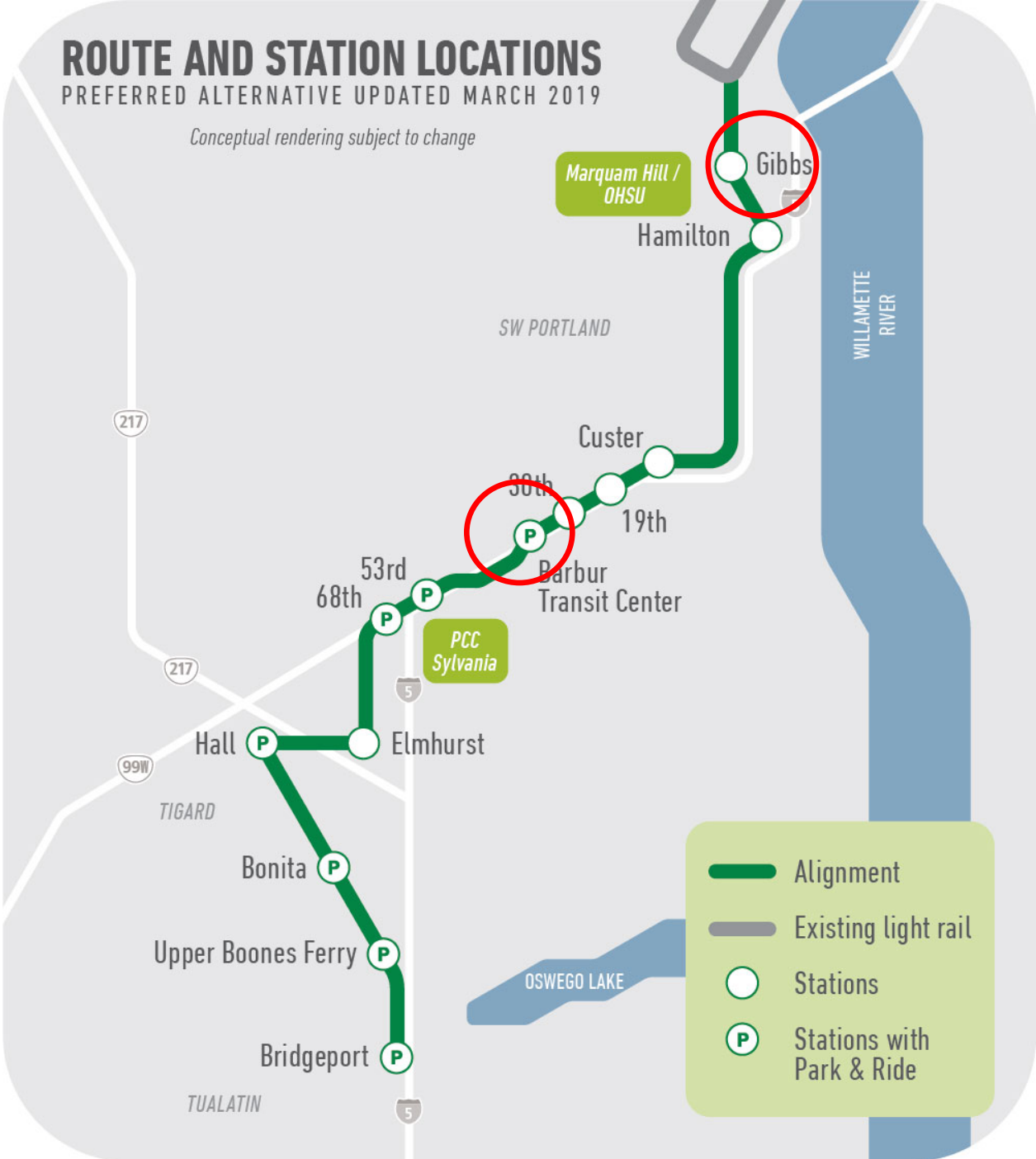

Inclusive Communities Project:

Naito Main Street Project and Ross Island Bridgehead

West Portland Town Center Plan

Key Light Rail Dates

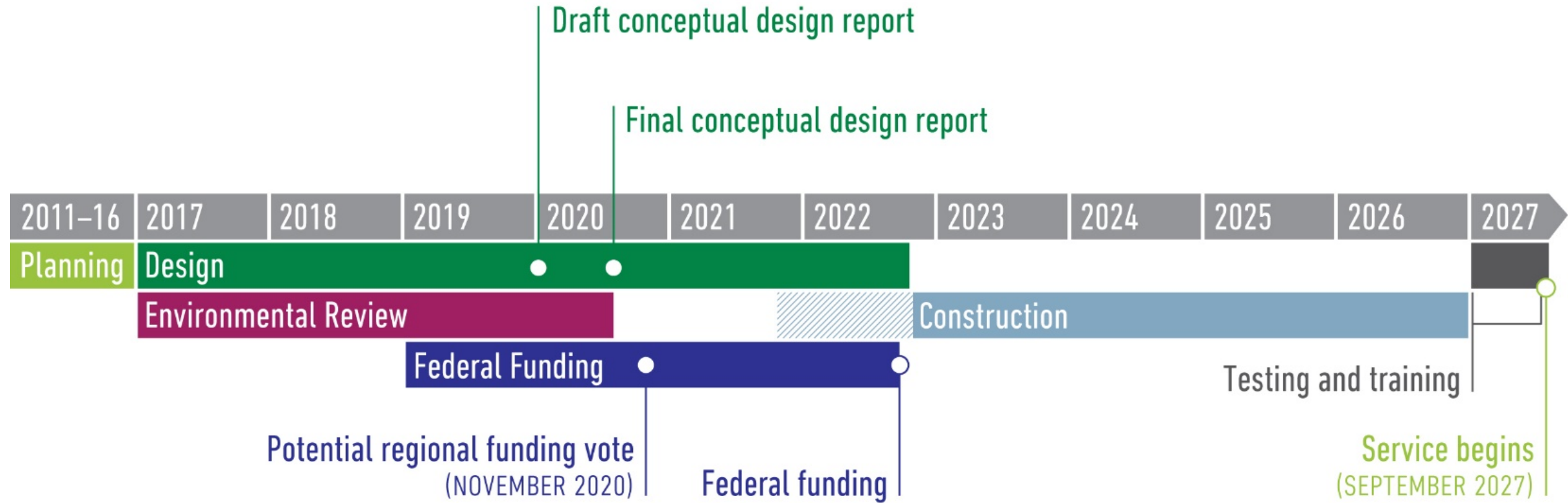

“To plan for a Southwest Corridor that provides complete and inclusive communities for all, we need to also listen to the voices of our neighbors most impacted by today’s racial and economic disparities.”

— Mayor Ted Wheeler

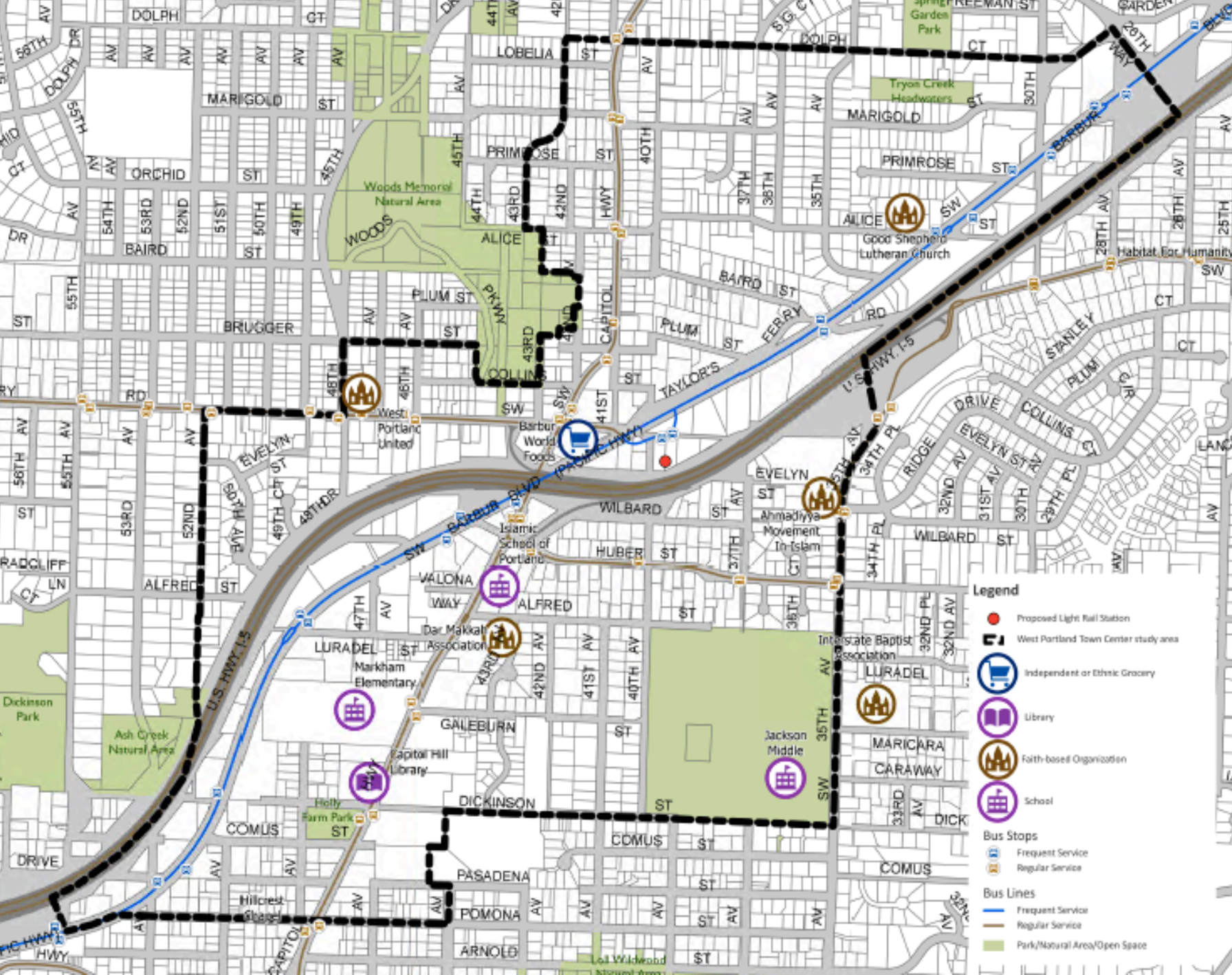

West Portland Town Center Plan

West Portland Park:
Most racially diverse part of SW:

- 28% POC
- 17% foreign born
- 9% from Africa

Health inequity

1. Five years less life expectancy
2. Residents are experiencing declining trends in income, education rates and increasing poverty rates
3. Households of color are more likely to rent and spend more than 50% of their household income on housing costs
4. Residents have lower rates of health insurance

West Portland Park Census Tract

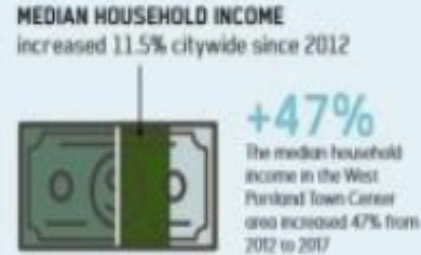
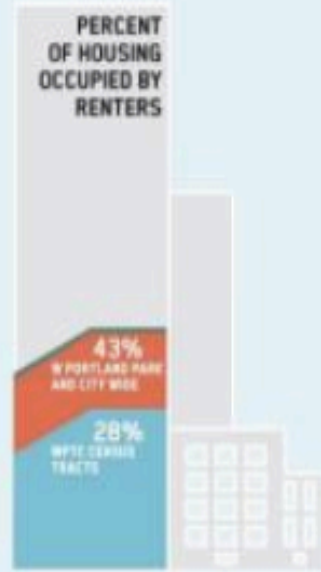

CULTURAL DIVERSITY
currently 26% People of Color (POC) citywide

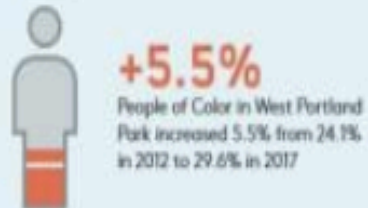
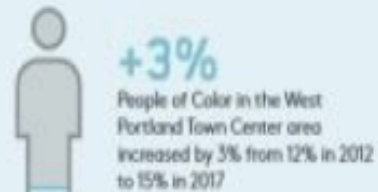

PERCENT LIVING IN POVERTY
decreased 0.8% citywide since 2012

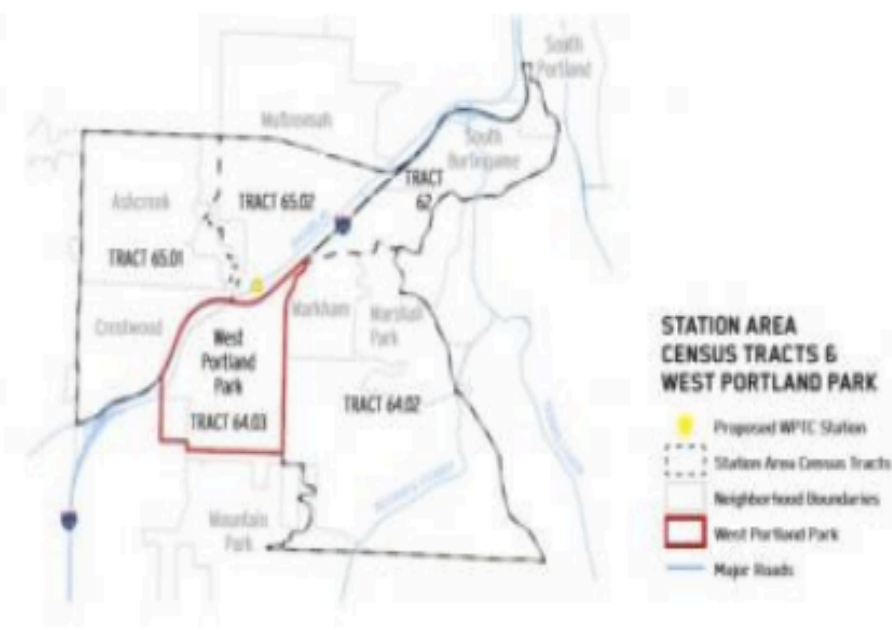

UNINSURED POPULATION
accounted for 8.7% of Portland residents in 2017

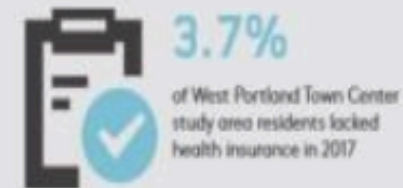

LIFETIME CANCER RISK FROM INHALATION OF AIR TOXICS
Portland citywide is in the 85th Percentile (Greater than in 85% of US population, representing an absolute lifetime risk level of 52 cancer deaths per million.)

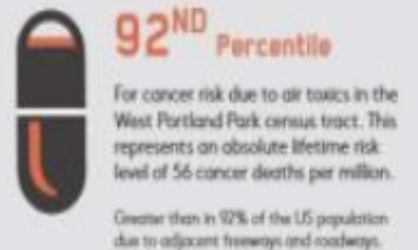
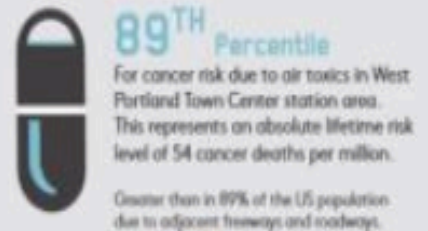

Community led engagement



We do focus groups, community meetings, leadership development and advocacy



Themes we've heard so far...

1. Pride in cultural diversity and love of cultural amenities (ex. mosque)
2. Fear of displacement, more affordable housing and cultural gathering places needed
3. Desire for more healthy food options and business opportunities (ex. Halal shop)
4. Area is divided by I-5, fear when walking
5. Community wants to stay engaged in planning



Humanitarian Assistance with
Kindness & Interculturalism



Community-based priorities - actions

- **Multi-cultural community center**
- **Culturally specific businesses.** Support for existing (ex. halal shop) and multi-cultural marketplace for new businesses
- **New affordable housing for refugees and asylees**
- **Walkability and transit access.** More foot bridges. Bus stops not so close to street. Ped signal at Alfred.
- **Transit.** More bus lines, greater frequency, free/reduced fare, and less policing
- **Ownership.** Support renters owning their buildings
- **Healthy homes.** Renovations without displacement
- **Rent stability.** Rent freeze for period of time



Multi-cultural Hub

- Maintain Cultural identity.
- Art of cultural pictures/drawings
- Small business and market owned by minorities.
- Preservation & building of new affordable housing.



Barbur Transit Center Development Concept informed by community

- Affordable housing
- Community event and meeting space
- Multi-cultural market place
- Office space for community services
- Outdoor gathering space

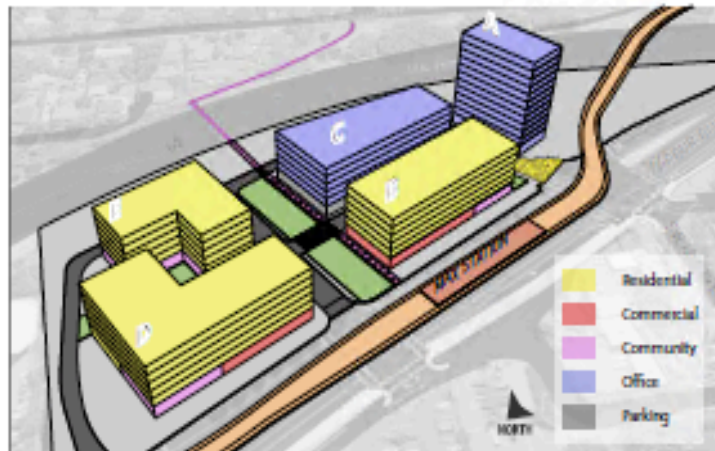
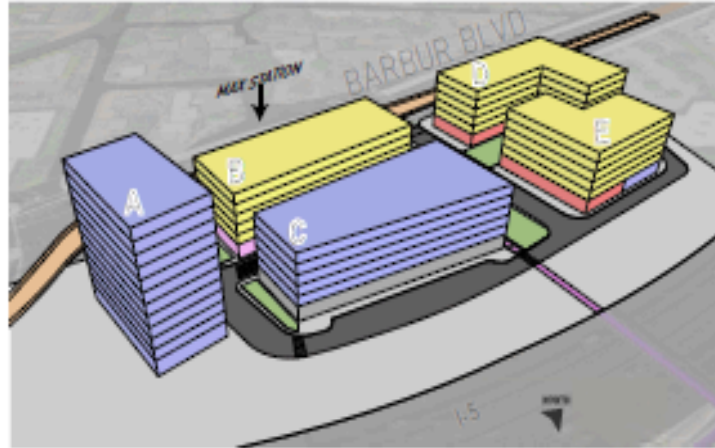



Implementation tools:

1. SW Equitable Development Strategy
2. SW Equitable Housing Strategy
3. Tax Increment Financing
4. Plan District regulations
5. Parks capital plan

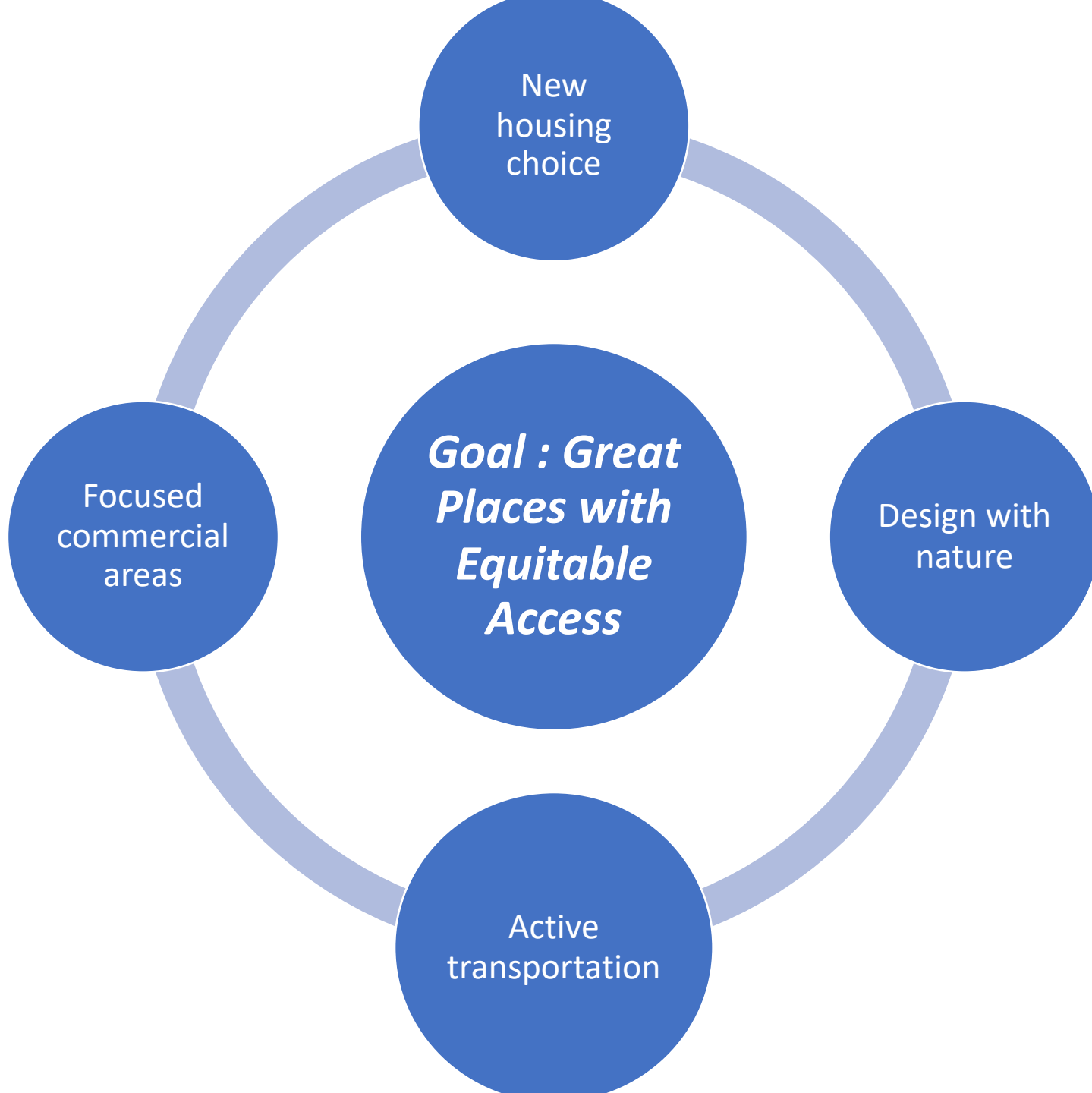

Implementation tools:

1. Zoning map
2. Plan District regulations
3. Transportation Systems Plan
4. Citywide Systems Plan

Growth concept

Features:

- Shared growth
- Employment zones
- N and S commercial areas
- Multicultural hub
- Affordable apartment preservation
- Green ring

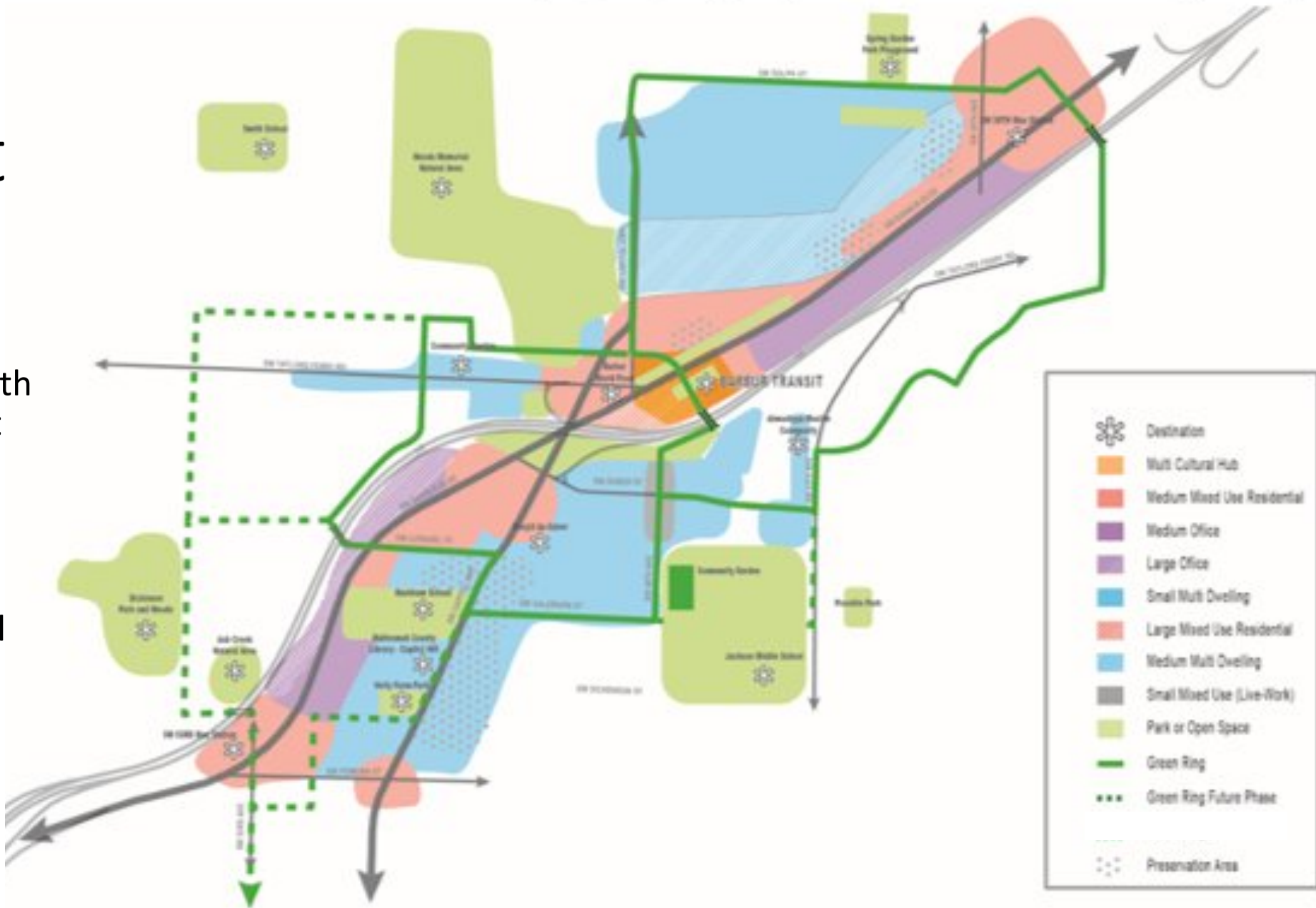

Transportation concept

Features:

- Corridor investments
- Green scapes
- New main street on Collins
- Local streets
- I-5 pedestrian crossings



Discussion



A New Approach for Equitable Outcomes

