



OREGON STATE HIGHWAY DIVISION

HIGHWAY BUILDING • SALEM, OREGON • 97310

Portland City Council
City Hall
Portland, Oregon 97204

TOM McCALL
GOVERNOR

F. B. KLABOE
Administrator of Highways

Attn: Mr. Lloyd Anderson
Commissioner of Public Works

Re: Maintenance Stipulations
Steel Bridge-Sheridan Street
Section (Front Avenue)
Pacific Highway West, No. 1W

Gentlemen:

The Oregon State Highway Commission and the City of Portland entered into an agreement, authorized by Ordinance No. 135362 and approved by the State on October 31, 1972, whereby the State and City agreed to the closure of Harbor Drive and rerouting of Pacific Highway West along Front Avenue.

It has been determined to be in the best interest of all concerned that State and City should now enter into an agreement for the purpose of clarifying maintenance responsibilities to be in effect at such time as highway traffic is actually routed along Front Avenue.

Attached hereto, marked Exhibit A, and by this reference made a part hereof, is a portion of the plans for the project showing State and City areas of responsibility colored in green and orange, respectively.

In recognition of the mutual benefits that will accrue to the residents of the State of Oregon and the City of Portland, the State and City hereby pledge complete cooperation, each with the other, to the end that a safe and expeditious flow of traffic will be encouraged through efficient maintenance operations.

Maintenance responsibilities shall be divided as follows:

STATE OBLIGATIONS:

1. State shall maintain the surfacing of that portion of Front Avenue which is designated as the route of Pacific Highway

Portland City Council

-2-

West from face of curb to face of curb, approximately as shown colored in green on the attached Exhibit A.

2. State shall furnish, erect and maintain all directional signing required for the convenient routing of highway traffic, and shall paint striping to delineate traffic lanes, medians and left-turn refuges.

3. State shall perform sanding operations at such times as weather conditions warrant, and shall remove snow from the traveled way to a berm in the center area of the street.

4. State shall, upon completion of the project, transfer all State's right, title and interest, if any there be, in S.W. Harbor Way to City with all jurisdiction, maintenance and control passing to City to be performed at City's sole expense. A portion of said S.W. Harbor Way is shown colored in orange on the attached Exhibit A.

CITY OBLIGATIONS:

1. City shall retain the exclusive right to grant franchises over, beneath and upon the street and may grant the privilege to open the surface, but all damage occasioned thereby shall promptly be repaired by City.

2. City shall retain the responsibility for cleaning the street by use of flusher trucks and sweepers, and shall maintain the storm sewer system along the street.

3. City shall continue to maintain and pay the cost of electrical energy consumed by illumination units installed as a part of the project.

4. City shall remove the snow berm following plowing by State.

5. City shall have full jurisdiction and control of those portions of the rights-of-way, including sidewalks, which are located outside the curb line. Any repair or maintenance, after completion of the project, of said sidewalks shall be the responsibility of either City or the abutting property owners, as may be provided by City Charter or ordinance.

EXHIBIT 1

Portland City Council

-3-

6. City shall accept all State's right, title, interest, jurisdiction, maintenance, and control of S.W. Harbor Way as referred to in paragraph 4 under State Obligations, and shall continue to exercise all jurisdiction and control of those city streets shown colored in orange on the attached Exhibit A.

IN WITNESS WHEREOF, the parties hereto have set their hands and affixed their seals as of the day and year hereinafter written. City's Mayor and Commissioner of Public Works have acted in this matter pursuant to Ordinance No. _____ passed by its City Council on the _____ day of _____, 1973.

This agreement was approved by the Oregon Transportation Commission on _____, 1973, at which time the Administrator and State Highway Engineer was authorized and directed to sign said agreement for and on behalf of the Commission. Said authority is set forth in Volume _____, Minute Book of the Oregon Transportation Commission.

APPROVED:

Assistant State Highway Engineer

Administrator & State Highway Engineer

APPROVED:

CITY OF PORTLAND, by and through its
City Officials

City Engineer

By _____
Mayor

APPROVED AS TO FORM:

By _____
Commissioner of Public Works

City Attorney

MCH:ljt
9/4/73

EXHIBIT 1

137533

Approx. 1 Mile East of River, Shown Thus
 Remove 22' Easement & Shown Thus
 Const. AC Pavement

SEC. 34, T. 12 N., R. 12 W.
 PORTLAND

SHEET NO.		3	
PROJECT NO.		137533	
DATE		1965	
DRAWN BY		J. L. ...	
CHECKED BY		...	
APPROVED BY		...	
ORIGIN	STATE		

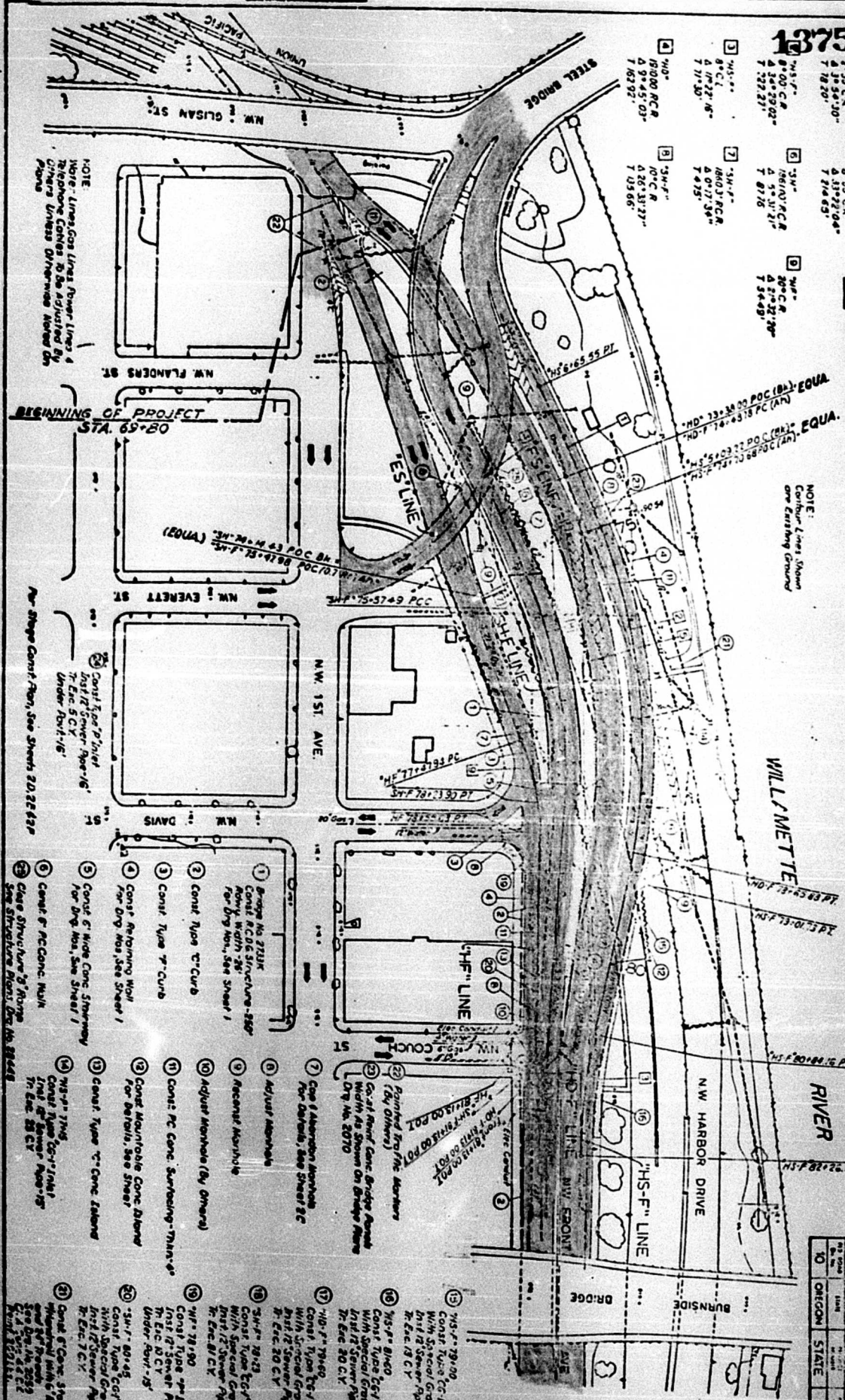

EXHIBIT 1

SEC. 34 IN RILE, W.M.
PORTLAND

- ① Const. Type "C" Curb
- ② Const. Type "C" Conc. Island
- ③ Remove Existing Island
- ④ Const. Gravel Conc. Walk (See Details, See Sheet 20)

WILLAMETTE RIVER

NOTE:
Contours Lines Shown
are Existing Ground

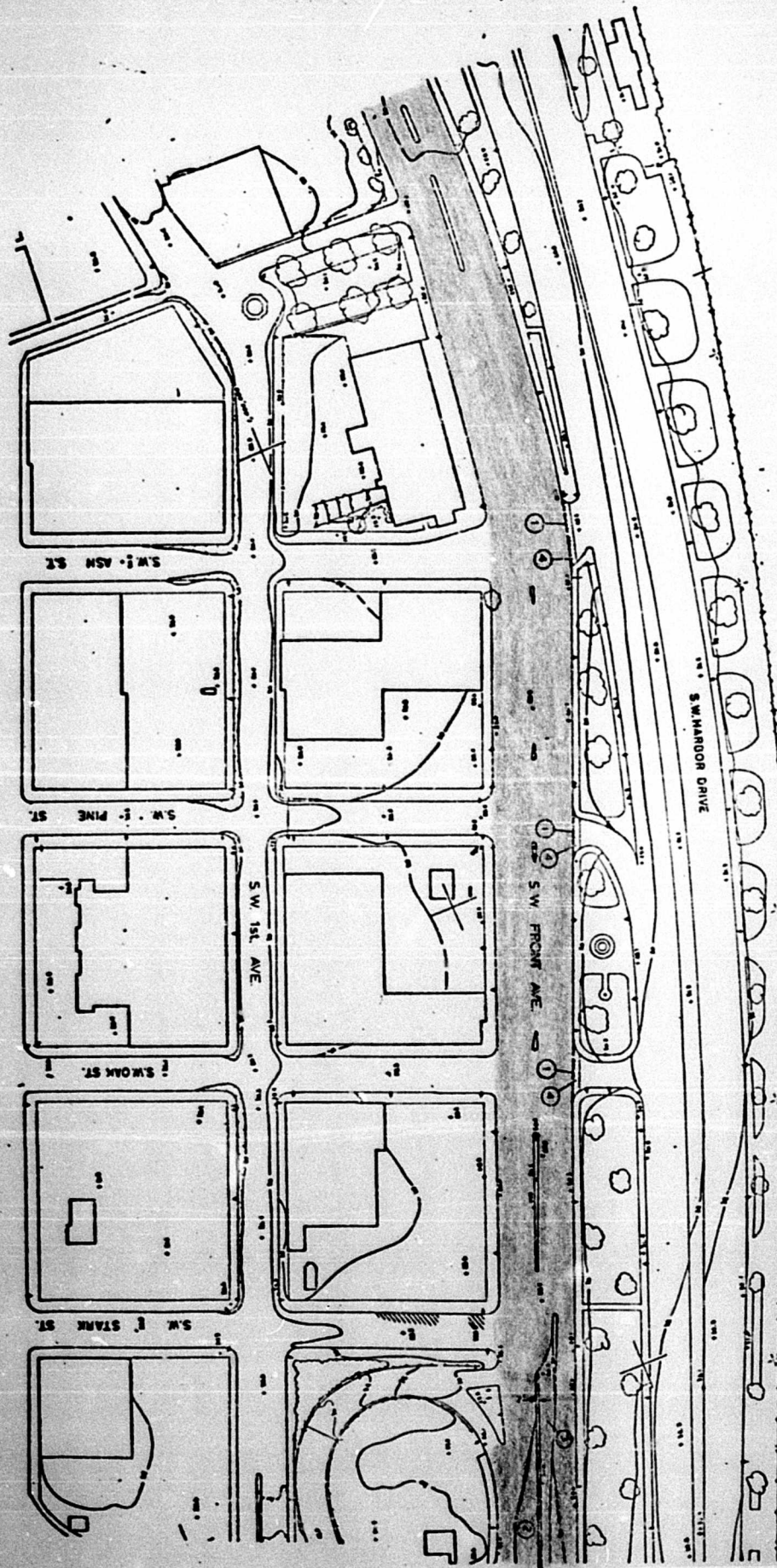

SHEET NO. 1 OF 2			
PACIFIC HIGHWAY WEST			
PORTLAND, OREGON			
10	0000	STATE	2

EXHIBIT 1

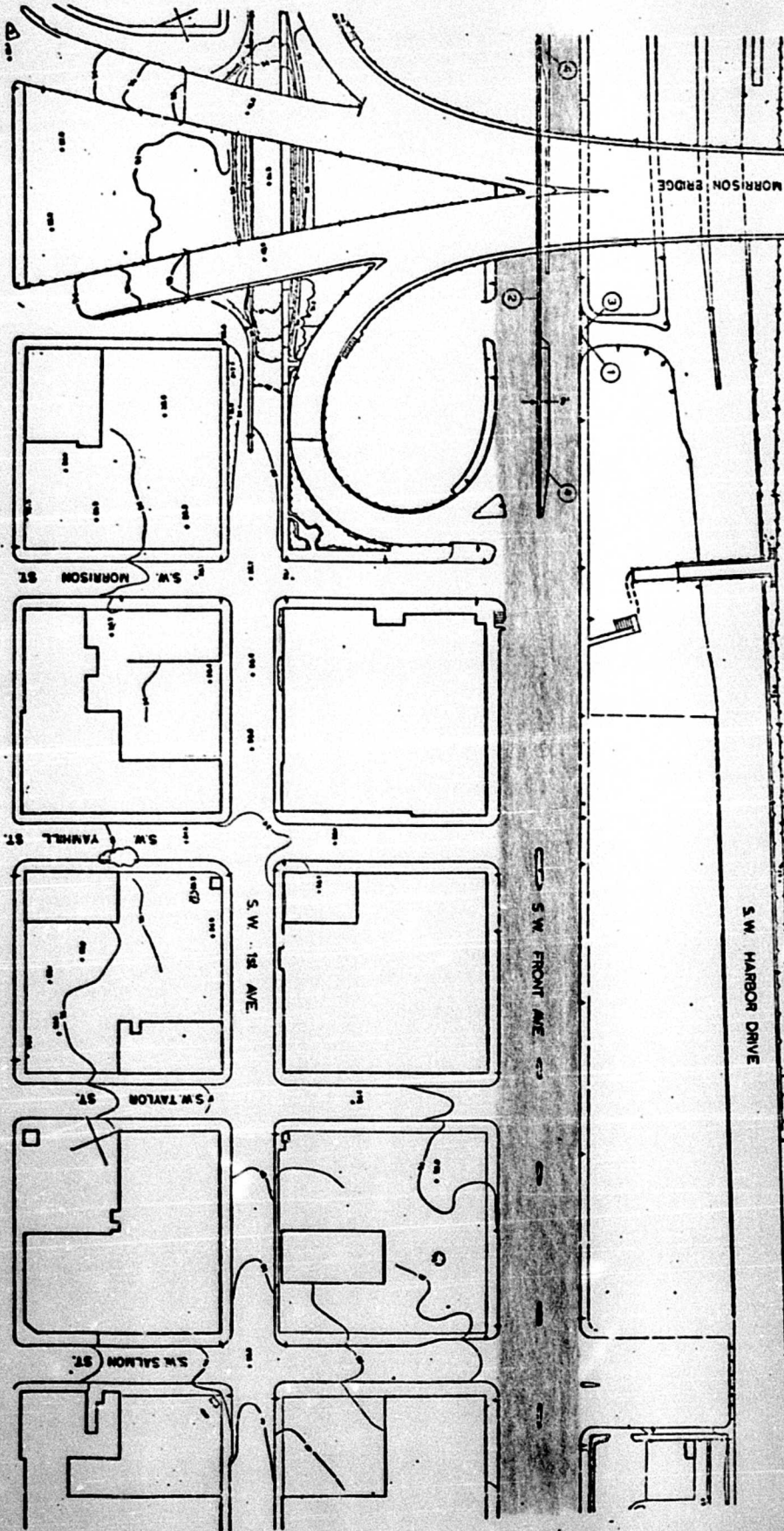

- ① Canal Type "x" Curb
- ② Const. Type "C" Conc. Island
- ③ Const. & Asphalt Conc. Walk (See Details, See Sheet 2B)
- ④ Remove Entry Island

WILLAMETTE

RIVER

S.W. HARBOR DRIVE

S.W. FRONT AVE

S.W. 1st AVE

MORRISON ST

S.W. VAN NESS ST

S.W. TAYLOR ST

S.W. SALMON ST

NOTE:
Confluence of Stream
are Existing Ground

SHEET NO. 1		DATE: 10/1/56	
PROJECT: 100-100000-1000		SCALE: 1" = 100'	
DRAWN BY: J. H. HARRIS		CHECKED BY: J. H. HARRIS	
10		OCEAN STATE	

EXHIBIT 1

WILLAMETTE RIVER

NOTE:
Contour Lines Shown
are Existing Ground

10	OREGON	STATE	10	OREGON	STATE	10	OREGON	STATE
----	--------	-------	----	--------	-------	----	--------	-------

- 11 1324
- ① Const Type "C" Curb
② Const PC Conc Walk
③ Adjust Manhole
④ Adjust Manhole (By Others)
⑤ Remove Manhole
⑥ Reconst Manhole
⑦ Reconst Manhole (By Others)
⑧ Const Conc Slope Protector
Dry Ho 2050
⑨ Adjust Inlet
⑩ Const Type "C" Conc Island
- ⑫ 2'-5N'-44+50
Const 2 Type "C" Inlets
With Special Grade
Inst 12" Sewer Pipe--140'
Tr Exc 50 CY
Under Pave--50'
- ⑬ 2'-5N'-43+00
Const 2 Type "C" Inlet
With Special Grade
Inst 12" Sewer Pipe--60'
Tr Exc 22 CY
Under Pave--50'
- ⑭ 2'-5N'-42+00
Const "C" Inlet
With Special Grade
Inst 12" Sewer Pipe--40'
Tr Exc 14 CY
Under Pave--40'
- ⑮ 2'-20+50
Const 1 Type "C" Inlet
With Special Grade
Inst 12" Sewer Pipe--40'
Tr Exc 20 CY
Under Pave--20'
- ⑯ 2'-20+50
Const 1 Type "C" Inlet
With Special Grade
Inst 12" Sewer Pipe--20'
Tr Exc 10 CY
Under Pave--20'
- ⑰ 2'-20+50
Const 1 Type "C" Inlet
With Special Grade
Inst 12" Sewer Pipe--20'
Tr Exc 10 CY
Under Pave--20'
- ⑱ Const Type "C" Curb
- HAWTH

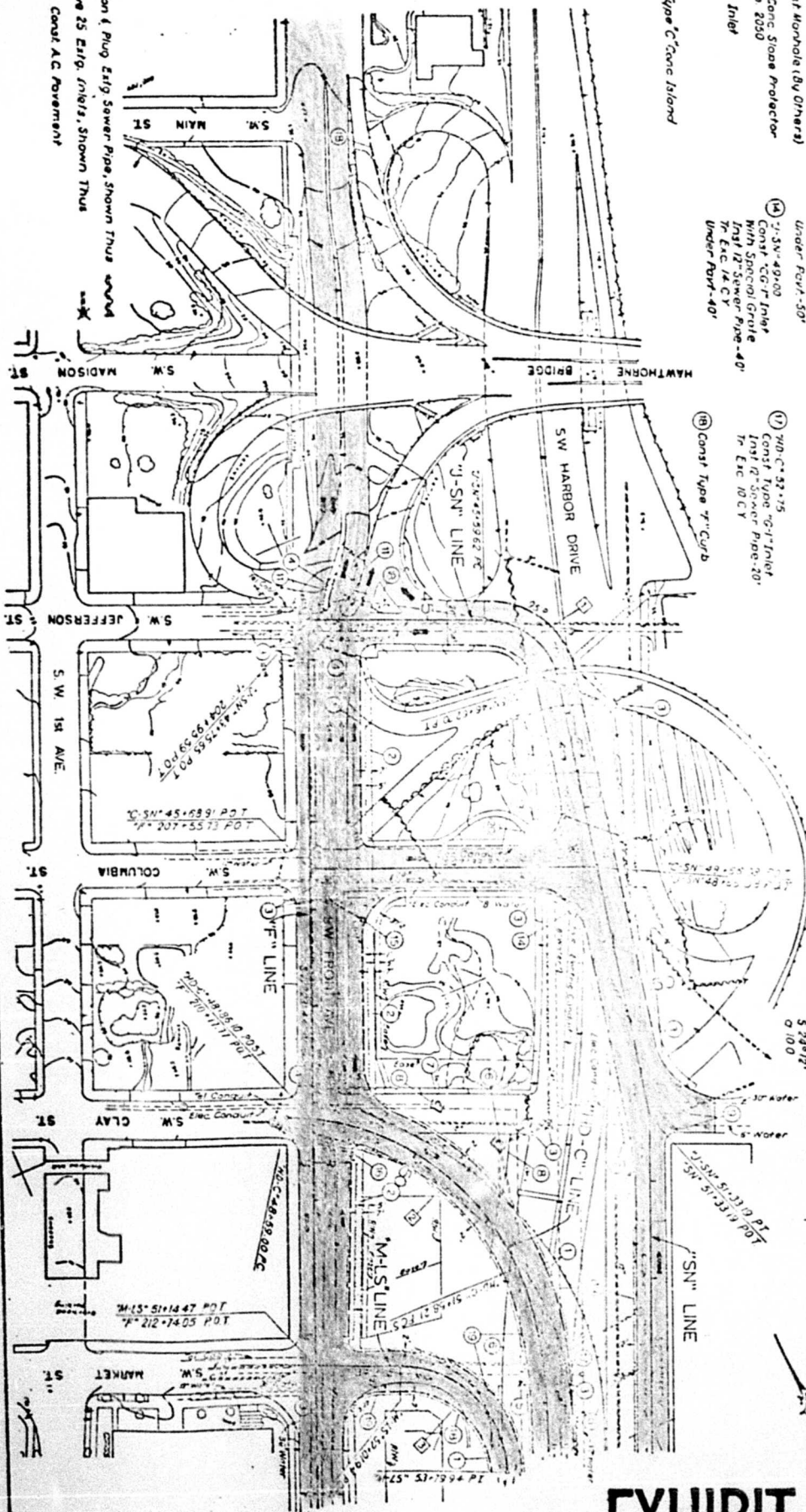

EXHIBIT

SEC 3 TIS, RIE, WM
PORTLAND

NOTE:
Conduit Lines Shown
on Existing Ground

PROJECT	STREET LIGHTS, PORTLAND, OREGON
DATE	1957
BY	W. H. HARRIS
CHECKED	W. H. HARRIS
STATE	OREGON
CITY	PORTLAND
NO.	7

- ① Const Type "C" Curb
- ② Const Type "T" Curb
- ③ Const Type "C" Conc. Band
- ④ Adjust Manhole
- ⑤ Recast Manhole
- ⑥ Adjust Inlet
- ⑦ Const Inlet
- ⑧ Const Type "G" Inlet
- ⑨ Const Type "G" Inlet
- ⑩ Const Type "G" Inlet
- ⑪ Const Type "G" Inlet
- ⑫ Const Type "G" Inlet
- ⑬ Const Type "G" Inlet
- ⑭ Const Type "G" Inlet
- ⑮ Const Type "G" Inlet
- ⑯ Const Type "G" Inlet
- ⑰ Const Type "G" Inlet
- ⑱ Const Type "G" Inlet
- ⑲ Const Type "G" Inlet
- ⑳ Const Type "G" Inlet
- ㉑ Const Type "G" Inlet
- ㉒ Const Type "G" Inlet
- ㉓ Const Type "G" Inlet
- ㉔ Const Type "G" Inlet
- ㉕ Const Type "G" Inlet
- ㉖ Const Type "G" Inlet
- ㉗ Const Type "G" Inlet
- ㉘ Const Type "G" Inlet
- ㉙ Const Type "G" Inlet
- ㉚ Const Type "G" Inlet
- ㉛ Const Type "G" Inlet
- ㉜ Const Type "G" Inlet
- ㉝ Const Type "G" Inlet
- ㉞ Const Type "G" Inlet
- ㉟ Const Type "G" Inlet
- ㊱ Const Type "G" Inlet
- ㊲ Const Type "G" Inlet
- ㊳ Const Type "G" Inlet
- ㊴ Const Type "G" Inlet
- ㊵ Const Type "G" Inlet
- ㊶ Const Type "G" Inlet
- ㊷ Const Type "G" Inlet
- ㊸ Const Type "G" Inlet
- ㊹ Const Type "G" Inlet
- ㊺ Const Type "G" Inlet
- ㊻ Const Type "G" Inlet
- ㊼ Const Type "G" Inlet
- ㊽ Const Type "G" Inlet
- ㊾ Const Type "G" Inlet
- ㊿ Const Type "G" Inlet

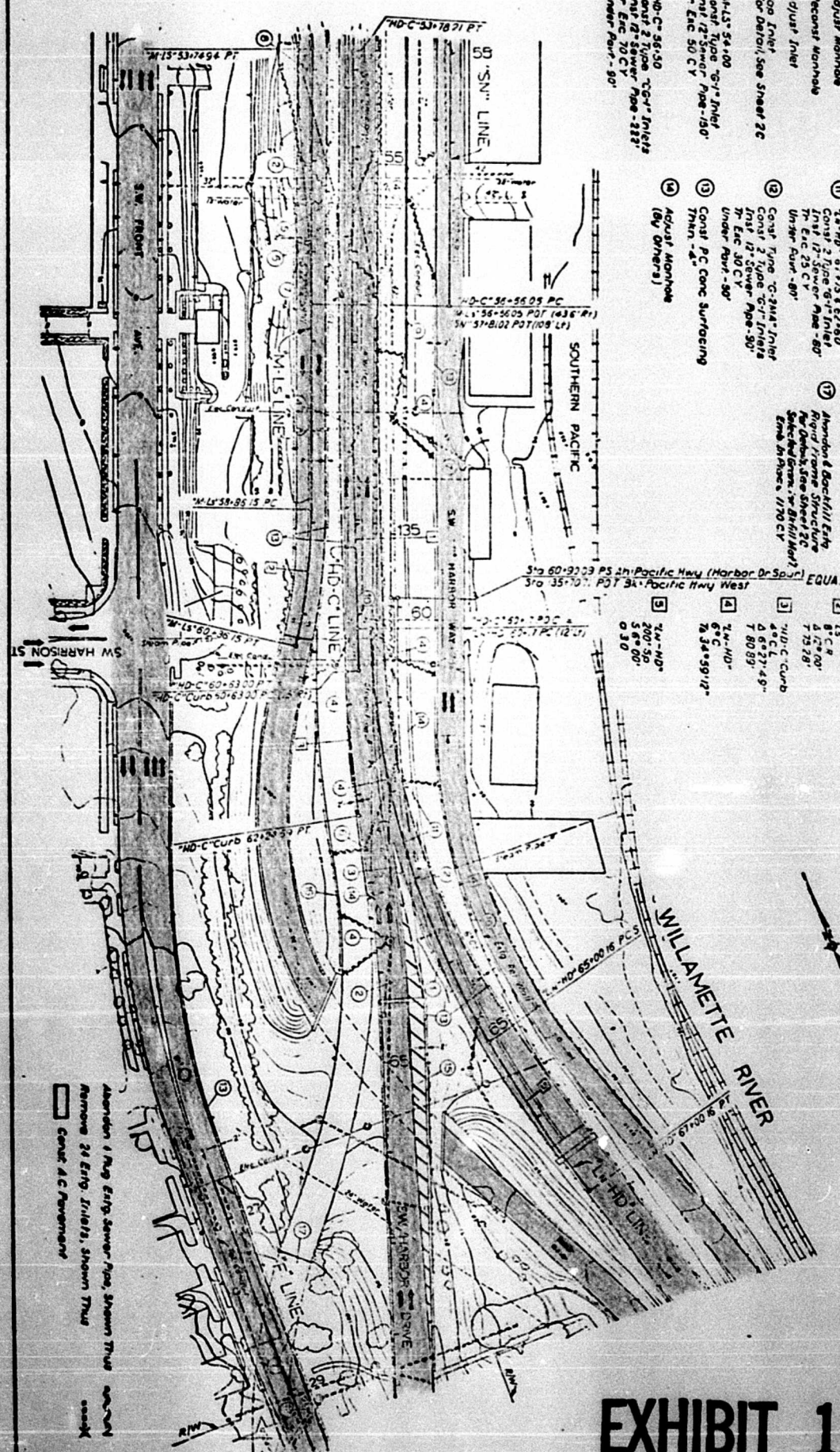
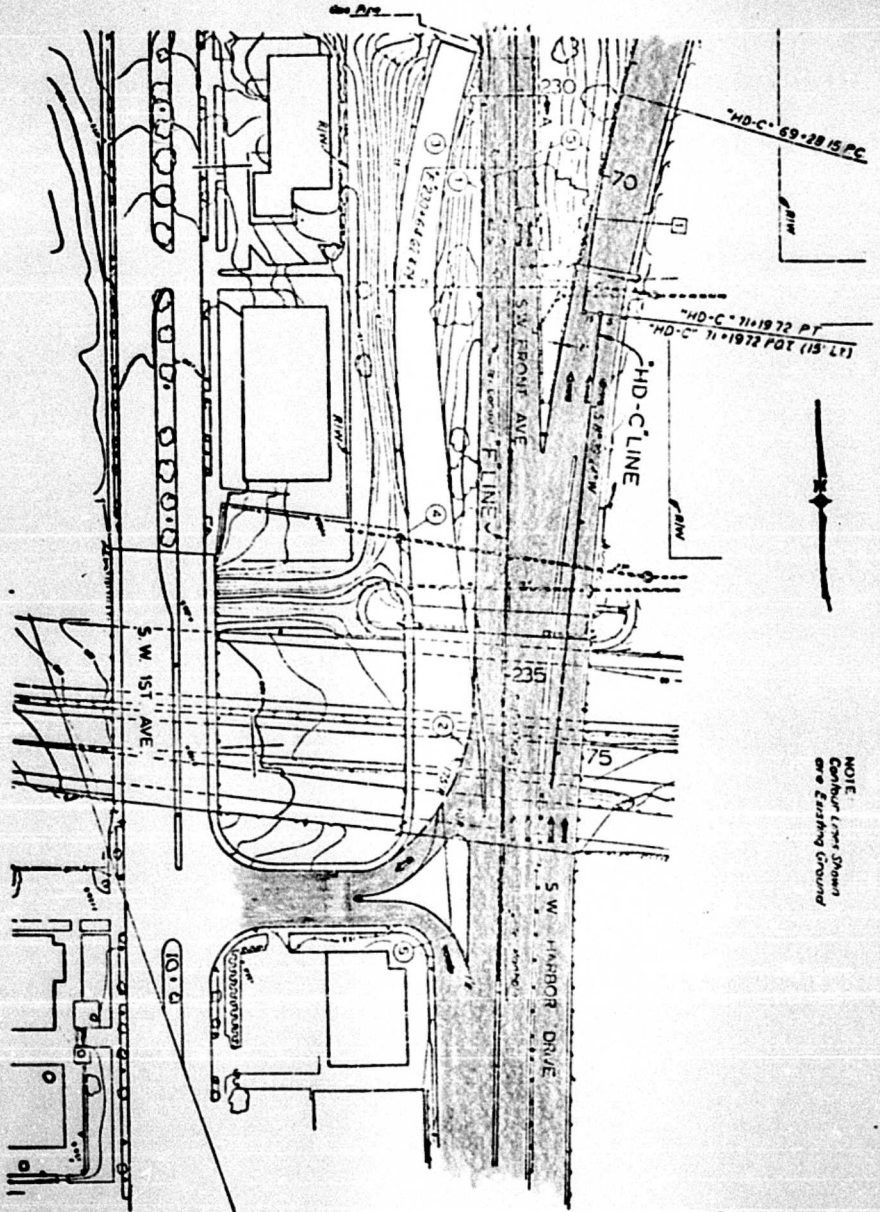

EXHIBIT 1

137533

SEC. 3, 115, RILE, WM.
PORTLAND

NOTE:
Conduit Lines Shown
are Existing Ground



- ① *Constr Type "C" Curve*
- ② *Constr Type "r" Curve*
- ③ *Adj/ust Wornhole (by Others)*
- ④ *Reconstr Wornhole*
- ⑤ *Constr "P" Conc Surfacing*
- ⑥ *Constr Type "C" Conc Island*

①
ND-C
5°C L
4 00 34' 42"
7 06 01'

☐ **Cons. A.C. Movement**

EXHIBIT 1

ORDINANCE No. 137533

An ordinance authorizing execution of an agreement between the City of Portland and the State of Oregon, by and through its Transportation Commission, relating to the closure of Harbor Drive and rerouting of Pacific Highway West along Front Avenue, clarifying maintenance responsibilities to be in effect at such time as highway traffic is actually routed along Front Avenue, and declaring an emergency.

The City of Portland ordains:

Section 1. The Council finds that Ordinance No. 135362 authorized the execution of an agreement between the City and the State of Oregon, by and through its State Highway Commission for the closure of Harbor Drive and rerouting of Pacific Highway West along Front Avenue; that it is in the best interest of all concerned to now enter into an agreement approved by the Commissioner of Public Works and the State Highway Division for the purpose of clarifying maintenance responsibilities to be in effect at such time as highway traffic is actually routed along Front Avenue. Now, therefore, the Mayor and the Commissioner of Public Works hereby are authorized to execute an agreement with the State of Oregon as previously set forth, said agreement to be substantially in accordance with Exhibit "1" attached to the original only of this ordinance and by this reference hereby made a part hereof:

Section 2. Inasmuch as this ordinance is necessary for the immediate preservation of the public health, peace and safety of the City of Portland in this: In order that needed improvements may go forward without unnecessary delay; therefore, an emergency hereby is declared to exist and this ordinance shall be in force and in effect from and after its passage by the Council.

Passed by the Council NOV 28 1973

Commissioner Lloyd Anderson

GRP:jp
10/31/73

Attest:

Auditor of the City of Portland

Calendar No. 3606

ORDINANCE No. 137513

Title

An ordinance authorizing execution of an agreement between the City of Portland and the State of Oregon, by and through its Transportation Commission, relating to the closure of Harbor Drive and re-routing of Pacific Highway West along Front Avenue, clarifying maintenance responsibilities to be in effect at such time as highway traffic is actually routed along Front Avenue, and declaring an emergency.

THE COMMISSIONERS VOTED AS FOLLOWS:

	Yeas	Nays
Anderson	1	
Ivancie	1	
McCready	1	
Schwab	1	
Goldschmidt	1	

FOUR-FIFTHS CALENDAR

Anderson	
Ivancie	
McCready	
Schwab	
Goldschmidt	

Filed NOV 20 1973

GEORGE YERKOVICH

Auditor of the CITY OF PORTLAND

By London Cressel
Deputy

INTRODUCED BY

LLOYD E. ANDERSON, COMM'R

DRAWN BY

GRP:jp

Date 10-31-73

NOTED BY THE COMMISSIONER

Affairs

Finance and
Administration

Safety

Utilities

Works

City Attorney

NOTED BY THE CITY AUDITOR

APPROVED

Date 11-14-73

By

James L. Apperson
City Engineer
JAMES L. APPERSON

Date

By

Calendar No. 3606

ORDINANCE No. 137533

Title

An ordinance authorizing execution of an agreement between the City of Portland and the State of Oregon, by and through its Transportation Commission, relating to the closure of Harbor Drive and re-routing of Pacific Highway West along Front Avenue, clarifying maintenance responsibilities to be in effect at such time as highway traffic is actually routed along Front Avenue, and declaring an emergency.

AS FOLLOWS:

THE COMMISSIONERS VOTED	
Yeas	Nays
Anderson	1
Ivancie	1
McCreedy	1
Schwab	1
Goldschmidt	1

FOUR-FIFTHS CALENDAR

Anderson	
Ivancie	
McCreedy	
Schwab	
Goldschmidt	

Filed

NOV 20 1973

GEORGE YERKOVICH

Auditor of the CITY OF PORTLAND

By London Croell
Deputy

INTRODUCED BY

LLOYD E. ANDERSON, COMM'R

DRAWN BY

GRP:jp

Date 10-31-73

NOTED BY THE COMMISSIONER

Affairs

Finance and
Administration

Safety

Utilities

Works

City Attorney

NOTED BY THE CITY AUDITOR

APPROVED

Date 11-14-73

By

James L. Apperson
City Engineer
JAMES L. APPERSON

Date

By