

Barbara Walker Crossing

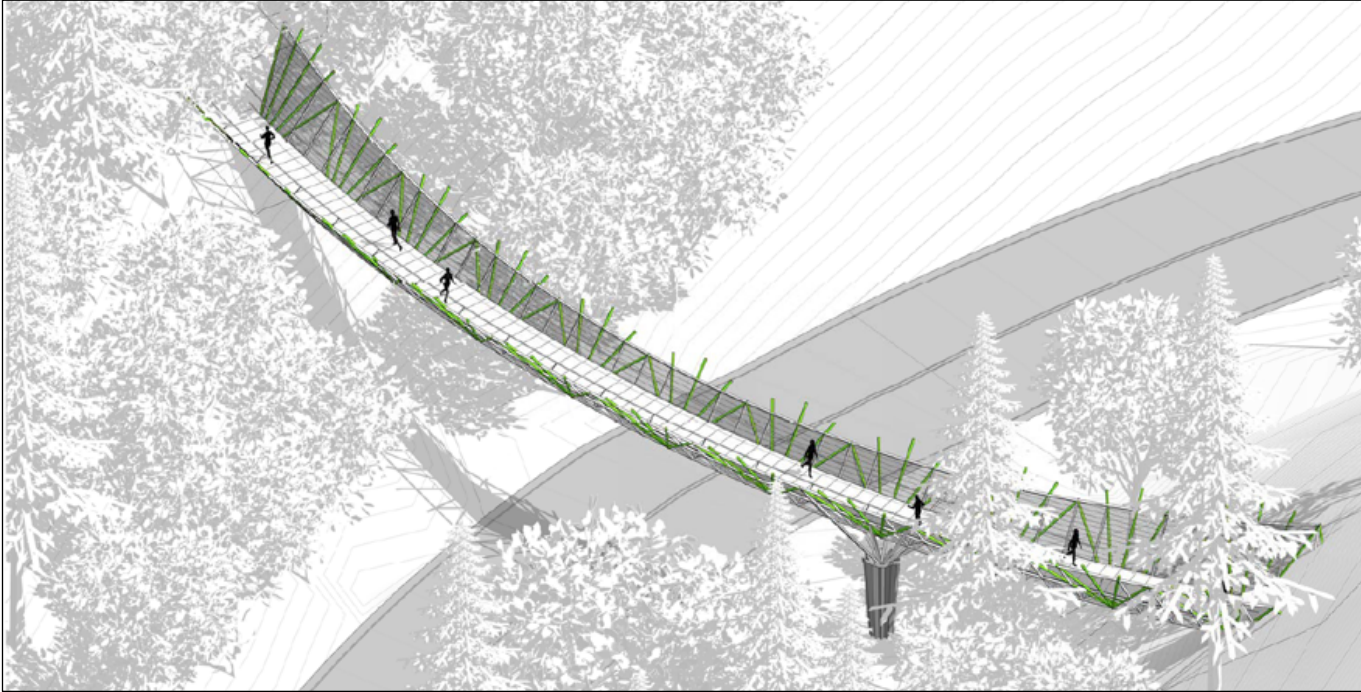

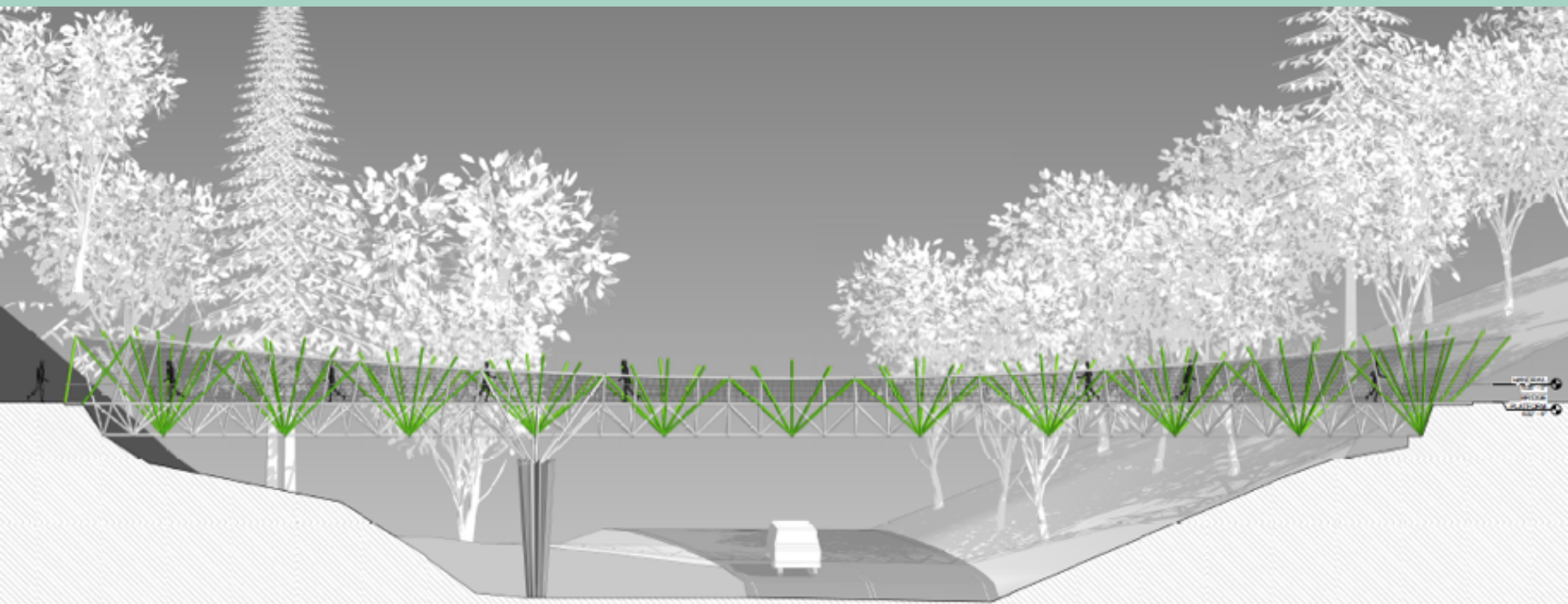





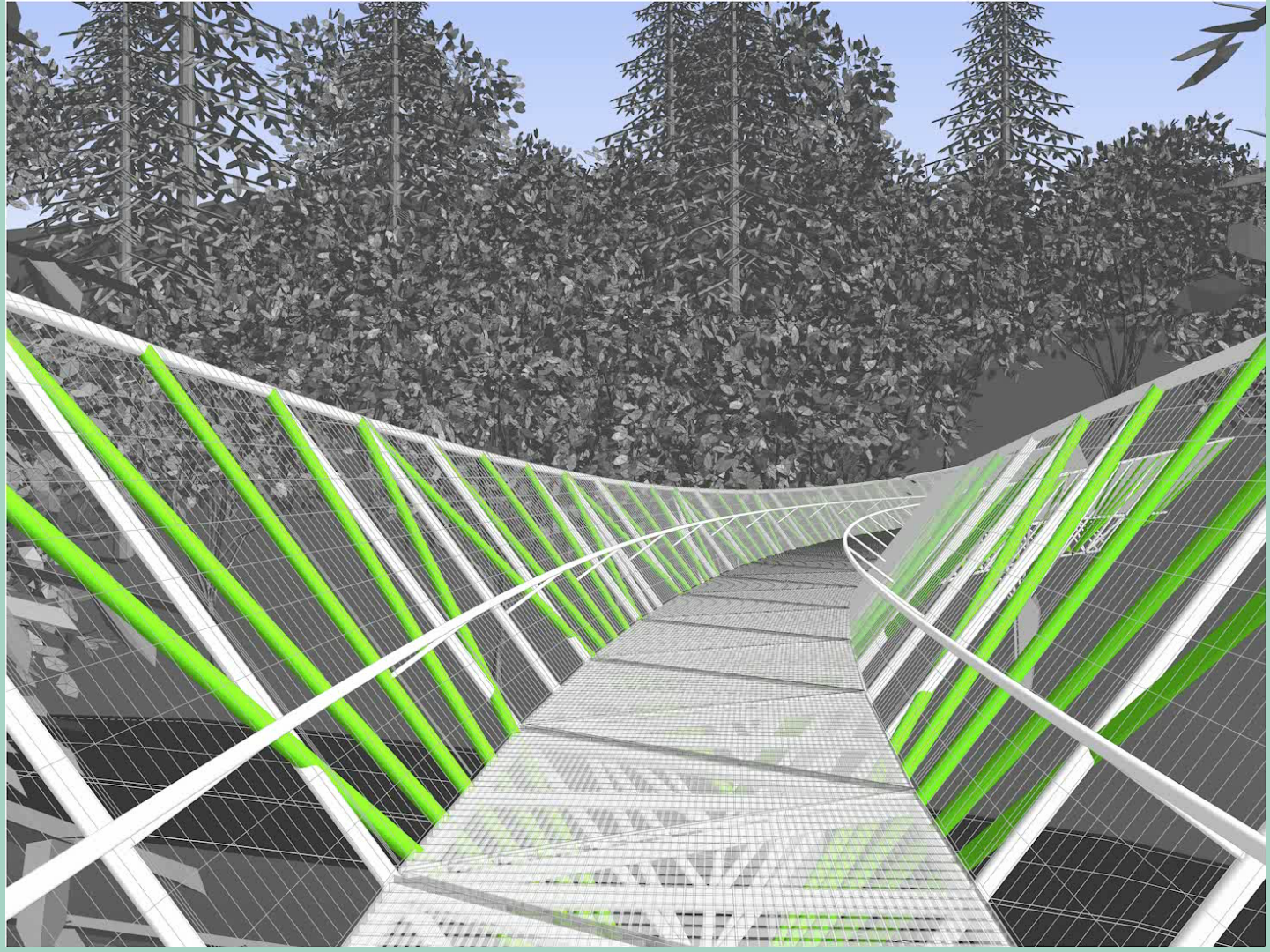



Ed Carpenter



Charlie Swindells



Private funding:

- \$2.17 million from 900 individual donors and major foundations
- Including 600 donors who gave \$184,916 through a 33-day crowdfunding campaign

Design, construction, and legal pro bono :

- \$385,000



Shields | Obletz | Johnsen



Public funding:

- \$500,000 from Portland's general fund
- \$350,000 PBOT SDCs
- \$450,000 PP&R SDCs
- \$200,000 from Metro's 2014 Open Spaces Bond

Total: \$1,500,000



Public: 37%
Private: 63%
Total: \$5.085 million

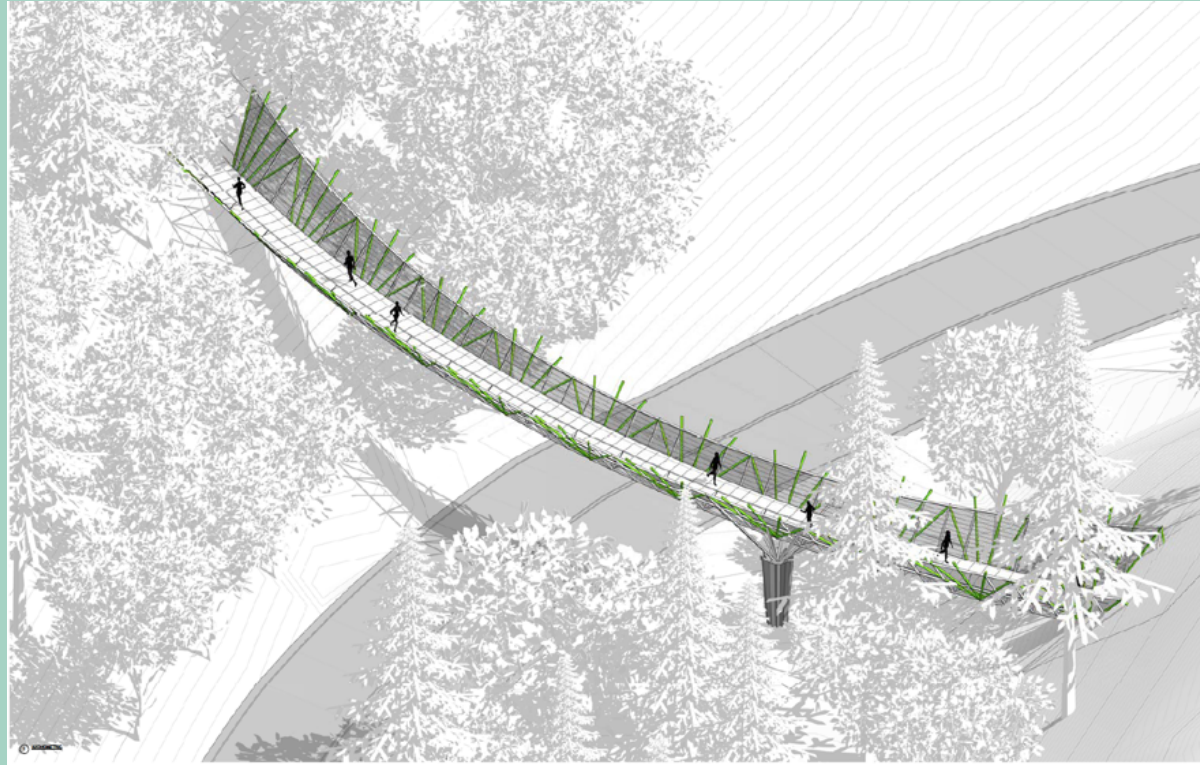



Marquam Nature Park



Tom McCall Waterfront Park, 1978



Tom McCall Waterfront Park, 1978



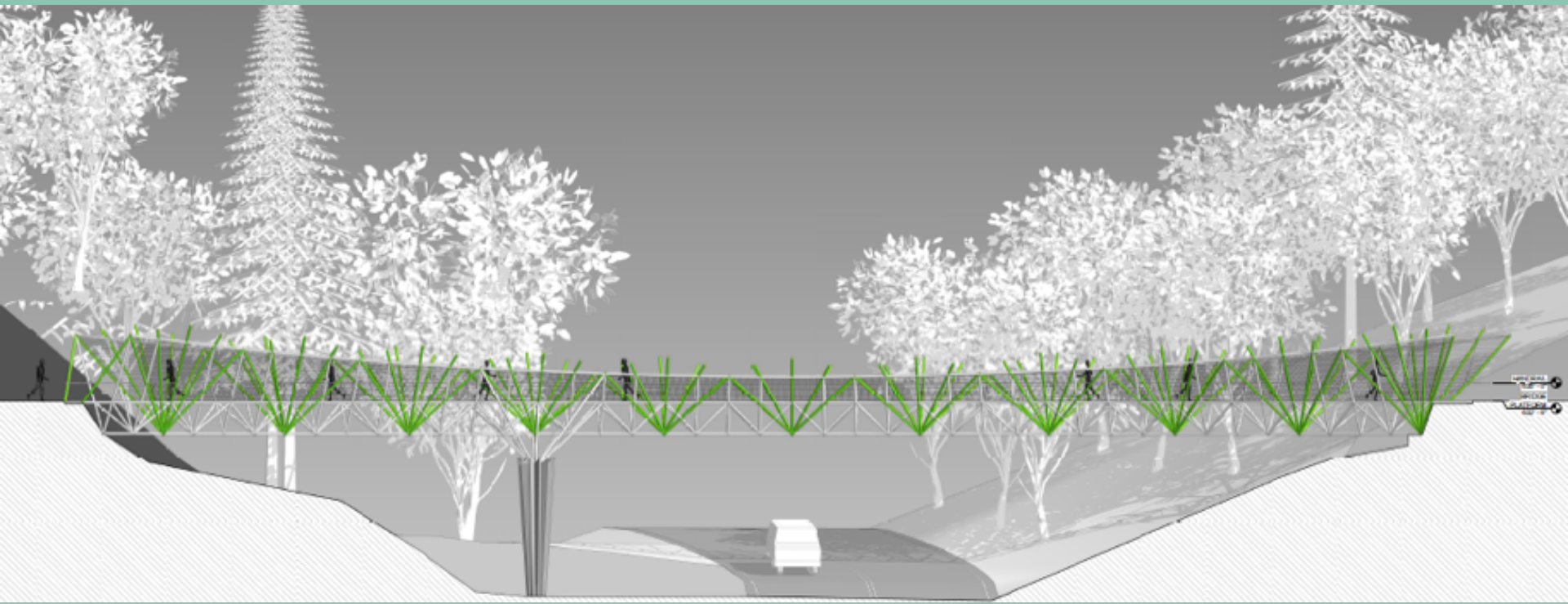

Grand Opening: 8:30-noon Sunday, Oct 27



Portland Parks Foundation

Helping people help parks.