

in progress

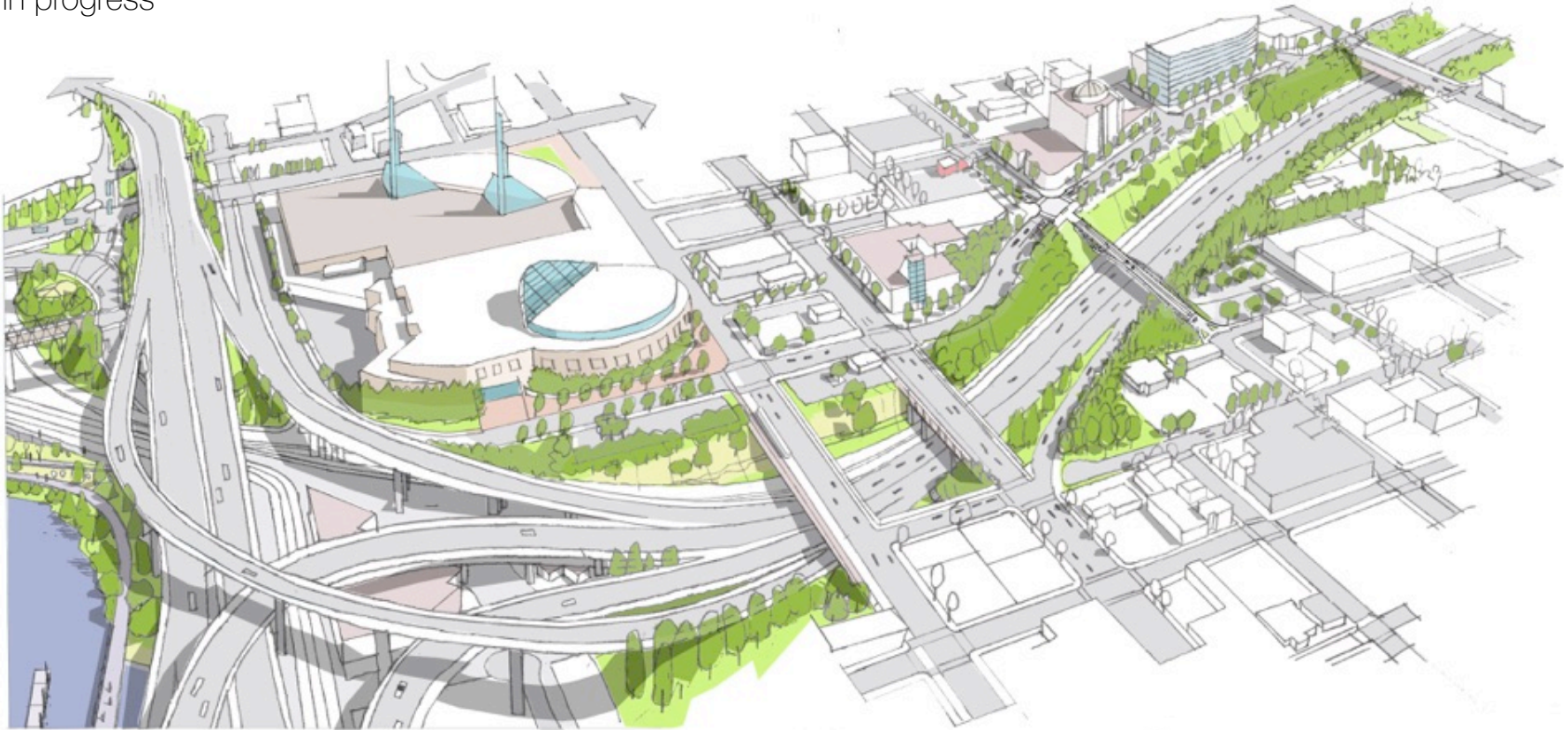

Sullivan's Crossing

Bicycle & Pedestrian Bridge



PBOT

PORTLAND BUREAU OF TRANSPORTATION

Commissioner: DAN SALTZMAN | Director: LEAH TREAT

June 7, 2018

in progress



context

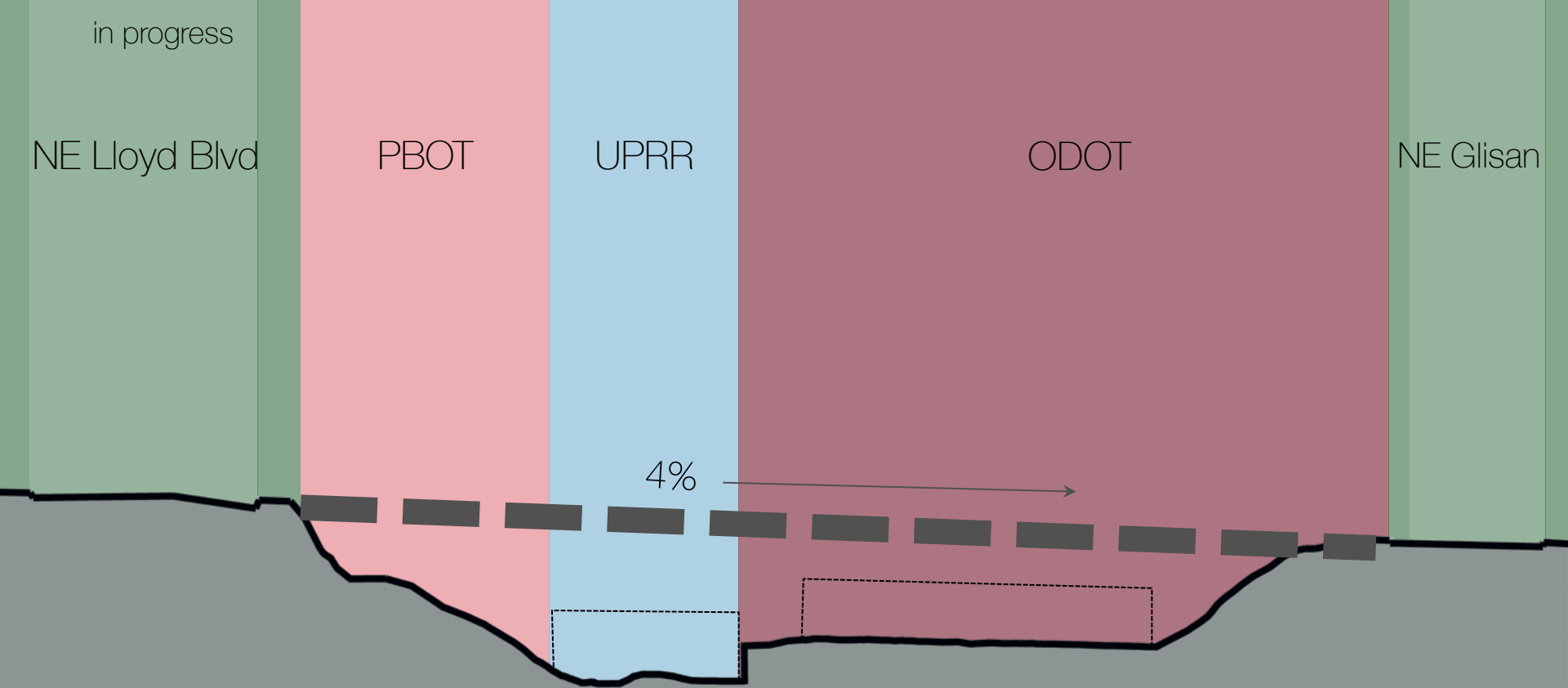

topographical section looking east

in progress

Arch

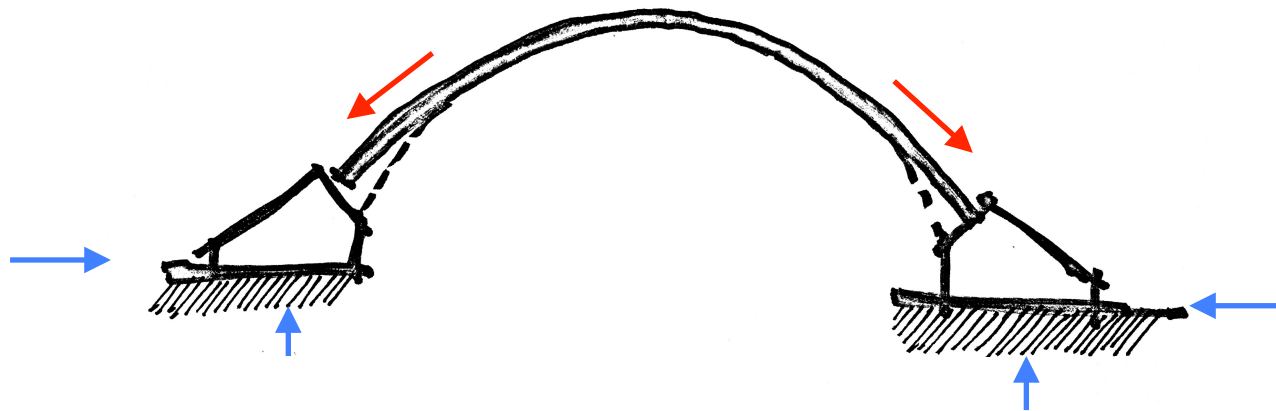

Tied Arch

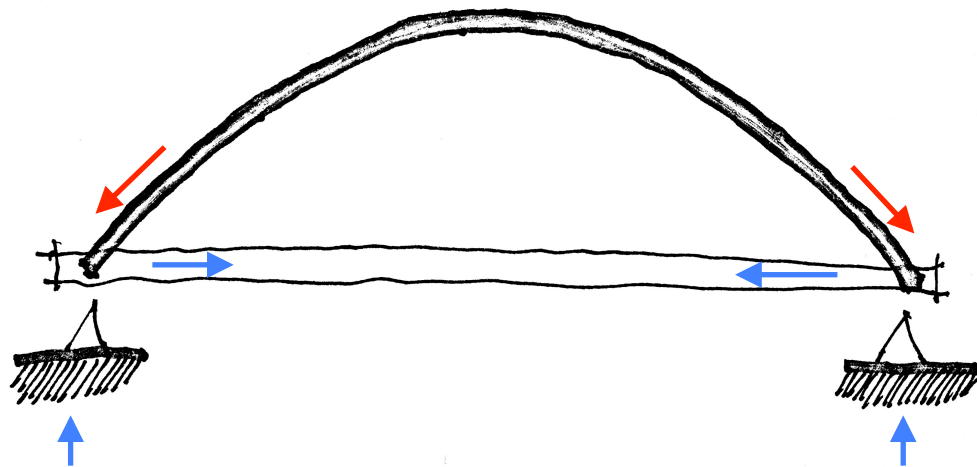

structural logic

in progress

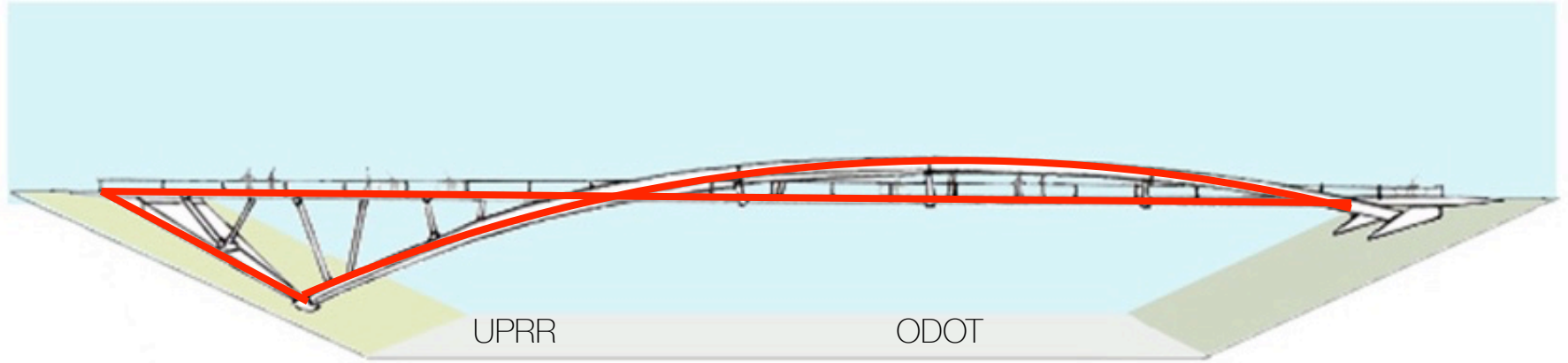

structural logic

in progress

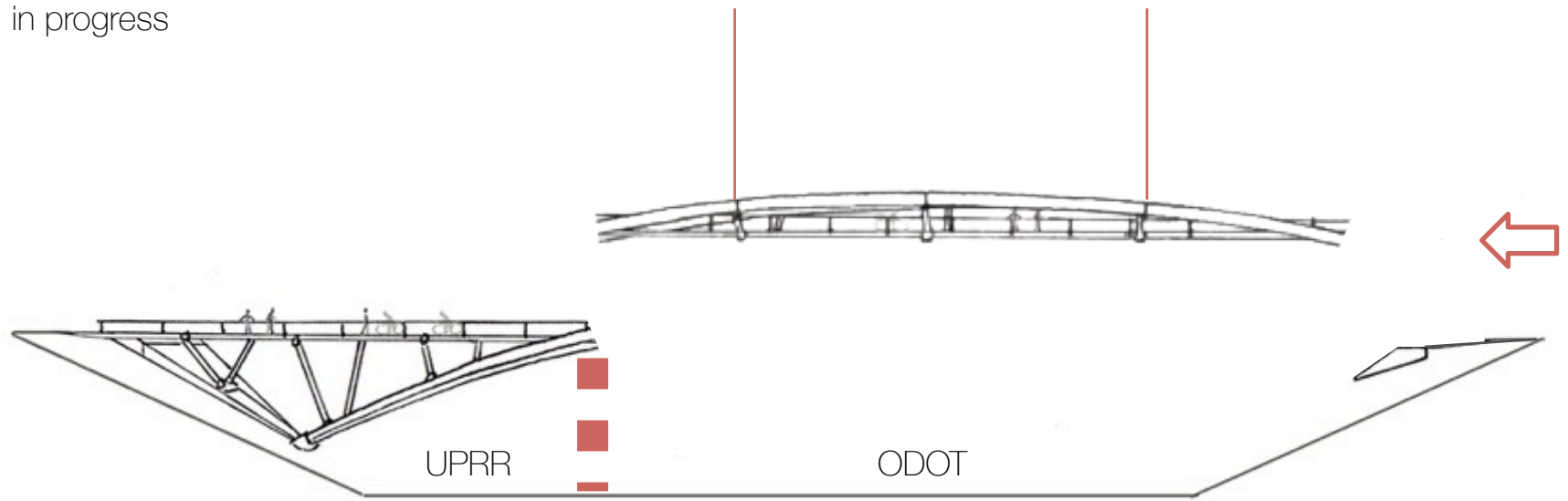

construction logic

in progress

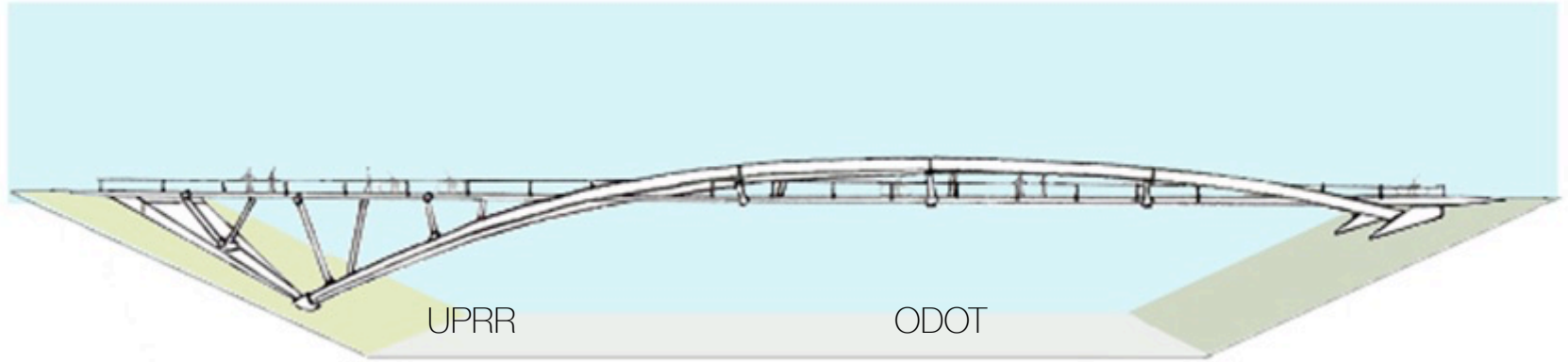

construction logic

in progress

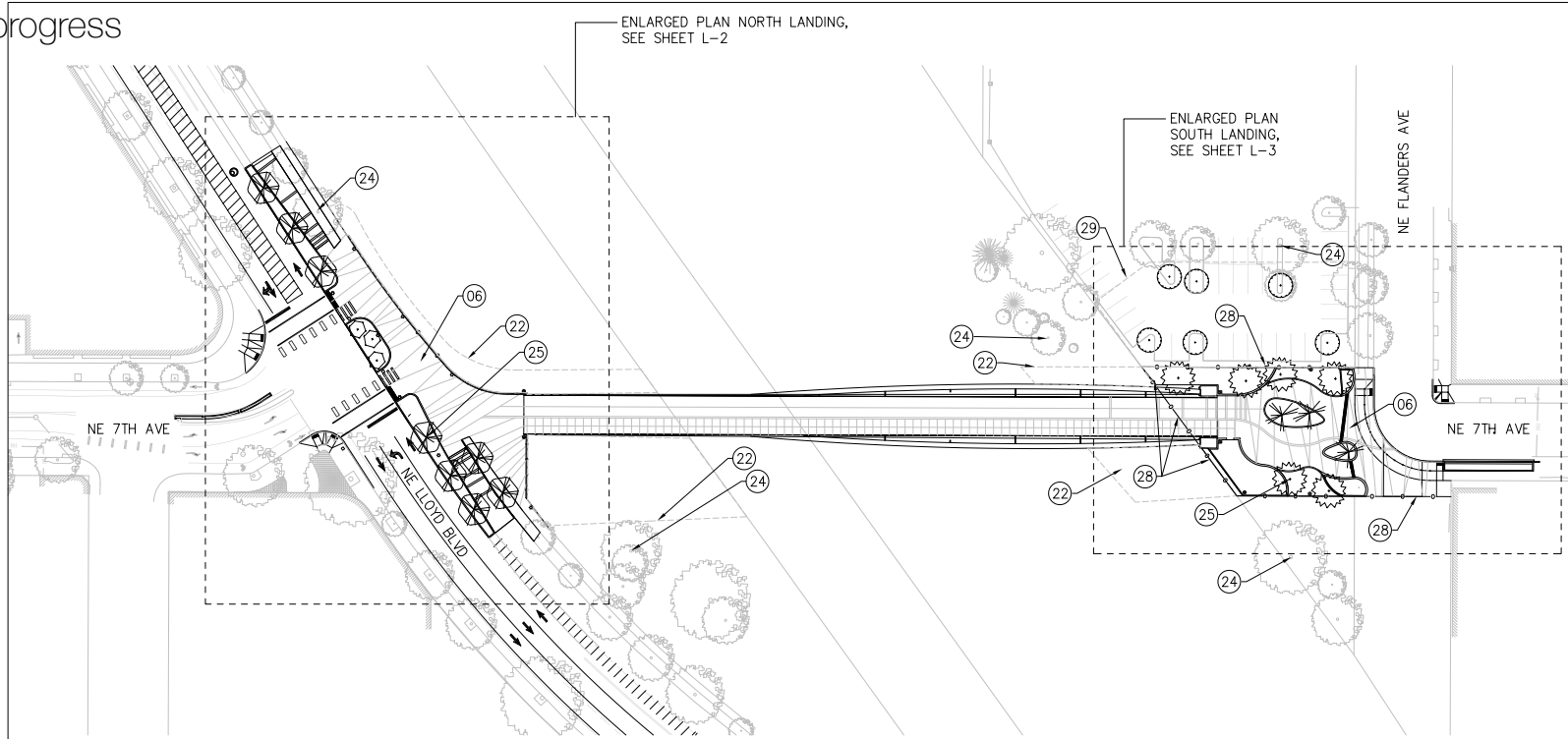

○ LANDSCAPE CONSTRUCTION NOTES

- 06 concrete paving
- 22 mitigation planting
- 24 preserve and protect existing tree, typ.
- 25 new tree, typ.
- 28 6" ht steel fence
- 29 replace landscape in parking lot staging area

WARNING
 IF THIS BAR DOES NOT MEASURE BY THEN DRAWING IS NOT TO SCALE.

NO.	DATE	DESCRIPTION	APPROVED	APPL.

DESIGNED BY
T. Thelen

DATE APPROVED

DRAWN BY
B. Deines

CHECKED BY
S. Townsend

DESIGNED BY
T. Thelen

PRELIMINARY
 NOT FOR
 CONSTRUCTION

APPROVALS:

PROJECT PRINCIPAL ENGINEER REG. PROF. ENGR. NO. 16339FC

CITY ENGINEER REG. PROF. ENGR. NO. 61630PE



Sullivan's Crossing
 Bicycle and Pedestrian Bridge

OVERALL SITE PLAN



30% DESIGN SUBMITTAL
 5/17/2018

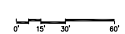

1/4 SECTION
 1nt35

PROJECT NO.
 1000006

SHEET NO.
 L-1

in progress

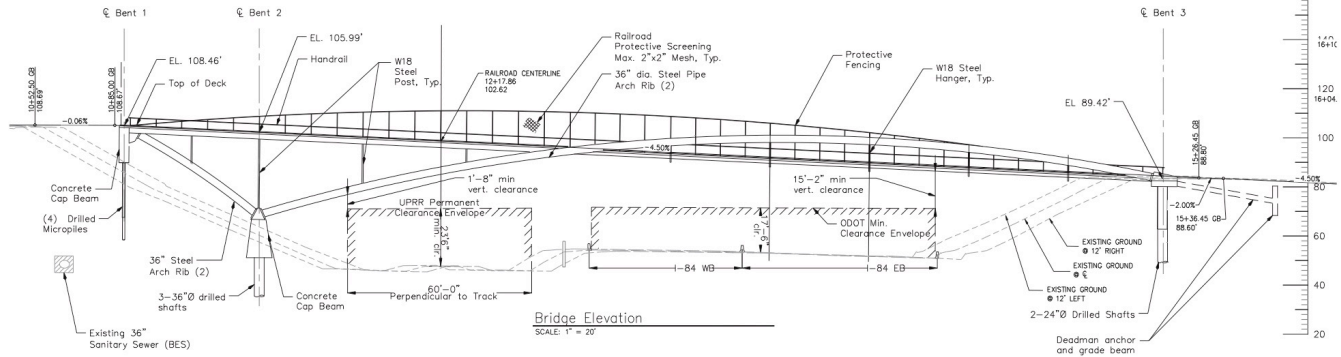
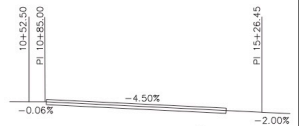
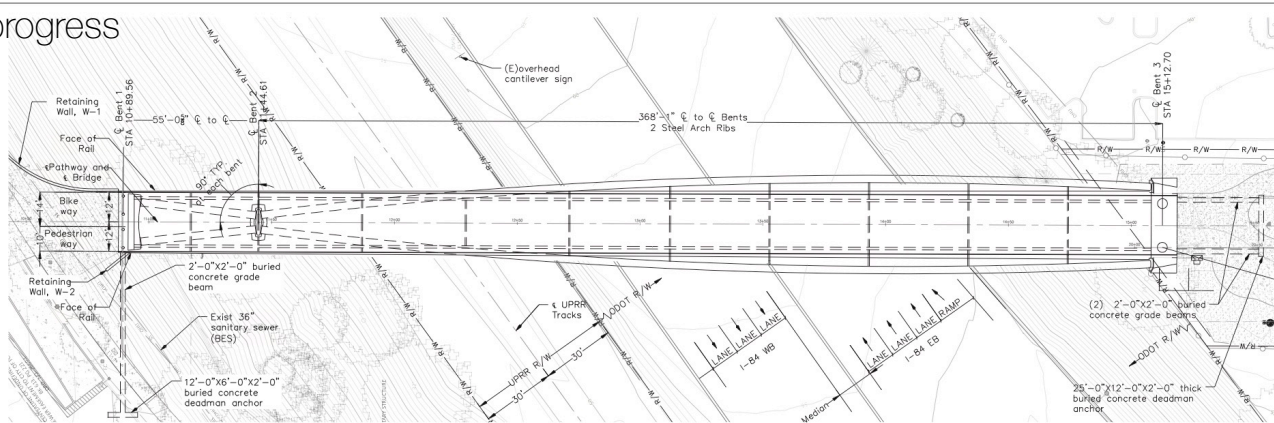

WARNING
IF THIS BAR DOES NOT MEASURE, THEN DRAWING IS NOT TO SCALE.

NO.	DATE	DESCRIPTION	REVISION

DESIGNED BY S. Whittington	DATE APPROVED
CHECKED BY J. Wilkes	DIV. ENGINEER
APPROVED	

**PRELIMINARY
CONSTRUCTION**

APPROVALS:	
PRINCIPAL ENGINEER	REG. PROF. ENGR. NO. 14369PE
CITY ENGINEER	REG. PROF. ENGR. NO. 51339PE

PBOT
PORTLAND BUREAU OF TRANSPORTATION
DAN SALTZMAN
STEVE TOWNSEN, P.E.
COMMISSIONER
CITY ENGINEER



Sullivan's Crossing
Bicycle and Pedestrian Bridge
30% DESIGN SUBMITTAL
5/17/2018
BRIDGE PLAN AND ELEVATION
BR-1

Note:
Reference section A-A for typical deck information.

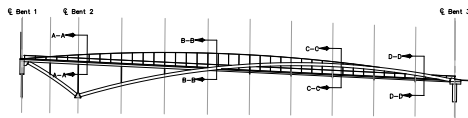

Bridge Profile
SCALE: 1" = 40'

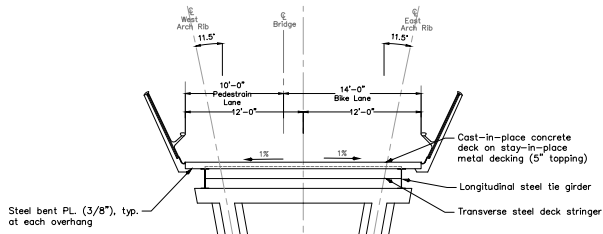

Deck Section A-A
SCALE: 1" = 5'

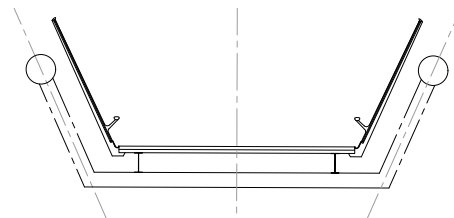

Deck Section C-C
SCALE: 1" = 5'

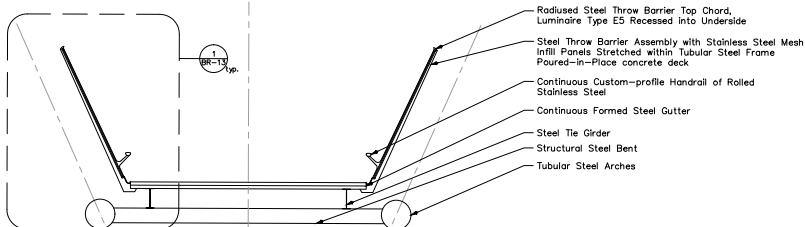

Deck Section B-B
SCALE: 1" = 5'

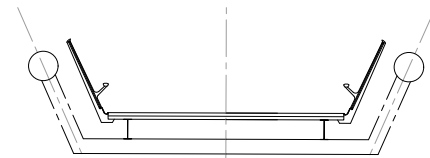

Deck Section D-D
SCALE: 1" = 5'

WARNING
IF THIS BAR DOES NOT MEASURE UP THEN DRAWING IS NOT TO SCALE.

NO.	DATE	DESCRIPTION	REVISION

DESIGNED BY S. Whittington	DATE APPROVED
DRAWN BY J. Wilkes	CIV. ENGINEER
CHECKED BY	

PRELIMINARY
NO FOR
CONSTRUCTION

APPROVALS:	
POST PRINCIPAL ENGINEER	REG. PROF. ENGR. NO. 16330PE
CITY ENGINEER	REG. PROF. ENGR. NO. 81630PE



Sullivan's Crossing
Bicycle and Pedestrian Bridge

Bridge Deck Sections

30% DESIGN SUBMITTAL
5/17/2018

1/4 SECTION	In1e35
PROJECT NO.	1000000
SHEET NO.	BR-8

in progress



LANDSCAPE CONSTRUCTION NOTES

- 01 6"ht. x 6" w cast-in-place concrete curb
- 04 extend existing planter, typ.
- 05 match existing grade at existing sidewalk
- 06 concrete paving, see civil
- 07 concrete scoring pattern
- 08 exposed concrete warning strip, 12' w x 1/4"-3/8" depth
- 10 asphalt paving
- 11 12" wide cast-in-place concrete retaining wall, board form finish, see structural
- 12 42" ht. stainless steel guardrail
- 13 42" ht. stainless steel railing
- 14 pedestrian lighting, lloyd standard
- 15 pedestrian lighting
- 17 6" dia. stainless steel removable bollard
- 18 pedestrian signal pole and light, see traffic
- 19 traffic light, see traffic
- 20 landscape planting
- 22 mitigation planting
- 23 specialty planting
- 24 preserve and protect existing tree, typ.
- 25 new tree, typ.

WARNING
IF THIS BAR DOES NOT MEASURE THEN DRAWING IS NOT TO SCALE.

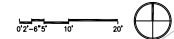

ZGF
Zimmer Gunsberg Architects LLP
 1223 SW Washington Street
 Suite 200
 Portland, OR 97205
 T 503 224 3800
 F 503 224 2442
 www.zgf.com

30% DESIGN SUBMITTAL
5/17/2018

NO.	DATE	DESCRIPTION	REVISION

DESIGNED BY	DATE APPROVED
T. Thelen	
CHK BY S. Townsen	
CHECKED BY T. Thelen	

APPROVALS:

PROJECT PRINCIPAL ENGINEER	REG. PROF. ENGR. NO. 16339P
CITY ENGINEER	REG. PROF. ENGR. NO. 51339P

PRELIMINARY
NOT FOR
CONSTRUCTION

PBOT
 PORTLAND BUREAU OF TRANSPORTATION
 DAN SALTZMAN
 STEVE TOWNSEN, P.E.
 COMMISSIONER
 CITY ENGINEER



Sullivan's Crossing
Bicycle and Pedestrian Bridge
NORTH LANDING SITE PLAN

VIA SECTION	1nt1e35
PROJECT NO.	K10024
SHEET NO.	L-2

in progress



north landing

in progress

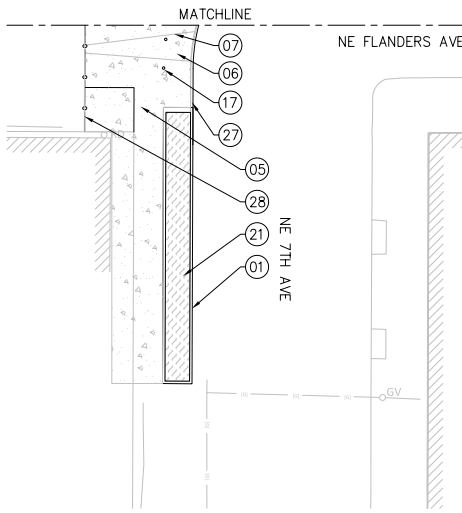
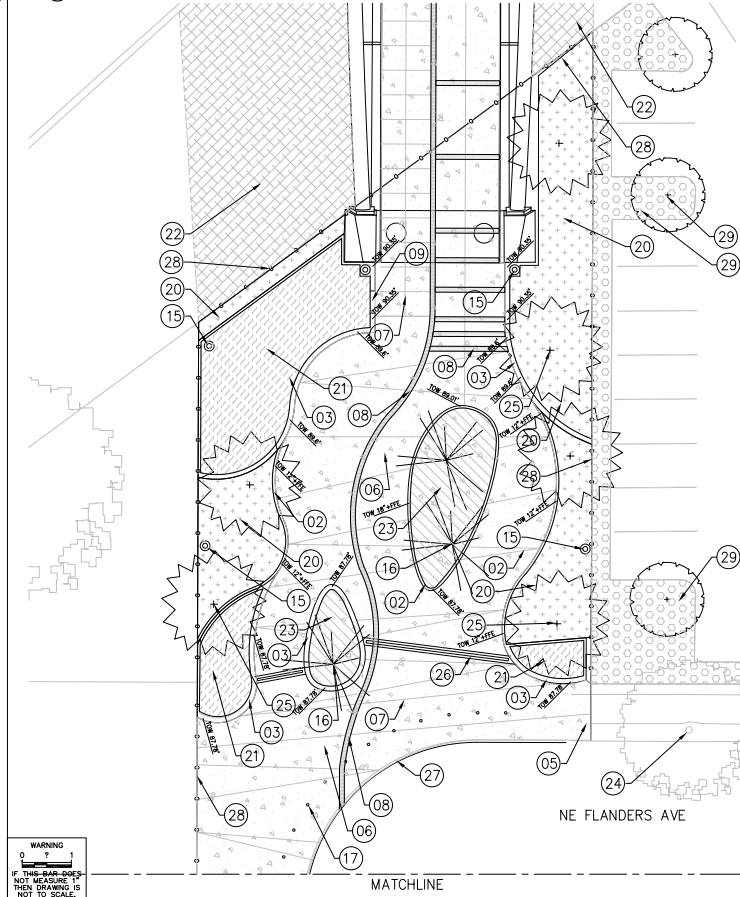

LANDSCAPE CONSTRUCTION NOTES

- 01 6"ht. x 6"w cast-in-place concrete curb
- 02 12"ht. x 6"w cast-in-place concrete planter wall
- 03 18"ht x 12"w cast-in-place concrete planter wall
- 05 match existing grade at existing sidewalk
- 06 concrete paving, see civil
- 07 concrete scoring pattern
- 08 exposed concrete warning strip, 12'w x 1/4"-3/8" depth
- 09 stormwater inlet, see civil
- 15 pedestrian lighting
- 16 specialty lighting
- 17 6" dia. stainless steel removable bollard
- 20 landscape planting
- 21 stormwater planting
- 22 mitigation planting
- 23 feature planting
- 24 preserve and protect existing tree
- 25 new tree, typ.
- 26 trench drain, see civil
- 27 flush concrete curb and gutter, see civil
- 28 6' ht steel fence
- 29 replace landscape and trees in parking lot staging area

WARNING
 IF THIS BAR DOES NOT MEASURE UP THEN DRAWING IS NOT TO SCALE.

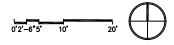

30% DESIGN SUBMITTAL
 5/17/2018

NO.	DATE	DESCRIPTION	REVISION

DESIGNED BY T. Thelen	DATE APPROVED
CHECKED BY E. Delness	CHK. ENGINEER S. Townsen
APPROVED BY T. Thelen	APP.

APPROVALS:

PROJECT PRINCIPAL ENGINEER	REG. PROF. ENGR. NO. 16339PZ
CITY ENGINEER	REG. PROF. ENGR. NO. 51330PZ

PRELIMINARY
 NOT FOR
 CONSTRUCTION



Sullivan's Crossing
 Bicycle and Pedestrian Bridge
 SOUTH LANDING SITE PLAN

VIA SECTION 1n1e35
PROJECT NO. KX0008
SHEET NO. L-3

in progress



south landing

in progress

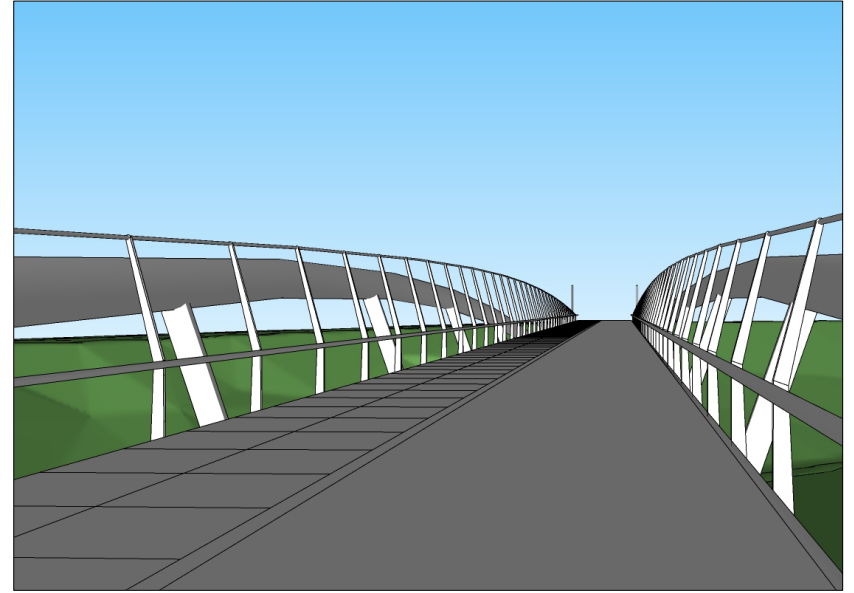
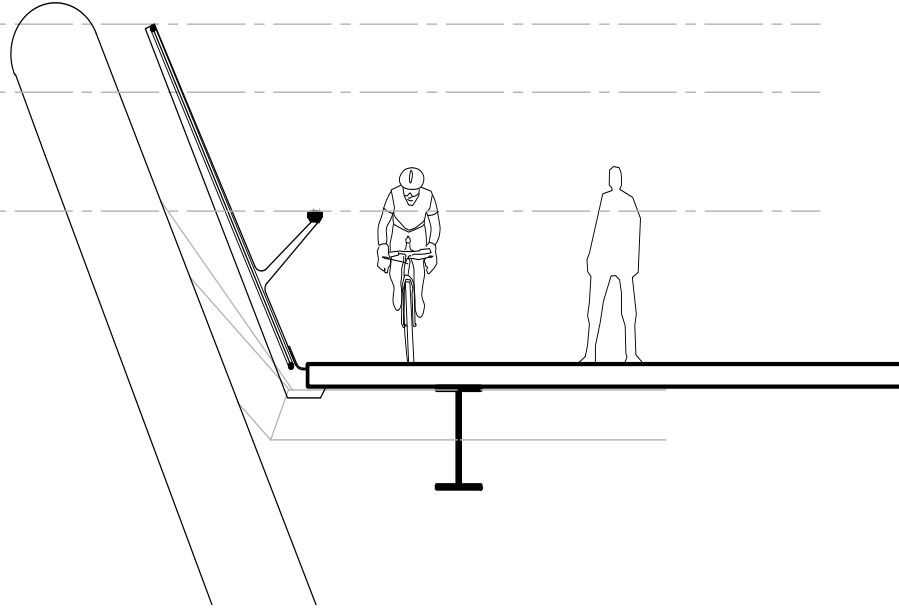

railing option 1

in progress

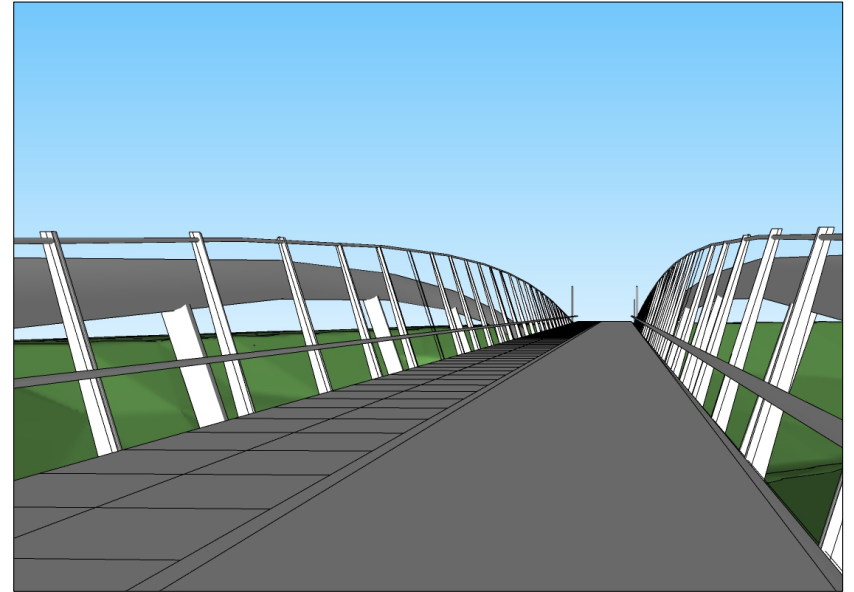
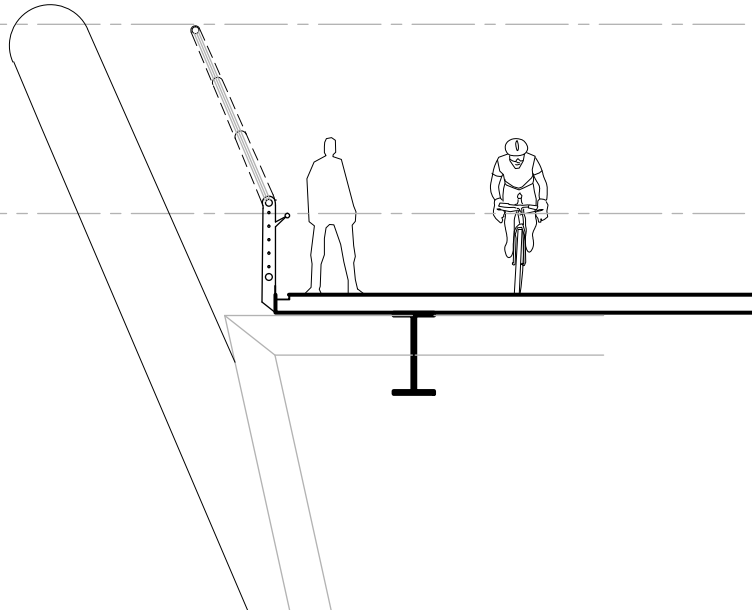

railing option 2

in progress

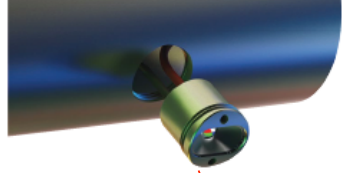

currently carrying budget allowance for lighting of bridge structure

lighting

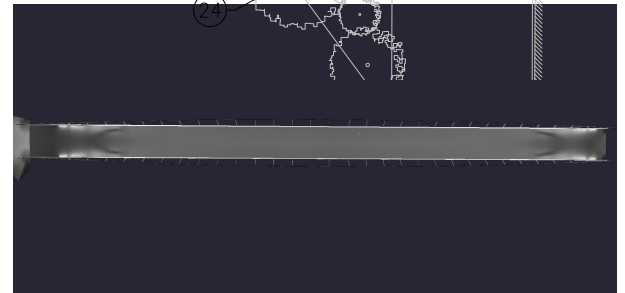
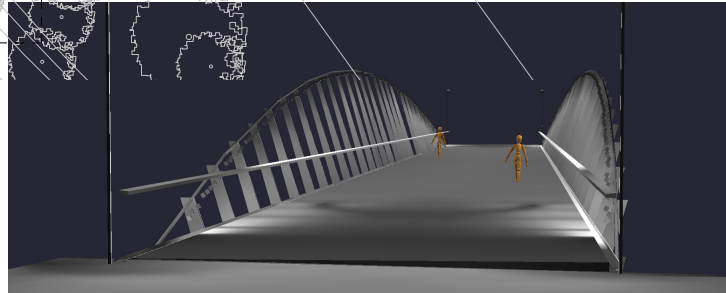

in progress

color option 1 (painted steel)



in progress



color option 2 (weathering steel)

in progress



PBOT

PORTLAND BUREAU OF TRANSPORTATION

Commissioner: DAN SALTZMAN | Director: LEAH TREAT