

# SE 80th Avenue & Mill Street Local Improvement District Resolution of Intent Hearing

*December 13, 2017 - Agenda Item #1323*

**WE KEEP PORTLAND MOVING.**

*Project scope and estimate:*

*Completed by Olivia Grenier, Oregon State University '18  
under supervision of Ryan Webb, P.E.*



**PBOT**  
PORTLAND BUREAU OF TRANSPORTATION

*Staff presenting: Andrew Aebi, LID Administrator, PBOT*

*Montavilla South Sanitary Sewer Project: David Hammond, P.E., BES*

# SE Mill Street Pedestrians West of 82nd

## Bridger student matriculating in 2020 and father

**BOTTOM LINE:** People desperately need a place to WALK. We are trapped inside our property due to the standing water and no sidewalks, which forces us to climb through neighbor's bushes with our son to get out. And when the time comes for our son to go to school, we will unfortunately have to drive him the 1 block, because we cannot leave our house by foot. This does not promote the carbon footprint reduction that the City wants to see, and we surely don't believe that Bridger Elementary wants another idling motor vehicle congesting their already restricted access points.

Financially, we also feel trapped in the sense that we cannot afford to move anywhere else in Portland due to how unattainable real estate has become. This is our home for the long-term, and we are willing to do whatever it takes to improve our community.

We feel the City should care about these improvements to **ensure the safety of children**, and make this a top priority. **Please do not wait until someone gets hurt.**



*Photos taken 10/26/17 (L) and 10/21/17 (R) and Council testimony submitted by Hannah Furseth on 12/05/17*



# SE Mill Street Looking East to 80th

306.8 miles of paved streets, no curbs as of 6/30/17

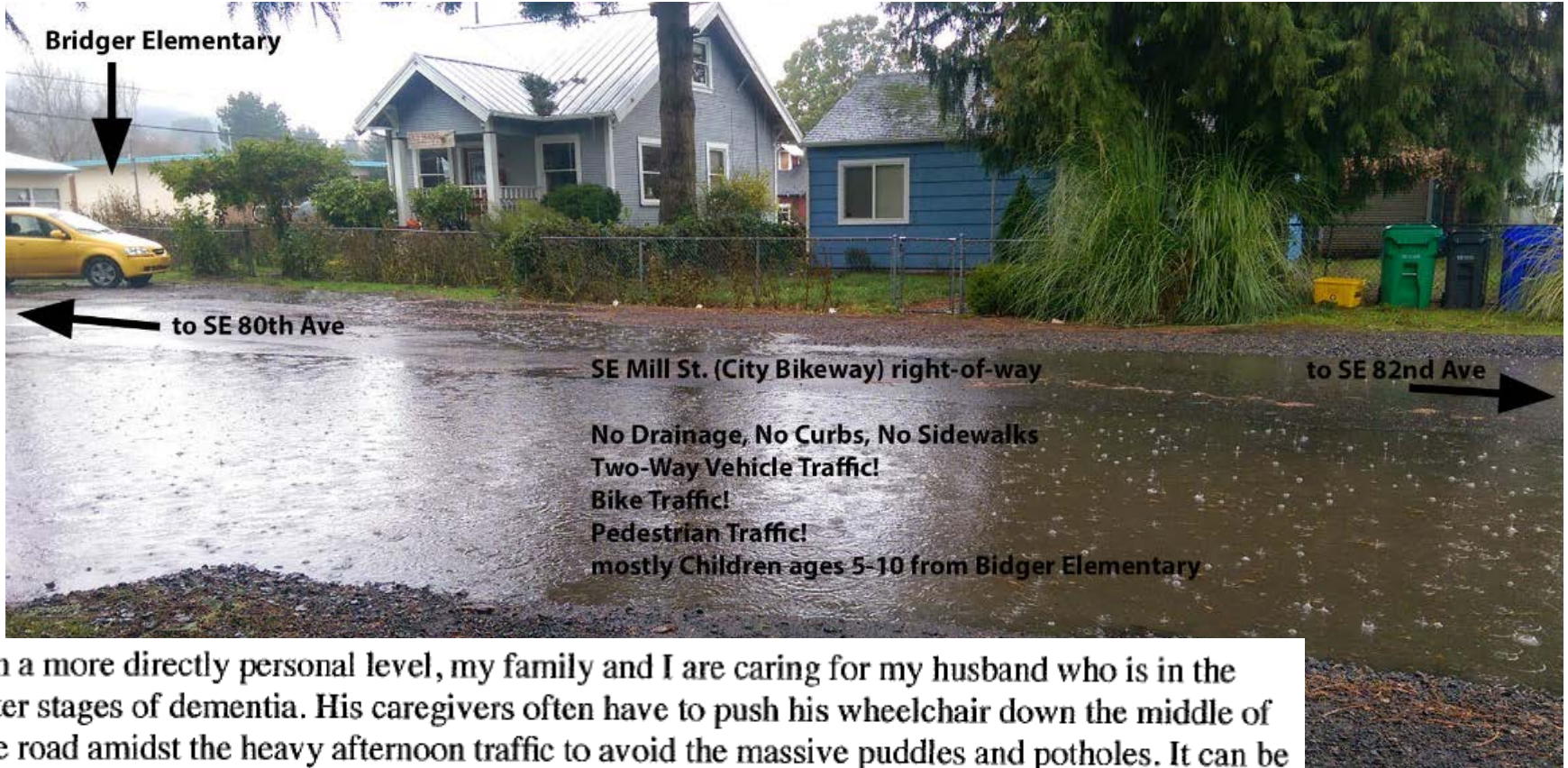

*Undated photo and captions received on 4/24/17 from Dustin Furseth;  
Excerpt of 5/20/17 letter received from Margaret Gosnell*

# Unplanned Partnership Opportunity

## New Street, New Sidewalks, New Sanitary Sewer

Without LID

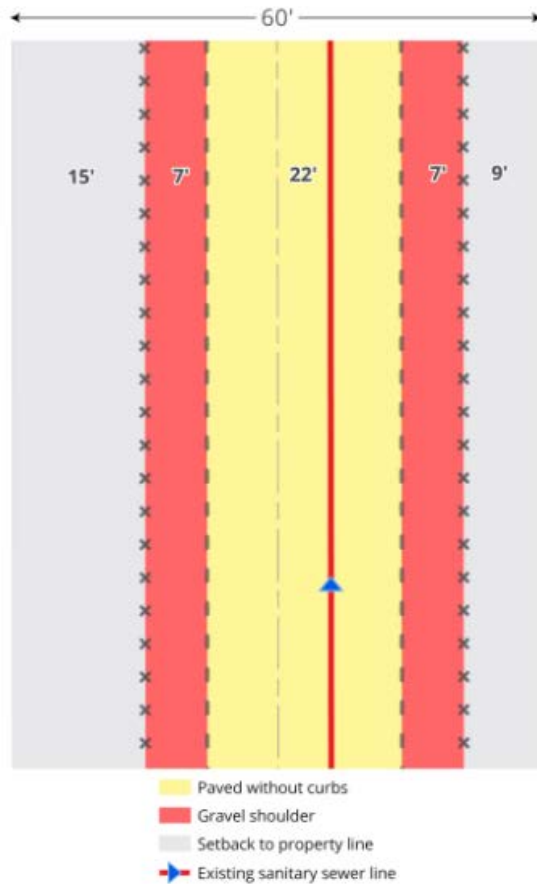

With LID

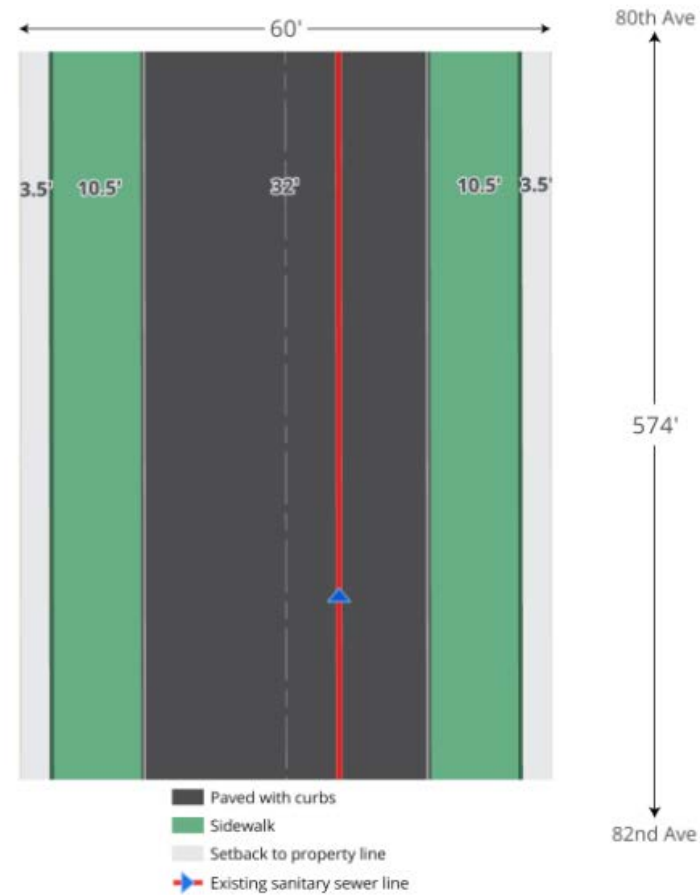

# SE 80th Avenue: Stephens to Market

## Pavement score of 5 on zero (unpaved) to 100 scale



I've observed many near miss accidents involving children nearly getting hit by cars, buses, and bike collisions (bike to bike, bike to person, bike to vehicle) at this highly trafficked intersection. We are fortunate to live only 4 blocks from school. We need only walk from SE Grant to SE Mill along 80th. The irony of this fortune is that we are apprehensive of walking or biking the short distance because the street condition is not safe. As you know there are no sidewalks so we must share the street with bikes and vehicles. In addition, the street itself is undeveloped/unpaved. Because of the disinvestment of this street we see illicit and illegal activity. The street attracts vandalism, observed by the graffiti and gang tagging of fences and private property. We see drug use and drug paraphernalia. We see a lot of dumping. We see vehicles that are stolen, abandoned and vandalized. The stretch of Mill St from 80th to 82nd is our way to the closest playground owned by Portland Parks and Recreation, Harrison Park. This is also unsafe due to lack of sidewalks and condition of the pavement.

*Photo taken on 11/14/16 by Amy Wren; Council testimony submitted by Kari Christensen on 11/27/17*



# SE 80th Ave. North of Grant to Stephens

## 55.8 miles of unpaved streets in City as of 6/30/17



*"To watch my students come to school with wet shoes -- knowing that those are their only shoes -- because they have a journey to school that involves walking through water is heartbreaking to me. I think it's an assault on their basic dignity to have to live like that, because there aren't amenities that most communities take for granted."*

*Photo taken by Andrew Aebi on 11/17/17, except photo of pedestrians taken on 11/21/17  
Quotation from Lane Middle School Assistant Principal Michael Rowell (with permission)*

## Project Map (original project limits)

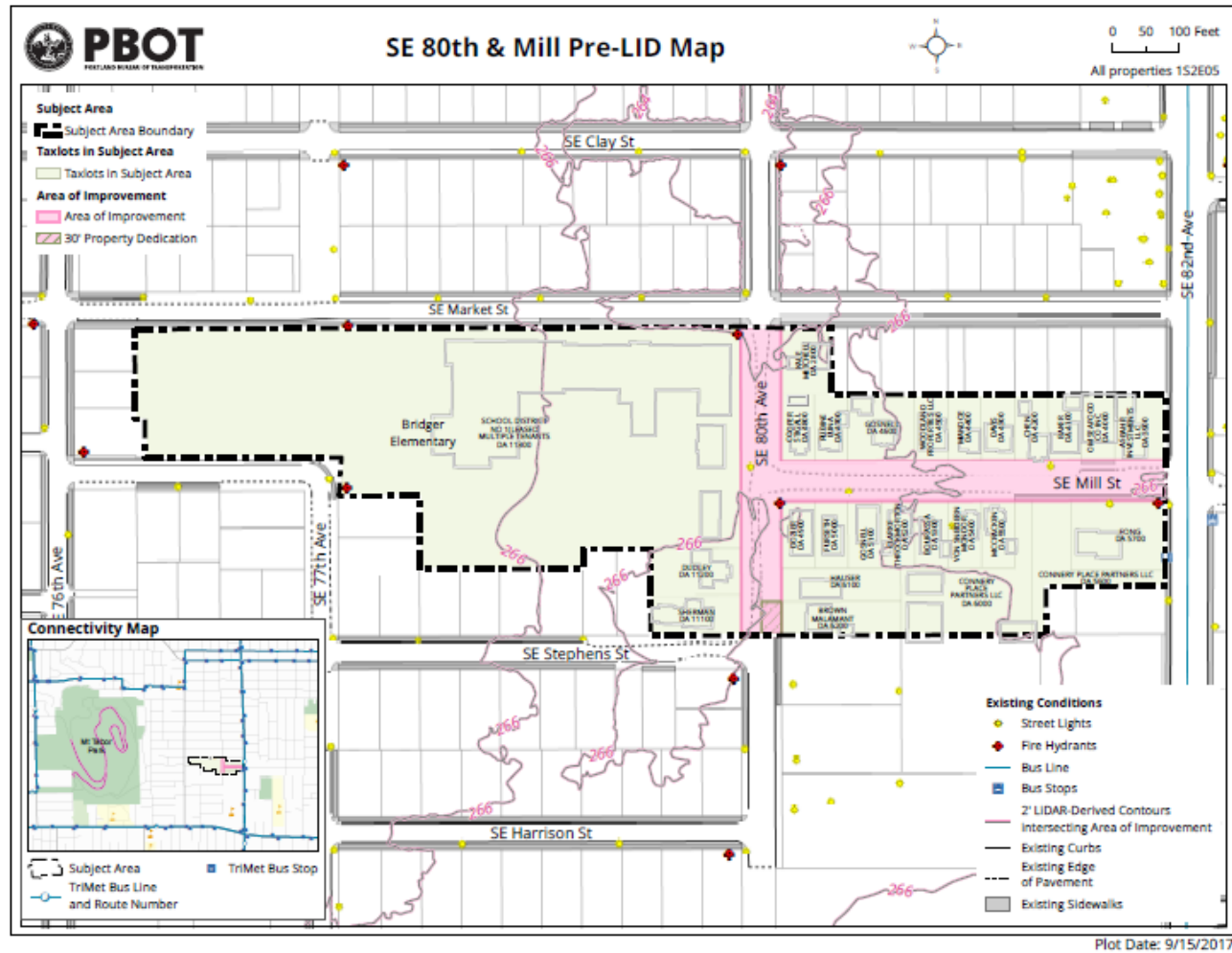

# Project Map (revised project limits)

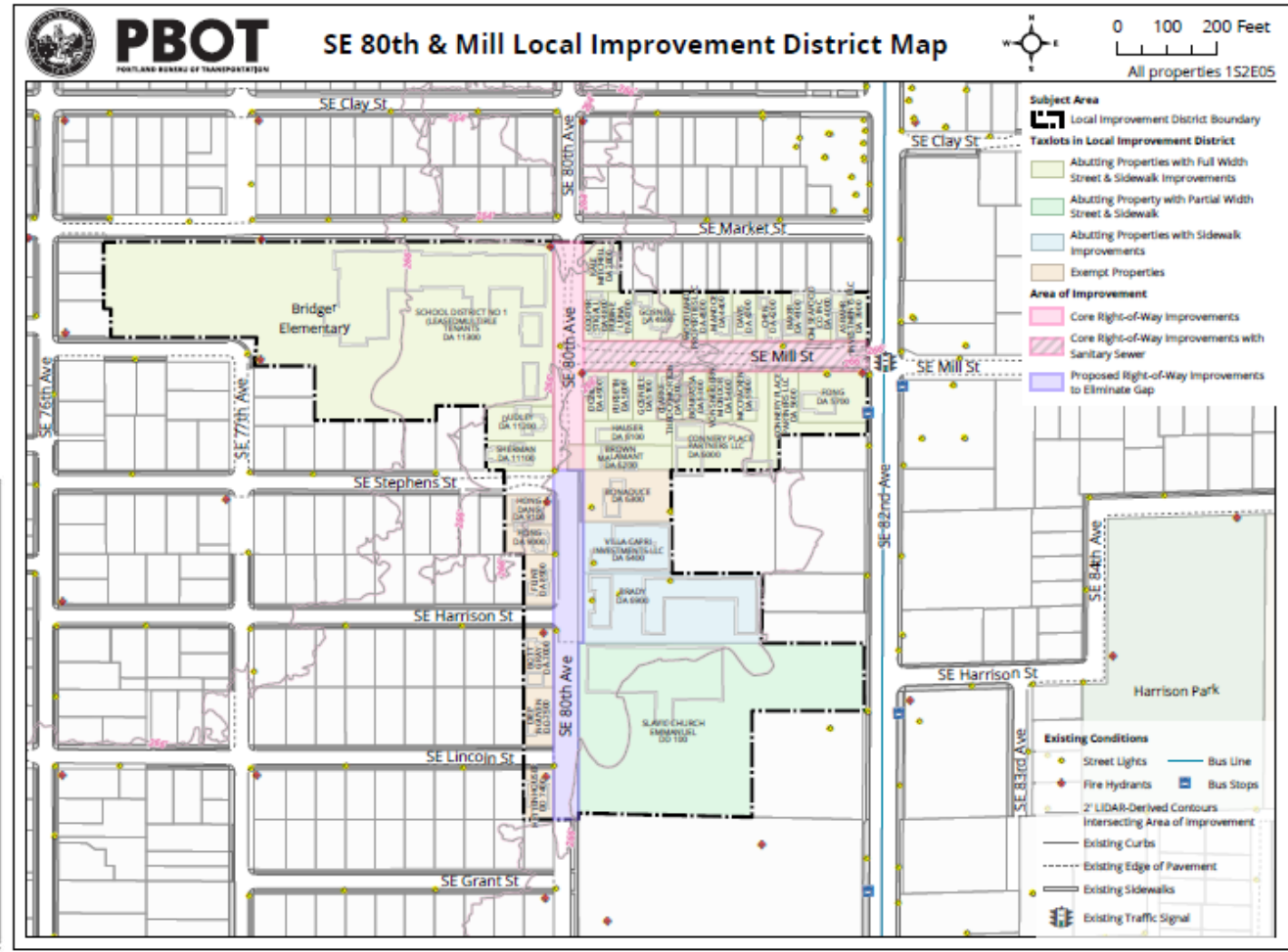
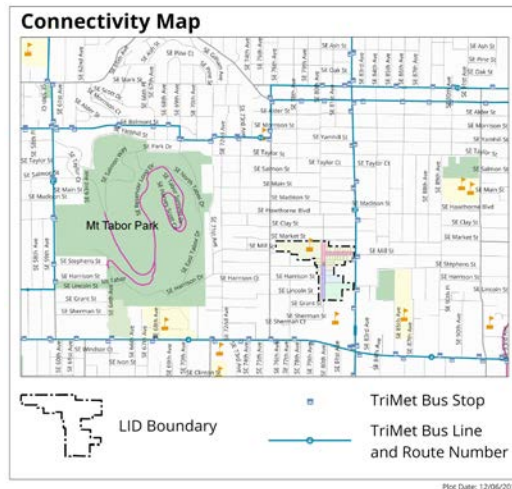



# PBOT-BES CIP Coordination Opportunity

## Project Financials (Prior to Project Extension)

Local Improvement District \$758,505 (27%):

- \$456,747 Portland Public Schools (60% of LID)

- \$301,758 among 21 residential properties (40% of LID)

- Deferral option for owner-occupied residential properties

LID previously petitioned in 2005

7937 SE Stephens St. example: \$23,846 now \$19,635 after 12 years

PBOT \$1,164,517 (42%):

- \$758,505 System Development Charge & \$406,012 overhead

BES \$865,975 (31%) including direct and in-kind funding

# “A Rough Road Leads to Greatness”

Rachel Kimbrow:  
Where are our safe routes to school?

<https://www.youtube.com/watch?v=13hDaWLqsXs>

