

Multnomah County Official Records
R Weldon, Deputy Clerk

2012-029901



\$51.00

00960270201200299010050057

03/14/2012 10:44:23 AM

2R-ORDINANC
\$25.00 \$11.00 \$15.00

Pgs=5 Stn=10 RECCASH1

Plu K. Calvert.

CITY OF PORTLAND
Office of the City Auditor
1221 SW Fourth Avenue, Room 140
Portland, OR 97204-1900

I hereby certify this Ordinance No. 185178 to be a complete and exact copy of the original as the same appears on file and of record in my office and in my care and custody on March 13, 2012.

LaVonne Griffin-Valade
Auditor of the City of Portland
By *[Signature]*
Deputy

5

ORDINANCE No. 185178

*Authorize the naming of a segment of street located between SE 99th Ave and SE 100th Ave as SE Bush St (Ordinance)

The City of Portland ordains:

Section 1. The Council finds:

1. The City of Portland (City) is expanding its Emergency Coordination Center (ECC) located at the Bureau of Emergency Communication's 9-1-1 Call Center Facility at 9911 SE Bush Street.
2. The expansion consists of the consolidation of the existing ECC site with parcels purchased by the Portland Water Bureau (PWB). This requires vacating a portion of SE Bush Street between SE 99th Avenue and SE 100th Avenue and relocating SE Bush Street to the south as depicted on Exhibit A attached hereto.
3. City Council passed Ordinance No. 184102 on September 8, 2010 at the request of the PWB designating the property for the relocation of SE Bush Street as public right-of-way and assigning it to the Bureau of Transportation.
4. It was recently discovered that Ordinance No. 184102 did not direct Council to assign the name of SE Bush Street to the newly created street, thereby leaving the street segment unnamed.
5. It is now necessary to assign the name of SE Bush Street to the unnamed segment of street.
6. There are minimal costs for staff time associated with drafting and processing this Ordinance, likely not exceeding \$1,000. Funds are available in the Water Fund 7TRWA0000495 FY 2011/12.
7. The proposal complies with the procedures and requirements established in Title 17, Chapter 17.92 Street Designation.

NOW, THEREFORE, the Council directs:

- a. That the unnamed street segment between SE 99th Avenue and SE 100th Avenue described below is hereby named SE Bush Street.

As described on Exhibit A and depicted on Exhibit B attached hereto and by this reference made a part hereof.

- b. That the Auditor shall return a certified copy of this Ordinance to the Right-of-Way Acquisition Section, Bureau of Transportation, for recording in the Multnomah County Deed Records; Right-of-Way Acquisition shall return the recorded Ordinance to the Auditor.
- c. The Bureau of Transportation will work with Multnomah County to change County tax records to reflect the street name and will notify public agencies, the US Post Office and emergency service organizations.

Section 2. The Council declares that an emergency exists because a delay would extend the possibility for confusion in locating properties in the area impacted by the street not being named; therefore, this Ordinance shall be in full force and effect from and after its passage by the Council.

Passed by the Council, MAR 07 2012

Mayor Sam Adams
Prepared by: Lance D. Lindahl:slg
February 10, 2012
RWA # 7420

LAVONNE GRIFFIN-VALADE
Auditor of the City of Portland
By

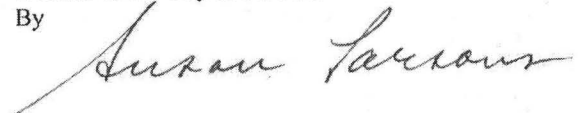

DEPUTY

EXHIBIT A

185178

EMERGENCY COMMUNICATIONS CENTER
JOB NO. 309228
MAY 12, 2010

LEGAL DESCRIPTION

A PARCEL OF LAND BEING ALL OF PARCEL 1 OF PARTITION PLAT NO. 2007-145, LOT 15 AND A PORTION OF LOT 14 OF LILY TRACT, AND A PORTION OF LOT 7 OF BETT'S PARK, MULTNOMAH COUNTY PLAT RECORDS, LYING WITHIN THE SOUTHEAST ONE-QUARTER OF SECTION 9, TOWNSHIP 1 SOUTH, RANGE 2 EAST, OF THE WILLAMETTE MERIDIAN, CITY OF PORTLAND, MULTNOMAH COUNTY, OREGON, BEING MORE PARTICULARLY DESCRIBED AS FOLLOWS:

BEGINNING AT THE SOUTHEAST CORNER OF SAID PARCEL 1, SAID POINT ALSO BEING ON THE WESTERLY RIGHT-OF-WAY LINE OF SE 100TH AVENUE (50 FEET WIDE); THENCE LEAVING SAID WESTERLY RIGHT-OF-WAY LINE ALONG THE SOUTHERLY LINE OF SAID PARCEL 1 NORTH 90°00'00" WEST 114.74 FEET TO THE EASTERLY LINE OF SAID LOT 15; THENCE ALONG SAID EASTERLY LINE SOUTH 00°00'00" WEST 16.26 FEET TO THE SOUTHERLY LINE OF SAID LOT 15; THENCE ALONG SAID SOUTHERLY LINE NORTH 88°11'18" WEST 118.51 FEET TO THE EASTERLY RIGHT-OF-WAY LINE OF SE 99TH AVENUE (50 FEET WIDE); THENCE ALONG SAID EASTERLY RIGHT-OF-WAY LINE NORTH 00°05'34" EAST 68.51 FEET; THENCE LEAVING SAID EASTERLY RIGHT-OF-WAY LINE SOUTH 90°00'00" EAST 233.08 FEET TO SAID WESTERLY RIGHT-OF-WAY LINE OF SE 100TH AVENUE; THENCE ALONG SAID WESTERLY RIGHT-OF-WAY LINE SOUTH 00°00'00" WEST 56.00 FEET TO THE POINT OF BEGINNING.

CONTAINING 14,758 SQUARE FEET OR 0.339 ACRES, MORE OR LESS.

THE DEDICATION AREA IS SHOWN ON THE ATTACHED EXHIBIT B AND BY THIS REFERENCE MADE A PART THEREOF.

THE BASIS OF BEARINGS FOR THIS DESCRIPTION IS THE CENTERLINE OF SE 100TH AVENUE, AS SHOWN HEREON AS SOUTH 00°00'00" WEST, PER SAID PARTITION PLAT NO. 2007-145.

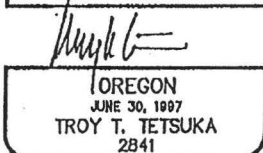
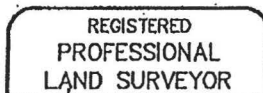

RENEWAL DATE 6-30-10

