

GBD

APPENDIX A

# MATERIALS AND PHOTOS

*Block 37 Apartments*  
*February 14, 2014*





# CONTEXT PHOTOS



# CONTEXT PHOTOS



Looking xxxxx over site



Looking xxxxx over site



on, United States

Looking xxxxx Over Site



way, Portland, Oregon, United States

Looking towards xxxxxx

# SITE PHOTOS



Garage Door



Brick



Metal Panel – Wood



Skycore

Metal Panel – White

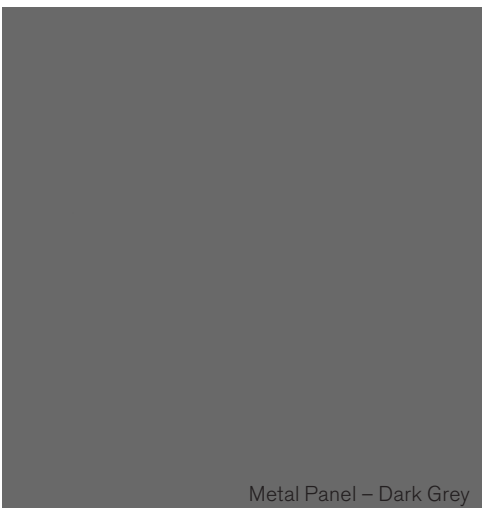

Metal Panel – Dark Grey

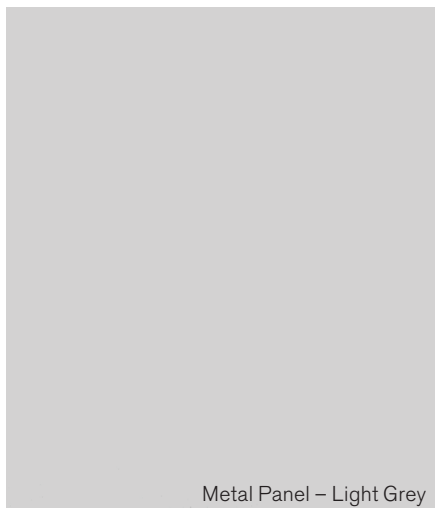

Metal Panel – Light Grey



Stucco

# FACADE MATERIALS



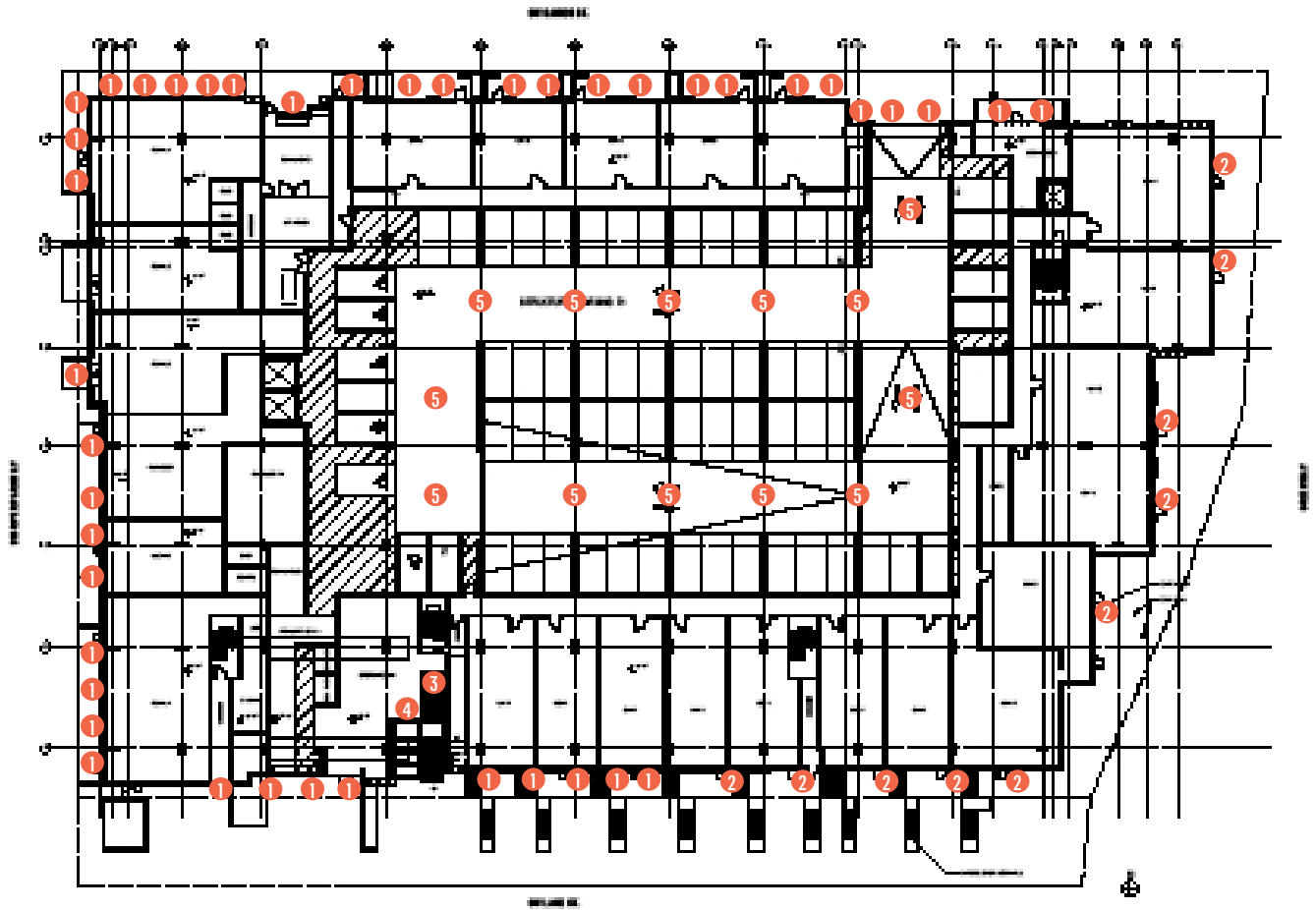

1 Exterior Downlight



4 Fountain Light



2 Entry Light



5 Garage Light



3 Step Light



6 Low Wall Light

GROUND FLOOR

LIGHTING PLAN





1 Exterior Downlight



4 Fountain Light



2 Entry Light



5 Garage Light



3 Step Light



6 Low Wall Light

SECOND FLOOR

LIGHTING PLAN

# HH4SQPL

## 4" Architectural Square CFL Downlight

Architectural

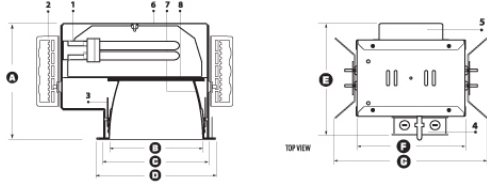

- A. Height = 5-3/4"
- B. Trim Aperture = 4-1/2"
- C. Cut-out = 5-1/8"
- D. Trim Outside Diameter = 5-3/4"
- E. Width = 9"
- F. Length = 7-1/8"
- G. Max. Length = 10"

Catalog Number:	
Project Name:	Type:
Note:	<b>MAXILUME</b> ARCHITECTURAL LIGHTING

**DESCRIPTION**

- 1. LAMP HOLDER** - Lamp holder effectively provides heat dissipation and ventilation. Unitized optics guarantees proper trim to housing installation. Tool-less installation adjustability from either outside the housing or inside the housing.
- 2. MOUNTING BRACKET** - Constructed from 16-gauge steel. Can be installed with 3/4" or 1-1/2" lathing channel, 1/2" EMT, or with optional C-channel mounting bars (Part# BP31) ordered separately. Housing can be adjusted from the inside of the ceiling.
- 3. RETAINING SPRINGS** - Precision tooled springs secure trim to mounting frame, for effortless and tool-less installation.
- 4. JUNCTION BOX** - UL and ETL listed for through-branch circuit wiring and has four 1/2" KO's, one 3/4" KO and four Romex knockouts with pry-out slots and strain clamps. Junction Box is accessible from below, no tools required.
- 5. BALLAST** - Ballast is accessible from below, no tools required. Ballast supplied is manufactured by Philips Advance, Universal Technologies or Lutron Electronics.
- 6. MOUNTING FRAME** - Die-formed construction for maximum heat dissipation and rust protection.

**OPTICS**

- 7. REFLECTOR** - Self-flanged .050" aluminum reflector with low iridescent finish. Reflector provides 45-degree lamp-to-reflector image cutoff.
- 8. LENS** - Choice of either tempered clear, tempered prismatic or tempered frosted lens fastened with two torsion springs for easy re-lamping. ETL/UL listed for wet or damp location.

**LISTING**

ETL/UL listed for through-branch circuit wiring and damp locations. Wet location only with lens trims.



Energy Star Qualified Models:	
	<ul style="list-style-type: none"> <li>• HH4SQPL-1X13-S-120</li> <li>• HH4SQPL-1X18-S-120</li> <li>• HH4SQPL-1X26-S-120</li> </ul>

LAMP BASE GUIDE (Sockets will accept all designated lamp bases listed.)						
13W	18W	26W	32W	42W	57W	70W
G24q-1 GX24q-1	G24q-2 GX24q-2	<b>G24q-3</b> <b>GX24q-3</b> GX24q-4	<b>GX24q-3</b> GX24q-4	GX24q-4	GX24q-5	GX24q-6

**HH4SQPL - ITEM SELECTOR:** (Please check the boxes below for the option desired)

WATTAGE	BALLAST	VOLTAGE	EMERGENCY OPTIONS	TRIM TYPE & DESCRIPTION	REFLECTOR
<input checked="" type="checkbox"/> 1X13 <input type="checkbox"/> 1X18 <input type="checkbox"/> 1X26 <input type="checkbox"/> 1X32	<input type="checkbox"/> (E) Electronic <input checked="" type="checkbox"/> (S) Energy Star <sup>2</sup>  <b>DIMMING</b> <input type="checkbox"/> Mark 7 <sup>3</sup> <input type="checkbox"/> Mark 10 <sup>4</sup> <input type="checkbox"/> Lut-E (EC3D) <sup>5</sup>	<input type="checkbox"/> MVOLT (120/277) <input checked="" type="checkbox"/> 120 <input type="checkbox"/> 277	<input type="checkbox"/> EMG 750 (750 Lumens) <sup>6</sup> <input type="checkbox"/> EMG 1300 (1300 Lumens) <sup>6</sup> <input type="checkbox"/> INTG 750 (750 Lumens) <sup>7</sup> <input type="checkbox"/> INTG 1300 (1300 Lumens) <sup>7</sup> <input type="checkbox"/> EMG-D-750 (750 Lumens) <sup>8</sup> <input type="checkbox"/> ESD-130 (1300 Lumens) <sup>13</sup> <input type="checkbox"/> ICE-1300 (1300 Lumens) <sup>10</sup>  <b>OTHER OPTIONS</b> <input type="checkbox"/> FUSE <sup>11</sup> <input type="checkbox"/> RIF <sup>12</sup> <input type="checkbox"/> BP31 (24" C-Channel Bar Hangers)	<input type="checkbox"/> 4601 <input type="checkbox"/> 4604 <input type="checkbox"/> 4607 <input type="checkbox"/> 4614 <input type="checkbox"/> 4615	<input type="checkbox"/> CL <input type="checkbox"/> SCH <sup>**</sup> <input type="checkbox"/> SHZ <sup>**</sup> <input type="checkbox"/> WT <input type="checkbox"/> W <input type="checkbox"/> MB

<sup>1</sup> - (M) Magnetic = Available in 9W, 13W, 18W & 26W fixtures only • <sup>2</sup> - (S) Energy Star = Available on selected fixtures only, please see list above • <sup>3</sup> - MARK 7 = Not available in 9W, 13W, 57W, 70W • <sup>4</sup> - MARK 10 = Not available in 9W, 13W, 57W, 70W, must specify voltage • <sup>5</sup> - LUT-E (EC3D) = Not available in 9W, 13W, 57W, 70W • <sup>6</sup> - EMG = Emergency battery pack w/ remote test switch • <sup>7</sup> - INTG = Emergency battery pack w/ integral (reflector) test switch • <sup>8</sup> - EMG-D = Emergency battery pack w/ remote test switch for damp location • <sup>9</sup> - INTG-D = Emergency battery pack w/ integral/reflector test switch for damp location • <sup>10</sup> - ICE = Emergency battery pack w/ remote test switch operating between -18°C and 55°C • <sup>11</sup> - FUSE = Single slow-blow fuse • <sup>12</sup> - RIF = Radio interference filter • <sup>13</sup> - ESD = Emergency self-diagnostic

**Specifications:**

HH4SQPL    1X13    S    120    \_\_\_\_\_    \_\_\_\_\_    \_\_\_\_\_    \_\_\_\_\_

WATT    BALLAST    VOLTAGE    EMERGENCY    OPTIONS    TRIM TYPE    REFLECTOR    RING

Sample of Catalog Number: HH4SQPL-1X32-E-MVOLT-EMG750-4601-CL-WH

REFLECTOR	RING
CL Clear	WH Self-Flange White
SHZ Satin Haze (Low Iridescent)	Standard on all trims
WT Wheat	
MB Black	
W White	

\*For custom jaffle, reflector, trim ring, glass color and lens options, please consult factory.



A division of  
**Elite Lighting**

Submital form is available @ [www.maxilume.com](http://www.maxilume.com)  
Tel: 323-888-1973 • Fax: 323-888-1977

Specifications and Dimensions subject to change without notice.

MAX-SPEC5 2011-03-08

# EXTERIOR DOWNLIGHT

# F+P Wall LED

F-P WALL LED

PRODUCT SPECIFICATION

## Product description

Weblink: 2720

Design: Foster &amp; Partners

Light Concept: The fixture emits a symmetrical downlight. The opal cone ensures an even and diffuse light, free from obtrusive glare. The light emitted through the cone helps reducing the contrasts. The polished edges of the cylinder glow and hence clarify the shape of the fixture.

Finish: White, natural painted aluminum or graphite grey, powder coated.

Material: Housing: Die cast aluminum. Enclosure: Extruded clear acrylic with polished edges.

Mounting: Surface: Mounted directly to finished surface over a recessed 4" octagonal junction box.

Weight: Max. 2 lbs.

Label: cULus, Wet location. IBEW.

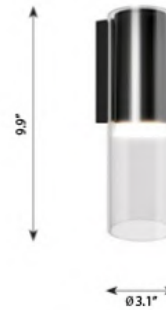

Product code	Light source	Voltage	Finish
F+P-W	7W LED/3000K 7W LED/4000K	120V	GRAPH NAT PAINT ALU WHT

a. Provided with one 120V integral electronic driver.  
b. All LED wattages are system power.

I. The comparable EU version has the following classification: Ingress Protection Code: IP44.  
II. LED technology is rapidly changing. Specifications are based on present technology. For most up to date specifications see [www.louispoulsen.com](http://www.louispoulsen.com).

# F+P Wall LED

F-P WALL LED

PRODUCT SPECIFICATION

## Material description

### NOTES:

LED TECHNOLOGY IS RAPIDLY CHANGING. LEDS ARE MADE IN LOTS AND SORTED INTO BINS BASED ON WAVELENGTHS RANGES THAT ACHIEVE COLORS. PRODUCTS ORDERED AT DIFFERENT TIMES MAY NOT HAVE THE SAME COLOR APPEARANCE

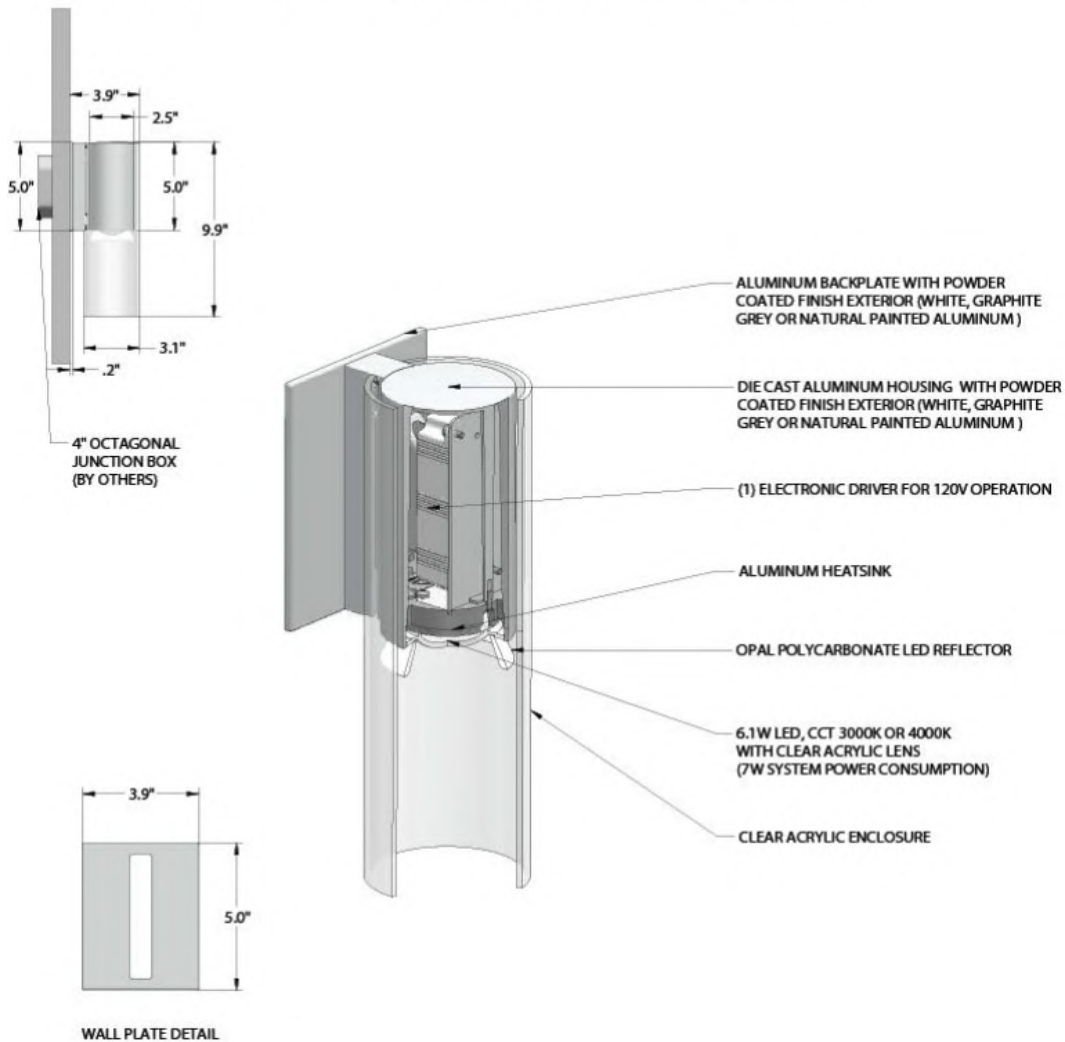

**louis  
poulsen**

Louis Poulsen Lighting | 3260 Meridian Parkway | Fort Lauderdale | FL 33331 | PH:954-349-2525 | Fax: 954-349-2550 | louispoulsen.com

2/3

# ENTRY LIGHT, OPTION 1

# F+P Wall LED

F-P WALL LED

PRODUCT SPECIFICATION

## Light measurements

Photometric Report: F&P WALL LED L7713A,IES  
 Report No.: L7713A  
 Poulsen Report No.: F&P WALL LED L7713A  
 Luminaire: F&P WALL  
 Lamp: 7W LED

Description: All data shown are per 352 lumens. This report can be used for calculation on all versions listed below. Use only actual lumen data calculating.

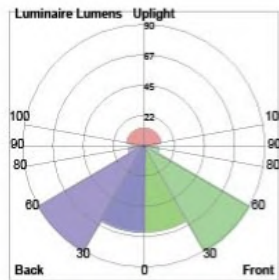
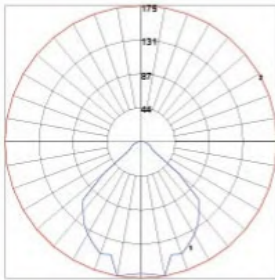

Candlepower Distribution	
Vertical Angle	Candela
0	168.7
5	170.6
10	174.5
25	144.7
40	115.8
55	10.2
70	11.4
85	4.9
90	3.8
120	2.8
150	1.5
180	0.4

### LUMINAIRE CLASSIFICATION SYSTEM (LCS)

	Lumens	% Lamp	% Luminaire
FL - Front-Low (0-30)	63.7	18.1	18.1
FM - Front-Medium (30-60)	90.0	25.6	25.6
FH - Front-High (60-80)	11.3	3.2	3.2
FVH - Front-Very High (80-90)	2.8	0.8	0.8
BL - Back-Low (0-30)	63.7	18.1	18.1
BM - Back-Medium (30-60)	90.0	25.6	25.6
BH - Back-High (60-80)	11.3	3.2	3.2
BVH - Back-Very High (80-90)	2.8	0.8	0.8
UL - Uplight-Low (90-100)	3.9	1.1	1.1
UH - Uplight-High (100-180)	12.5	3.5	3.5
Total	352.0	100.0	100.0
BUG Rating	B0-U2-G0		



Louis Poulsen Lighting | 3260 Meridian Parkway | Fort Lauderdale | FL 33331 | PH:954-349-2525 | Fax: 954-349-2550 | louispoulsen.com

3/3

# ENTRY LIGHT, OPTION 1



Job : \_\_\_\_\_ **Project**

Type : \_\_\_\_\_

Part # : \_\_\_\_\_

# CORE 300 LX sconce up + down

## Specifications

- Source Two Xicato XSM modules - 400, 700, 1000, or 1300 lumens each
- C.C.T. 2700K, 3000K, 3500K or 4000K
- Color Consistency CCT +/- 50K, Duv +/- .001, 1x2 step MacAdam (1 x 2 SDCM) along BBL
- CRI (Ra) ≥80 or ≥ 95
- CRI Consistency +3/-0 points
- LED Driver Remote mount
- Power 14 to 40 watts max, depending on LED module combination / driver
- Reflector High efficiency 20°, 20°, 40° or 60° - field replaceable without tools
- Material CNC machined aluminum with stainless steel hardware
- Finish Powder coat - TGIC polyester for exterior and interior use
- Weight 5 lb. [2.3 kg]
- Location Listed for Wet Locations, IP66
- Approvals ETL listed. Conforms to UL Standards 2108, 8750 and CSA C22.2#250.0
- L70 Life > 50,000 hours at 70% lumen maintenance based on IESNA LM-80-08
- Warranty Lifetime Limited Warranty - see warranty for details
- IES Files LM-79-08 IES files available at www.v2LightingGroup.com
- Modifications Any modification or customization is possible - consult factory

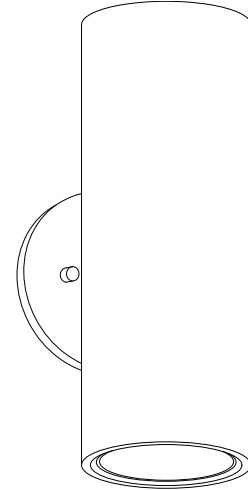

## Ordering Logic

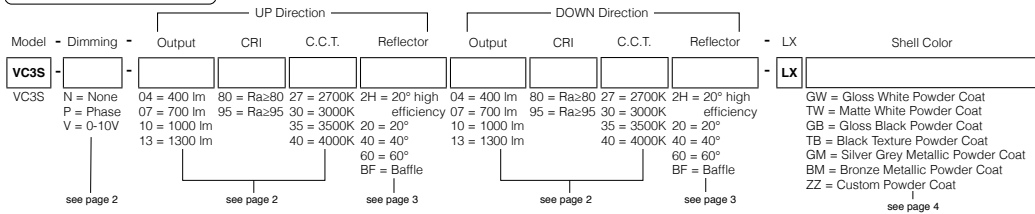

## Dimensions

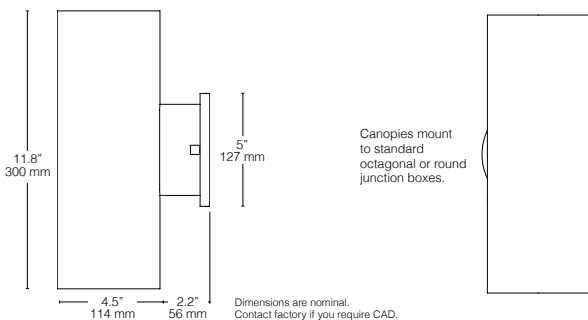

www.v2LightingGroup.com

rev130224 © 2013 v2 Lighting Group, Inc. Specifications subject to change without notice. Page 1

# ENTRY LIGHT, OPTION 2



Job : \_\_\_\_\_ **Project**

Type : \_\_\_\_\_

Part # : \_\_\_\_\_

# CORE 300 LX sconce up + down

**LED Options**

Use the chart below to select an LED.  
 Use the resulting 6-number order code in the Output, CRI and CCT boxes in the "Ordering Logic" section on Page 1.

LED Specifications			Order Codes				Dimming Options		
Lumens	CRI	Wattage*	2700 K	3000 K	3500 K	4000 K	non-dim	phase / triac	0-10V
400	≥80	5.7	04 80 27	04 80 30	n/a	04 80 40	✓	✓	✓
700		9.7	07 80 27	07 80 30	n/a	07 80 40	✓	✓	✓
1000		13.0	10 80 27	10 80 30	10 80 35	10 80 40	✓	✓	✓
1300	≥95	17.8	13 80 27	13 80 30	13 80 35	13 80 40	✓	✓	✓
700		13.4	07 95 27	07 95 30	n/a	07 95 40	✓	✓	✓

\*add 14% for total fixture wattage including LED Driver

Higher lumen options are available in CORE 400 series.

# ENTRY LIGHT, OPTION 2

Recessed wall luminaires with directed light

**Housing:** Constructed of die-cast and aluminum with integral wiring compartment. Mounting tabs provided.

**Enclosure:** One piece die-cast aluminum faceplate. Clear tempered glass; .125" thick, machined flush to faceplate surface. Faceplate is secured by two (2) flush, socket head, stainless steel captive screws threaded into stainless steel inserts in the housing casting. Continuous high temperature, molded silicone rubber gasket for weather tight operation.

**Electrical:** 11.2W LED luminaire, 14.5 total system watts, -30°C start temperature. Integral 120V-277 V electronic LED driver, 0 -10V dimming. The LED and driver are mounted on a removable plate for easy replacement. Standard LED color temperature is 3000K (available in 4000K; add suffix K4).

**Note:** Due to the dynamic nature of LED technology, LED luminaire data on this sheet is subject to change at the discretion of BEGA-US. For the most current technical data, please refer to [www.bega-us.com](http://www.bega-us.com).

**Finish:** Available in four standard BEGA colors: Black (BLK); White (WHT); Bronze (BRZ); Silver (SLV). To specify, add appropriate suffix to catalog number. Custom colors supplied on special order.

**UL** listed, suitable for wet locations and for installation within 3 feet of ground. IC rated. Protection class: IP65.

**Luminaire Lumens:** 342  
Tested in accordance with LM-79-08

Type:  
BEGA Product:  
Project:  
Voltage:  
Color:  
Options:  
Modified:



	Lamp	A	B	C
<b>2384 LED</b>	ADA 11.2W LED	12½	2¾	2½



**BEGA-US** 1000 BEGA Way, Carpinteria, CA 93013 (805) 684-0533 FAX (805) 566-9474 [www.bega-us.com](http://www.bega-us.com)  
©copyright BEGA-US 2011 Updated 10/12

# STEP/FOUNTAIN/LOW WALL LIGHT





# Specialized Lighting Solutions, Inc.

## LINDA TRANSPARENT DIRECT-INDIRECT DISTRIBUTION

**LINDA TRANSPARENT:** For use in car-parks or environments where indirect ceiling and diffused direct lighting is required to supply uniform illumination.

**MECHANICAL CHARACTERISTICS:**

- **Transparent** housing in self-extinguishing injection molded UV stabilized Polycarbonate.
- **Gasket** :Molded one piece injected long life sealing foam gasket provides.
- **IP65** watertight seal.
- **Diffuser: Transparent** Self-extinguishing injection molded polycarbonate, UV stabilized, with smooth external surface and differentiated prismatic internal surface.
- **Gear-tray reflector unit:** reduced width for a greater indirect distribution, in hot galvanized steel, pained in white polyester, fixed to the housing by means of snap-lock devices in steel. Hinged opening for simple maintenance and installation.
- **Snug fit snap-lock clips**, in *stainless steel*, for diffuser's mounting, vandal-proof opening.

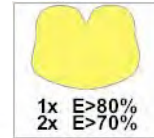

**Installation:**

Linda offers **quick** and **safe** installation with various types of fixings. The Luminaries are supplied with two types of mounting devices:



**Ceiling:**  
Provided with Pair of metal brackets supplied for quick installation.



**Suspended:**  
Hook or chain mounting. Provided with a Pair of steel springs supplied for quick install



**Features:**

- **REFLECTORS**  
A selection of optional easy to install reflectors for a variety of applications. (See pages 3-4).

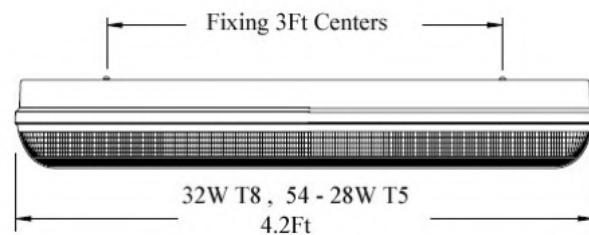
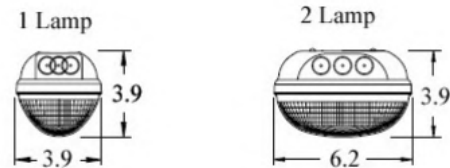

**ORDERING DETAILS:** (DESCRIPTION)

- 3F LINDA TRANSPARENT 1x32 T8
- 3F LINDA TRANSPARENT 2x32 T8
- 3F LINDA TRANSPARENT 1x28 T5
- 3F LINDA TRANSPARENT 2x28 T5
- 3F LINDA TRANSPARENT 1x54 T5
- 3F LINDA TRANSPARENT 2x54 T5

ORDERING NUMBER

- SLS-LTR-1x32W-T8-xx
- SLS-LTR-2x32W-T8-xx
- SLS-LTR-1x28W-T5-xx
- SLS-LTR-2x28W-T5-xx
- SLS-LTR-1x54W-T5-xx
- SLS-LTR-2x54W-T5-xx

OPTIONS

**EBP-Emergency Battery Pack (Consult Factory)**  
**Reflector Options:**  
(16MRA, 16RTA, 16NBH, 16FGP, 16REC, 16TLS, 16QST, 16THO, 16UCL, 16GDM, 16ZOQ, 16NQE)

[www.slsnw.com](http://www.slsnw.com)

640 NW Silverado Drive, Beaverton OR 97006 Tel: 503-530-8908 Fax: 503-531-0711

# GARAGE LIGHT



# Specialized Lighting Solutions, Inc.

LINDA TRANSPARENT DIRECT-INDIRECT DISTRIBUTION

## Reflector Accessories

By using **Parabolic Asymmetric Reflector** in high-reflectance aluminum for T8 lamps and for T5 lamps, the luminaries' luminous efficiency is increased thus optimizing illumination **in the usable working area** and allowing a consequent saving in energy and operating costs.

### Wide reflectors

Application in rooms with **height range from 9 to 18 feet.**

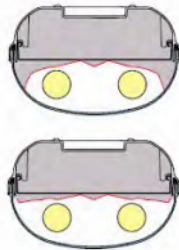

### Concentrated reflectors

Application in rooms with height **exceeding 12 feet** or where **higher quality illumination** is required.

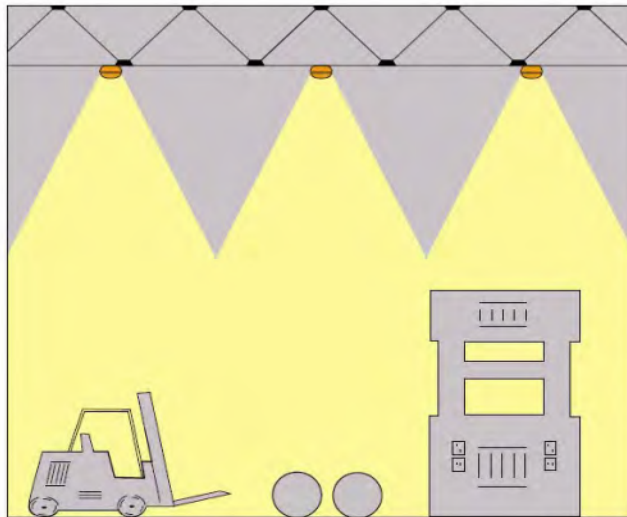
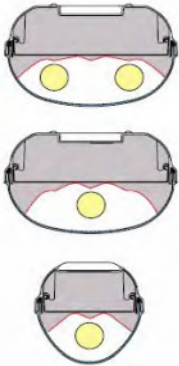

### Asymmetric reflectors

Application in rooms where there is a need for **precise focusing of the luminous flow** on the working area.

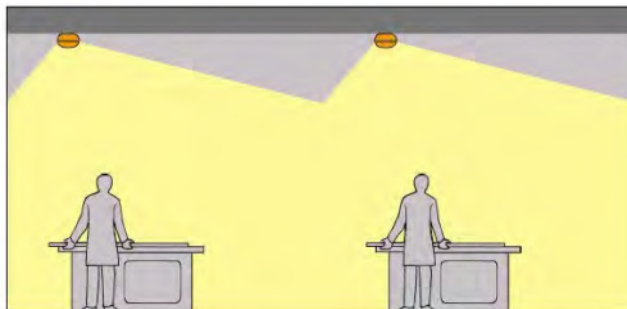
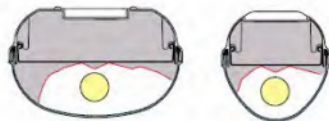

[www.slsnw.com](http://www.slsnw.com)

640 NW Silverado Drive, Beaverton OR 97006 Tel: 503-530-8908 Fax: 503-531-0711

# GARAGE LIGHT



# Specialized Lighting Solutions, Inc.

## LINDA TRANSPARENT DIRECT-INDIRECT DISTRIBUTION

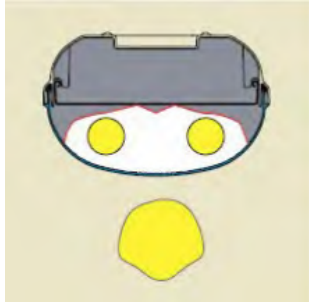

Parabolic flow reflector **wide** direct distribution, for luminaires 6 inches wide.

Luminaire	Reflector Code
2x32 T8	16 MRA
2x28 T5HE	16 RTA
2X54 T5HO	16 RTA

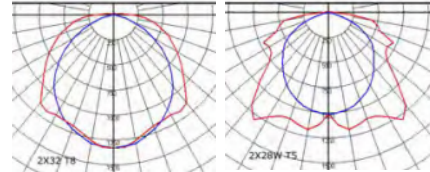

IES File No.

5020166 - 3F Linda 2x32+16MRA

5020666 - 3F Linda 2x28 T5 HF+16RTA

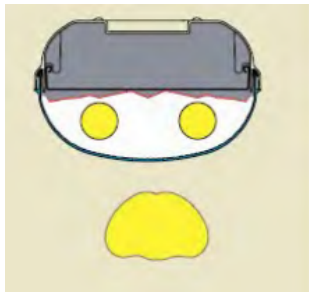

Parabolic flow reflector **super-wide** direct distribution, for luminaires 6 inches wide.

Luminaire	Reflector Code
2x32 T8	16 NBH
2x28 T5HE	16 FGP
2X54 T5HO	16 FGP

IES File No.

- 3F Linda 2x32+16NBH

- 3F Linda 2x28 T5 HF+16FGP

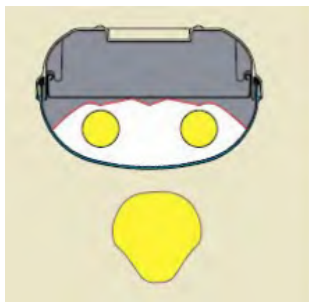

Parabolic flow reflector **concentrated** direct distribution, for luminaires 6 inches wide.

Luminaire	Reflector Code
2x32 T8	16 REC
2x28 T5HE	16 TLS
2X54 T5HO	16 TLS

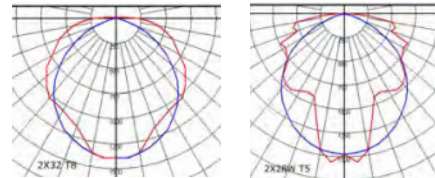

IES File No.

5010165 - 3F Linda 2x32+16REC

5020667 - 3F Linda 2x28 T5 HF+16TLS

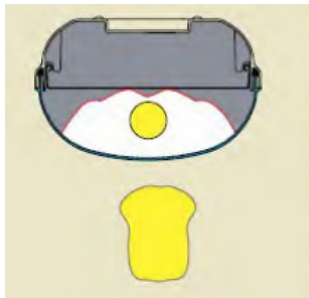

Parabolic flow reflector **concentrated** direct distribution, for luminaires 6 inches wide.

Luminaire	Reflector Code
1x32 T8	16 QST
1X54 T5HO	16 QST

IES File No.

- 3F Linda 1x32+16QST

[www.slsnw.com](http://www.slsnw.com)

640 NW Silverado Drive, Beaverton OR 97006 Tel: 503-530-8908 Fax: 503-531-0711

# GARAGE LIGHT



## An affordable solution for equipment screening is finally here...

Envisor equipment screens now offer architects the flexibility to create affordable, elegant, **customized screening solutions** that integrate with their building design, all with **no rooftop penetration**.

Our patented equipment screens also provide a viable solution for **municipal screening code requirements** on everything from HVAC units to



The Ohio State University Foundation - Columbus, Ohio

chillers, air handlers, power exhausts, roof stacks, communication equipment, dumpsters - you name it!

## Customizing a screen to fit your needs is easy...

Simply choose between canted or vertical, decide on a panel design, select a top trim (optional), and pick a color. It's that simple! **We can customize any feature** to your particular design requirements, including custom panel designs, custom colors, and custom top trim designs. If you don't see what you need, tell us what you want. We'll build it for you.



52" Louver Panels

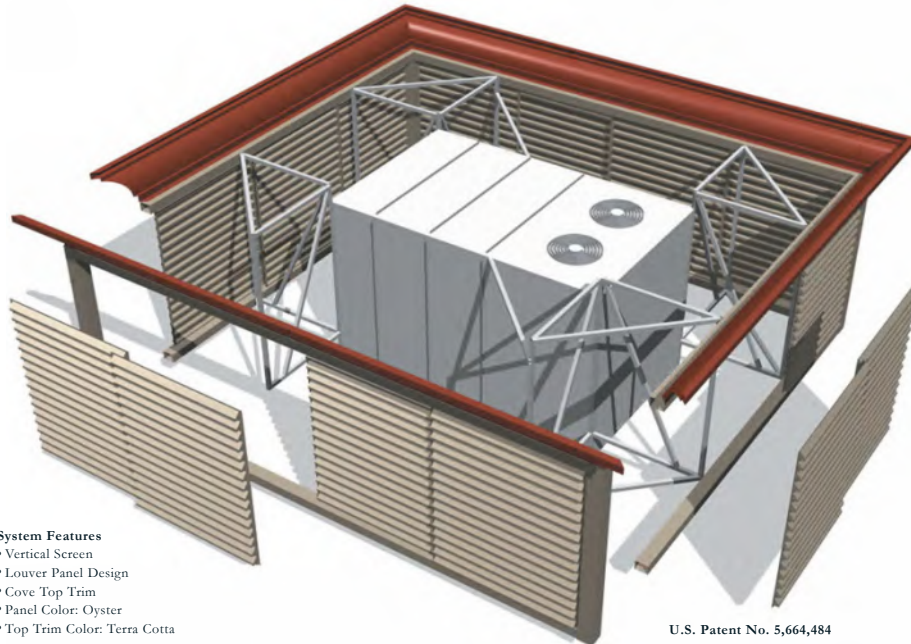

**System Features**

- Vertical Screen
- Louver Panel Design
- Cove Top Trim
- Panel Color: Oyster
- Top Trim Color: Terra Cotta

U.S. Patent No. 5,664,484

[www.cityscapesinc.com](http://www.cityscapesinc.com)

# MECHANICAL EQUIPMENT SCREEN

## Step 1: Choose a Canted or Vertical System



Envisor screens are the perfect alternative to parapet walls and they satisfy even the strictest screening code requirements. Both styles feature our patented attachment method, which secure our screens directly to the equipment with no rooftop penetration. Screen heights are available to screen virtually anything you desire.

## Step 2: Decide on a Panel Design

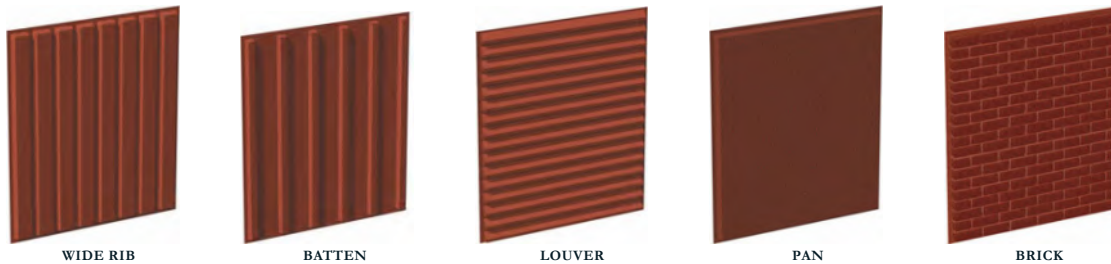

Panels are available in **5 standard styles** allowing you to control the project without sacrificing the essential elements of the building design. The panels are constructed of thermoformed high impact ABS with a **co-extruded UV protective layer** on both sides. The panels are held firmly in place using a rust-free, double tracked aluminum rail system. This enables the panels to slide side-to-side for easy access to the unit during servicing and maintenance. Don't see a panel that fits your project? Tell us and we'll make one that you design.

## Step 3: Select a Top Trim (optional)

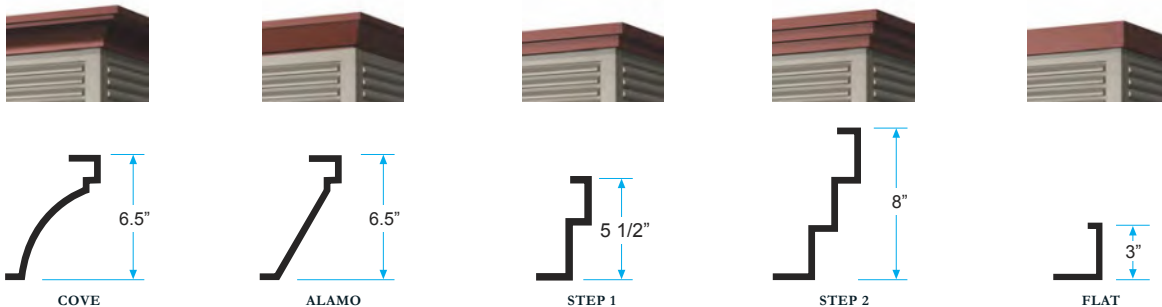

Decorative top trim options offer the flexibility to further customize the elegant appearance of the screens by **picking up on your building design elements** and incorporating those details into the screen itself. Although optional, they offer one more way to make screens part of the design, not part of the problem. We can manufacture any size and shape top trim you create.

[www.cityscapesinc.com](http://www.cityscapesinc.com)

# MECHANICAL EQUIPMENT SCREEN



# MECHANICAL EQUIPMENT SCREEN



Phone: (206) 324-9101  
Toll-Free: (800) 561-6765  
Fax: (206) 324-9104  
E-mail: [info@davisdoor.com](mailto:info@davisdoor.com)

[Home](#) | [About Us](#) | [Product Gallery](#) | [Services](#) | [Contact Us](#)

### Commercial Only

[Check out our new slideshow presentation of our vertical lift gates!](#)

*Keeping you on track since 1959!*



Davis Door Service is an extended family of professional men and women dedicated to providing quality, **commercial** overhead and **commercial** pedestrian door sales, installation, maintenance, and repair. Since 1959, we have provided the Pacific Northwest with responsive service and quality products at a fair price and honest value  
... satisfaction guaranteed.

[Home](#) | [About Us](#) | [Product Gallery](#) | [Services](#) | [Contact Us](#)  
Copyright 2009 Davis Door Service



Phone: (206) 324-9101  
Toll-Free: (800) 561-6765  
Fax: (206) 324-9104  
E-mail: [info@davisdoor.com](mailto:info@davisdoor.com)

[Home](#) | [About Us](#) | [Product Gallery](#) | [Services](#) | [Contact Us](#)

### Commercial Only

[Check out our new slideshow presentation of our vertical lift gates!](#)

*Keeping you on track since 1959!*



Davis Door Service is an extended family of professional men and women dedicated to providing quality, **commercial** overhead and **commercial** pedestrian door sales, installation, maintenance, and repair. Since 1959, we have provided the Pacific Northwest with responsive service and quality products at a fair price and honest value  
... satisfaction guaranteed.

[Home](#) | [About Us](#) | [Product Gallery](#) | [Services](#) | [Contact Us](#)  
Copyright 2009 Davis Door Service

# GARAGE DOOR

