

5610 SE 115TH AVE  
12-113671-000-00-RS

3151591

Residential 1 & 2 Family Permit  
Issued: 6/12/12

City of Portland BDS

INSPECTION REPORT

Single Family Dwelling/Addition

Occupancy: R-3, R-3, U

Const. Type: V-B V-B V-B

IVR Number: 3151591

Inspection Code: 842

Inspection:

EC1 EC3 VM

842 Decommission System (Pumped & Filled) (503) 519-5258

Call Date/Time: 6/12/2012 14:12:13 Requested Date/Time: 6/13/12 AM

SINGLE STORY 140 SF  
ADDITION AT REAR. NEW  
FAMILY ROOM AND BATHROOM  
(2 TOTAL IN HOUSE AFTER  
REMODEL)/PRESCRIPTIVE\*\*\*CE  
DECOM REQ'D PRIOR TO  
FOUNDATION\*\*\*\*\* EMick  
4/11/12

Applicant:  
TERRY HELLEM  
PROJECTIVE BUILDING  
DESIGNS  
Work: (503) 270-6128  
  
Owner:  
STANLEY MANDZIJ

Applicant:  
TERRY HELLEM  
PROJECTIVE BUILDING  
DESIGNS  
Work: (503) 270-6128  
  
Owner:  
STANLEY MANDZIJ

INSPECTION MEMO:  
CP decom prior to foundation.  
EMick 4/11/12

Valuation at Issuance: 35000  
Code Edition: 2011 ORSC  
Square Footage - Occ 1: 142  
Square Footage - Occ 2: 266  
Occupancy Group 3 - RS:  
U\_Decks, Patios, Porches,  
Carports Square Footage -  
Occ 3: 236 Construction Type  
4: Total Square Footage -  
Display Only: 644 Number of  
Stories: 1 Decommission  
Permit Required Energy Code  
Edition: 2010 Oregon Energy  
Efficiency Specialty Code  
(OEESC) Zoning Enforcement  
Agency: Portland Table-based  
Construction Val Adj - Display  
Only: 6885 Final adj to ICC  
Value reason - Display Only:  
Final overrides ICC-based Value  
100-Year Floodplain Water  
District: City of Portland Water  
Bureau GIS Update Flag 1:  
02/17/12 GIS Update Flag 2:  
02/17/12 School District:  
DAVID DOUGLAS 1st Branch  
Circuit w/o Svc or Fdr: 1 Each  
Add. Branch Circuit w/o Svc or  
Fdr: 2 Single-Duct Exhaust  
(Bath/Toilet/Util): 1 # of  
Fixtures: 4

Most Recent Inspections:

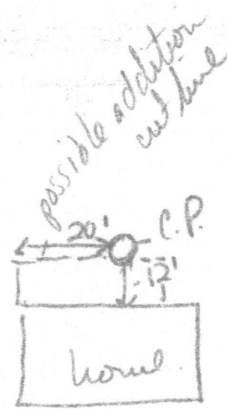

SE 115th

1	Approved
2	Partially Approved
3	Approved with Corrections
4	Rollover/Missed
5	Not Approved
6	Consultation Completed

No Access	1
Stop Work Order Issued	2
Not Ready	3
Could Not Locate	4
See Correction Notice on Job Site	5
No Plans on Job	6
No Permit Card on Job	7
Fees Owed	8
Subcontractor Information Missing	9
Cancelled by Customer	0

Confirmation: #226677 Inspector/Date/Time/Phone: *Erin Mick 823-5471 6/13/12*

*Concrete C.P. found in back of house  
12' off east e/d edge of house. Filled  
w/ pea gravel. Looks like 2' from  
edge of new addition away from.*

*Show me plans for new addition  
to check for compaction requirements*

Decommission Fees Paid \$396.00



**PLUMBING CHECKSHEET**

Residential 1 & 2 Family Permit

Application #: **12-113671-000-00-RS**

Review Date: **April 11, 2012**

<b>To:</b> APPLICANT	<b>TERRY HELLEM PROJECTIVE BUILDING DESIGNS PO BOX 6542 BEAVERTON OR 97007</b>	Work:	503 270-6128
		Home:	503 - probuild101@gmail.com

<b>From:</b> REHS, ONSITE SANITATION , SITE DEVELOPM ENT	<b>ERIN MICK</b>	Phone:	503-823-5471
		Fax:	503 823-5433
		e-mail:	Erin.Mick@portlandoregon.gov

<b>cc:</b> OWNER	<b>STANLEY MANDZIJ 5610 SE 115TH AVE #A PORTLAND, OR 97266-3904</b>
---------------------	---

**PROJECT INFORMATION**

Street Address:	<b>5610 SE 115TH AVE</b>
Description of Work:	<b>SINGLE STORY 140 SF ADDITION AT REAR. NEW FAMILY ROOM AND BATHROOM (2 TOTAL IN HOUSE AFTER REMODEL)/PRESCRIPTIVE</b>

Based on the plans and specifications submitted, the following items appear to be missing or not in conformance with the Oregon Plumbing Specialty Code and/or other city, state, or federal requirements:

Item #	Location on plans	Code Sec.	Clarification / Correction Required
1	Site Plan	OAR 340-071-185	<p>This home was originally built with the waste water going to a cesspool in the rear of the home. The plumbing records indicate that it was not decommissioned at the time of sewer connection in 1996 by the "release letter signed" stamp. You must decommission a cesspool when building within 10' of its location, making the decommissioning a requirement prior to pouring foundation for the proposed addition. The fees of \$396 have been added and will need to be paid prior to issuance of this building permit.</p> <p>Once the permit has been issued, you will need to locate the cesspool and fill it with 3/4" minus or concrete slurry, depending on where it is in relation to your addition. If a footing is directly over it, an engineer may be necessary to ensure your addition's stability. We do not have records of the cesspool's location; only that it was likely in the back of the home due to reversal permit (meaning a change in plumbing direction), and they are 10-12' out from house in straight line with main plumbing stack coming out of the roof. If there is no basement with plumbing, then they are 3-5' below ground surface to the top, 15' deep and 3-4' in diameter. Once you have filled the cesspool to within 1' of it's top, you will call for inspection under this building permit using the</p>

5610 SE 115TH

			inspection code of 842. It must be inspected prior to backfill and prior to any further inspections for the building.
2			

To respond to this checksheet, come to Document Services (located at 1900 SW Fourth Ave., 2<sup>nd</sup> Floor, hours 8:00 a.m. - 3:00 p.m. Tuesday through Friday) and update all four sets of the originally submitted drawings. To update the drawings, you may either replace the original sheets with new sheets, or edit the originally submitted sheets. (Specific instructions for updating plans are posted in Document Services.)

Please complete the attached Checksheet Response Form and include it with your re-submittal.

If you have specific questions concerning this Checksheet, please call me at 503-823-5471. To check the status of your project, please call 503 823-7000 and select option 4. Your Plan Review Status will be faxed to you, so please be ready to provide a fax number. If you don't have a fax number you may dial 503 823-7357 to request a Plan Review Status or visit Document Services.

You may receive separate Checksheets from other City agencies that will require separate responses.

PLUMBING INSPECTION REQUEST FORM

Report: PLMINSP-REP

Address

5610 SE 115TH

ENTERED

Plbg Permit No

PLM96-52898

Status

P

PERMITTED WORK:

Number of Fixtures:	1	Water Service - Feet:	0
Number of Branches:	0	Sanitary Sewer - Feet:	0
Solar Units :	0	Storm Sewer - Feet:	0
In-Kind Water Htr :	0	Rain-Drains - Feet:	0

Date Issued

19-JUL-96

Issued By

MYK

Date Updated

19-JUL-96

Updated By

MYK

Permittee

DITCH MASTERS

Permittee Phone

503 777-8289

FIXTURES:

Water Closets	:	_____	Kitchen Sinks	:	_____	Area Drains	:	_____
Urinals	:	_____	Dishwashers	:	_____	Catch Basins	:	_____
Wash Basins	:	_____	Garb. Disposal	:	_____	Drywells	:	_____
Bathtubs	:	_____	Drink Fountain	:	_____	Soak Trench	:	_____
Showers	:	_____	2-Comp Sinks	:	_____	Interceptor	:	_____
Bidets	:	_____	3-Comp Sinks	:	_____	Sewer Caps	:	_____
Water Heaters	:	_____	Hand Sinks	:	_____	Conn. Sewer	:	_____
Clothes Washers	:	_____	Floor Sinks	:	_____	Conn. Storm	:	_____
Laundry Trays	:	_____	Bar Sinks	:	_____	Rain Drains	:	_____
Serv/Mop Sinks	:	_____	Hub Drains	:	_____	Bck Wtr Valve	:	_____
Floor Drains	:	_____	Backflow Prvtr	:	_____	Reversal	:	_____
	:	_____		:	_____		:	_____

Customer

261393

Description

Notes

REVERSAL

07/19/96 MYK

Work Location

Building Use

SF

Sewer Connect: N

Building Work

REM

Building Owner

MANDZIJ, ANNA

Remarks

INSPECTION HISTORY:

8/27/96 AM Call Reversal App w/ARR - PROPERLY SUPPORT STACKS JDS

Final Inspection:

JDS

Date:

8/27/96

617-1961

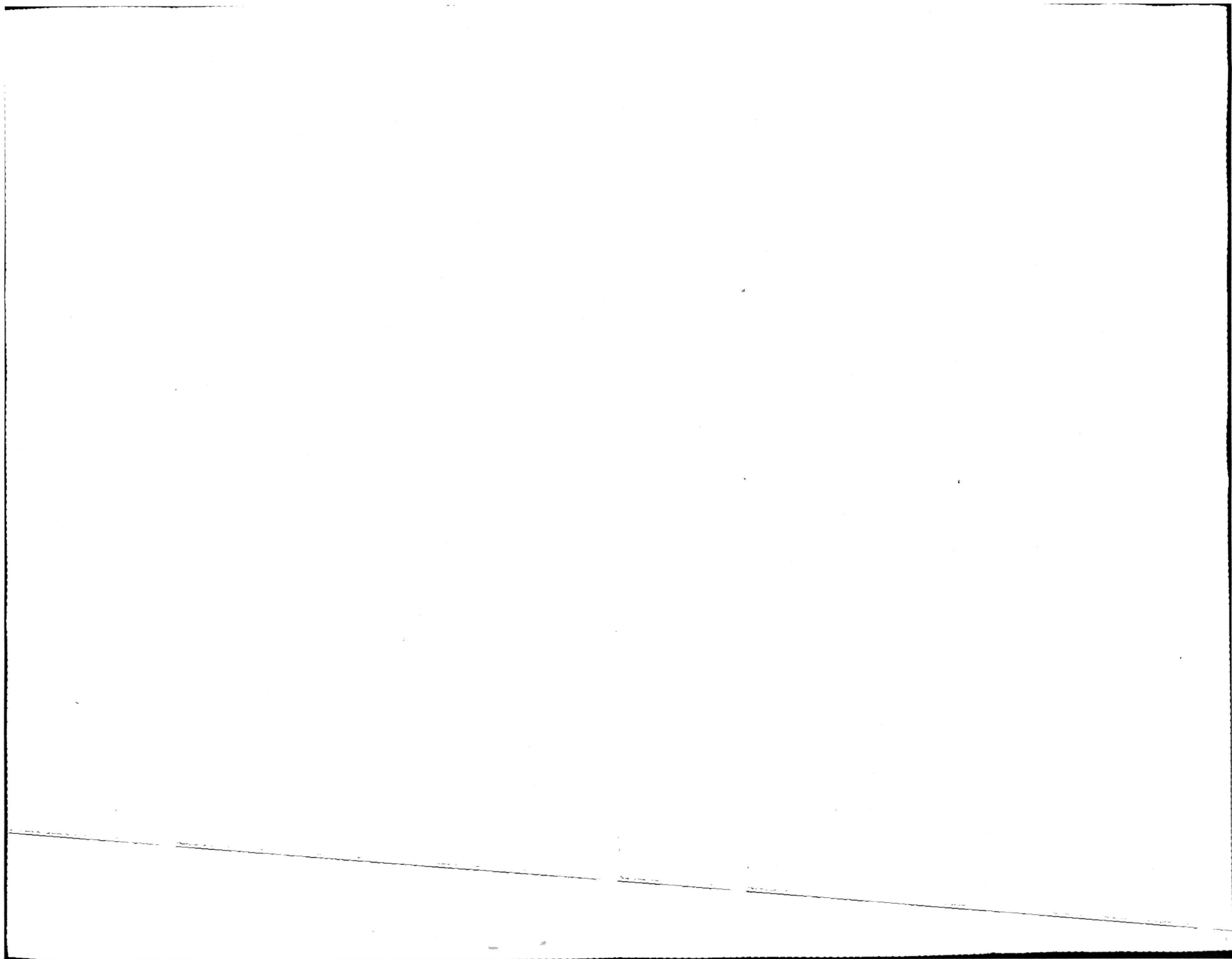

**PLUMBING INSPECTION REQUEST FORM**

Report: PLMINSP.REP

Address : 5610 SE 115TH

Plbg Permit No: **PLM96-73663** Status : I

PERMITTED WORK:

Date Issued : 19-JUL-96 Issued By :  
 Date Updated : Updated By :  
 Permittee : DITCHMASTERS PLUMBING  
 Permittee Phone: 777-8289/FAX

Number of Fixtures: Water Service - Feet:  
 Number of Branches: Sanitary Sewer - Feet: 50  
 Solar Units : Storm Sewer - Feet:  
 In-Kind Water Htr : Rain Drains - Feet:

Customer: 00963663-823=7000

FIXTURES:

Description : 305 ft. of 8" PVC Sanitary in SE 115TH AVE, at branch 6" PVC 72 ft. from MH NOR of property. Branch 28.0 ft. Long, Approx

Water Closets : _____	Kitchen Sinks : _____	Area Drains : _____
Urinals : _____	Dishwashers : _____	Catch Basins : _____
Wash Basins : _____	Garb. Disposal: _____	Drywells : _____
Bathtubs : _____	Drink Fountain: _____	Soak Trench : _____
Showers : _____	2-Comp Sinks : _____	Interceptor : _____
Bidets : _____	3-Comp Sinks : _____	Sewer Caps : _____
Water Heaters : _____	Hand Sinks : _____	Conn. Sewer : <input checked="" type="checkbox"/>
Clothes Washers: _____	Floor Sinks : _____	Conn. Storm : _____
Laundry Trays : _____	Bar Sinks : _____	Rain Drains : _____
Serv/Mop Sinks : _____	Hub Drains : _____	Bck Wtr Valve: _____
Floor Drains : _____	Backflow Prvtr: _____	Reversal : _____

Notes : ABANDONMENT 35.00 CONCRETE

**DECOMMISSIONED**

Work Location : **RELEASE LETTER SIGNED**

*Jason Abraham 8-28-96*

Remarks : \_\_\_\_\_

Building Use : SF Sewer Connect: Y  
 Building Work : CON  
 Building Owner : MANDZIJ, ANNA

INSPECTION HISTORY:

8/27/96 AM Call SAN SEWER App  
*878*

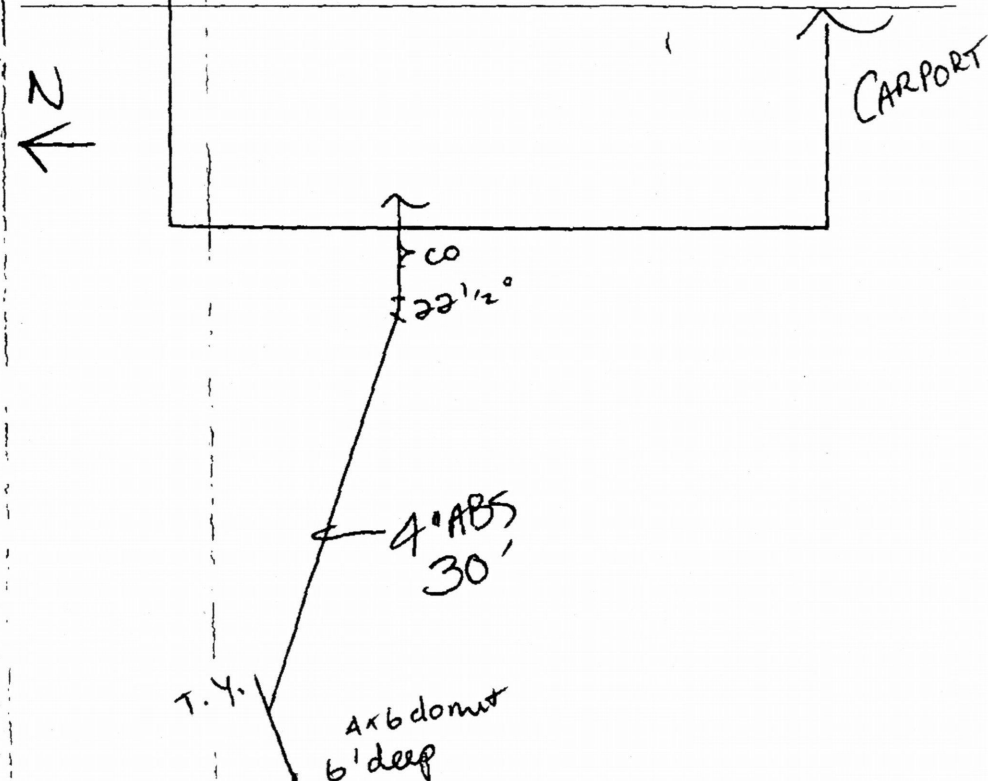

Final Inspection: *878* Date: 8/27/96



