

# Education Urban Renewal Plan

May 16, 2012

88881

Exhibit A

## Table of Contents

I.	Introduction .....	1
II.	Urban Renewal Area Map and Legal Description .....	3
A.	Legal Description.....	3
B.	Proposed Land Uses.....	3
III.	Urban Renewal Projects.....	7
A.	Strategic Partnerships to Develop and Educate a 21 <sup>st</sup> Century Workforce .....	7
B.	Urban Innovation .....	8
C.	Research & Technology Commercialization .....	9
D.	Entrepreneurship .....	10
E.	Cluster Development .....	11
F.	Housing .....	11
G.	Planning and Administration .....	11
IV.	Public Buildings .....	12
V.	Relationship to Local Objectives .....	13
A.	Portland Comprehensive Plan .....	13
B.	City of Portland Five-Year Economic Development Strategy.....	13
VI.	Relocation Policy.....	14
VII.	Property Acquisition and Disposition Policies .....	14
VIII.	Plan Financing .....	14
A.	General Description of the Proposed Financing Methods.....	14
B.	Tax Increment Financing.....	14
C.	Prior Indebtedness.....	14
IX.	Procedures for Amendments to the Plan .....	15
A.	Substantial Amendments.....	15
B.	Council-Approved Amendments.....	15
C.	Minor Amendments.....	15
X.	Other Provisions.....	16
A.	Non-Discrimination .....	16
B.	Agreements to Implement this Plan .....	16
C.	Duration of Urban Renewal Plan .....	16
D.	Validity .....	16

788281

Exhibit A



## I. Introduction

In 2012, municipalities across the United States, from New York to Tennessee to Utah, are pursuing urban universities for the opportunities they present to improve a region's economic future. These communities recognize the link between a world class research university and accelerating economic growth.

In New York, Mayor Bloomberg is pushing forward the Applied Sciences NYC Initiative by partnering with Cornell University to bring a new two million square foot campus to New York City by 2043. The city has pledged up to \$100 million for infrastructure as an incentive to build out the campus. In Tennessee, Governor Haslam directed \$50 million toward a program focusing on innovation, commercialization, investment, technology and entrepreneurship to raise Tennessee's profile in innovation-based economic development and drive growth in the creation of knowledge-based jobs. In addition to expanding the state's capacity for innovation, the governor has pledged \$10 million to the Memphis Research Consortium to cultivate commercialization partnerships. In 2006 Utah launched the Utah Science and Technology Research Initiative (USTAR). The program invested more than \$100 million in the state's universities. The goal was to recruit top researchers in key economic areas from around the world, who are now creating real economic value. Jobs in the state's technology sector grew from about 60,000 in 2006 to more than 72,000 in 2011. At the same time, the University of Utah took steps to make it easier to turn cutting-edge research into a business and to connect business students to the engineers and scientists doing the research. Last year, venture capital investment in Utah increased by 54 percent.

The Portland region is fortunate to have an urban university with world class potential in its own backyard. Portland State University ("PSU") is Oregon's largest and most diverse research university with a regional impact of more than \$1.4 billion annually. Providing close access to the city's business, technology, and cultural resources, PSU considers its mission to both "let knowledge serve the city," and to serve the greater community and region.

The university, with its current 50-acre campus, is forecasting growth in enrollment from 30,000 in 2012 to more than 50,000 by 2035. This predicted growth occurs at a time when PSU is taking an increasingly aggressive approach toward research, which has already led to the establishment of "Centers of Excellence" such as the Institute for Sustainable Solutions (the "ISS"). These centers have generated more than \$65 million in sponsored research and expect to exceed \$100 million by 2017. The combination of more students and greater ambitions to attract the best researchers and faculty requires increased and improved academic space, a need that will exceed 4.2 million square feet. Such growth positions PSU as an even more prominent employer, purchaser, researcher, real estate developer, and community partner.

As proposed, this Education Urban Renewal Plan ("Plan") directs tax increment resources to the 144-acre Education Urban Renewal Area ("EDURA" or "Area"). The Plan sets forth long-term partnerships between PSU, Portland Public Schools ("PPS"), Multnomah County ("County"), and the City of Portland ("City") with the objectives of creating an environment of educational excellence, attracting private investment, enhancing blighted properties and developing the region's workforce. The Plan is

## Exhibit A

forecasted to provide up to \$169 million for investments that leverage research facilities, business accelerators, affordable housing, and private development.

This is a timely, unique opportunity for urban renewal to help grow a great urban university that will serve a great city. The implementation of the Plan is envisioned to bring regional benefit through a continuum of educational advancement and job growth. Designed to be consistent with PDC's mission and strategic plan, as well as PSU's strategies for evolving into a world class university, these investments will provide a platform for job creation and private sector commerce through research and commercialization and other partnerships. Reduction of blight will also occur through both taxable and non-taxable development on low-density properties.

The objectives of the Plan will prioritize job growth and economic development projects through the following categories of investment:

- *Strategic Partnerships to Develop and Educate a 21st Century Workforce;*
- *Urban Innovation;*
- *Research and Technology Commercialization;*
- *Entrepreneurship; and*
- *Cluster Industry Firms*

These objectives will lead the progression of a district that will connect an educational environment and job generation to physical development as follows:

- Investing in the Portland Public Schools 11-acre site in Goose Hollow will provide an improved learning environment to aid the development of our future workforce.
- An enhanced academic environment at PSU provides the foundation for attracting new research dollars which also spurs greater entrepreneurship and small business development within the campus.
- Outward expansion evolves as entrepreneurs commercialize their ideas into startups and high-growth companies that attract additional cluster industries to gain a presence in private development within the EDURA.

## Exhibit A

## II. Urban Renewal Area Map and Legal Description

The Area shown in Figure 1 totals 144 acres and can generally be described as lying west of 1<sup>st</sup> Avenue, east of Interstate-405 and south of Jefferson Street, but including Portland Public School District property west of I-405. The Area includes a portion of the Portland State University District and planned growth area as outlined in the PSU Framework Plan. The Area also overlaps portions of the Goose Hollow Foothills League, Portland Downtown Neighborhood Association and South Portland Neighborhood Association boundaries.

### A. Legal Description

The legal description of the Area is attached as Exhibit 1, with an associated map as Exhibit 1.A.

### B. Proposed Land Uses

The City's Comprehensive Plan and implementing ordinances govern land use within the Area. Any adopted change in the Comprehensive Plan or implementing ordinances shall automatically amend this Section, as applicable, without the necessity of any further formal action. This Section shall thereafter incorporate the relevant amendments, additions or deletions. To the extent this Section conflicts with the Comprehensive Plan or Zoning Code, the Comprehensive Plan and Zoning Code shall govern.

Title 33, Portland City Code is incorporated herein to establish the maximum densities and building requirements to be implemented under this Plan.

Table 1. Existing Comprehensive Plan Designations of Tax Lots within Area

Comprehensive Plan Designation	Acreage	Square Feet	Percentage
Central Commercial (CX)	50.8	2,214,627	53%
Central Residential (RX)	24.8	1,082,462	26%
Institutional Residential (IR)	10.9	474,800	11%
Open Space (OS)	10.0	434,011	10%
<b>Total</b>	<b>96.6</b>	<b>4,205,900</b>	<b>100%</b>

\*Source: City of Portland Bureau of Planning and Sustainability



**Exhibit A**

At the time of the release of this Plan, the Bureau of Planning and Sustainability is also seeking Portland City Council ("Council") approval of the proposed Portland Plan. The EDURA intentionally is built on strong public partnerships which align resources for regional benefit. The Plan also provides an opportunity to advance many of the integrated strategies of the Portland Plan listed below:

**Thriving Educated Youth:**

- A culture of high expectations and achievement for all Portland youth
- Shared ownership of student success
- Neighborhoods and communities that support youth
- Facilities and programs that meet 21<sup>st</sup> century challenges and opportunities

**Economic Prosperity and Affordability:**

- Business cluster growth
- Urban innovation
- Growing employment districts
- Access to housing
- Education and job training
- Household economic security

**Healthy Connected City:**

- Public decisions that benefit human and environmental health
- Vibrant neighborhood hubs
- Coordinated interagency approach

[illegible]



**PDC** | PORTLAND DEVELOPMENT COMMISSION  
www.pdc.us

## Education Urban Renewal Area

**City of Portland Comp Plan Designations**

- Central Commercial
- Institutional Residential
- Open Space
- Central Multi-Dwelling Residential
- Urban Commercial

APRIL 2012

### **III. Urban Renewal Projects**

In order to achieve the objectives of this Plan, the following projects will be undertaken in the Area by PDC, in accordance with applicable federal, state, county and city laws, policies and procedures. Such projects may be modified, expanded or eliminated as needed to meet the objectives of this Plan as set forth herein, subject to Section IX, Procedures for Amendments to the Plan.

#### **A. Strategic Partnerships to Develop and Educate a 21<sup>st</sup> Century Workforce**

The boundaries of the EDURA include Lincoln High School which is one link in the PPS chain of K-12 facilities. A partnership with PPS better positions the school district to achieve a redevelopment vision of that campus. The EDURA also features a collaborative redevelopment between PSU and the County. Synergy to develop long term partnerships among all three institutions will bring significant benefit to the region.

##### **1. Multnomah County**

A development project will serve as a home for functions of the County Department of Human Services. PSU will strive to co-locate compatible academic and research programs with this project. A synergistic co-location will leverage PSU's academic and research expertise with the County's proficiency in service design and delivery to advance programs supporting social and community prosperity.

##### **2. Portland Public Schools**

Portland Public Schools owns an 11-acre site in the Goose Hollow neighborhood, which includes Lincoln High School. Current zoning and floor area ratio allowances provide development capacity of more than 1.7 million square feet above the existing 200,000 square foot facility. This Plan provides an opportunity for PDC to partner with PPS for investments that improve the educational environment and the intensity of development on the site.



## **B. Urban Innovation**

Portland enjoys the unique advantage of a national reputation as a leader in urban development. Innovative approaches to building efficiency, reduced carbon use through environmental design, the provision of local energy and transportation systems have helped support a growing number of firms in the local technology sectors, while simultaneously building the City's reputation for livability.

This combination is a powerful draw for entrepreneurs. It has also helped position PSU to make significant investments in sustainability.

### **1. EcoDistrict Development**

PSU is at the heart of one of the City's five pilot EcoDistricts, an effort to pursue comprehensive action and accelerate sustainable development at the neighborhood scale by integrating building and infrastructure projects with community engagement. Funds could be used to support development of district-scale projects, such as energy, water and stormwater management, smart grid, demand management or resource sharing. Such projects in the Area would directly benefit PSU's operations and research development as well as clean technology cluster firms involved in design, development and construction.

Demonstration projects, such as district energy, will also keep PSU and Portland at the forefront of next generation development practices, including high-performance buildings, integrated district systems, and existing building retrofit.

### **2. Energy Efficiency/Modernization**

Access to capital for energy retrofits can simultaneously lower operating costs while making the neighborhood more appealing and capable of absorbing an accumulation of companies. Demonstration projects can serve the dual benefit of enhancing the City's image and providing local firms with exportable experience and exposure.

The upgrade and enhancement of existing commercial buildings owned by PSU and adjacent private properties will achieve utility savings for the university and adjacent businesses, reduce energy use, interface with ISS-led research in the energy efficiency field, and support the growth of the efficiency sector in Portland.

### **3. Enhance PSU's Academic Capacity**

PSU will re-invest in older buildings and construct new ones to handle the demands of a growing student population. One such project is Neuberger Hall, one of the largest academic buildings on campus. Current deterioration in the building has limited the use of several rooms. Classroom capacity could be expanded if fundamental building systems were repaired. Another opportunity is East Hall, a campus building with historic character that serves PSU's growing international student population. The building will undergo a major retrofit. Projects such as these will enhance the academic environment and its capacity.



### **C. Research & Technology Commercialization**

A deliberate focus on attracting research dollars and top research faculty will be driven by an increase in the amount of laboratory space and other advanced office infrastructure. A byproduct of this initiative will be partnerships with private industry as well as the emergence of startup businesses which are seeded through technology transfer and commercialization. Research specific to PSU and Portland intellectual and technological competencies will generate jobs in the City's target industries.

#### **1. Public/Private Research Facility Expansion**

PSU has already begun to reinforce its research capacity with the establishment of Centers of Excellence, including the Oregon Built Environment and Sustainable Technologies ("BEST") Center, the Food Industry Leadership Center, the Center for Life in Extreme Environments, and the Institute on Aging. Substantially increasing research capacity by expanding these Centers of Excellence and creating new ones will lead to enhanced regional innovation.

The Institute for Sustainable Solutions ("ISS") is a sign of PSU's commitment. The ISS took great strides through the successful pursuit of a \$25 million grant from the James F. and Marion L. Miller Foundation, the largest gift in the history of PSU and among the largest single gifts supporting sustainability in U.S. higher education history. The ISS facility has become a hub for connecting research, education and services to local companies and creating new alliances with major think tanks at Intel, Cisco, IBM and General Electric. The prominence of the ISS has helped differentiate PSU from its peers by infusing sustainability as a core competency at levels that draw national attention.

Funds may be available to assist with the expansion of PSU research facilities with a priority given to projects that encourage 1) cross-disciplinary research and development and 2) partnerships with private-sector firms and industry. Research Centers of Excellence would provide enhanced infrastructure for the development and commercialization of leading edge technologies.

#### **2. PSU Classroom and Research Facility Expansion**

PSU currently has research expenditures of approximately \$65 million annually. This has increased by as much as 20% per year in recent years, creating a significant demand for expanded research facilities in a variety of disciplines, including engineering and physical sciences. Funds may be available to assist with the expansion of existing PSU research facilities that contribute directly to PSU's research and development growth and to the knowledge base of Portland's cluster industries.

## **D. Entrepreneurship**

PSU is in the process of building a robust entrepreneurial ecosystem. The City and PDC are also achieving significant results from strategies intended to make Portland more attractive to early-stage startups by increasing the pool of local capital available to people with such aspirations. Traction has been gained through efforts such as the Portland Seed Fund, the Portland 100 Mentoring Program, place-based entrepreneurial efforts in the Central Eastside and Old Town/Chinatown, and a newly launched commercialization grant program with both Oregon Health & Science University ("OHSU") and PSU. Entrepreneurship will gain a powerful partner when leveraged with PSU's goals to improve direct training, provide technical assistance and mentoring city-wide, and an overall expansion of the resources for startup businesses. OHSU has become increasingly reliant on the PSU School of Business to draw on business development expertise. Further development of these partnerships will result in greater benefit for the region.

### **1. PSU/Private Partner Business Accelerator**

University-based accelerators help incubate and advance startup technologies and science companies while creating a living laboratory for the community. Funds may be available to assist with the construction of new accelerators and to expand existing facilities such as Portland State Business Accelerator ("PSBA"), OHSU's startup wet labs or other institutional incubator facilities.

### **2. Startup Accelerator Fund**

As a result of partnerships between PSU, PDC, the private investment community and others, funds may be available to assist early stage entrepreneurial firms in areas such as capital funding gaps.

### **3. Expansion of the PSU School of Business**

With a current total enrollment of almost 2,800 undergraduate and 600 graduate students, the existing 69,000 square foot School of Business facility is undersized when compared to peer institutions. Funds may be used to expand this facility, which, at completion, is anticipated to be more than double its current size to meet the needs of a 20 to 30% increase in enrollment. Studies have shown that a majority of PSU School of Business graduates remain in the Portland area, adding to the region's workforce.



## **E. Cluster Development**

The City's Five-Year Economic Development Strategy (the "Strategy") identifies four target industry clusters where Portland and the region have competitive advantages at a national level. These clusters include Advanced Manufacturing, Athletic and Outdoor, Clean Technology and Software/Technology. Most of these industries have a natural affinity to collaborate within a strong academic research-driven environment.

The nearly 30-year build out of the EDURA with some of the more than 100 private property owners will be important for upgrading and replacing office space and a built environment which was largely constructed prior to 1970. The Area will see a progressive transformation of surface parking lots and very low intensity parcels to accommodate demand from cluster firms and the related need for a more diverse mix of neighborhood amenities.

### **1. Target Industry Recruitment & Expansion Fund**

Funds may be available to assist business recruitment and expansion efforts geared toward attracting research and development-intensive companies to strategic commercial properties in the Area, including the recruitment of early-stage firms to accelerator facilities.

### **2. Small Business/Real Estate Programs**

PDC provides a number of smaller scale programs intended to improve the quality and efficiency of buildings and to position small businesses in a manner that gives them increased opportunities for prosperity and growth. These include storefront grants, green features grants, business finance programs and other tools intended to promote private investment.

## **F. Housing**

The City of Portland *Tax Increment Financing Set Aside Policy for Affordable Housing* will apply to this Plan. The 30% Set Aside resources will be administered by the Portland Housing Bureau. TIF-supported housing investments in this URA will be guided by the investment priorities in the Portland Housing Bureau's Strategic Plan and other applicable City housing policies. In the fall of 2012, PHB will develop specific income guidelines for the EDURA and seek public comment. PHB's Strategic Plan is available at <http://www.portlandonline.com/phb/strat>.

## **G. Planning and Administration**

PDC will undertake program development and project planning activities necessary to achieve the objectives described in Section I of this Plan. PDC will also undertake administration of all aspects of this Plan in a manner consistent with the Plan's objectives.

#### **IV. Public Buildings**

Projects undertaken by PSU under this Plan may include public buildings that serve or benefit the Area in one or more of the following ways:

- Increase density on underutilized parcels
- Enhance academic facilities to prepare the future workforce of the Area and region
- Develop or expand training and educational facilities that accelerate the creation of knowledge-based jobs
- Leverage private development that will increase the tax base of the Area
- Provide housing and neighborhood commercial services for students, Area residents, and employees
- Provide opportunities for reducing energy costs and carbon footprint

PSU projects include, but are not limited to, the following:

- Energy efficiency/modernization projects at the Marston House, East Hall, Montgomery Court, the Fourth Avenue Building, and the Smith Memorial Student Union
- Expansion of the School of Business
- Neuberger Hall and Cramer Hall renovations
- Expansion of engineering and physical science classrooms and research facilities
- Upgraded laboratory space, potentially in partnership with OHSU and others
- Knowledge Commons, a building that combines high tech classrooms and student services functions
- Potential expansion of the existing PSBA and related programs
- Potential co-location of services and departments with the County

As described in Section III.A. of this Plan, a potential project with PPS on its 11-acre site in Goose Hollow will benefit the Area by investing towards a higher density development within the central city. Development on this site may include private development, directly benefiting the tax base of the Area and providing a better utilization of the site.

As described in Section III.A. of this Plan, a development with the County will strive to co-locate the County Department of Human Services and PSU academic functions. This resulting investment will benefit the Area by providing a new real estate project that will strengthen connections between health and higher education and creates a pipeline for the delivery of services and workforce training.



## **V. Relationship to Local Objectives**

### **A. Portland Comprehensive Plan**

This Plan conforms to the City's Comprehensive Plan and its supporting neighborhood and area plans, as a whole, relative to the improvement of residential neighborhoods, commercial districts, and employment centers within the Area.

### **B. City of Portland Five-Year Economic Development Strategy**

The Strategy was adopted by Council on July 8, 2009. The Strategy sets forth the approach for building the most sustainable economy in the world, with the goal of creating 10,000 new jobs in five years. Building a sustainable economy requires a balanced focus on job growth, innovation in sustainability and equality of economic opportunity through competitiveness, urban innovation and neighborhood business vitality. This Plan meets Strategy Goals 1 and 2 as follows:

#### **1. Competitiveness**

Maximize industry competitiveness and generate robust job growth by creating opportunities for existing, emerging or relocating traded-sector businesses to enter new markets and access financial and human capital resources.

This Plan provides financial and technical assistance resources to assist target industry cluster businesses and high-growth firms. Strategies include assisting firms with export and global branding opportunities, supporting higher education innovation efforts, enhancing startup activity and business incubation opportunities, and aligning university workforce development resources with the skills needed in target industries. This Plan will support substantially increasing PSU's research capability and the conversion of research into commercially viable businesses, contributing to job growth throughout the City.

#### **2. Urban Innovation**

Maintain a leadership position in sustainability by constantly striving to produce an innovative urban setting that fosters creativity and invention and aligns with clean technology industry activities.

This Plan will assist in the implementation of demonstration projects that enhance Portland's reputation as an early adopter of advanced green development approaches and solutions— a "living laboratory" for innovation, including:

- **Energy efficiency:** Pursue commercial and institutional building retrofits to improve building performance and support Portland's energy efficiency industry; capture "off the shelf" technical and financial solutions to ensure replicable and exportable new approaches and skills.
- **Integrated district utilities:** Pursue partnerships with property owners and private firms to realize district scale and integrated district solutions (water, wastewater, energy, waste, transportation).
- **High performance new construction:** Pursue new development that supports industry growth in high performance design and engineering; green materials development and deployment; and energy and water management.

## **VI. Relocation Policy**

All relocation activities will be undertaken in accordance with the requirements of ORS 281.045-281.105, PDC Relocation Policies and Procedures and any other applicable law or regulation.

## **VII. Property Acquisition and Disposition Policies**

Although no real property acquisition is presently anticipated, PDC may acquire real property by any means within the Area, if necessary, to achieve the objectives of this Plan. Prior to such future acquisitions, the Board shall adopt a Resolution identifying the property and finding that the acquisition thereof is necessary to achieve the objectives of this Plan.

## **VIII. Plan Financing**

### **A. General Description of the Proposed Financing Methods**

PDC may borrow money and accept advances, loans, grants and any other form of financial assistance from the federal government, the state, city, county, or other public body, or from any sources, public or private, for the purposes of undertaking and carrying out this Plan, or may otherwise obtain financing as authorized by ORS 457 and Chapter XV of the City Charter. Upon request of PDC, Council may from time to time issue revenue bonds, certificates, debentures or promissory notes to assist in financing project activities as provided by Section 15-106 of the City Charter.

The funds obtained by PDC shall be used to pay or repay any costs, expenses, advancements and indebtedness incurred in planning or undertaking project activities or in otherwise exercising any of the powers granted by ORS 457 and Chapter XV of the City Charter in connection with the implementation of this Plan.

The total maximum indebtedness which may be incurred to complete this Plan is \$169,000,000.

### **B. Tax Increment Financing**

This Plan may be financed, in whole or in part, by funding allocated to PDC as provided in Section 1c, Article IX of the Oregon Constitution and ORS 457.420 through ORS 457.450.

### **C. Prior Indebtedness**

Any indebtedness permitted by law and incurred by PDC or the City in connection with preplanning for this Plan shall be repaid from tax increment revenues from the Area when and if such funds are available.

## **IX. Procedures for Amendments to the Plan**

This Plan may be reviewed and evaluated periodically, and may be amended as needed, in conformance with statutory requirements. All amendments to this Plan shall be made pursuant to the following procedures.

### **A. Substantial Amendments**

Substantial amendments are solely amendments that:

1. Add land to the Area, except for an addition of land that totals not more than one percent of the existing Area; or
2. Increase the maximum amount of indebtedness that can be issued or incurred under the Plan.

Substantial amendments shall require the same approval process as required for initial plan adoption including the approval process as provided in ORS 457.095 and the notice requirement set forth in ORS 457.120.

### **B. Council-Approved Amendments**

Council-approved amendments are solely amendments that:

1. Extend the last date to issue debt; or
2. Identify a project that includes a public building.

Council-approved amendments require approval by PDC's Board of Commissioners (the "Board") by resolution and by Council, which may approve the amendment by resolution. Council-approved amendments do not require any of the procedural or notice requirements found in ORS Chapter 457 including, but not limited to, the procedures set forth in ORS 457.085(4) and (5). To the extent that a Council-approved amendment involves a public building, such amendment shall explain how the building serves or benefits the urban renewal area.

### **C. Minor Amendments**

Minor amendments are amendments that are neither substantial, nor Council-approved amendments. Minor amendments may include changing the goals of the Plan or removing land from the Area. Minor amendments are effective upon adoption of a resolution by the Board approving the amendment.



## **X. Other Provisions**

### **A. Non-Discrimination**

In the preparation, adoption and implementation of this Plan, no public official or private party shall take any action or cause any person, group or organization to be discriminated against on the basis of age, race, color, religion, gender, sexual orientation, marital status, citizenship status, or national origin.

### **B. Agreements to Implement this Plan**

PDC will implement this Plan through vehicles such as partnerships between PDC and other public agencies, private sector property owners, for-profit developers and non-profit development organizations. It is the intention of PDC to utilize agreements such as memorandums of understanding, development agreements or other mechanisms with Area property owners and developers to guide and specify public investments and private development. These agreements will be utilized throughout the life of this Plan to ensure activities are in conformance with this Plan.

### **C. Duration of Urban Renewal Plan**

No indebtedness, as defined by applicable state law, for which taxes divided under ORS 457.440 are to be pledged, shall be issued under this Plan (and under any and all projects undertaken with respect to this Plan) after: (i) the date that maximum indebtedness is reached; or (ii) June 30, 2041, whichever occurs first.

### **D. Validity**

Should a court of competent jurisdiction find any word, clause, sentence, section or part of this Plan to be invalid, the remaining words, clauses, sentences, sections or parts shall be unaffected by such findings and shall remain in full force and effect for the duration of this Plan



**Exhibit 1****LEGAL DESCRIPTION****THE EDUCATION URBAN RENEWAL AREA****PORTLAND, OREGON**

Commencing in the Northwest one-quarter of Section 3, Township 1 South, Range 1 East, Willamette Meridian, City of Portland, County of Multnomah, State of Oregon, at the northeasterly corner of Block 149 of the plat of the **"City of Portland"**, which at the intersection of the southerly right-of-way line of SW Columbia Street as dedicated in said plat, with the westerly right-of-way line of SW 4<sup>th</sup> Avenue as dedicated in said plat, Assessor Map 1S 1E 3BC for the POINT OF BEGINNING of the Education Urban Renewal Area Boundary Line;

1. Thence easterly, along the southerly right-of-way line of SW Columbia Street as dedicated in the plat of the **"City of Portland"**, a distance of 820 feet, more or less, to the westerly right-of-way line of SW First Avenue, Assessor Map 1S 1E 3BC and Assessor Map 1S 1E 3BD;
2. Thence southerly, along the westerly right-of-way line of SW First Avenue as dedicated in the plat of the **"City of Portland"**, a distance of 460 feet, more or less, to the northerly right-of-way line of SW Market Street as dedicated in said plat, Assessor Map 1S 1E 3BD and Assessor Map 1S 1E 3BC;
3. Thence southwesterly, crossing the right-of-way of SW Market Street, a distance of 117 feet, more or less, to the westerly right-of-way line of SW First Avenue at the southeasterly end of a 30.00 foot radius curve at the northeasterly corner of Block A of the plat of **"South Auditorium Addition"**, Assessor Map 1S 1E 3CB;
4. Thence southerly, along the westerly right-of-way line of SW First Avenue as dedicated in the plat of **"South Auditorium Addition"**, a distance of 619.85 feet, more or less, to the point of curvature of a 30.00 foot radius curve at the southeasterly corner of the plat of **"Harrison East Condominiums"**, Assessors Map 1S 1E 3CB;
5. Thence southwesterly, along the right-of-way line at the intersection of the westerly right-of-way line of SW First Avenue with the northerly right-of-way line of SW Harrison Street as dedicated in the plat of **"South Auditorium Addition"** and shown in the plat of **"Harrison East Condominiums"**, along the arc of a 30.00 foot radius curve, an arc distance of 47.12 feet, more or less, to a point of tangency on the northerly right-of-way line of SW Harrison Street, which is also a point on the boundary line of the **North Macadam Urban Renewal Area**, Assessor Map 1S 1E 3CB;

**The following courses are in common with the boundary line of the North Macadam Urban Renewal Area.**

6. Thence westerly, along the northerly right-of-way line of SW Harrison Street as dedicated in the plat of "South Auditorium Addition" and it's westerly extension, a distance of 750.00 feet, more or less, to the westerly right-of-way line of SW 4<sup>th</sup> Avenue, Assessor Map 1S 1E 3CB;
7. Thence southerly, along the westerly right-of-way line of SW 4<sup>th</sup> Avenue as dedicated in the plat of the "City of Portland", a distance of 80.00 feet, more or less, to the southerly right-of-way line of SW Harrison Street, Assessor Map 1S 1E 3CB;
8. Thence easterly, along the southerly right-of-way line of SW Harrison Street as dedicated in the plat of "South Auditorium Addition, a distance of 750.00 feet, more or less, to the point of curvature of a 30.00 foot radius curve at the northeasterly corner of Block B of the plat of "South Auditorium Addition", Assessor Map 1S 1E 3CB;
9. Thence southeasterly, along the right-of-way line at the intersection of the southerly right-of-way line of SW Harrison Street with the westerly right-of-way line of SW First Avenue as dedicated in the plat of "South Auditorium Addition", along the arc of a 30.00 foot radius curve, an arc distance of 47.12 feet, more or less, to a point of tangency on the westerly right-of-way line of SW First Avenue, Assessor Map 1S 1E 3CB;
10. Thence southerly, along the westerly right-of-way lines of SW First Avenue as dedicated in the plat of "South Auditorium Park", a distance of 580.56 feet, more or less, to the point of curvature of a 30.00 foot radius curve at the southeasterly corner of Block B of the plat of "South Auditorium Addition", Assessor Map 1S 1E 3CB;
11. Thence southwestly, along the right-of-way line at the intersection of the westerly right-of-way line of SW First Avenue with the north right-of-way line of SW Lincoln Street as dedicated in the plat of "South Auditorium Addition", along the arc of a 30.00 foot radius curve, an arc distance of 47.12 feet, more or less, to a point of tangency on the north right-of-way line of SW Lincoln Street, Assessor Map 1S 1E 3CB;
12. Thence westerly, along the north right-of-way line of SW Lincoln Street as dedicated in the plat of "South Auditorium Park", a distance of 393 feet, more or less, to the most easterly corner of that tract of land conveyed to the City of Portland for street purposes by deed recorded October 20, 1980 in Book 1477, Page 1676, Multnomah County Deed Records, Assessor Map 1S 1E 3CB;
13. Thence westerly, along the north right-of-way line of SW Lincoln Street as conveyed in said Book 1477, Page 1676 and it's westerly extension, a distance of 130 feet, more or less, to the west line of that tract of land conveyed to the City of Portland by city of Portland Ordinance No. 147584 filed April 20, 1979, Assessor Map 1S 1E 3CB;
14. Thence southerly, along the west line of said City of Portland tract conveyed in city of Portland Ordinance No. 147584, a distance of 11.15 feet, more or less, to the south right-of-way line of SW Lincoln Street as dedicated in the plat of "South Auditorium Park", Assessor Map 1S 1E 3CC;
15. Thence westerly, along the south right-of-way line of SW Lincoln Street as dedicated in the plat of "South Auditorium Park", a distance of 165 feet, more or less, to the point of curvature of a 30.00 foot radius curve at the southwestly corner of Block B of the plat of "South Auditorium Addition", Assessor Map 1S 1E 3CC;
16. Thence westerly, crossing SW 4<sup>th</sup> Avenue, a distance of 112 feet, more or less, to the southeast corner of Block 21 of the plat of "Caruthers Addition to Caruthers Addition", Assessor Map 1S 1E 4DD;
17. Thence southerly, along the west right-of-way line of SW 4<sup>th</sup> Avenue as dedication in the plat of "Caruthers Addition to Caruthers Addition", a distance of 92 feet, more or less, to



- the westerly extension of the south right-of-way line of SW Lincoln Street as dedicated in the plat of "South Auditorium Addition", Assessor Map 1S 1E 4DD;
18. Thence easterly, along the south right-of-way line of SW Lincoln Street as dedicated in the plat of "South Auditorium Addition" and it's westerly extension, a distance of 245 feet, more or less, to the northeast corner of that tract of land conveyed to ANR L.L.C. by statutory warranty deed recorded May 20, 2002 in Document No. 2002-090332, said deed records, Assessor Map 1S 1E 3CC;
  19. Thence southerly, along the east line of said ANR L.L.C. tract, a distance of 127 feet, more or less, to a point of curvature, Assessor Map 1S 1E 3CC;
  20. Thence southwesterly, along the southeasterly line of said ANR L.L.C. tract, along the arc of a 15.00 foot radius curve, an arc distance of 23.56 feet, more or less, to a point of tangency, Assessor Map 1S 1E 3CC;
  21. Thence westerly, along the south line of said ANR L.L.C. tract, a distance of 106 feet, more or less, to the southwest corner thereof, Assessor Map 1S 1E 3CC;
  22. Thence, **leaving the boundary line of the North Macadam Urban Renewal Area**, westerly, along the westerly extension of the south line of said ANR L.L.C. tract, a distance of 126 feet, more or less, to the west right-of-way line of SW 4<sup>th</sup> Avenue as dedication in the plat of "Caruthers Addition to Caruthers Addition", Assessor Map 1S 1E 3CC;
  23. Thence southerly, along the west right-of-way line of SW 4<sup>th</sup> Avenue as dedication in the plat of "Caruthers Addition to Caruthers Addition", a distance of 87 feet, more or less, to the south right-of-way line of SW Grant Street, Assessor Map 1S 1E 4DD;
  24. Thence easterly, along the easterly extension of the south right-of-way line of SW Grant Street as dedicated in the plat of "Caruthers Addition to Caruthers Addition", a distance of 35 feet, more or less, to the right-of-way centerline of SW 4<sup>th</sup> Avenue, Assessor Map 1S 1E 3CC;
  25. Thence southerly, along the right-of-way centerline of SW 4<sup>th</sup> Avenue as dedicated in the plat of "South Auditorium Addition", and it's southerly extension, a distance of 811 feet, more or less, to the westerly extension of the south right-of-way line of SW Sheridan Street as dedicated in the plat of "South Auditorium Addition", Assessor Map 1S 1E 3CC;
  26. Thence easterly, along the south right-of-way line of SW Sheridan Street as dedicated in the plat of "South Auditorium Addition" and it's westerly extension, a distance of 228 feet, more or less, to the point of curvature of a 30.00 foot radius curve at the northeasterly corner of Block E of the plat of "South Auditorium Addition", Assessor Map 1S 1E 10BB;
  27. Thence southeasterly, along the right-of-way line at the intersection of the south right-of-way line of SW Sheridan Street with the west right-of-way line of SW 3<sup>rd</sup> Avenue as dedicated in the plat of "South Auditorium Addition", along the arc of a 30.00 foot radius curve, an arc distance of 47.12 feet, more or less, to a point of tangency on the west right-of-way line of SW 3<sup>rd</sup> Avenue, Assessor Map 1S 1E 10BB;
  28. Thence southerly, along the west right-of-way line of SW 3<sup>rd</sup> Avenue as dedicated in the plat of "South Auditorium Addition" and it's southerly extension, a distance of 440.00 feet, more or less, to the right-of-way centerline of SW Arthur Street, which is now vacated by City of Portland Ordinance No. 133763, recorded January 25, 1972 in Book 836, Page 813, said deed records, Assessor Map 1S 1E 10BB;
  29. Thence westerly, along the right-of-way centerline of SW Arthur Street as dedicated in the plat of "South Auditorium Addition" and it's westerly extension, said right-of-way



- now vacated, a distance of 313.04 feet, more or less, to the west right-of-way line of SW Barbur Boulevard as dedicated in the plat of "South Auditorium Addition", Assessor Map 1S 1E 10BB;
30. Thence northerly, along the west right-of-way line of SW Barbur Boulevard as dedicated in the plat of "South Auditorium Addition", a distance of 502 feet, more or less, to the south right-of-way line of SW Sheridan Street as dedication in the plat of "Caruthers Addition to Caruthers Addition", Assessor Map 1S 1E 9AA;
  31. Thence northerly, crossing SW Sheridan Street, a distance of 61 feet, more or less, to the southeast corner of Block 25 of the plat of "Caruthers Addition to Caruthers Addition", Assessor Map 1S 1E 4DD;
  32. Thence northerly, along the west right-of-way line of SW 4<sup>th</sup> Avenue as dedication in the plat of "Caruthers Addition to Caruthers Addition", 590 feet, more or less, to the northeasterly right-of-way line of Interstate Highway 405 – Stadium Highway, said point being southerly, 30.00 feet from the northeast corner of Lot 3, Block 23 of the plat of "Caruthers Addition to Caruthers Addition", Assessor Map 1S 1E 4DD;
  33. Thence northwesterly, along said northeasterly right-of-way lines of Interstate Highway 405 – Stadium Highway as shown in the Oregon Department of Transportation Drawing No. 1A-16-25, a distance of 212 feet, more or less, to the south right-of-way line of SW Grant Street as dedication in the plat of "Caruthers Addition to Caruthers Addition", said point being westerly, 40.00 feet from the northeast corner of Lot 8, Block 23 of said plat, Assessor Map 1S 1E 4DD;
  34. Thence westerly, along the south right-of-way line of SW Grant Street as dedication in the plat of "Caruthers Addition to Caruthers Addition", 66 feet, more or less, to the east right-of-way line of SW 5<sup>th</sup> Avenue, Assessor Map 1S 1E 4DD;
  35. Thence northerly, along the east right-of-way lines of SW 5<sup>th</sup> Avenue as dedicated in the plat of "Caruthers Addition to Caruthers Addition" and the plat of the "City of Portland", a distance of 527 feet, more or less, to the southerly right-of-way line of SW Jackson Street as dedicated in the plat of the "City of Portland", Assessor Map 1S 1E 4DD and Assessor Map 1S 1E 4DA;
  36. Thence westerly, crossing SW 5<sup>th</sup> Avenue, a distance of 80.00 feet, more or less to the northeast corner of Block 157 of the plat of the "City of Portland", Assessor Map 1S 1E 4DA;
  37. Thence southerly, along the westerly right-of-way line of SW 5<sup>th</sup> Avenue as dedicated in the plat of the "City of Portland" and the plat of "Caruthers Addition to Caruthers Addition", a distance of 37 feet, more or less, to the westerly right-of-way line of realigned SW 5<sup>th</sup> Avenue as shown in the Oregon Department of Transportation Drawing No. 1A-16-25, Assessor Map 1S 1E 4DA and 1S 1E 4DD;
  38. Thence southerly, along the westerly right-of-way line of realigned SW 5<sup>th</sup> Avenue as shown in the Oregon Department of Transportation Drawing No. 1A-16-25, a distance of 175 feet, more or less, to the northerly right-of-way line of Interstate Highway 405 – Stadium Highway, Assessor Map 1S 1E 4DD;
  39. Thence westerly, along the northerly right-of-way line of Interstate Highway 405 – Stadium Highway as shown in the Oregon Department of Transportation Drawing No. 1A-16-25, a distance of 45 feet, more or less, to the northeasterly right-of-way line of realigned SW 6<sup>th</sup> Avenue as shown in the Oregon Department of Transportation Drawing No. 1A-16-25, Assessor Map 1S 1E 4DD;
  40. Thence northwesterly, along the northeasterly right-of-way line of realigned SW 6<sup>th</sup> Avenue as shown in the Oregon Department of Transportation Drawing No. 1A-16-25, a



- distance of 256 feet, more or less, to the southerly right-of-way line of SW Jackson Street as dedicated in the plat of the "City of Portland", said point being easterly, 10.00 feet from the northwest corner of Block 157 of said plat, Assessor Map 1S 1E 4DD and Assessor Map 1S 1E 4DA;
41. Thence westerly, along the southerly right-of-way line of SW Jackson Street as dedicated in the plat of the "City of Portland", a distance of 90.00 feet, more or less, to the northeast corner of Block 194 of said plat, Assessor Map 1S 1E 4DA;
  42. Thence southerly, along the westerly right-of-way line of SW 6<sup>th</sup> Avenue as dedicated in the plat of the "City of Portland" and the plat of "Caruthers Addition to Caruthers Addition", a distance of 134 feet, more or less, to the northwest corner of that portion of SW 6<sup>th</sup> Avenue vacated in the City of Portland Ordinance No. 139277 passed January 2, 1975, Assessor Map 1S 1E 4DA and Assessor Map 1S 1E 4DD;
  43. Thence easterly, along the north line of that portion of SW 6<sup>th</sup> Avenue vacated in the City of Portland Ordinance No. 139277 accepted January 2, 1975, a distance of 23.50 feet, more or less, to the northeast corner thereof, Assessor Map 1S 1E 4DA and Assessor Map 1S 1E 4DD;
  44. Thence southerly, along the east line of that portion of SW 6<sup>th</sup> Avenue vacated in the City of Portland Ordinance No. 139277 accepted January 2, 1975, a distance of 49.50 feet, more or less, to the southeast corner thereof, said southeast corner being on the easterly extension of the south line of Lot 1, Block 31 of the plat of "Caruthers Addition to Caruthers Addition", Assessor Map 1S 1E 4DA and Assessor Map 1S 1E 4DD;
  45. Thence westerly, along the south line of that portion of SW 6<sup>th</sup> Avenue vacated in the City of Portland Ordinance No. 139277 accepted January 2, 1975, which is also along the easterly extension of the south line of Lot 1, Block 31 of the plat of "Caruthers Addition to Caruthers Addition", a distance of 24.00 feet, more or less, to the southeast corner of said Lot 1, Assessor Map 1S 1E 4DA and Assessor Map 1S 1E 4DD;
  46. Thence northwesterly, along the northeasterly right-of-way lines of Interstate Highway 405 – Stadium Highway as shown in the Oregon Department of Transportation Drawing No. 1A-16-25, a distance of 221 feet, more or less, to the easterly right-of-way line of SW Broadway Avenue, which is at the southwesterly corner of that tract of land conveyed to GRS Properties, LLC, by statutory warranty deed recorded October 8, 2002 in Document No. 2002-180030, said deed records, and referred to as Parcel 3 therein, Assessor Map 1S 1E 4DD and Assessor Map 1S 1E 4DA;
  47. Thence northwesterly, crossing SW Broadway Avenue, a distance of 92 feet, more or less, to the southwesterly corner of that tract of land conveyed to the State of Oregon by warranty deed recorded January 11, 1963 in Book 2150, Page 205, said deed records, and referred to as Parcel 2 therein, Assessor Map 1S 1E 4DA;
  48. Thence northwesterly, along the northeasterly right-of-way lines of Interstate Highway 405 – Stadium Highway as shown in the Oregon Department of Transportation Drawing No. 1A-16-25, a distance of 210 feet, more or less, to the easterly right-of-way line of the north bound portion of SW Park Avenue, said point being southerly, 40.00 feet from the northwest corner of Block 196 of said plat, Assessor Map 1S 1E 4DA;
  49. Thence northerly, along the easterly right-of-way line of the north bound portion of SW Park Avenue as dedicated in the plat of the "City of Portland", a distance of 100.00 feet, more or less, to the northerly right-of-way line of SW Jackson Street, Assessor Map 1S 1E 4DA;
  50. Thence westerly, along the northerly right-of-way line of SW Jackson Street as dedicated in the plat of the "City of Portland", a distance of 140 feet, more or less, to the easterly



- right-of-way line of the south bound portion of SW Park Avenue, Assessor Map 1S 1E 4DA;
51. Thence northerly, along the easterly right-of-way line of the south bound portion of SW Park Avenue as dedicated in the plat of the "City of Portland", a distance of 260 feet, more or less, to the northerly right-of-way line of SW College Street, Assessor Map 1S 1E 4DA;
  52. Thence westerly, along the northerly right-of-way line of SW College Street as dedicated in the plat of the "City of Portland", a distance of 60.00 feet, more or less, to the westerly right-of-way line of the south bound portion of SW Park Avenue, Assessor Map 1S 1E 4DA;
  53. Thence northerly, along the westerly right-of-way line of the south bound portion of SW Park Avenue as dedicated in the plat of the "City of Portland", said right-of-way now vacated as shown in the City of Portland Ordinance No. 132640 dated May 5, 1971, a distance of 720 feet, more or less, to the southerly right-of-way line of SW Montgomery Street, Assessor Map 1S 1E 4DA;
  54. Thence easterly, along the southerly right-of-way line of SW Montgomery Street as dedicated in the plat of the "City of Portland", a distance of 60.00 feet, more or less, to the easterly right-of-way line of the south bound portion of SW Park Avenue, Assessor Map 1S 1E 4DA;
  55. Thence northerly, along the easterly right-of-way line of the south bound portion of SW Park Avenue as dedicated in the plat of the "City of Portland", a distance of 520 feet, more or less, to the southerly right-of-way line of SW Market Street, Assessor Map 1S 1E 4AD;
  56. Thence westerly, along the southerly right-of-way line of SW Market Street as dedicated in the plat of the "City of Portland", a distance of 60.00 feet, more or less, to the westerly right-of-way line of the south bound portion of SW Park Avenue, Assessor Map 1S 1E 4AD;
  57. Thence southerly, along the westerly right-of-way line of the south bound portion of SW Park Avenue as dedicated in the plat of the "City of Portland", a distance of 200 feet, more or less, to the northerly right-of-way line of SW Mill Street, Assessor Map 1S 1E 4AD;
  58. Thence westerly, along the northerly right-of-way line of SW Mill Street as dedicated in the plat of the "City of Portland", a distance of 200 feet, more or less, to the easterly right-of-way line of SW 10<sup>th</sup> Avenue, Assessor Map 1S 1E 4AD;
  59. Thence, westerly, crossing SW 10<sup>th</sup> Avenue as dedicated in the plat of the "City of Portland" and referred to therein as 8<sup>th</sup> Street, a distance of 85 feet more or less, to the intersection of the right-of-way centerline of SW Mill Street, which is now vacated by City of Portland Ordinance No. 128737, accepted March 19, 1969, with the westerly right-of-way line of SW 10<sup>th</sup> Avenue, Assessor Map 1S 1E 4AD;
  60. Thence westerly, along the right-of-way centerline of SW Mill Street, which is now vacated by City of Portland Ordinance No. 128737, accepted March 19, 1969 and City of Portland Ordinance No. 159198, accepted November 26, 1938, a distance of 480 feet, more or less, to the easterly right-of-way line of SW 12<sup>th</sup> Avenue, Assessor Map 1S 1E 4AD;
  61. Thence northerly, along the easterly right-of-way line of SW 12<sup>th</sup> Avenue as dedicated in the plat of the "City of Portland" and referred to therein as 10<sup>th</sup> Street, a distance of 230 feet, more or less, to the southerly right-of-way line of SW Market Street, Assessor Map 1S 1E 4AD;

62. Thence westerly, along the southerly right-of-way line of SW Market Street as dedicated in the plat of the "City of Portland", a distance of 280 feet, more or less, to the easterly right-of-way line of SW 13<sup>th</sup> Avenue, Assessor Map 1S 1E 4AC;
63. Thence northerly, along the easterly right-of-way line of SW 13<sup>th</sup> Avenue as dedicated in the plat of the "City of Portland" and referred to therein as 11<sup>th</sup> Street, a distance of 580 feet, more or less, to the northerly right-of-way line of SW Columbia Street, Assessor Map 1S 1E 4AC and Assessor Map 1S 1E 4AB;
64. Thence westerly, along the northerly right-of-way line of SW Columbia Street as dedicated in the plat of the "City of Portland", a distance of 360 feet, more or less, to the westerly right-of-way line of SW 14<sup>th</sup> Avenue, Assessor Map 1S 1E 4AB;
65. Thence northerly, along the westerly right-of-way line of SW 14<sup>th</sup> Avenue as dedicated in the plat of the "City of Portland" and referred to therein as 12<sup>th</sup> Street, a distance of 510 feet, more or less, to the south line of that tract of land conveyed to Jacob Kamm by deed recorded March 11, 1876 in Book 29, Page 25, said deed records, Assessor Map 1S 1E 4AB;
66. Thence westerly, along the south line of that tract of land conveyed to Jacob Kamm by deed recorded March 11, 1876 in Book 29, Page 25, said deed records, a distance of 1080 feet, more or less, to the easterly right-of-way line of SW 18<sup>th</sup> Avenue, Assessor Map 1S 1E 4AB;
67. Thence northerly, along the easterly right-of-way line of SW 18<sup>th</sup> Avenue as conveyed to the City of Portland by Resolution No. 19297 accepted August 29, 1929 and shown in the plat of "Opening, Lay-Out and Establishing of Jefferson Street and Chapman Street by Resolution No. 19297", a distance of 157 feet, more or less, to an angle point in said east right-of-way at the south line of that tract of land conveyed to the City of Portland for right-of-way purposes by deed recorded August 7, 1997 in Document No. 97119188, Assessor Map 1S 1E 4AB;
68. Thence easterly and northerly, along the southerly and easterly right-of-way lines of SW 18<sup>th</sup> Avenue as conveyed to the City of Portland for right-of-way purposes by deed recorded August 7, 1997 in Document No. 97119188, a distance of 241 feet, more or less, to the southerly right-of-way line of SW Salmon Street, Assessor Map 1S 1E 4AB;
69. Thence easterly, along the south right-of-way lines of SW Salmon Street as conveyed to the City of Portland by Ordinance No. 52062, dated May 4, 1927 and shown in the plat of "Opening, Lay-Out and Establishing of Salmon St. and Lownsdale St. by Resolution No. 19513", a distance of 1022 feet, more or less, to the westerly right-of-way line of SW 14<sup>th</sup> Avenue, Assessor Map 1S 1E 4AB;
70. Thence southerly, along the westerly right-of-way line of SW 14<sup>th</sup> Avenue as dedicated in the plat of the "City of Portland" and referred to there in as 12<sup>th</sup> Street, a distance of 323.00 feet, Assessor Map 1S 1E 4AB;
71. Thence easterly, perpendicular to the last described course, a distance of 360 feet, more or less, to the easterly right-of-way line of SW 13<sup>th</sup> Avenue, which is also on the boundary line of the **South Park Blocks Urban Renewal Area**, Assessor Map 1S 1E 4AB and Assessor Map 1S 1E 4AA;

**The following courses are in common with the boundary line of the South Park Blocks Urban Renewal Area.**

72. Thence southerly, along the easterly right-of-way line of SW 13<sup>th</sup> Avenue as dedicated in the plat of the "City of Portland" and referred to therein as 11<sup>th</sup> Street, a distance of 457



- feet, more or less, to the southerly right-of-way line of SW Jefferson Street, Assessor Map 1S 1E 4AA;
73. Thence easterly, along the southerly right-of-way line of SW Jefferson Street, which is also 30.00 feet southerly of, measured perpendicular thereto, the east-west centerline of Block D of the plat of the "City of Portland" and it's easterly extension, a distance of 280 feet, more or less, to the easterly right-of-way line of SW 12<sup>th</sup> Avenue, Assessor Map 1S 1E 4AA;
  74. Thence northerly, along the easterly right-of-way line of SW 12<sup>th</sup> Avenue as dedicated in the plat of the "City of Portland" and referred to therein as 10<sup>th</sup> Street, a distance of 148 feet, more or less, to the northwesterly corner of that tract of land conveyed to the City of Portland by Warranty Deed – Statutory Form recorded July 18, 2001 in Document No. 2001-109903, said deed records, Assessor Map 1S 1E 4AA;
  75. Thence easterly, along the northerly line of that tract of land conveyed to the City of Portland by Warranty Deed – Statutory Form recorded July 18, 2001 in Document No. 2001-109903, said deed records, a distance of 200 feet, more or less, to the northeasterly corner thereof, which is on the westerly right-of-way line of SW 11<sup>th</sup> Avenue, Assessor Map 1S 1E 4AA;
  76. Thence southerly, along the westerly right-of-way line of SW 11<sup>th</sup> Avenue as dedicated in the plat of the "City of Portland" and referred to therein as 9<sup>th</sup> Street, a distance of 141 feet, more or less, to southerly right-of-way line of SW Jefferson Street, Assessor Map 1S 1E 4AA;
  77. Thence easterly, along the southerly right-of-way line of SW Jefferson Street as dedicated in the plat of the "City of Portland", a distance of 620 feet, more or less, easterly right-of-way line of the south bound portion of SW Park Avenue; Assessor Map 1S 1E 4AA and Assessor Map 1S 1E 4AD;
  78. Thence northerly, along the easterly right-of-way line of the south bound portion of SW Park Avenue as dedicated in the plat of the "City of Portland", a distance of 780 feet, more or less, to the south right-of-way line of SW Salmon Street, Assessor Map 1S 1E 4AA and 1S 1E 3BB;
  79. Thence easterly, along the south right-of-way line of SW Salmon Street as dedicated in the plat of the "City of Portland", a distance of 80 feet, more or less to the westerly right-of-way line of the north bound portion of SW Park Avenue, Assessor Map 1S 1E 3BB;
  80. Thence southerly, along the westerly right-of-way line of the north bound portion of SW Park Avenue as dedicated in the plat of the "City of Portland", a distance of 1040 feet, more or less, to the southerly right-of-way line of SW Columbia Street, Assessor Map 1S 1E 3BB, Assessor Map 1S 1E 4AA, and Assessor Map 1S 1E 4AD;
  81. Thence easterly, along the southerly right-of-way line of SW Columbia Street as dedicated in the plat of the "City of Portland", a distance of 860 feet, more or less, to the right-of-way centerline of SW 5<sup>th</sup> Avenue, Assessor Map 1S 1E 4AD and Assessor Map 1S 1E 3BC;
  82. Thence southerly, along the right-of-way centerline of SW 5<sup>th</sup> Avenue as dedicated in the plat of the "City of Portland", a distance of 1175 feet, more or less, to the westerly extension of the southerly line of that tract of land conveyed to the City of Portland by statutory bargain and sale deed recorded December 20, 2002 in Document No. 2002-234375, said deed records, Assessor Map 1S 1E 3BC and Assessor Map 1S 1E 3CB;
  83. Thence easterly, along the southerly line of that tract of land conveyed to the City of Portland by statutory bargain and sale deed recorded December 20, 2002 in Document No. 2002-234375, said deed records, and it's westerly extension, a distance of 240 feet,



- more or less, to the westerly right-of-way line of SW 4<sup>th</sup> Avenue, Assessor Map 1S 1E 3CB;
84. Thence northerly, along the westerly right-of-way line of SW 4<sup>th</sup> Avenue as dedicated in the plat of the "City of Portland", a distance of 135 feet, more or less, to the southerly right-of-way line of SW Montgomery Street, Assessor Map 1S 1E 3CB;
85. Thence westerly, along the southerly right-of-way line of SW Montgomery Street as dedicated in the plat of the "City of Portland", a distance of 200 feet, more or less, to the easterly right-of-way line of SW 5<sup>th</sup> Avenue, Assessor Map 1S 1E 3CB;
86. Thence northerly, along the easterly right-of-way line of SW 5<sup>th</sup> Avenue as dedicated in the plat of the "City of Portland", a distance of 1040 feet, more or less, to the southerly right-of-way line of SW Columbia Street, Assessor Map 1S 1E 3CB and Assessor Map 1S 1E 3BC;
87. Thence easterly, along the southerly right-of-way line of SW Columbia Street as dedicated in the plat of the "City of Portland", a distance of 200 feet, more or less, to the westerly right-of-way line of SW 4<sup>th</sup> Avenue as dedicated in said plat and the POINT OF BEGINNING, Assessor Map 1S 1E 3BC.

The Education Urban Renewal Area contains 144 acres, more or less.

REGISTERED  
PROFESSIONAL  
LAND SURVEYOR

*Gary P. Christerson*

OREGON  
January 20, 1989  
GARY P. CHRISTERSON  
2377

RENEWAL: 12-31-13

Exhibit A

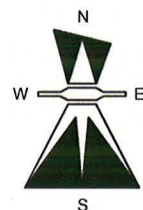
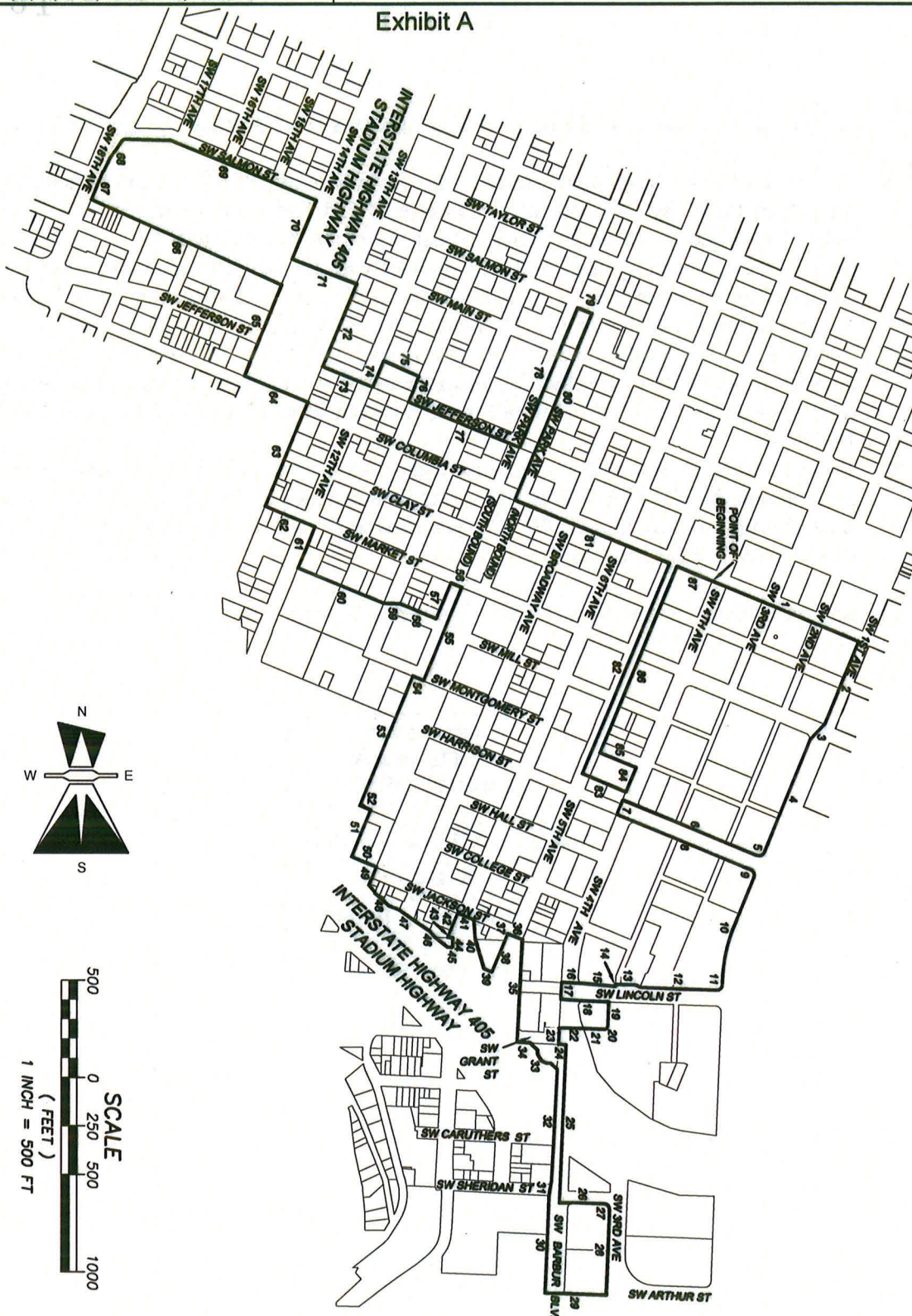

SHEET 1 OF 1	DATE: 03/30/12
	REVISION #:
	SURVEYED BY: GPC
	DRAWN BY: RFS
	CHECKED BY:

EXHIBIT 1.A LEGAL DESCRIPTION MAP EDUCATION URA		
CITY OF PORTLAND/MULTNOMAH COUNTY OREGON		
SCALE: 1" = 500'	PROJECT NO. 2010-024	FILE NAME: PDC EXHIBITS.DWG



Because the world is a spatial place™

1724 23rd Avenue | Forest Grove OR 97116  
T: 503.359.1688 | www.oriongeomatics.com