

184942

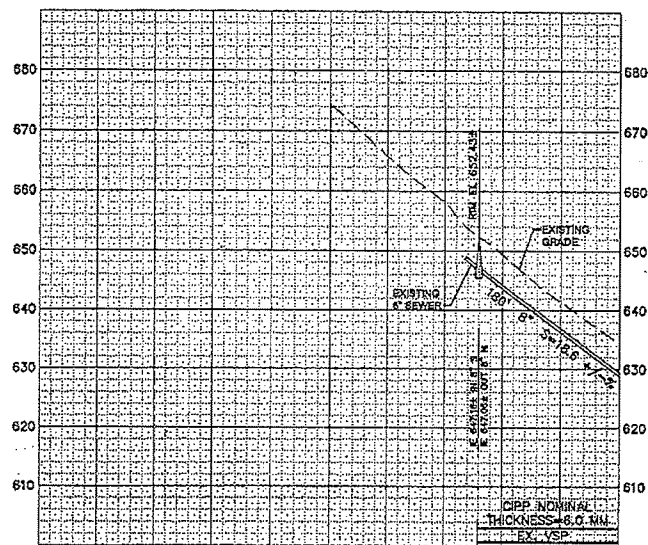

PROFILE: HORIZ: 1"=40'  
VERT: 1"=10'

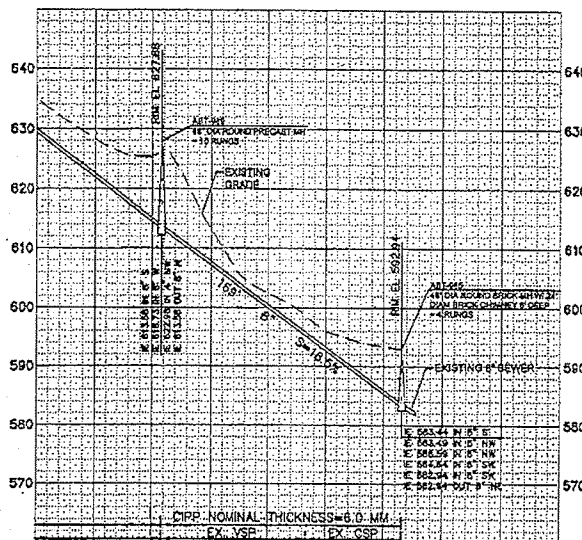

#### ACCESS CHART

ABT-985	MANHOLE LOCATED BEHIND CURBLINE IN LANDSCAPED AREA BETWEEN AN ELECTRIC POLE AND GUY WIRE THAT LIMITS OVERHEAD ACCESS.
ABT-989	COORDINATE WITH 2430 SW MONTGOMERY DR. FOR MANHOLE ACCESS AND VEHICLE PARKING. VERY STEEP AND LONG DRIVEWAY TO NARROW PATH FOR MAN AND EQUIPMENT ACCESS.
ABU-021	MANHOLE LOCATED IN ALLEY. COORDINATE WITH ADJACENT PROPERTIES AS NECESSARY.

MH-MH SEGMENT	INSTALLED EX (in)	INSTALLED THICKNESS
ABU-021 TO ABT-989		
ABT-989 TO ABT-985		

\*TABLE TO BE FILLED IN BY THE OWNER UPON COMPLETION OF CIPP INSTALLATION

#### CONSTRUCTION NOTES:

1. REHABILITATE EXISTING MANHOLE.
2. APPROXIMATE LOCATION OF GRADE BREAK IN SEWER OF 30 DEGREES +/-.
10. VERIFY STATUS OF LATERAL LOCATED 48' UP THE CLAY SEWER. IF ACTIVE, REROUTE TO 8" SEWER BEING REHABILITATED WITH CIPP. ABANDON CLAY SEWER FOLLOWING LATERAL VERIFICATION.
14. REPORT ANY MEDIUM TO HEAVY ROOTS FOUND DURING PRE-INSTALLATION INSPECTIONS TO CONSTRUCTION MANAGER.
16. APPROXIMATE LOCATION OF MANHOLE TO BE BUILT BY OTHERS.
20. RECONSTRUCT INTERIOR OF MANHOLE BASE.
21. REPLACE MANHOLE STEPS.
22. TRIM BACK PROTRUDING LATERAL PRIOR TO CIPP LINING.
24. APPROXIMATE LOCATION OF OFFSET JOINT.
33. SEWER AND MANHOLE WORK TO BE DONE BY PROPERTY OWNER 2615 UNDER A PRIVATE PERMIT. NEW AS-BUILT PLANS WILL BE ISSUED WHEN PRIVATE WORK IS COMPLETED. PLANNED CIPP WORK TO BE DONE AFTER ALL PRIVATE WORK IS COMPLETED.

8/29/11

1. THE CITY OF PORTLAND HAS REVIEWED THIS PLAN FOR CONFORMANCE WITH THE PORTLAND CITY CODE, CHAPTER 21.01, AND HAS FOUND IT TO BE IN ACCORDANCE WITH THE CITY CODE. THE CITY OF PORTLAND DOES NOT GUARANTEE THE ACCURACY OF THE INFORMATION PROVIDED HEREON. THE CITY OF PORTLAND IS NOT RESPONSIBLE FOR ANY ERRORS OR OMISSIONS. THE CITY OF PORTLAND IS NOT RESPONSIBLE FOR ANY DAMAGES, INCLUDING BUT NOT LIMITED TO, CONSEQUENTIAL DAMAGES, ARISING OUT OF OR FROM THE USE OF THIS PLAN. THE CITY OF PORTLAND IS NOT RESPONSIBLE FOR ANY DAMAGES, INCLUDING BUT NOT LIMITED TO, CONSEQUENTIAL DAMAGES, ARISING OUT OF OR FROM THE USE OF THIS PLAN.

DESIGNED BY	DATE	APPROVED BY
DRAWN BY	PROJECT NO.	
CHECKED BY	CONTRACT NO.	
DATE		
DESCRIPTION	APPROVAL	
REVISION		

CITY OF PORTLAND  
ENVIRONMENTAL SERVICES



Brown and Caldwell



THE WESTSIDE LINER  
SEWER REHABILITATION PROJECT  
CIVIL  
SW BUENA VISTA DR  
PLAN AND PROFILE

1/4" EQUAL  
3225  
JOB NO.  
E09121  
PROJECT  
C01  
4 of 38

EXHIBIT A

184942

184942

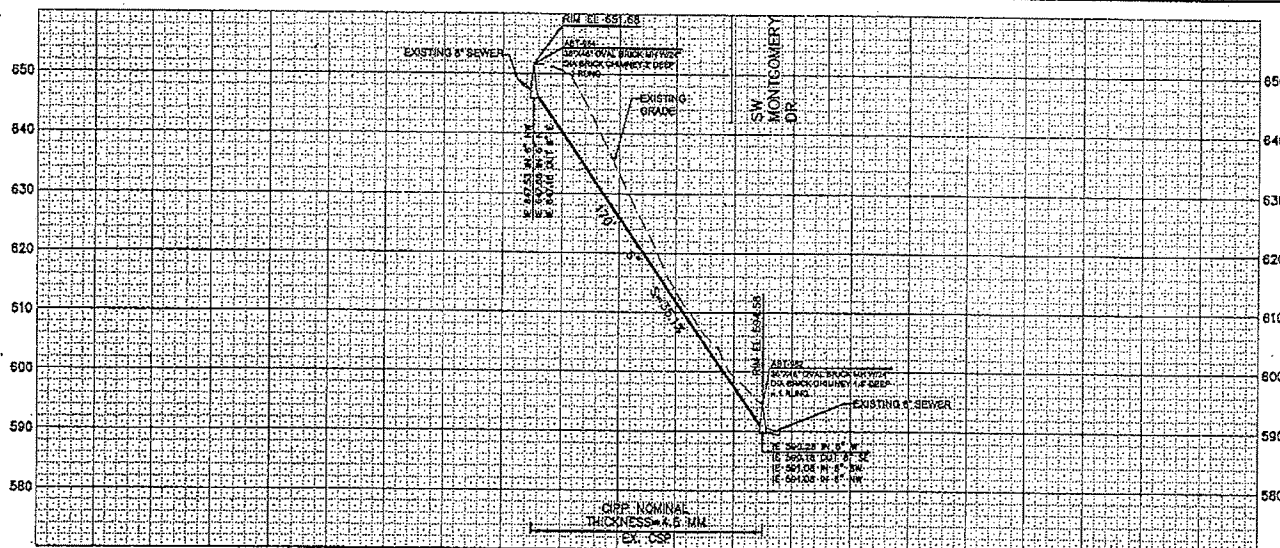

PROFILE: HORIZ: 1"=40'  
VERT: 1"=10'

**SEE**  
Total Area = 1840 SF

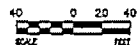
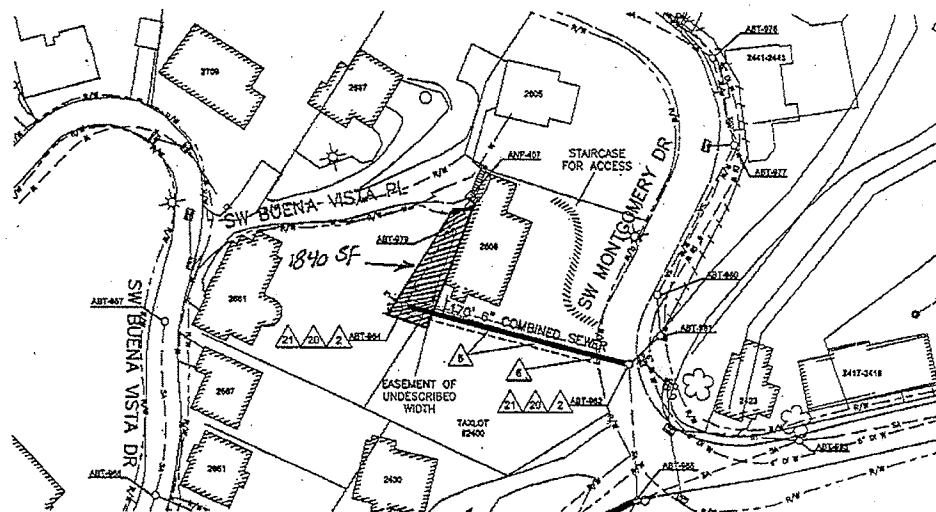

#### ACCESS CHART

ABT-982	TRAFFIC CONTROL PER SECTION 00225 FOR VEHICULAR AND MANNED ACCESS.
ABT-984	LIMITED VEHICULAR PARKING IN BUENA VISTA PL COORDINATE WITH 2505 AND 2581 SW BUENA VISTA PL FOR MANNED ACCESS ONLY.

MH-MH SEGMENT	INSTALLED Ea (ps)	INSTALLED THICKNESS
ABT-984 TO ABT-982		

\*TABLE TO BE FILLED IN BY THE OWNER UPON COMPLETION OF GPP INSTALLATION

#### CONSTRUCTION NOTES:

- 2 REHABILITATE EXISTING MANHOLE.
- △ APPROXIMATE LOCATION OF GRADE BREAK IN SEWER OF 30' +/-.
- △ SEVERAL LOCATIONS WITH LIGHT TO MEDIUM ROOTS.
- 2△ RECONSTRUCT INTERIOR OF MANHOLE BASE.
- 2△ REPLACE MANHOLE STEPS.

8/29/11

PROJECT UNDER: SECTION AHEAD: CONSTRUCTION BY: PROJECT COMPLETED: MAP CORRECTED BY: FINAL MAP DATE: 1/18/2012		DESIGNED BY: DRAWN BY: CHECKED BY: DESIGN WORK:		CITY OF PORTLAND <b>ENVIRONMENTAL SERVICES</b>				<b>THE WESTSIDE LINE SEWER REHABILITATION PROJECT CIVIL</b> SW BUENA VISTA PL PLAN AND PROFILE		174 32255 3225 JOB NO. E08121 SHEET NO. C02 5 of 38
--	--	--	--	---	--	--	--	--	--	---

EXHIBIT B

184942

184942

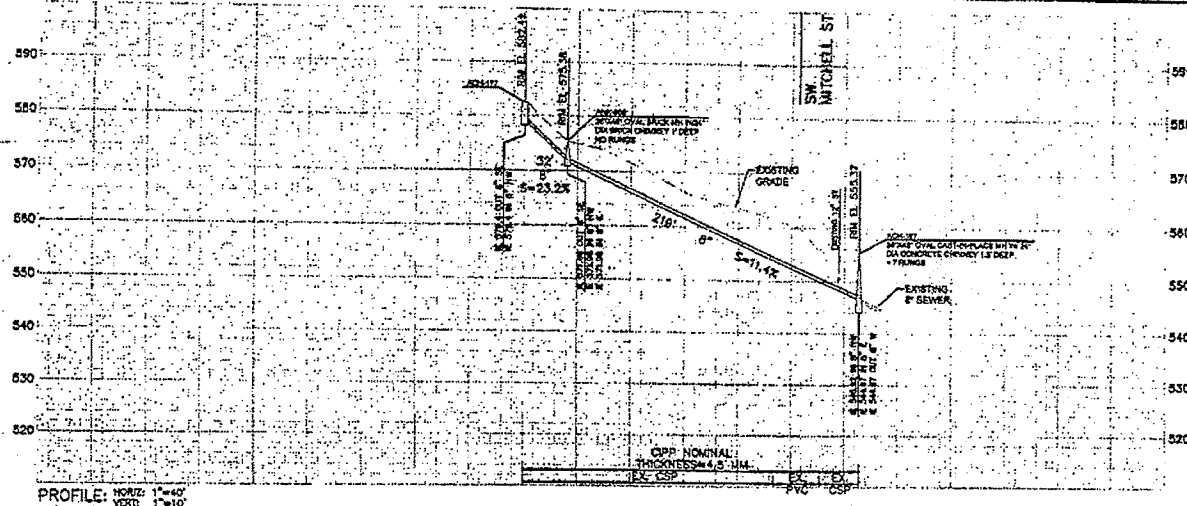

TCE  
Total Area = 1780 SF

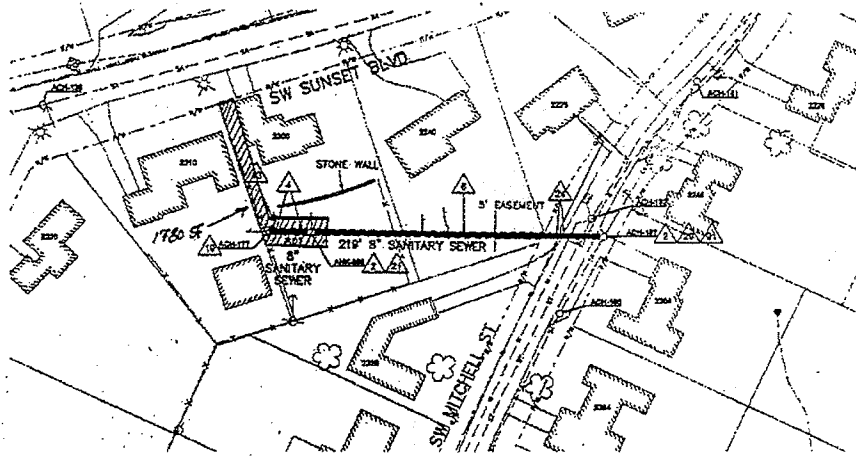

# ACCESS CHART

ACH-187	TRAFFIC CONTROL PER SECTION 00225 FOR VEHICULAR AND MANHOOD ACCESS.
ANK-888	COORDINATE WITH 2300 SW SUNSET BLVD.
ACH-177	COORDINATE WITH 2300 AND 2310 SW SUNSET BLVD.

NON-MH SECTION	INSTALLED E4 (3M)	INSTALLED THICKNESS
ACH-177 TO ANK-888		
ANK-888 TO ACH 187		

\*TABLE TO BE FILLED IN BY THE OWNER UPON COMPLETION OF CIPP INSTALLATION

# CONSTRUCTION NOTES:

1. REHABILITATE EXISTING MANHOLE.
2. APPROXIMATE LOCATION OF PROTRUDING OBSTACLE AT CROWN OF PIPE.
3. SEVERAL LOCATIONS WITH LIGHT TO MEDIUM ROOTS.
4. REPLACE EXISTING LATERAL CONNECTION PER DETAIL D01.
5. IDENTIFY LOCATION OF CHANGE IN SEWER DIAMETER FROM 8" TO 6" AND INSTALL STANDARD CLEAN OUT PER STANDARD PLANS P-256 AND P-261.
6. RECONSTRUCT INTERIOR OF MANHOLE BASE.
7. REPLACE MANHOLE STEPS.
8. APPROXIMATE LOCATION OF OFFSET JOINT.

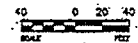

DESIGNED BY	REVISION	DATE
CHECKED BY	REVISION	DATE
APPROVED BY	REVISION	DATE
PROJECT NO.	134130-027	07/11 at 1354

CITY OF PORTLAND  
ENVIRONMENTAL SERVICES



Brown and Caldwell



THE WESTSIDE LINER  
SEWER REHABILITATION PROJECT  
CIVIL  
SW MITCHELL ST  
PLAN AND PROFILE

177 42025  
3522  
JOB NO.  
E08121  
SHEET NO.  
C07  
10 of 38

EXHIBIT C

184848

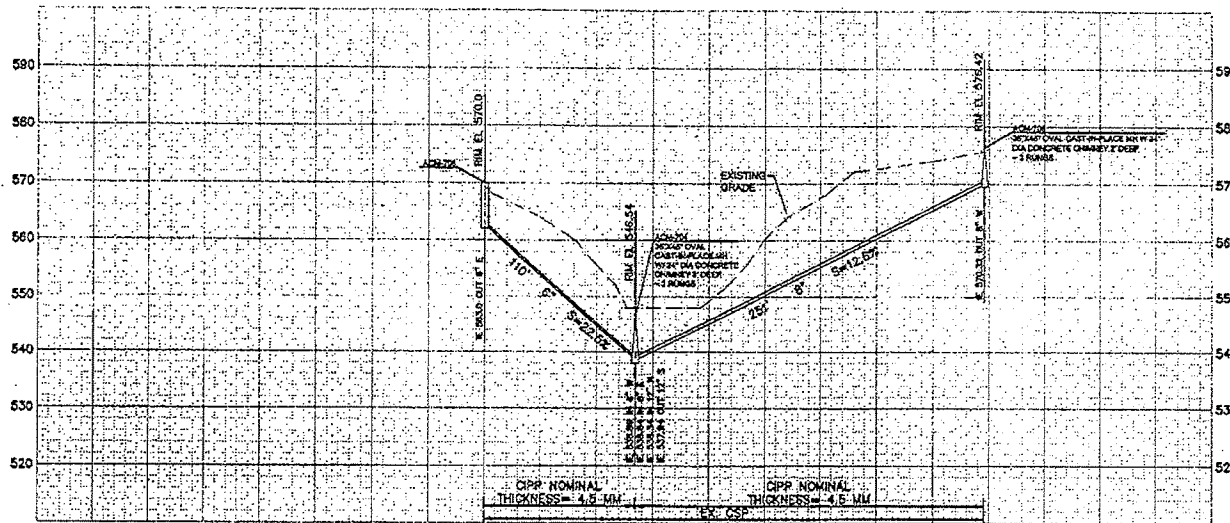

PROFILE: HORIZ: 1"=40'  
VERT: 1"=10'

ACCESS CHART

ACM-708	COORDINATE VEHICULAR AND MANNED ACCESS WITH 1117 SW CHELTEMHAM ST AND 1023 SW CHELTEMHAM CT. GROUND ELEVATION AT ACM-708 STS APPROXIMATELY 6' LOWER THAN DRIVEWAY OF 1020 SW CHELTEMHAM CT.
ACM-704	COORDINATE WITH 1031 SW CHELTEMHAM ST. AND 910 SW WESTWOOD ST. FOR ACCESS. PRIVATE GATES (2) ARE LOCATED BETWEEN SW CHELTEMHAM AND ACM-704. VEHICULAR ACCESS WOULD REQUIRE RESTORATION WORK.
ACM-706	COORDINATE WITH 640 AND 640 SW WESTWOOD ST. AND 1023 SW CHELTEMHAM ST. FOR ACCESS. VEHICULAR ACCESS IS LIMITED.

MH--MH SEGMENT	INSTALLED E <sub>8</sub> (pH)	INSTALLED THICKNESS
ACM-708 TO ACM-704		
ACM-708 TO ACM-706		

\*TABLE TO BE FILLED IN BY THE OWNER UPON COMPLETION OF CIP INSTALLATION

CONSTRUCTION NOTES:

- ▲ LOCATE END OF SEWER AND CONSTRUCT STANDARD CLEANOUT PER STANDARD PLANS P-236 AND P-261.
- ▲ REHABILITATE EXISTING MANHOLE.
- ▲ SEVERAL LOCATIONS WITH LIGHT TO MEDIUM ROOTS.
- ▲ REPLACE MANHOLE STEPS.
- ▲ APPROXIMATE LOCATION OF CHANGE IN SEWER DIAMETER FROM 8" TO 4". LOCATE 4" PIPE AND REPLACE WITH 6" SDR 35 PVC PRIOR TO LINING.

TCE  
Total Area = 12,430 SF

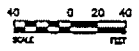
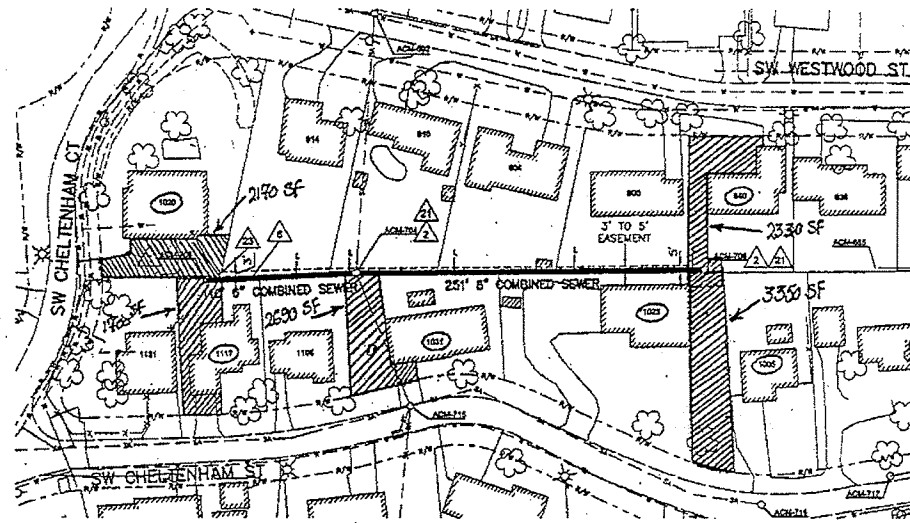

NO.	DATE	DESCRIPTION	APPROVED
1	12/12/11	ISSUED FOR PERMIT	
2	1/11/12	REVISED	

CITY OF PORTLAND  
ENVIRONMENTAL SERVICES



Brown and Caldwell



THE WESTSIDE LINER  
SEWER REHABILITATION PROJECT  
CIVIL  
SW CHELTEMHAM CT  
PLAN AND PROFILE

1/2 SHEET  
3628  
201211  
C09  
12 of 38

184942

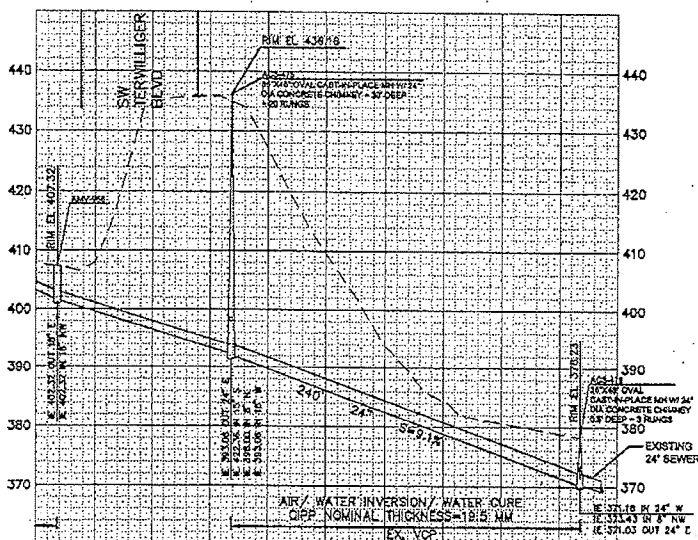
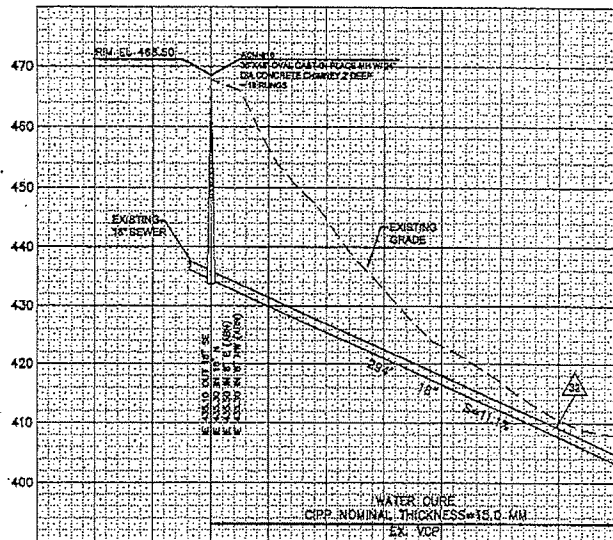

ACCESS CHART

ACM-816	COORDINATE WITH 820 SW BURLINGAME RD. FOR VEHICULAR AND MANNED ACCESS. PRUNE TREES AS NEEDED.
AMV-966	LOCATED IN ENVIRONMENTAL OVERLAY ZONE. COORDINATE WITH 8737 SW TERWILLIGER BLVD FOR MANNED ACCESS AND VEHICULAR PARKING.
ACS-475	LOCATED IN ENVIRONMENTAL OVERLAY ZONE. TRAFFIC CONTROL PER SECTION 00225 IS NECESSARY FOR VEHICULAR AND MANNED ACCESS.
ACS-476	LOCATED IN ENVIRONMENTAL OVERLAY ZONE. ACCESS MANHOLE FROM PUBLIC TRAIL LOCATED OFF OF SW TERWILLIGER BLVD. NEAR ACS-475. NO VEHICULAR ACCESS ALLOWED, MANNED ACCESS ONLY.

MH-MH SEGMENT	INSTALLED Ea (ft)	INSTALLED THICKNESS
ACM-816 TO AMV-966		
AMV-966 TO ACS-475		
ACS-475 TO ACS-476		

\*TABLE TO BE FILLED IN BY THE OWNER UPON COMPLETION OF CIPP INSTALLATION

CONSTRUCTION NOTES:

2. REHABILITATE EXISTING MANHOLE.
3. LOCATIONS WITH MORTAR AND MINERAL DEPOSITS.
21. REPLACE MANHOLE STEPS.
22. PREVIOUSLY LINED SEWER. DO NOT INSTALL CIPP.
28. 24" DIAMETER BRICK CHIMNEY IS APPROXIMATELY 30 FEET DEEP.
29. REMOVE AND RESTORE WOODEN INLET GRATE AND STRUCTURE AS NEEDED TO FACILITATE CIPP LINING.
32. INSTALL 2' CURED-IN-PLACE POINT REPAIR AT LOCATION OF HOLE APPROXIMATELY 250' DOWNSTREAM OF ACM-816.

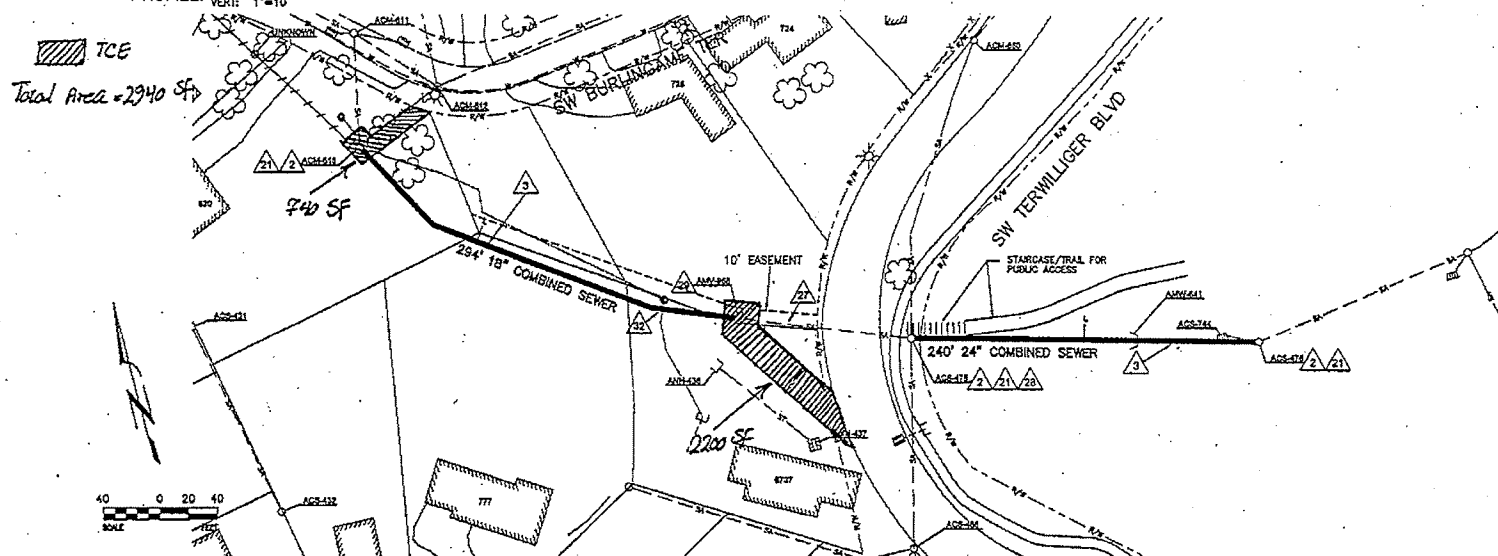

8/29/11

DESIGNED BY: [ ] DATE: [ ] CHECKED BY: [ ] DATE: [ ] PROJECT NO.: [ ] SHEET NO.: [ ]		CITY OF PORTLAND <b>ENVIRONMENTAL SERVICES</b>				<b>THE WESTSIDE LINER SEWER REHABILITATION PROJECT</b> CIVIL SW TERWILLIGER BLVD PLAN AND PROFILE		1/4" = 1' SCALE 3728 E09121 C11 14x38
---	--	---	--	--	--	--	--	---

EXHIBIT E

184942

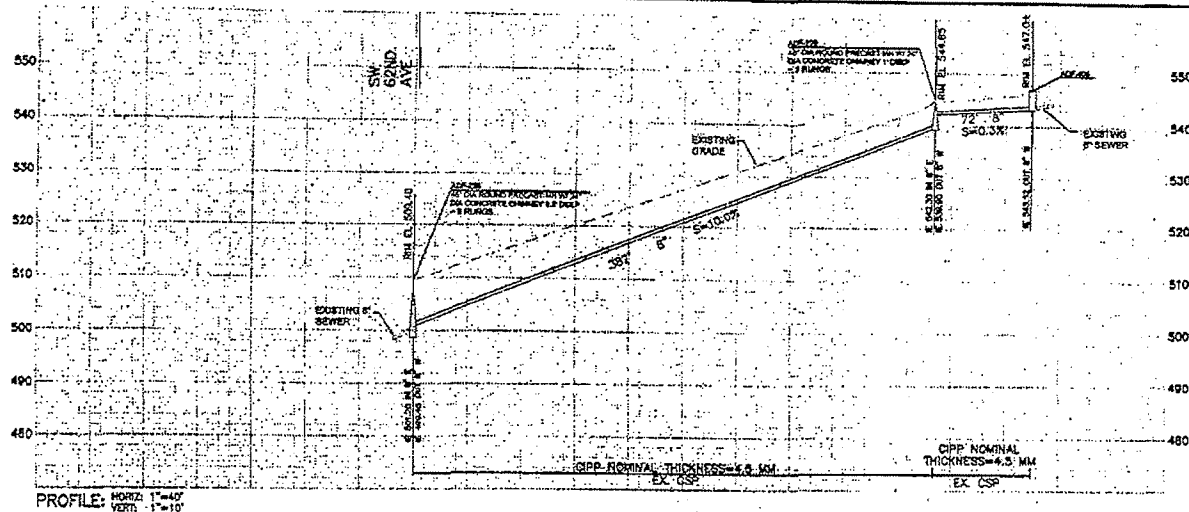

## ACCESS CHART

ADF-228	TRAFFIC CONTROL PER SECTION D0232 FOR VEHICULAR ACCESS. COORDINATE WITH 6161 SW EVELYN ST. FOR MANNED ACCESS.
ADF-229	COORDINATE WITH 6049 SW EVELYN ST. FOR MANNED ACCESS. MAIN DATE IS ON EAST SIDE OF HOME. NO VEHICULAR ACCESS ALLOWED.
ADF-406	COORDINATE WITH 6049 SW EVELYN ST. FOR ACCESS. MAIN DATE IS ON EAST SIDE OF HOME.

MAN-SEGMENT	INSTALLED Ca (ps)	INSTALLED THICKNESS
ADF-228 TO ADF-229		
ADF-229 TO ADF-406		

\*TABLE TO BE FILLED IN BY THE OWNER UPON COMPLETION OF CPP INSTALLATION

7CE  
Total Area = 3390 SF

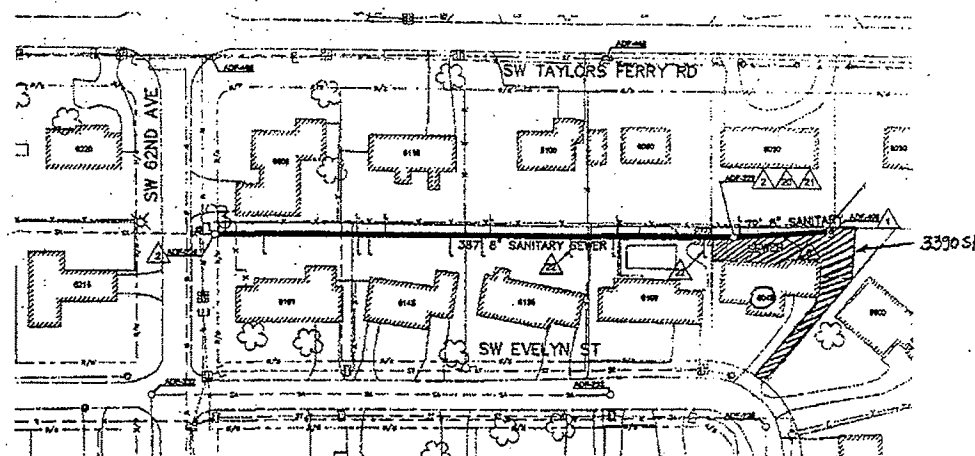

## CONSTRUCTION NOTES:

- ▲ LOCATE END OF SEWER AND CONSTRUCT STANDARD CLEANOUT PER STANDARD PLANS P-258 AND P-261.
- ▲ REHABILITATE EXISTING MANHOLE.
- ▲ SEVERAL LOCATIONS WITH LIGHT TO MEDIUM ROOTS.
- ▲ RECONSTRUCT INTERIOR OF MANHOLE BASE.
- ▲ REPLACE MANHOLE STEPS.
- ▲ TRIM BACK PROTRUDING LATERAL PRIOR TO CPP LIVING.

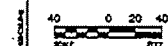

DESIGNED BY: _____ CHECKED BY: _____ PROJECT COMPLETION: _____ DATE: _____		CITY OF PORTLAND <b>ENVIRONMENTAL SERVICES</b>				<b>THE WESTSIDE LINER SEWER REHABILITATION PROJECT CIVIL</b> SW 62ND AVE PLAN AND PROFILE	1/2" = 1' SCALE 4925 E09121 C15 184938
---	--	---	--	--	--	---	--

EXHIBIT F

184943